

**BID PACKAGE-1: HVAC RENOVATION**

**HVAC RENOVATIONS FOR:  
EAST COWETA MIDDLE  
SCHOOL GYMNASIUM**

SENOIA, GEORGIA

FOR:

**COWETA COUNTY SCHOOL SYSTEM**

NEWMAN, GEORGIA

STATE PROJECT No. FY19

FTE 650

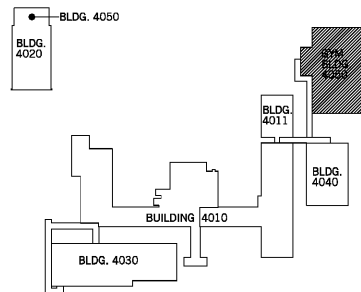

KEY PLAN

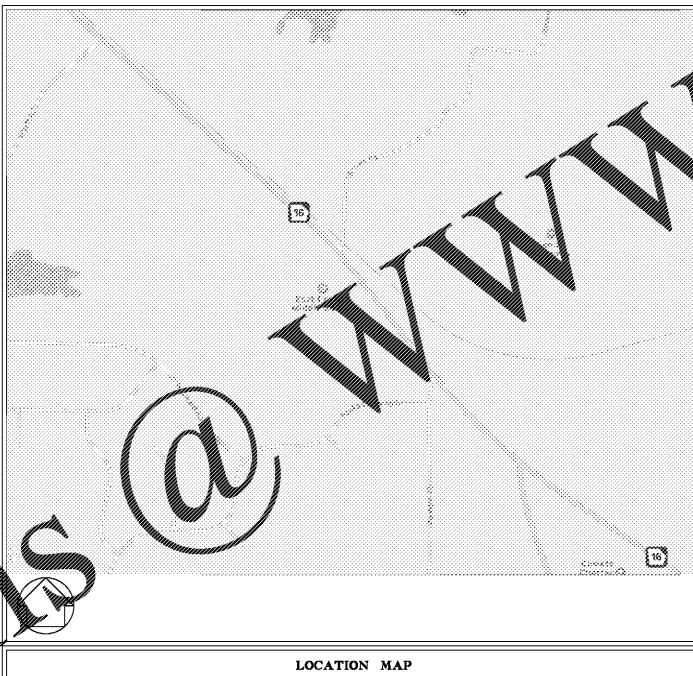

LOCATION MAP

**Southern A&E**  
7951 Tron Circle  
Austell, Ga. 30168  
(770) 819-7777  
architects & engineers

© COPYRIGHT 2019 BY SOUTHERN A&E, LLC. ALL RIGHTS RESERVED.  
THIS DOCUMENT IS THE PROPERTY OF SOUTHERN A&E, LLC AND  
SHALL NOT BE COPIED OR REPRODUCED IN WHOLE OR PART  
WITHOUT EXPRESSED WRITTEN CONSENT FROM SOUTHERN A&E, LLC.

*DESIGNED IN ACCORDANCE WITH THE FOLLOWING CODES:*

<b>GENERAL:</b> International Building Code 2012 Edition with Georgia Amendments. International Fire Code, 2012 Edition with Georgia Amendments. International Energy Conservation Code, 2009 Edition with Georgia Amendments. National Fire Protection Association Publication Number 101 (Life Safety Code), 2012 Edition. National Fire Protection Association NFPA 13, National Fire Protection Association NFPA 24, National Fire Protection Association NFPA 70, 2017 Edition National Fire Protection Association NFPA 72, 2013 Ed. State of Georgia "Rules of Safety Fire Commissioner Chapter 120-3-3". State of Georgia Department of Education "Regulations and Procedures". 2010 ADA Standards For Accessible Design (120.3-20A). ANSI A117.1 Providing accessibility and usability for physically handicapped people. Local and State Codes or Regulations.	<b>FIRE PROTECTION SYSTEM:</b> Fire Protection Equipment List Published by Underwriters Laboratories. NFPA-24 Installation of Private Fire Service Mains and the Appurtenances, 2013 Edition. NFPA-13 Installation of Sprinkler Systems, 2013 Edition.
<b>PLUMBING:</b> International Plumbing Code, 2012 Edition with Georgia Amendments. International Fuel Gas Code, 2012 Edition with Georgia Amendments. L. P. Gas Code - GA 120-3-16 Rules and Reg. for LP Gases	<b>HEATING, VENTILATION, &amp; AIR CONDITIONING:</b> International Mechanical Code, 2012 Edition. Air Conditioning and Ventilating Systems- NFPA Standard 90A, 2012 edition. HVAC Duct Construction Standards Metal and Flexible, 3rd, Edition 2005, Published by SMACNA. Fire, Smoke and Radiation Damper Installation Guide, 5th, Edition 2002, Published by SMACNA. Vapor Removal from Cooking Equipment - NFPA Standard 96, 2011 Edition.
<b>STRUCTURAL:</b> American Institute of Steel Construction, AISC 14 Edition American Concrete Institute, 318-11 Steel Joist Institute, SJI 2010 Building Code Requirement for Concrete Masonry Structures, ACI 530-11 ASCE 7-10 Minimum Design Loads for Buildings & Other Structures	<b>ELECTRICAL GENERAL (most recent edition, unless noted):</b> NFPA 70 (National Electrical Code), 2017 Edition NFPA 72, (National Fire Alarm Code) 2013 Edition, with Georgia Amendments. NFPA 37, (Standard for the Installation and Use of Stationary Combustion Engines and Gas Turbines) NFPA 780, 2011 Edition (Lightning Protection Code) NFPA 90A, (Air Conditioning and Ventilating Systems) NFPA 110, 2013 Edition (Standard for Emergency and Standby Power Systems) NFPA 30, (Flammable and Combustible Liquids Code) All local prevailing city and county codes.
<b>MECHANICAL GENERAL:</b> Underwriters' Laboratories, Inc., Approved Materials List. Materials and apparatus of a type that have been tested and listed by UL shall be manufactured under their reinspection service and bear the UL label. All local prevailing city and county codes. Georgia Laws and Rules "Regulating Boilers and Pressure Vessels" by Georgia Department of Labor, Safety Engineering Section.	

**WARNING:** Contractors, subcontractors, vendors and suppliers are advised that the Contract Documents consist of Drawings, Specifications, Addenda, Post-Bid Addenda and Change Orders that have been printed, bound and numbered by the Architect. Any documents reproduced by parties other than the Architect, whether hard copy or electronic format, shall not be considered part of the Contract Documents and do not supercede the provisions of the Contract Documents. Contractors, subcontractors, vendors and suppliers are solely responsible for verifying that information used for bidding, development of shop drawings and construction of the facility are identical to the Architect's Contract Documents.

**LIST OF DRAWINGS**

COVER	
A101	GYMNASIUM FLOOR PLAN AND DETAILS
A102	SECTIONS AND DETAILS
P101	PLUMBING FLOOR PLAN - GYMNASIUM
P501	PLUMBING DETAIL DRAWINGS & SCHEDULES
M101	HVAC - DEMOLITION FLOOR PLAN - GYMNASIUM
M102	HVAC - RENOVATION FLOOR PLAN - GYMNASIUM
M501	HVAC - DETAIL DRAWINGS
M502	HVAC - DETAIL DRAWINGS
M503	HVAC - EQUIPMENT SCHEDULES.
E001	ELECTRICAL SYMBOL LEGEND, MECHANICAL EQUIPMENT CONNECTION SCHEDULE, PANEL SCHEDULE, DETAILS
E101	ELECTRICAL - GYMNASIUM DEMOLITION PLAN
E102	ELECTRICAL - GYMNASIUM RENOVATION PLAN

**KEYNOTES**

01 10 00	SITE CLEARING	07 22 00	ROOF ACCESSORIES
31 20 00	EARTH MOVING	A	ROOF CURBS
A	SUBGRADE	B	EQUIPMENT SUPPORT
B	DRAINAGE COURSE	C	ROOF FLASHING
32 18 28	ATHLETIC SURFACING & PAVING (POLYURETHANE)	D	PRE-FORMED FLASHING BLEWEE
32 18 29	ATHLETIC SURFACING & PAVING (GATE)	E	FALL PROTECTION SAFETY RAIL SYSTEM
32 18 16	ASPHALT PAVING	07 81 00	APPLIED FIREPROOFING
32 18 18	CONCRETE PAVING	07 81 01	GENERATION FIRESTOPPING
32 18 13	TENNIS COURT PAVING & SURFACING	07 84 46	FIRE RESISTIVE JOINT SYSTEM
32 14 00	UNIT PAVES	07 92 00	JOINT SEALANTS
32 11 18	CHAIN LINK FENCE & GATES	07 92 00	EXPANSION CONTROL
32 32 23	SEGMENTAL RETAINING WALLS	A	PEDESTRIAN TRAFFIC JOINTS
39 41 00	STORM UTILITY DRAINAGE PIPING	B	WALL JOINTS
39 46 00	SUBDRAINAGE	C	SEUL JOINTS
A	DRAINAGE PIPE & FITTINGS	08 11 13	HOLLOW METAL DOORS AND FRAMES
B	DRAINAGE FALL	08 14 16	FLUSH WOOD DOORS
C	CAST-IN-PLACE CONCRETE	08 22 10	FIBERGLASS REINFORCED DOORS
A	CONCRETE	08 32 17	FOLDING ALUMINUM-FRAMED GLASS DOORS
B	STEEL REINFORCEMENT	08 33 13	OVERHEAD COILING DOORS
C	WELDED WIRE FABRIC	08 33 25	OVERHEAD COILING GRILLES
D	VAPOR BARRIER	08 33 25	SOUND CONTROLS, DOOR ASSEMBLIES
E	BOND-BREAKER STRIPS	08 33 25	ELECTRICALLY OPERATED SECTIONAL DOORS
08 41 00	PLANT PRECAST STRUCTURAL CONCRETE	08 33 25	ALUMINUM-FRAMED ENTRANCES & STOREFRONTS
08 48 00	PRECAST ARCHITECTURAL CONCRETE	08 33 25	ALL-GLASS ENTRANCES
08 48 00	CONCRETE BLOCK	08 42 28	SLAZED ALUMINUM CURTAIN WALLS
A	MORTAR & GROUT	08 43 13	STRUCTURED-POLYCARBONATE-PANEL ASSEMBLIES
B	MASONRY JOINT REINFORCEMENT	08 43 13	FIBERGLASS SANDWICH PANEL BLYTLIGHTS
C	TIE & ANCHORS	08 43 13	ALUMINUM WINDOWS
D	MASONRY JOINT REINFORCEMENT	08 43 23	STEEL WINDOWS
E	TIE & ANCHORS	08 52 00	WOOD WINDOWS
F	DRIBBLEDGOUT	08 52 00	DOOR HARDSHORE
G	MASONRY SETTERS	08 80 00	GLAZING
H	CAST-IN-PLACE MATERIAL	08 80 00	PLASTIC GLAZING
I	GLASS LAMINATION	08 80 00	LOCKERS AND VENTS
J	CAST STONE MASONRY	09 21 16	GYPSUM BOARD SHAFT-WALL ASSEMBLIES
K	CAST STONE MASONRY	09 22 16	NON-STRUCTURAL METAL FRAMING
L	CAST STONE MASONRY	09 22 16	STEEL STUDS AND RUNNERS
M	STEEL JOIST TRIM	B	CHANNEL BRIDGING
N	STEEL JOIST TRIM	C	FURRING CHANNEL
09 21 00	CEILING-SUPPORTED METAL FRAMING	D	CEILING & SCOTT FRAMING
A	STEEL SHIPS LADDOR	09 29 00	GYPSUM BOARD
B	STEEL SHIPS LADDOR	A	INTERIOR GYPSUM BOARD
C	STEEL SHIPS LADDOR	B	EXTERIOR GYPSUM BOARD
D	STEEL SHIPS LADDOR	C	TILE BACKING PANELS
E	LOOKS BEARING & LEVELING PLATES	09 30 13	CERAMIC TILE
F	LOOKS BEARING & LEVELING PLATES	09 30 13	RESILIENT PANEL CEILING
G	LOOKS BEARING & LEVELING PLATES	09 30 13	CORK FLOORING
H	LOOKS BEARING & LEVELING PLATES	09 30 13	WOOD ATHLETIC FLOORING
I	LOOKS BEARING & LEVELING PLATES	09 30 13	RESILIENT WALL, SHOE AND ACCESSORIES
J	LOOKS BEARING & LEVELING PLATES	09 30 13	RESILIENT SHEET FLOORING
K	LOOKS BEARING & LEVELING PLATES	09 30 13	RESILIENT TILE FLOORING
L	LOOKS BEARING & LEVELING PLATES	09 30 13	LIQUID FLOOR COVERINGS
M	LOOKS BEARING & LEVELING PLATES	09 30 13	RESILIENT ATHLETIC FLOORING
N	LOOKS BEARING & LEVELING PLATES	09 30 13	TERRAZZO
09 31 00	METAL STAIRS	09 31 23	RESILIENT FLOORING
A	STAIR FRAMING	09 38 13	TILE CARPETING
B	METAL RISERS	09 38 13	SHEET CARPETING
C	METAL SUBTREADS	09 38 13	WALL COVERINGS
D	PIPE AND TUBE RAILINGS	09 72 28	FABRIC WRAPPED PANELS
E	FABRICATED SPIRAL STAIRS	09 72 28	SOUND ABSORPTIVE CEILING CANOPIES
F	MISCELLANEOUS ROUGH CARPENTRY	09 72 28	EXTERIOR PAINTING
G	WOOD NAILERS & BLOCKING	09 81 14	EXTERIOR RE-PAINTING
H	SHEATHING	09 81 23	INTERIOR PAINTING
I	ORIENTED STRAND BOARD SHEATHING	10 11 00	VISUAL DISPLAY UNITS
J	GLASS-MAT GYPSUM SHEATHING	A	PORCELAIN ENAMEL MARKERSBOARDS
09 82 00	CEILING-SUPPORTED METAL FRAMING	B	VINYL FABRIC FACED CORE TACKBOARDS
A	STEEL SHIPS LADDOR	C	TACKABLE DISPLAY RAILS
B	STEEL SHIPS LADDOR	10 14 16	PLAQUES
C	STEEL SHIPS LADDOR	10 14 28	DIMENSIONAL LETTER SIGNAGE
D	STEEL SHIPS LADDOR	10 14 28	PANEL SIGNAGE
E	STEEL SHIPS LADDOR	10 14 28	MESSAGE BOARDS
F	STEEL SHIPS LADDOR	10 21 13	PLASTIC TOILET COMPARTMENTS
G	STEEL SHIPS LADDOR	10 21 28	GUBICLES (CURTAINS AND TRACKS)
H	STEEL SHIPS LADDOR	10 22 39	FOLDING PANEL PARTITIONS
I	STEEL SHIPS LADDOR	10 29 00	TOILET & BATH ACCESSORIES
J	STEEL SHIPS LADDOR	A	PAPER TOWEL DISPENSER
06 41 16	CABINET MATERIALS	B	SOAP DISPENSER
1	SOLID HARDWOOD LAMBER	C	FRAMED MIRRORS
2	PARTICLEBOARD	D	TOILET TISSUE DISPENSER
3	SOFTWOOD EXTERIOR-GRADE PLYWOOD	E	GRAB BARS
4	HARDWOOD PLYWOOD	F	SHOWER FOOT
5	HIGH - PRESSURE LAMINATE	G	SHOWER CURTAIN & HOOKS
6	SOLID - SURFACING MATERIAL	H	TOWEL BAR
7	HARDWARE & ACCESSORIES	I	SOAP DISH
8	KNOS & PULLS	J	HANDICAPPED SHOWER & TUB SEAT
9	DRAWER & DOOR LOCKS	K	MOP & BROOM HOLDER
10	SELF-STANCHIONS & SUPPORTS	L	ELECTRIC HAND DRYER
11	PLASTIC-LAMINATE FACED ARCHITECTURAL CABINETS	M	SURFACE MOUNTED SANITARY NAPKIN DISPOSAL
12	DRAWER & DOOR LOCKS	N	FIRE EXTINGUISHERS AND CABINETS
13	SELF-STANCHIONS & SUPPORTS	O	FIRE EXTINGUISHER CABINET
14	PLASTIC PANELING	P	SEMI - RECESSED
15	BUTYLUMINOUS DAMPROOFING	Q	SURFACE MOUNTED
16	SELF-ADHERING SHEET WATERPROOFING	R	METAL LOCKERS
17	HORIZONTAL SURFACE	S	CORRIDOR LOCKERS
18	VERTICAL SURFACE	T	KITCHEN LOCKERS
19	COLD FLUID - APPLIED WATERPROOFING	U	P.E. LOCKERS
20	THERMAL INSULATION	V	ATHLETIC LOCKERS
21	EXTRUDED POLYSTYRENE BOARD	W	LOCKER ROOM BENCHES
22	FOIL FACED POLYISOCYANURATE BOARD	X	METAL STORAGE SHELVING
23	UNFACED GLASS-FIBER BLANKETS	Y	POST & SHELF STORAGE UNITS
24	KRAFT FACED GLASS-FIBER BLANKETS	Z	PRE-FABRICATED COAT RACK
25	SOUND ATTENUATION BLANKETS	AA	WALKWAY AND CANOPY COVERS
26	MINERAL WOOL BLANKETS	AB	FABRIC AWNINGS
27	SPRAY POLYURETHANE FOAM	AC	FABRICATED SHEETERS
28	SELF-ADHERING SHEET AIR BARRIER	AD	GROUND - SET FLAGPOLES
29	POLYMER-BASED EPS	AE	BANNERS
30	WATER DRAINAGE GUTS	AF	FRAMING CONTROL EQUIPMENT
31	WEATHER BARRIERS	AG	LOADING DOCK BUMPER
32	ASPHALT SHINGLES	AH	RECESSED APPLIANCES
33	STANDING SEAM METAL ROOF PANELS	AI	COMBUSTIBLE EQUIPMENT & FURNISHINGS
A	ROOF PANELS	AJ	FOOD SERVICE EQUIPMENT
B	FLASHING & TRIM	AK	LIBRARY STACK SYSTEM
C	ROOF & RAKE CAP	AL	PROJECTION SCREENS
D	GUTTER	AM	LABORATORY FUME HOODS
E	DOWNSPOUT	AN	FOLDING & PORTABLE STAGES
F	ROOF CURBS	AO	STAGE CURTAINS
G	EXTRUDED POLYSTYRENE BOARD INSULATION	AP	THEATER RIGGING SYSTEMS
H	UNDERLAYMENT MATERIAL	AQ	ART ROOM EQUIPMENT
I	FORMED METAL WALL PANELS	AR	ATHLETIC EQUIPMENT
J	METAL COMPOSITE MATERIAL WALL PANELS	AS	BASKETBALL EQUIPMENT
07 42 13	METAL SOFT PANELS	AT	VOLLEYBALL EQUIPMENT
07 42 13	FIBER CEMENT SIDING	AV	SAFETY PADS
07 42 17	METAL SOFT PANELS	B	DIVIDER CURTAIN
07 42 17	METAL SOFT PANELS	C	SCOREBOARDS
07 42 17	METAL SOFT PANELS	D	HORIZONTAL LOUVER BLINDS
07 42 17	METAL SOFT PANELS	E	VERTICAL LOUVER BLINDS
07 42 17	METAL SOFT PANELS	F	ROLLER WINDOW SHADES
07 42 17	METAL SOFT PANELS	G	WOOD LIBRARY CASEWORK (CIRCULATION DESK)
07 42 17	METAL SOFT PANELS	H	DISPLAY CASEWORK
07 42 17	METAL SOFT PANELS	I	PLASTIC LAMINATE GLAZ LABORATORY CASEWORK
07 42 17	METAL SOFT PANELS	J	WOOD LABORATORY CASEWORK
07 42 17	METAL SOFT PANELS	K	ENTRANCE FLOOR MATS & FRAMES
07 42 17	METAL SOFT PANELS	L	FIXED AUDIENCE SEATING
07 42 17	METAL SOFT PANELS	M	TELESCOPING STANDS
07 42 17	METAL SOFT PANELS	N	METAL BUILDING SYSTEMS
07 42 17	METAL SOFT PANELS	O	PRIMARY FRAMING
07 42 17	METAL SOFT PANELS	P	END WALL FRAMING
07 42 17	METAL SOFT PANELS	Q	SECONDARY FRAMING
07 42 17	METAL SOFT PANELS	R	PURLINS
07 42 17	METAL SOFT PANELS	S	GIRTS
07 42 17	METAL SOFT PANELS	T	EAVE STRUTS
07 42 17	METAL SOFT PANELS	U	CANOPY FRAMING
07 42 17	METAL SOFT PANELS	V	ROOF PANELS
07 42 17	METAL SOFT PANELS	W	THERMAL SPACER BLOCK
07 42 17	METAL SOFT PANELS	X	BRICKING PLATE
07 42 17	METAL SOFT PANELS	Y	WALL PANELS
07 42 17	METAL SOFT PANELS	Z	WALL LINER PANELS
07 42 17	METAL SOFT PANELS	AA	SCOTT PANELS
07 42 17	METAL SOFT PANELS	AB	ACCESSORIES
07 42 17	METAL SOFT PANELS	AC	FLASHING & TRIM
07 42 17	METAL SOFT PANELS	AD	ROOF & RAKE CAP
07 42 17	METAL SOFT PANELS	AE	GUTTER
07 42 17	METAL SOFT PANELS	AF	DOWNSPOUT
07 42 17	METAL SOFT PANELS	AG	ROOF CURBS
07 42 17	METAL SOFT PANELS	AH	FLASHING
07 42 17	METAL SOFT PANELS	AI	PIPE FLASHING
07 42 17	METAL SOFT PANELS	AJ	CONJ. EAVE DENT
07 42 17	METAL SOFT PANELS	AK	WIND FACED GLASS-FIBER BLANKET INSULATION SYSTEM
07 42 17	METAL SOFT PANELS	AL	EXTRUDED POLYSTYRENE BOARD INSULATION
07 42 17	METAL SOFT PANELS	AM	UNDERLAYMENT MATERIAL
07 42 17	METAL SOFT PANELS	AN	ELECTRIC TRACTION ELEVATORS
07 42 17	METAL SOFT PANELS	AO	HYDRAULIC ELEVATORS
07 42 17	METAL SOFT PANELS	AP	LIMITED/UNLIMITED-APPLICATION ELEVATORS
07 42 17	METAL SOFT PANELS	AQ	WHEEL CHAIR LIFTS