

Order Plans @ [www.LDILine.com](http://www.LDILine.com)

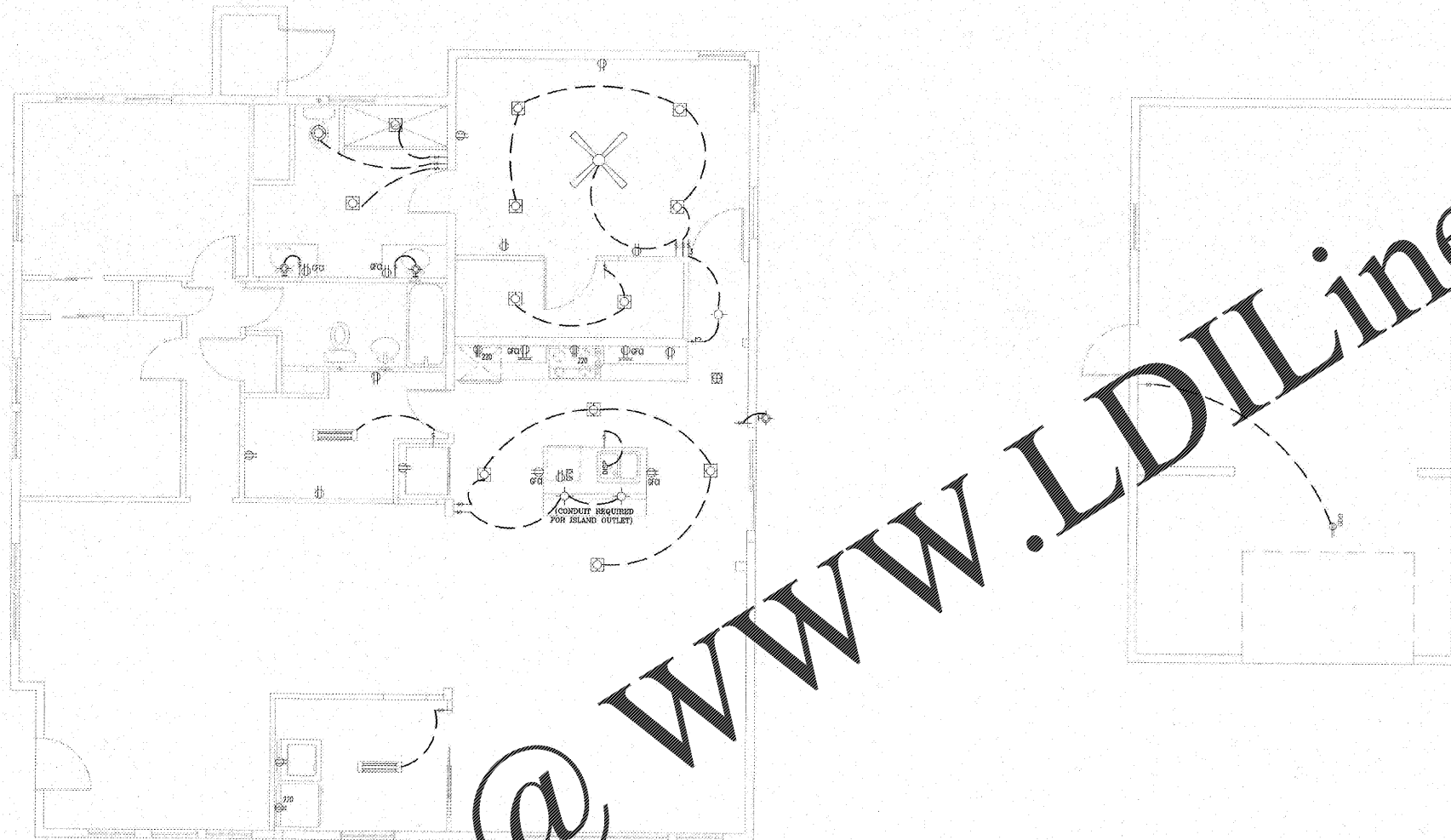

**ELECTRICAL FLOOR PLAN**

1/4"=1'-0"

NOTE: 100% OF ALL FIXED LIGHT FIXTURES INSIDE AND OUTSIDE HAVE CFL/LED LAMPS.

THE REQUIRED GFCI OUTLETS (DWELLING UNITS) BATHROOMS, KITCHEN COUNTERTOPS, OUTLETS WITHIN 6' OF LAUNDRY, UTILITY WET BAR SINKS, ACCORDING TO NEC 210.

FOR ATTICS, PROVIDE AT LEAST ONE LIGHTING OUTLET CONTAINING A SWITCH OR CONTROLLED BY A WALL SWITCH SHALL BE INSTALLED. AT LEAST ONE POINT OF CONTROL SHALL BE AT THE USUAL POINT OF ENTRY TO THESE SPACES NEC 210.70(A) (3)

AFCI PROTECTION - 210.12 (D) DWELLING UNITS, ALL 120 VOLT, SINGLE PHASE, 15 AND 20 AMP BRANCH CIRCUITS SUPPLYING OUTLETS INSTALLED IN DWELLING UNITS, FAMILY ROOMS, DINING ROOMS, LIVING ROOMS, PARLORS, LIBRARIES, DEN'S, BEDROOMS, SUNROOMS, RECREATION ROOMS, CLOSETS, HALLWAYS, OR SIMILAR ROOMS OR AREAS SHALL BE PROTECTED BY A LISTED AFCI COMBINATION TYPE, INSTALLED TO PROVIDE PROTECTION OF THE BRANCH CIRCUIT PER 210.12 (D)

NOTES:

-ALL OUTLETS ARE TAMPER RESISTANT

-LOCATION OF ELECTRIC OUTLETS ARE A REPRESENTATION ONLY. OUTLETS WILL BE LOCATED PER LOCAL BUILDING CODE.

ELECTRICAL LEGEND			
⊕	110V DUPLEX RCPT.	⊕	THERMOSTAT
⊕	NUMBER INDG. HGT. A.F.F.	⊕	PUSH BUTTON
⊕	110V 1 SIDE SWITCHED	⊕	CHIMES
⊕	WEATHER PROOF OUTLET	⊕	SPEAKER
⊕	110 FLOOR OUTLET	⊕	IRRIGATION
⊕	110V OUTLET ON GROUND FAULT CIRCUIT	⊕	INTERCOM PANEL
⊕	220V OUTLET	⊕	VOLUME CONTROL
⊕	GARAGE DOOR OPENER	⊕	TWO WAY SWITCH
⊕	DEDICATED OUTLET	⊕	THREE WAY SWITCH
⊕	JUNCTION BOX	⊕	FOUR WAY SWITCH
⊕	EXHAUST FAN	⊕	SWITCH w/ DIMMER
⊕	EXHAUST FANLIGHT	⊕	SWITCH w/ MOTION SENSOR
⊕	CEILING MTD LIGHT	⊕	CEILING FAN PRR-WIRE
⊕	WALL MTD LIGHT	⊕	FLOOD LIGHT
⊕	RECESSED LIGHT	⊕	CEILING FAN
⊕	RECESSED EYEBALL	⊕	CEILING FAN/LIGHT
⊕	RECESSED MOISTURE PROOF LIGHT	⊕	TRACK LIGHT
⊕	WALL SCONCE	⊕	PANEL
⊕	TELEPHONE OUTLET	⊕	2' x 4' FLOOR FIXTURE
⊕	WIRELESS ACCESS POINT	⊕	10' x 4' FLOOR FIXTURE
⊕	TELEPHONE MODEM LINE	⊕	TUBE LIGHT
⊕	TELEPHONE FLOOR OUTLET		
⊕	CABLE TV OUTLET		
⊕	SMOKE / CARBON DETECTOR		
⊕	ALARM KEYPAD		
⊕	SECURITY CAMERA		

**NOTE:**

- 1) ALL OUTLETS IN BEDROOM TO BE "A.F.I."
- 2) ALL EXTERIOR OUTLETS TO BE "G.F.I."
- 3) ALL ELECTRICAL WIRING TO BE IN ACCORDANCE WITH ARTICLE 86 OF NFPA 70A
- 4) NOTE: 100% HIGH EFFICIENCY LIGHTING
- 5) ALL 120 VOLT, SINGLE PHASE, 15 AND 20 AMP BRANCH CIRCUITS SUPPLYING OUTLETS INSTALLED IN DWELLING UNITS, FAMILY ROOMS, DINING ROOMS, LIVING ROOMS, PARLORS, LIBRARIES, DEN'S, BEDROOMS, SUNROOMS, RECREATION ROOMS, CLOSETS, HALLWAYS, OR SIMILAR ROOMS OR AREAS SHALL BE PROTECTED BY A LISTED AFCI COMBINATION TYPE, INSTALLED TO PROVIDE PROTECTION OF THE BRANCH CIRCUIT PER 210.12 (D)
- 6) VANITY LIGHTS AT 7'-4" ABOVE FINISHED FLOOR

REV. #	DESCRIPTION	DWG. DATE
1		
2		
3		
4		
5		

ELECTRICAL PLAN AND NOTES

RENOVATIONS AT  
500 ST JOHNS AVE.  
GREEN COVE SPRINGS, FLORIDA

DRAWN BY  
ACB

DATE  
12/10/2019

SCALE  
AS NOTED

DESIGNED BY  
DVL

JOB NO.  
TVC-20191121

SHEET No.  
E1 OF 1