



Consultant:

Project:

NEW SHOPPING CENTER FOR:  
**SANDBANKS LLC**  
REDEVELOPMENT  
U.S. 41, NAPLES, FL

© 2019  
GESHAAY ASSOCIATES, INC. EXPRESSLY RESERVES ITS  
COPYRIGHT AND OTHER PROPERTY RIGHTS FOR THESE  
DRAWINGS AND DESIGN(S), INCLUDING THEIR ORIGINAL  
PURPOSE AND SITE. THESE DRAWINGS MAY NOT BE  
REPRODUCED, CHANGED, REUSED OR COPIED WITHOUT  
WRITTEN CONSENT OF GESHAAY ASSOCIATES, INC. ANY  
ASSIGNMENT TO ANOTHER PARTY IS UNWARRANTED AND  
PROHIBITED.

Indicator	Date	Remarks/Revisions
△	4-26-19	ADDENDUM #1

Sign & Seal

Drawn by:	MG
Checked by:	JG
Date:	04/04/19
Project No.:	GA1700.15

A1.0

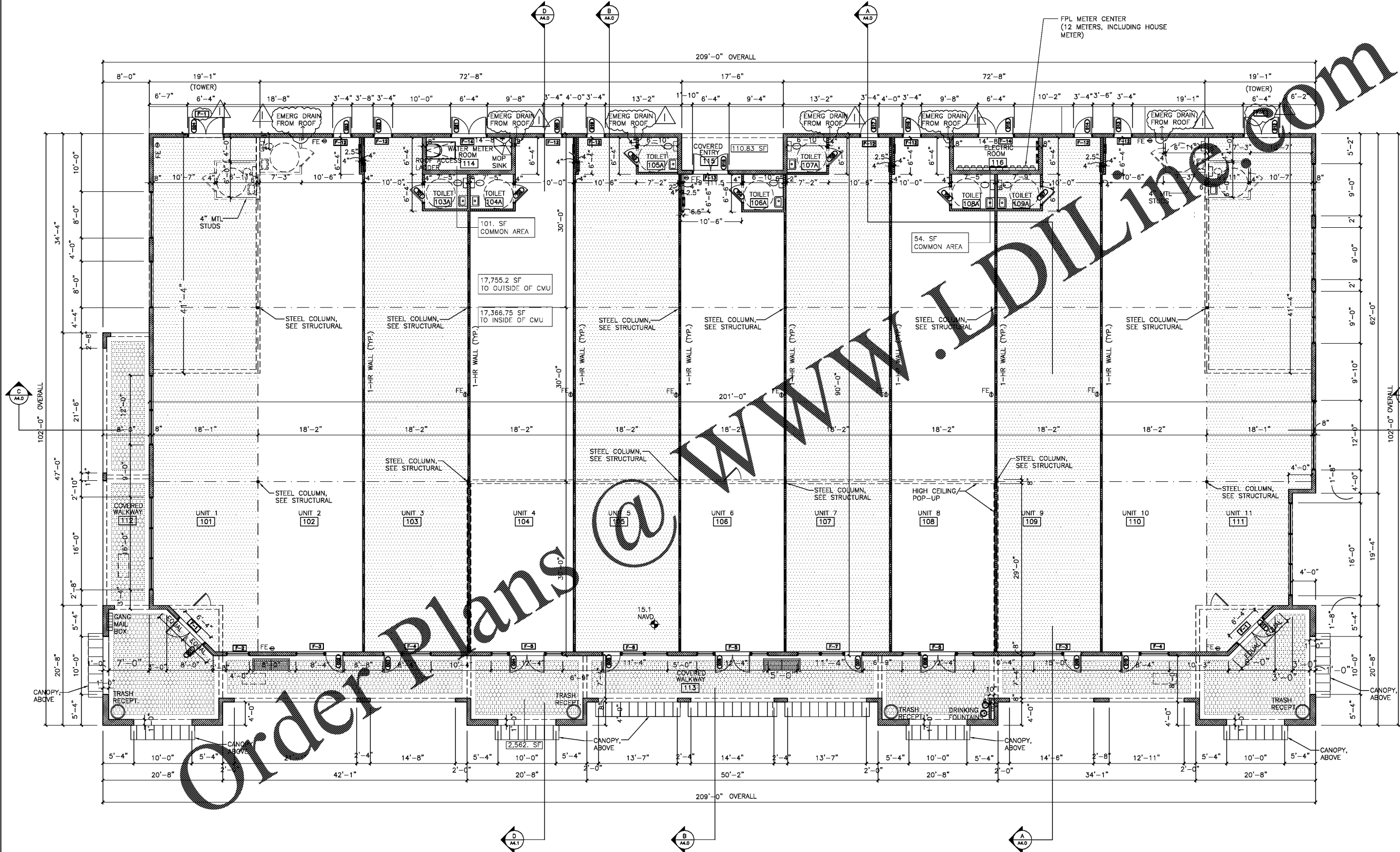

**FLOOR PLAN**  
SCALE: 1/8" = 1'-0"

SEE STRUCTURAL FOR COLUMNS, BEAMS.

⊙ FE INDICATES FIRE EXTINGUISHER ON BRACKET

NOTE: GC TO VERIFY ALL MASONRY OPENINGS FOR DOORS AND WINDOWS;  
COORDINATE WITH WINDOW AND DOOR MANUFACTURERS SPECIFICATIONS.

Order Plans @

WWW.IDILLINE.COM