

**TYPICAL FLOOR PLAN NOTES**

- AREAS OUTSIDE OF PROJECT SCOPE WITHIN EXISTING BUILDING (REPLACEMENT OF ROOFTOP HVAC SEPARATELY VESIP IN FIELD WORK NEEDED IN AREA).
- AREAS IN PROJECT SCOPE THAT ARE REPLACEMENT OF EXISTING FINISHES ONLY IN EXISTING BUILDING (REPLACEMENT OF ROOFTOP HVAC SEPARATELY).

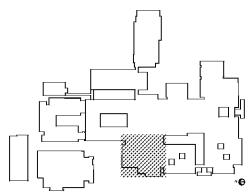

KEY PLAN

1 FIRST FLOOR FF&E PLAN - LEARNING COMMONS  
SCALE: 1/8" = 1'-0"

FF&E PLAN NOTES  
1. FURNITURE SHOWN FOR REFERENCE ONLY - NOT IN CONTRACT

**COOPER CARUSI COLLINS ARCHITECTS**  
3371 Peachtree Rd NE, Suite 400  
Atlanta, Georgia 30326  
404-873-0001

**COBB COUNTY SCHOOL DISTRICT**

**CAMPBELL HIGH SCHOOL PROJECT #B001 ADDITION/MODIFICATIONS**  
5265 WARD STREET NE  
SMYRNA, GEORGIA 30080  
GADOE FACILITY NUMBER: #633-1054  
CCCA #19002



THIS DRAWING IS THE EXCLUSIVE PROPERTY OF THE ARCHITECTS AND MAY NOT BE REPRODUCED OR USED WITHOUT THEIR WRITTEN AUTHORIZATION AND PERMISSION.

COPYRIGHT © 2020 COLLINS COOPER ARCHITECTS, INC.

**RELEASED FOR CONSTRUCTION**

- 03.19.2019 GADOE PRELIMINARY
- 05.08.2019 PRELIMINARY GADOE SCOPE CHANGE RESUBMITTAL
- 09.04.2019 GADOE CHECK SET
- 10.28.2019 FINAL PRICING SET
- 11.04.2019 RENOVATIONS PERMIT
- 11.04.2019 GA DOE FINAL SUBMITTAL
- 12.19.2019 PERMIT SET
- 01.06.2020 BID SET

NOTE: READ THE SPECIFICATIONS THIS SET OF DRAWINGS AND SPECIFICATIONS DEFINE PROJECT SCOPE AND CONTRACT REQUIREMENTS. INDIVIDUAL SHEETS SEPARATED FROM THE SET MAY NOT ACCURATELY REFLECT ALL INFORMATION NEEDED TO SUITABLY COVER CERTAIN ITEMS. DO NOT SEPARATE THIS SET OF DRAWINGS INTO INDIVIDUAL SHEETS.

**SHEET TITLE**  
FIRST FLOOR FF&E PLAN - LEARNING COMMONS

**AR-813**

BIM Server: \\server\cadd\plan - BIM Server 2019\plan\19002 CAD\Construction - Revit - 19020