



SIENNA LITE DECOR

ARCHITECT OF RECORD:	LITTLE PREPARED ARCHITECTURAL CONSULTING
REGISTERED ARCHITECT:	THOMAS B. LITTLE
REGISTERED ARCHITECT NO.:	20096
REGISTERED ARCHITECT STATE:	FLORIDA
REGISTERED ARCHITECT LICENSE:	20096
REGISTERED ARCHITECT LICENSE:	20096
REGISTERED ARCHITECT LICENSE:	20096
REGISTERED ARCHITECT LICENSE:	20096
REGISTERED ARCHITECT LICENSE:	20096
REGISTERED ARCHITECT LICENSE:	20096
REGISTERED ARCHITECT LICENSE:	20096
REGISTERED ARCHITECT LICENSE:	20096
REGISTERED ARCHITECT LICENSE:	20096

100% FOR CONSTRUCTION

10/16/2019

DATE

DESCRIPTION

DATE

DESCRIPTION

DATE

DESCRIPTION

DATE

DESCRIPTION

DATE

DESCRIPTION

DATE

DESCRIPTION

DATE

DESCRIPTION

DATE

DESCRIPTION

DATE

DESCRIPTION

DATE

DESCRIPTION

DATE

DESCRIPTION

DATE

DESCRIPTION

DATE

DESCRIPTION

Order Plans @ WWW.LITTLEONLINE.COM

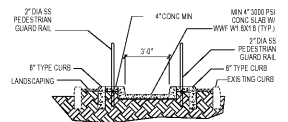

4 TYPICAL CART CORRAL SECTION
SP1.1 NTS

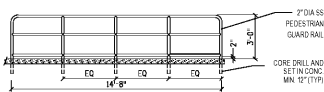

3 TYPICAL CART CORRAL GUARDRAIL ELEVATION
SP1.1 NTS

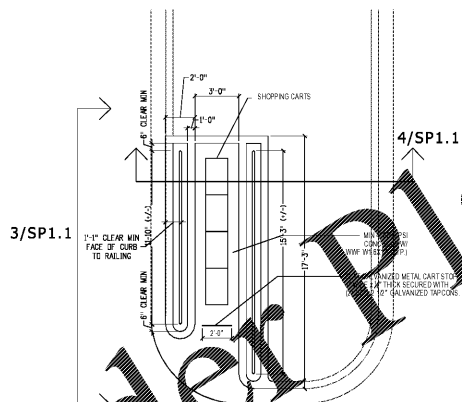

2 TYPICAL CART CORRAL
NTS

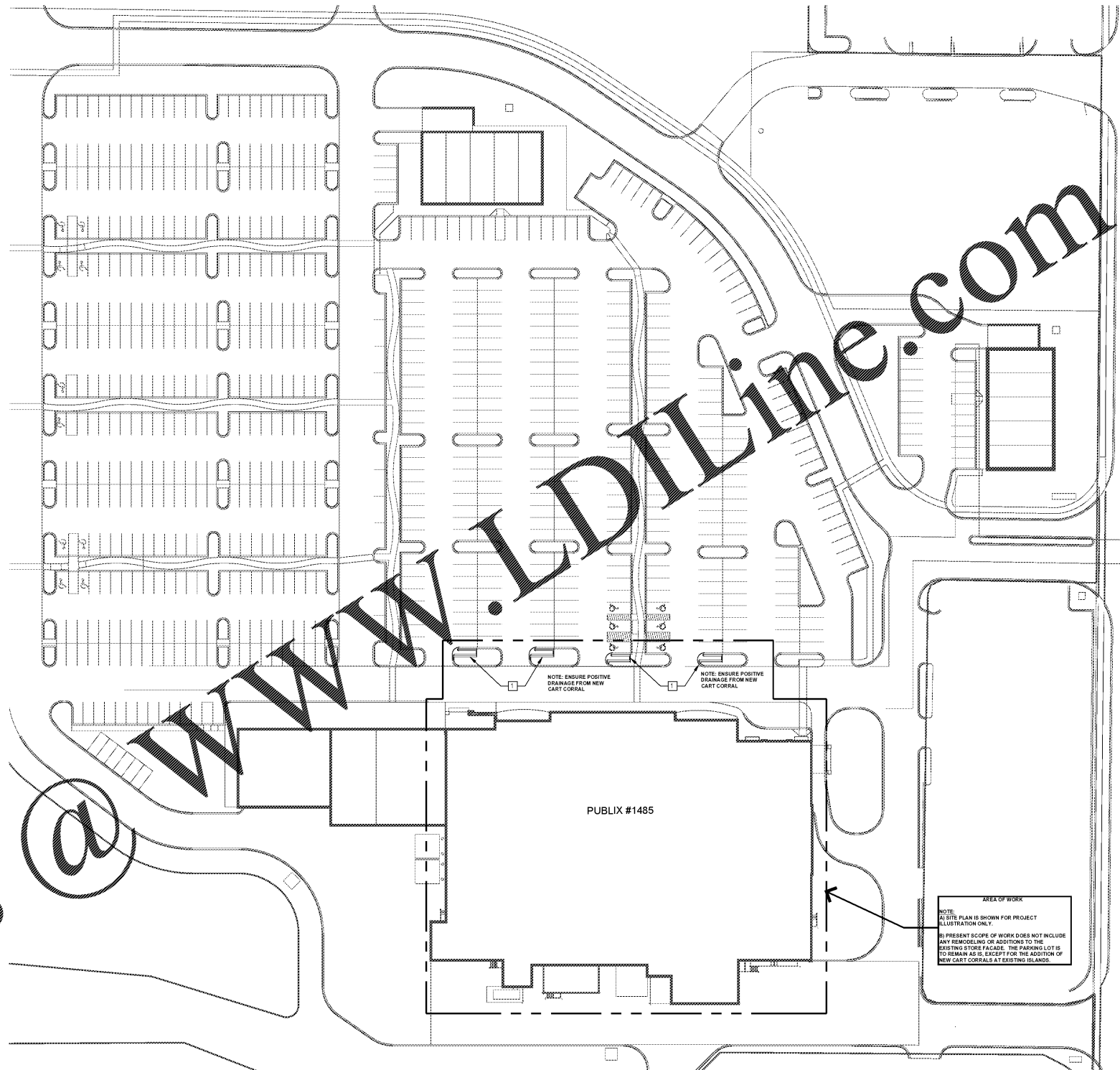

1 LOCATION PLAN (FOR REFERENCE ONLY)
SP1.1 NTS

NOTE:
A) SITE PLAN IS SHOWN FOR PROJECT ILLUSTRATION ONLY.
B) PRESENT SCOPE OF WORK DOES NOT INCLUDE ANY REMODELING OR ADDITIONS TO THE EXISTING STORE FACADE. THE PARKING LOT IS TO REMAIN AS IS, EXCEPT FOR THE ADDITION OF NEW CART CORRALS AT EXISTING ISLANDS.

<p>GENERAL NOTES:</p> <p>A. CONTRACTOR IS TO FIELD VERIFY ALL EXISTING CONDITIONS. CONTRACTOR SHALL PATCH AND REPAIR EXISTING CONSTRUCTION DAMAGED DURING WORK INSIDE OR OUTSIDE THE BUILDING. REPAIRS SHALL MATCH EXISTING FINISHES.</p> <p>B. CONFLICTS BETWEEN EXISTING CONDITIONS AND WHAT IS SHOWN ON THIS PLAN SHALL BE BROUGHT TO THE ARCHITECT'S ATTENTION IMMEDIATELY.</p> <p>C. THIS DRAWING IS AN ADAPTATION FROM AN OWNER SUPPLIED SITE SURVEY PREPARED BY PARADEISE CONSULTING GROUP 1775 SOUTH 10TH STREET, SUITE 100, LAUREL, FL 32806. THIS SITE PLAN IS TO BE USED FOR REFERENCE OF NEW WORK ONLY.</p> <p>D. STORE IS LEASED. LANDLORD SHALL BE RESPONSIBLE FOR THE REMOVAL OF BARRIERS TO ACCESSIBILITY AS REQUIRED BY APPLICABLE REGULATIONS.</p> <p>E. INFORMATION SHOWN HERE IS EXISTING UNLESS SPECIFICALLY NOTED OTHERWISE. FIELD VERIFY LOCATIONS OF ALL EXISTING COMPONENTS.</p>	<p>LOCATION PLAN KEY NOTES:</p> <p>NOTE: ONLY NUMBERED KEY NOTES APPLY TO THIS STORE.</p> <p>1 NEW CART CORRAL. REF. 2/SP1.1 FOR DETAILS</p>	<p>LOCATION PLAN LEGEND:</p> <p>KEY NOTE</p> <p>INDICATES EXTENT AREA LIMITS OF WORK</p>
--	---	---

