

Order Plans @ [www.LDILine.com](http://www.LDILine.com)

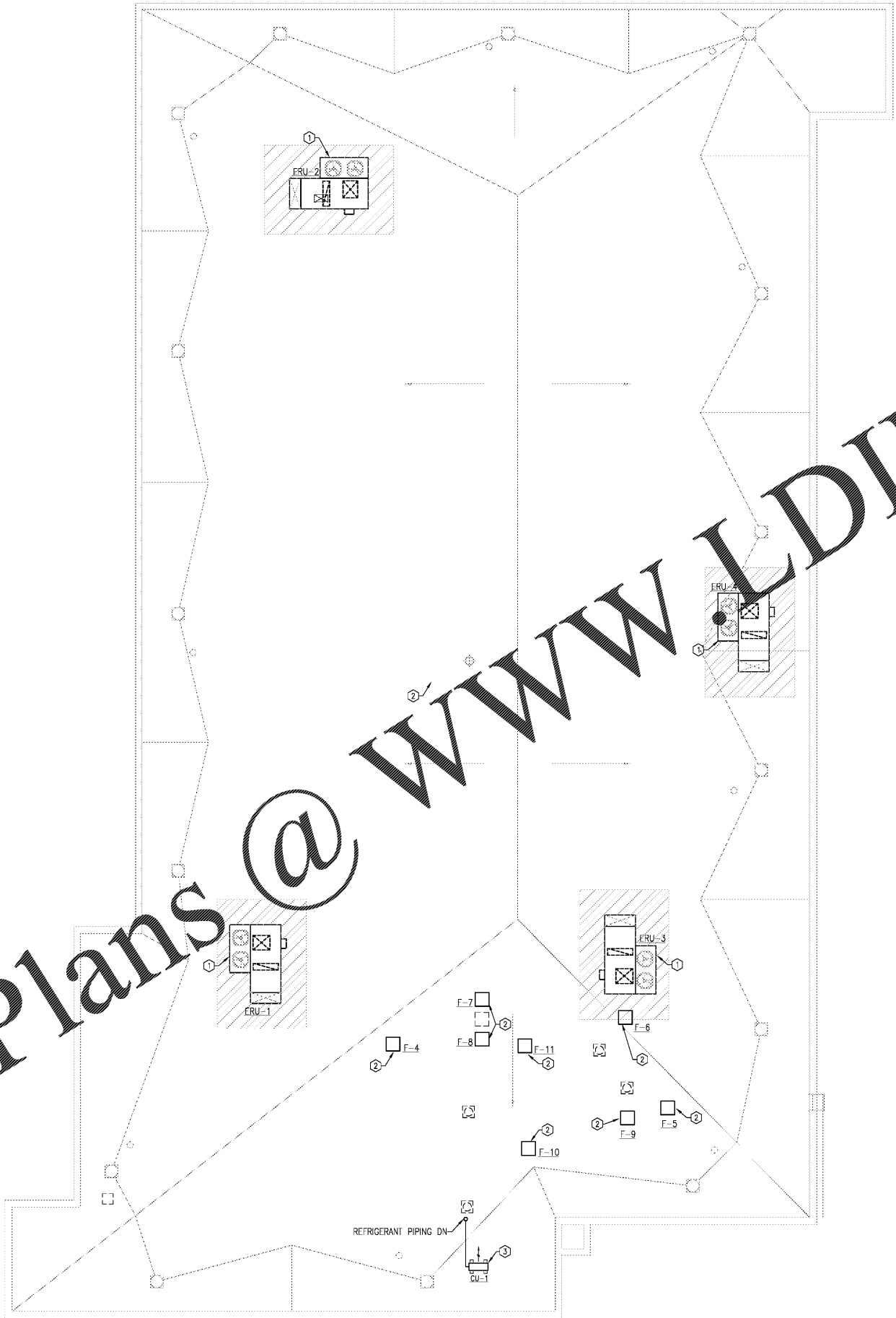

1 ROOF HVAC NEW WORK PLAN  
W2.13 SCALE: 1/8" = 1'-0"

**GENERAL NOTES**

1. SEE SHEET M0.1 FOR HVAC NOTES.

**KEY NOTES**

- ① NEW ENERGY RECOVERY UNIT. SEE SCHEDULE ON M5.01.
- ② NEW EXHAUST FAN. SEE SCHEDULE ON M5.01.
- ③ NEW MULTI-SPLIT SPLIT SYSTEM CONDENSING UNIT. RE-USE EXISTING ROOF PENETRATION FOR REFRIGERATION PIPING. PROVIDE NEW PIPE PORTALS AND FLASHING COVER.

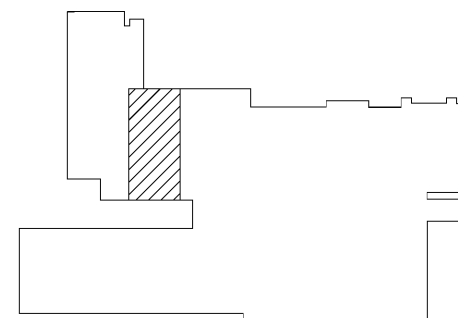

KEY PLAN



**COPYRIGHT OWNERSHIP:**  
The drawings are the property of Foreman Seeley Fountain Architecture and may not be used, copied or revised without expressed written permission.  
© 2019

Revisions:

No.	Description

**MEADOWCREEK HIGH SCHOOL  
HVAC and Roofing Renovations**  
4455 Steve Reynolds Blvd.  
Norcross, GA 30093

**FOREMAN | SEELEY | FOUNTAIN  
architecture**  
3091 Governors Lane Drive, Suite 150, Peachtree Corners, Georgia, 30071  
(770) 729-8433 Fax: (770) 729-8468  
[www.FSArchitecture.com](http://www.FSArchitecture.com)

Sheet Title: BUILDING 5011 - ROOF HVAC NEW WORK PLAN  
Drawn By: GBP  
Scale: AS NOTED  
Date: 12/20/19  
Job No.: 1911  
Sheet No.:

**M2.13**