

305 N. Chippewa Street
Lumberton, NC 28358
Office: (910) 671-9530
Fax: (910) 618-0838

Email:
andersonengineeringpa@gmail.com
Licensure #: C-0793

BUILDING PLANS FOR
COPART

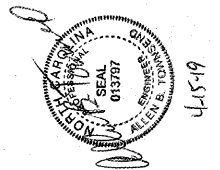

This creation of authorship contained in this drawing including but not limited to all design, text, specifications and drawings, are owned, except as otherwise expressly stated, by Anderson Engineering & Associates, P.A. and are protected by copyright and other intellectual property laws. This drawing may not be copied, reproduced, transmitted, displayed, distributed, sub-licensed, altered, utilized for other projects or otherwise used in any manner without the prior written consent of Anderson Engineering & Associates, P.A., except to the extent that such use constitutes "fair use" under the Copyright Act of 1976 (17 U.S.C. §107), as amended. Product owner may keep one un-altered permanent copy to be used for historical project use only.

POWER PLAN

PERMIT SET

ISSUE DATE: 1-18-2019

NO.	DATE	REASON
1	2-13-2019	OWNER REVIEW
2	4-10-2019	REDUCE BUILDING SIZE
3	4-10-2019	SCOPE VERIFICATION CONTRACT DOCS. GARAGE DOOR MOTORS

SCALE: 1/8"=1'
DRAWN BY: DJ
CHECKED BY: LWA
PROJECT NO.: 60-1656
DRAWING FILE: 1656
FILE NO.: 1656-BLDG-REV1
SHEET NO.:

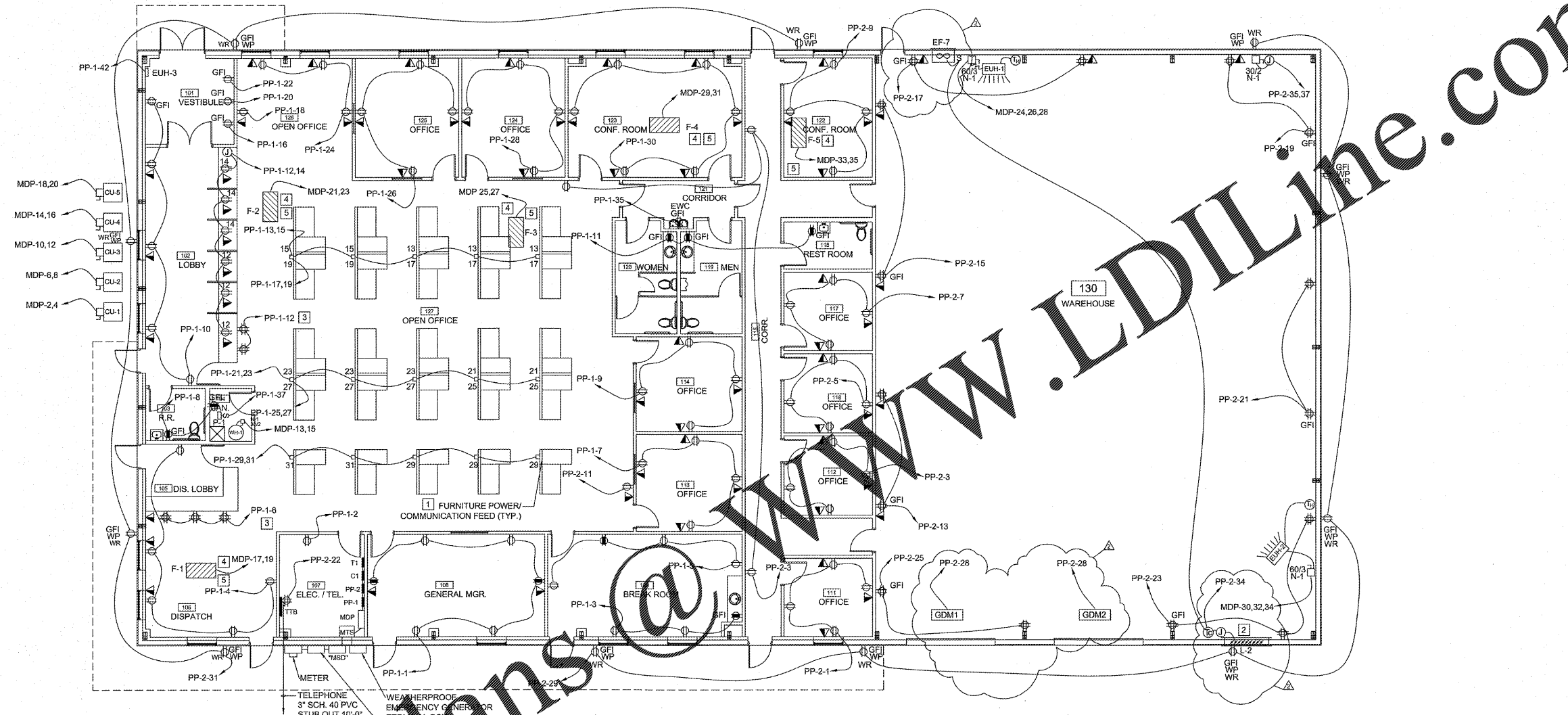

- #### GENERAL POWER NOTES
- SEE EQUIPMENT DATA SHEETS FOR ADDITIONAL INFORMATION ON MECHANICAL EQUIPMENT CIRCUITRY.
 - COORDINATE OUTLET LOCATIONS WITH OWNER'S FURNITURE LAYOUT.
 - FOR BRANCH CIRCUIT RUNS LONGER THAN 100 FT. USE #10 WIRING.

- #### KEYED POWER NOTES
- FURNITURE POWER / COMMUNICATION FEED FROM WALL OR POWER POLE. COORDINATE TYPE AND EXACT LOCATION WITH FURNITURE VENDOR. ELECTRICIAN TO COORDINATE WITH IT DRAWINGS FOR QUANTITY AND SIZE OF CABLES.
 - FIXED LOUVER WITH TRANSFORMER, LOW VOLTAGE ACTUATOR AND MOTORIZED DAMPER WITH SPRING RETURN DAMPERS, E.C. SHALL PROVIDE 120V /1PH SERVICE TO TRANSFORMER. DAMPER INTERLOCKED WITH EXHAUST FAN EF-7 THRU (C). SEE ELECTRICAL ROUNTER ELEVATIONS THIS SHEET FOR MORE DETAIL.
 - PROVIDE A 20A, 120 VOLT, DISCONNECT FOR FURNACE.
 - PROVIDE A KEYLESS LAMP HOLDER WITH 15W LED LAMP AND BUILT-IN 3-PRONG RECEPTACLE FOR MAINTENANCE ON FURNACES.

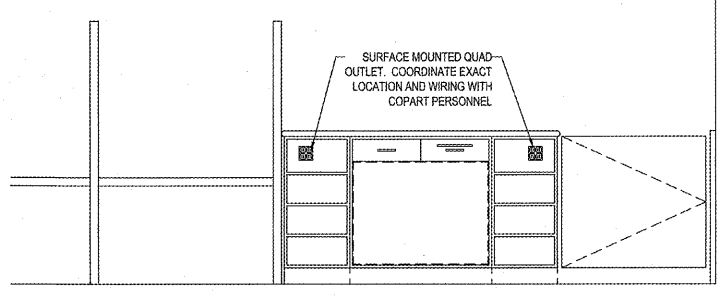

ELECTRICAL COUNTER ELEVATION - OPEN OFFICE

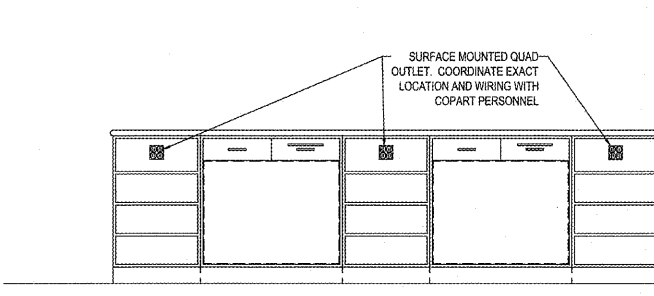

ELECTRICAL COUNTER ELEVATION - DISPATCH COUNTER

Order Plans @ WWW.LDILine.com

© 2019 Anderson Engineering & Associates, P.A.

E102