

**FLOOR PLAN GENERAL NOTES:**

- REFER TO SHEET E-0.1 ELECTRICAL SYMBOLS, ABBREVIATIONS, AND ADDITIONAL PROJECT NOTES.
- ALL DEVICES MOUNTED ON EXISTING WALLS SHALL REMAIN IN PLACE AND CONNECTED TO EXISTING POWER SOURCE, UNLESS NOTED OTHERWISE ON PLANS.

**C1 1ST FLOOR LIGHTING RENO ALTERNATE PLAN**  
3/16" = 1'-0"

**FLOOR PLAN KEY NOTES:**

- 01 PROVIDE NEW LIGHT FIXTURE PER LIGHTING FIXTURE SCHEDULE, LOCATED AS SHOWN. CONNECT TO EXISTING LIGHTING CIRCUIT RETAINED FROM DEMOLITION PHASE. FEED CIRCUIT THRU LIGHTING CONTACTOR "LC1". REFER TO SHEET E-2.4 FOR LOCATION OF "LC1".
- 02 PROVIDE NEW EXIT SIGN ABOVE DOOR. CONNECT UNSWITCHED TO NORMAL CIRCUIT FEEDING CEILING FIXTURES IN THIS SPACE.
- 03 PROVIDE SINGLE POLE WALL SWITCH TO OVER-RIDE LIGHTING CONTACTOR FOR MANUAL CONTROL OF OPEN SPACE LIGHT FIXTURES.
- 04 PROVIDE WALL MOUNTED OCCUPANCY SENSOR AT APPROXIMATELY 12'-0" AFF FOR AUTOMATED CONTROL OF LIGHT FIXTURES IN OPEN AREAS. SENSOR SHALL BE EQUAL TO HUBBELL MODEL LODTRPQT1. REFER TO DETAIL ON SHEET E-3.2.
- 05 PROVIDE RECESSED UNDERCOUNTER FIXTURE BELOW UPPER CABINET. PROVIDE SINGLE POLE TOGGLE SWITCH ABOVE COUNTER TO CONTROL FIXTURE.
- 06 PROVIDE NEW RECESSED, SINGLE POLE LIGHT SWITCH. CONNECT TO EXISTING FIXTURES.
- 07 PROVIDE NEW CEILING MOUNTED FIRE ALARM VISUAL DEVICE. CONNECT TO EXISTING FIRST FLOOR FIRE ALARM NOTIFICATION CIRCUIT.

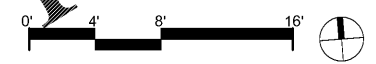

**RATED ASSEMBLIES LEGEND:**

NOTES: RATINGS ARE NOT SHOWN THROUGH DOORS FOR CLARITY. SEE A-0.1 FOR PARTITION TYPES. SEE LIFE SAFETY PLANS ON T-2.1 AND T-2.2 FOR FULL EXTENT OF RATINGS, INCLUDING HORIZONTAL RATINGS. RATINGS ARE CONTINUOUS AROUND OPENINGS AND OPENINGS ARE TO BE PROTECTED IN ACCORDANCE WITH THE NC STATE BUILDING CODE. PROTECT ALL PENETRATIONS.

SEE T-SHEETS FOR UL RATINGS AND ADDITIONAL INFORMATION.

- 1-HR RATED FIRE BARRIER
- 2-HR RATED FIRE BARRIER
- SMOKE RESISTANT WALL
- NEW SMOKE RESISTANT WALL

**KEY PLAN**

FIRST FLOOR = NTS

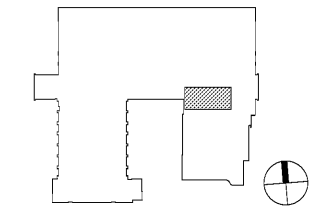

**Davis Kone**  
ARCHITECTS, P.A.  
ARCHITECTURE - PLANNING - INTERIORS  
503 300 0800 / 503 300 0801  
919 833 3737 - WWW.DAVISKONE.COM

**Sigma**  
Sigma Engineering Solutions, P.C.  
2100 Gateway Center Drive  
Suite 307  
Morrisville, NC 27560  
Tel: 919.662.0500  
Fax: 919.662.6933  
www.sigmaproject.com  
North Carolina License # C-24682  
Sigma Project # 19227

**UNCG ATHLETICS  
COLEMAN BUILDING  
WEIGHT ROOM**  
SCO ID No. 19 - 20597 - 01A | Code: 41825 | Item: 304  
1408 Walker Ave. Greensboro, NC 27402

**REGINALD D. ADAMS**  
REGISTERED PROFESSIONAL ARCHITECT  
1965

10-18-19

**DKA JOB NUMBER**  
1915

REVISIONS

These drawings are the property of Davis Kone Architects, P.A. They may not be reused for any purpose without written permission.  
Copyright © 2019 by Davis Kone Architects, P.A. All rights reserved.  
PE: REGINALD D. ADAMS  
PM: PJR  
Drawn By: SDR  
Plot Date: 10/23/2019 3:37:48 PM

**DATE ISSUED**  
BID DOCUMENTS  
10/22/2019

**SHEET TITLE**  
FIRST FLOOR  
LIGHTING RENO  
ALTERNATE PLAN  
**E-8.1**