

FLOOR PLAN GENERAL NOTES:

1. REFER TO SHEET FP-0.1 FOR GENERAL NOTES.

1 2ND FLOOR FIRE DEMO ALTERNATE PLAN
3/16" = 1'-0"

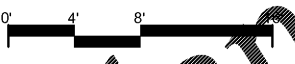

FLOOR PLAN KEY NOTES:

NOTE: NOT ALL KEY NOTES BELOW ARE APPLICABLE TO THIS SHEET. KEY NOTES SUPPLEMENT INFORMATION FOUND ELSEWHERE IN THE DRAWING. SEE SHEET FP-0.1 FOR FIRE PROTECTION GENERAL NOTES, LEGENDS, AND ADDITIONAL REQUIREMENTS.

- (01) EXISTING SPRINKLER PIPE BRANCH/MAIN CONTIGUES TO EXISTING SPRINKLERS. REFERENCE EXISTING AS-BUILT DOCUMENT FOR CONTINUATION.
- (02) EXISTING SPRINKLER PIPE MAIN CONTIGUES TO EXISTING FLOOR CONTROL ASSEMBLY. REFERENCE FP-1 FOR CONTINUATION.
- (03) DEMOLISH SPRINKLER BACKFLOW POINT AND DISCONNECT SHOWN. REFERENCE NETWORK FOR RELOCATION AND CONNECTION.

RATED ASSEMBLIES LEGEND:

NOTES: RATINGS ARE NOT SHOWN THROUGH DOORS FOR CLARITY. SEE A-0.1 FOR PARTITION TYPES. SEE LIFE SAFETY PLANS ON T-2.1 AND T-2.2 FOR FULL EXTENT OF RATINGS, INCLUDING HORIZONTAL RATINGS. RATINGS ARE CONTINUOUS AROUND OPENINGS AND OPENINGS ARE TO BE PROTECTED IN ACCORDANCE WITH THE NC STATE BUILDING CODE. PROTECT ALL PENETRATIONS.

- SEE T-SHEETS FOR UL RATINGS AND ADDITIONAL INFORMATION.
- [Symbol] 1-HR RATED FIRE BARRIER
- [Symbol] 2-HR RATED FIRE BARRIER
- [Symbol] SMOKE RESISTANT WALL
- [Symbol] NEW SMOKE RESISTANT WALL

KEY PLAN

SECOND FLOOR = NTS

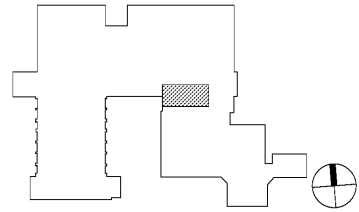

Davis Kone
ARCHITECTS, P.A.
ARCHITECTURE · PLANNING · INTERIORS
505 300 BERLIN ROAD, RALEIGH, NC 27605
919.833.3737 · WWW.DAVISKONE.COM

Sigma
Sigma Engineering Solutions, P.C.
2100 Gateway Center Drive
Suite 307
Morrisville, NC 27560
Tel: 919.660.2900
Fax: 919.542.6593
www.sigmaproject.com
North Carolina License # C-24660
Sigma Project # 19227

**UNCG ATHLETICS
COLEMAN BUILDING
WEIGHT ROOM**
SCO ID No. 19 - 20597 - 01A | Code: 41825 | Item: 304
1408 Walker Ave. Greensboro, NC 27402

SEALS

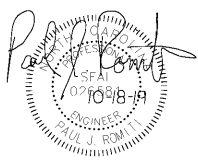

DKA JOB NUMBER
1915

REVISIONS

These drawings are the property of Davis Kone Architects, P.A. They may not be re-used for any purpose without written permission.
Copyright © 2019 by Davis Kone Architects, P.A. All rights reserved.

PE: PAUL J. ROMITI
PM: PJR
Drawn By: JRE
Plot Date: 10/23/2019 3:31:02 PM

DATE ISSUED

BID DOCUMENTS
10/22/2019

SHEET TITLE
SECOND FLOOR
FIRE PROTECTION
DEMO ALTERNATE
FP-8.2