

C1 1ST FLOOR - EQUIPMENT PLAN (ALTERNATE)
3/16" = 1'-0"

Order Plans @

WWW.LDILLINE.COM

FURNITURE, FIXTURES, AND EQUIPMENT LEGEND

- 01 MIRROR
- 02 DISHWASHER - NIC
- 03 FLAT PANEL DISPLAY, NIC
- 04 4X8 MARKERBOARD
- 05 RECORD BOARD - NIC
- 06 DRINK COOLER - NIC
- 07 GATORADE DISPENSER - NIC
- 08 TRASH PULL OUT
- 09 SOAP DISPENSER
- 10 PAPER TOWEL DISPENSER
- 11 MICROWAVE - NIC
- 12 ICEMAKER - NIC
- 13 MILK DISPENSER - NIC
- 14 GHD W/ HYPER COMBO
- 15 VERTICAL PLATE STORAGE TREE - NIC
- 16 BELT RACK / PITTSBURGH - NIC
- 17 DUMBBELL RACK WITH WHEELS - NIC
- 18 POWER LIFT RACK - NIC
- 19 CONIC INVERSE CURL - NIC
- 20 VERTICAL OLYMPIC / HEX BAR STORAGE - NIC
- 21 ATHLETIC ANCHORS - WALL MOUNTED SMALL - NIC
- 22 LAT PULLDOWN / LOW ROW - NIC
- 23 MULTIPLY BOXES - NIC
- 24 POWER SLED - NIC
- 25 FUNCTIONAL TRAINER - NIC
- 26 DUMBBELL RACK - NIC
- 27 UNI-LATERAL LEG PRESS - NIC
- 28 SLAM BALL / MED BALL RACK - NIC
- 29 KETTLE BELL RACK - NIC
- 30 AIR RUNNER TREADMILL - NIC
- 31 KEISER BIKE - NIC
- 32 ELLIPTICAL - NIC
- 33 P-TRAP COVER
- 34 NOT USED
- 35 METAL WIRE RACKS - 24"D X 48"W X 83"H
- 36 METAL WIRE RACKS - 12"D X 48"W X 83"H
- 37 ATHLETIC ANCHOR - WALL MOUNTED DOUBLE - NIC

RATED ASSEMBLIES LEGEND:

NOTES: RATINGS ARE NOT SHOWN THROUGH DOORS FOR CLARITY. SEE A-0.0 FOR PARTITION TYPES. SEE LIFE SAFETY PLANS ON T-2.1 - T-2.3 FOR FULL EXTENT OF RATINGS, INCLUDING HORIZONTAL RATINGS. RATINGS ARE CONTINUOUS AROUND OPENINGS AND OPENINGS ARE TO BE PROTECTED IN ACCORDANCE WITH THE NC STATE BUILDING CODE. PROTECT ALL PENETRATIONS.

SEE T-SHEETS FOR UL ASSEMBLIES AND ADDITIONAL INFORMATION.

- EXISTING 1-HR RATED FIRE BARRIER
- EXISTING 2-HR RATED FIRE BARRIER
- EXISTING SMOKE RESISTANT WALL
- NEW SMOKE RESISTANT WALL

KEY PLAN

FIRST FLOOR = NTS

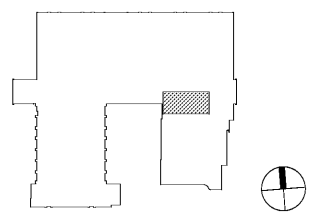

PROJECT INFORMATION

**UNCG ATHLETICS
COLEMAN BUILDING
WEIGHT ROOM**
SCO ID No. 19-20597-01A | Code: 41825 Item: 304
1408 Walker Ave., Greensboro, NC 27402

SEALS

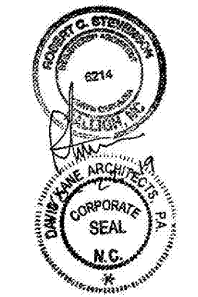

DKA JOB NUMBER

1915

REVISIONS

NO.	DESCRIPTION

These drawings are the property of Davis Kone Architects, P.A. They may not be used for any purpose without written permission. Copyright © 2019 by Davis Kone Architects, P.A. All rights reserved.

PA: RS
PM: SB
Drawn By: SB
Plot Date: 10/23/2019 4:25:18 PM

DATE ISSUED

BID DOCUMENTS
10/22/19

SHEET TITLE

FF&E PLAN 1ST FLOOR PLAN

I-2.1