

**C1** 1ST FLOOR - FINISHES PLAN  
3/16" = 1'-0"

**FINISHES PLAN NOTES:**

- SEE INTERIOR ELEVATIONS AND DETAILS FOR LOCATION OF CASEWORK AND WALL FINISH SELECTIONS NOT SHOWN ON PLAN.
- SEE A-0.0 FOR GENERAL PLAN & PARTITION NOTES.
- REFER TO A-0.0 FOR PARTITION CONSTRUCTION TYPE.
- SEE I-1.0 FOR INTERIOR FINISHES LEGEND AND ADDITIONAL FINISHES REQUIREMENTS.
- WHERE PAINT IS INDICATED ON LEGEND, PROVIDE THE FOLLOWING:
  - FINISH LOCATION
  - EGGSHELL GWB WALLS, UON.
  - SEMI-GLOSS MASONRY WALLS, UON.
  - SEMI-GLOSS INTERIOR FRAMES
  - FLAT GWB CEILINGS
- PAINT COLORS PROVIDED IN FINISHES LEGEND ARE FOR COLOR MATCH ONLY.
- ALL METAL COMPONENTS FOR MEZZANINE TO BE PAINT PS.
- RUBBER ATHLETIC FLOORING TO BE INSTALLED DOWNWARD TO COORDINATE INSTALLATION WITH OWNER'S VENDOR. FLOORING 5/8" THICK AND 2ND FLOOR IS TO BE 3/8" THICK.

**FINISHES SYMBOL LEGEND**

- FINISH SYMBOLS
- PT FLOORING
- WALL UON
- BASEUON
- PT ACCENT PAINT
- ST'A SIGN TYPE

**FINISHES KEY:**

- CARPET
- LUXURY VINYL TILE
- CONCRETE
- 2"x2" CERAMIC TILE
- ARF 1
- ARF 2
- TURF

**FINISHES KEY NOTES:**

NOTE: NOT ALL KEY NOTES BELOW ARE APPLICABLE TO THIS SHEET. KEY NOTES SUPPLEMENT INFORMATION FOUND ELSEWHERE IN THE DRAWINGS. SEE SHEET I-0.0 FOR FINISH LEGEND, DETAILS, AND ADDITIONAL REQUIREMENTS. SEE A-8.1 THROUGH A-8.4 AND I-8.1 THROUGH I-8.2 FOR ALTERNATE PLANS.

- 01 WALL BASE, FOR DETAIL REFER TO C1 / I-1.0
- 02 METAL THRESHOLD AT DOORWAY (RS1)
- 03 RUBBER THRESHOLD (RS)
- 04 PATCH VCT TO MATCH EXISTING AS INDICATED BY HATCH
- 05 PAINT ALL EXPOSED STEEL PARTS OF 1ST FLOOR INCLUDING RAILINGS, COLUMNS, BEAMS, SPRINGERS, ETC. PS
- 06 FLOOR HATCH TO COMPLETE UNDER COUNTERTOP. (ALTERNATE ONLY)
- 07 PATCH CERAMIC FLOORING TO MATCH EXISTING INCLUDING 2"x2" MOSAIC COVE BASE.
- 08 CUSTOM LOGO LAZER CUT INTO THE ATHLETIC RUBBER FLOORING ARF. (ALTERNATE ONLY)

**RATED ASSEMBLIES LEGEND:**

NOTES: RATINGS ARE NOT SHOWN THROUGH DOORS FOR CLARITY. SEE A-0.0 FOR PARTITION TYPES. SEE LIFE SAFETY PLANS ON T-2.1 - T-2.3 FOR FULL EXTENT OF RATINGS, INCLUDING HORIZONTAL RATINGS. RATINGS ARE CONTINUOUS AROUND OPENINGS AND OPENINGS ARE TO BE PROTECTED IN ACCORDANCE WITH THE NC STATE BUILDING CODE. PROTECT ALL PENETRATIONS.

- EXISTING 1-HR RATED FIRE BARRIER
- EXISTING 2-HR RATED FIRE BARRIER
- EXISTING SMOKE RESISTANT WALL
- EXISTING SMOKE RESISTANT WALL

**KEY PLAN**

FIRST FLOOR = NTS

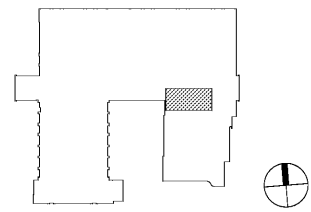

**PROJECT INFORMATION**

**UNCG ATHLETICS  
COLEMAN BUILDING  
WEIGHT ROOM**  
SCO ID No. 19-20597-01A | Code: 41825 Item: 304  
1408 Walker Ave., Greensboro, NC 27402

**SEALS**

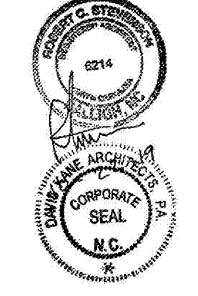

**DKA JOB NUMBER**

1915

**REVISIONS**

NO.	DESCRIPTION	DATE
1	REV 1	11/08/19

These drawings are the property of Davis Kone Architects, P.A. They may not be re-used for any purpose without written permission. Copyright © 2019 by Davis Kone Architects, P.A. All rights reserved.

PA: RS  
PM: SB  
Drawn By: SB  
Plot Date: 11/7/2019 2:47:37 PM

**DATE ISSUED**

BID DOCUMENTS  
10/22/19

**SHEET TITLE**

INTERIOR FINISHES  
1ST FLOOR PLAN  
**I-1.1**