

PROJECT INFORMATION

**UNCG ATHLETICS
 COLEMAN BUILDING
 WEIGHT ROOM**
 SCO ID No. 19-20597-01A | Code: 41825 Item: 304
 1408 Walker Ave., Greensboro, NC 27402

SEALS

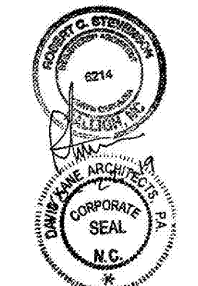

DKA JOB NUMBER

1915

REVISIONS

NO.	DESCRIPTION

These drawings are the property of Davis Kane Architects, P.A. They may not be reused for any purpose without written permission. Copyright © 2019 by Davis Kane Architects, P.A. All rights reserved.

PA: RS
 PM: SB
 Drawn By: JW
 Plot Date: 10/23/2019 3:58:39 PM

DATE ISSUED

BID DOCUMENTS

10/22/19

SHEET TITLE

WORK RESTRICTION PLANS

T-4.1

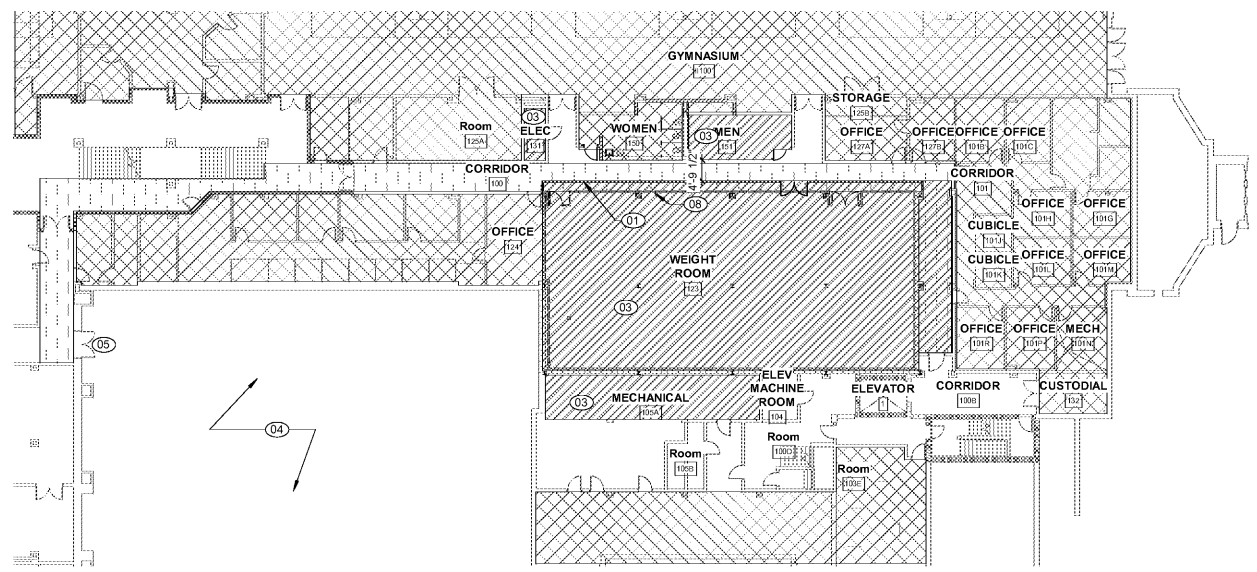

E1 1ST FLOOR AREA OF WORK
 1" = 20'-0"

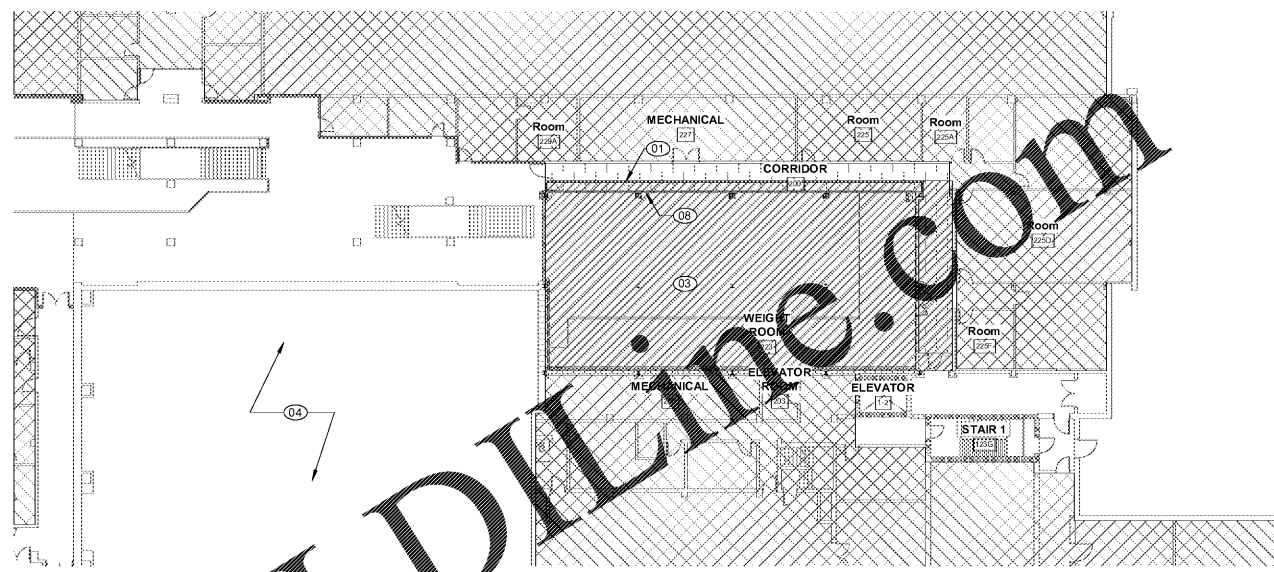

E2 2ND FLOOR AREA OF WORK
 1" = 20'-0"

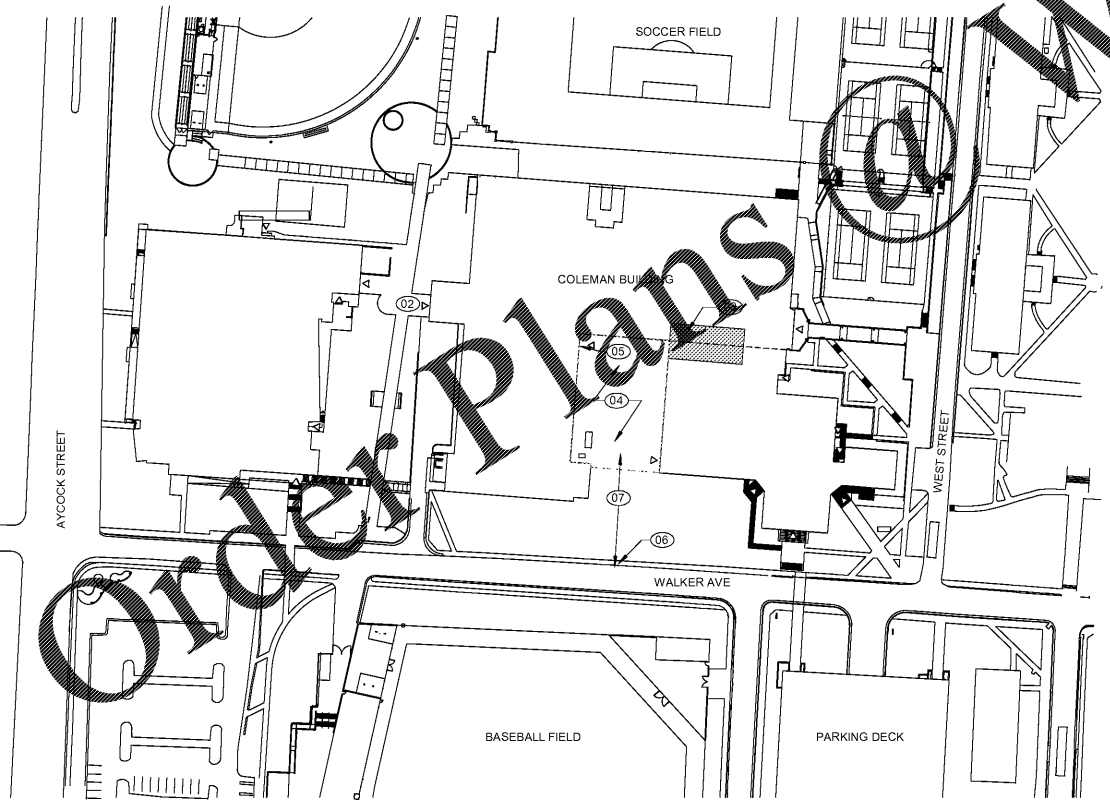

A1 WORK RESTRICTION SITE PLAN
 1" = 100'-0"

WORK RESTRICTION GENERAL NOTES:

- THE MAJORITY OF WORK SHALL OCCUR WITHIN THE DESIGNATED AREA OF WORK. MINIMAL WORK MAY OCCUR OUTSIDE THESE AREAS AS SUCH, WHICH MAY INCLUDE NEW FLOORING, PAINTING, AND NEW CEILINGS.
- ABSOLUTELY NO CONTRACTOR ACCESS IN THIS AREA. ANY DEVIATION FROM THESE REQUIREMENTS MUST BE REQUESTED IN WRITING BY THE CONTRACTOR AND WRITTEN APPROVAL MUST BE GRANTED BY THE ARCHITECT AND OWNER. EXTENTS DENOTED BY HATCH.
- DOORS AND CORRIDORS OUTSIDE AREA OF WORK WILL CONTINUE TO SERVE AS AN EXIT WAY FOR BUILDING OCCUPANTS DURING CONSTRUCTION. ENSURE AN UNOBSTRUCTED PATH TO EXIT IS MAINTAINED AT ALL TIMES. CONTRACTOR TO PROVIDE FLOOR PROTECTION THROUGHOUT DURATION OF CONSTRUCTION. FLOOR PROTECTION IS TO BE REMOVED DURING EVENTS. EXTENTS DENOTED BY HATCH.
- ALL AREAS AFFECTED BY CONSTRUCTION ACTIVITIES, INCLUDING THE CORRIDOR AND EXTERIOR AREAS SHALL BE MAINTAINED IN A NEAT AND ORDERLY MANNER. ALL AREAS SHALL BE THOROUGHLY CLEANED ON A DAILY BASIS. NO ACCUMULATION OF TRASH OR DEBRIS IS ALLOWED EXCEPT IN APPROVED WASTE CONTAINERS.
- WORK HOUR RESTRICTIONS ARE AS FOLLOWS: WORK ACTIVITIES MAY OCCUR MONDAY THROUGH FRIDAY 7:00 AM TO 6:00 PM. ALL WORK OCCURRING AFTER HOURS AND ON WEEKENDS MUST BE SCHEDULED WITH OWNER.
- ALL WORK SHALL BE PERFORMED WITH HIGHEST REGARD TO SAFETY OF BUILDING OCCUPANTS AND EMPLOYEES. TRANSPORT OF TOOLS AND MATERIALS MUST BE PERFORMED IN A MANNER THAT MAXIMIZES SAFETY AND MINIMIZES NOISE, DISRUPTION TO BUILDING OCCUPANTS, CONGESTION IN CORRIDORS AND OTHER SPACES USED BY BUILDING OCCUPANTS. MAINTAIN CLEAR, SAFE EGRESS PATHS AT ALL TIMES. MAINTAIN ACCESS TO EXISTING WALKWAYS, CORRIDORS AND OCCUPIED AREAS.
- ERECT PROTECTIVE MEASURES AROUND AREAS OF WORK TO PROTECT THE BUILDING FROM DIRT, DUST, ODORS AND DEBRIS. PROVIDE PROTECTIVE MEASURES INCLUDING PARTIAL SYSTEM ISOLATION FOR PLUMBING AND MECHANICAL SYSTEMS TO PREVENT UNWANTED TRANSFER OF DIRT, DUST, ODOR, DEBRIS AND ANY OTHER CONTAMINANTS BETWEEN AREAS OF WORK AND OTHER AREAS OF THE BUILDING. THE ARCHITECT AND OWNER WILL DETERMINE SUITABILITY OF PROTECTIVE MEASURES AND MAY REQUIRE ADDITIONAL MEASURES IF DEEMED NECESSARY TO INCREASE PROTECTION TO ACCEPTABLE LEVELS. ANY ADDITIONAL MEASURES REQUIRED ARE NOT JUSTIFIABLE CAUSE FOR A CHANGE ORDER. NOTIFY OWNER'S REPRESENTATIVE OF TIMES REQUIRED FOR PARTIAL HVAC SHUTDOWN.
- MATERIAL STORAGE MAY OCCUR ONLY WITHIN LOCKABLE CONFINES OF AREA OF WORK OR CONTRACTOR STAGING AREA. NO STORAGE IS ALLOWED IN CORRIDORS OR OTHER PARTS OF THE BUILDING OR GROUNDS.
- BUILDING WILL REMAIN OCCUPIED THROUGHOUT DEMOLITION AND CONSTRUCTION WORK. GENERAL CONTRACTOR TO MAINTAIN SERVICE OF FIRE ALARM SYSTEMS DURING THE WORK. NOTIFY OWNER'S REPRESENTATIVE 72 HOURS IN ADVANCE OF ANY WORK THAT MAY IMPACT FIRE ALARM SYSTEMS. PROTECT ALL FIRE ALARM DEVICES.
- A CONTRACTOR STAGING AREA (APPROX. 102 FT X 150 FT) WILL BE MADE AVAILABLE IN THE LOCATION SHOWN ON THE WORK RESTRICTIONS SITE PLAN FOR CONTRACTOR PARKING, MATERIAL STORAGE, TEMPORARY FACILITIES AND WASTE CONTAINERS. THE CONTRACTOR SHALL INSTALL A 6'-0" HIGH CHAINLINK FENCE WITH SCREEN ON THE INSIDE OF THE FENCE TO OBSCURE VISION INTO THE STAGING AREA. THE FENCE SHALL BE SUPPORTED ON GRADE WITHOUT ANCHORING POSTS INTO PAVEMENT, SIDEWALK, OR ANY OTHER EXISTING IMPERVIOUS SURFACE. PORTABLE TOILETS ARE TO BE LOCATED AS FAR AWAY FROM THE BUILDING AS POSSIBLE, LOCATION TO BE COORDINATED WITH OWNER PRIOR TO DELIVERY.

- PEDESTRIAN CIRCULATION PATHWAYS INCLUDING EGRESS AT MAIN CONSTRUCTION ACCESS DOOR MUST BE MAINTAINED AT ALL TIMES UNLESS NOTED OTHERWISE. SEE LIFE SAFETY PLANS FOR ADDITIONAL REQUIREMENTS.
- LAWN AREAS OF STAGING AREAS SHALL BE RETURNED TO PRE-CONSTRUCTION CONDITION IN CONJUNCTION WITH LANDSCAPE MANAGEMENT. SITE IS BE CLEAN OF ALL CONSTRUCTION DEBRIS AND EQUIPMENT INCLUDED NAILS.
- CONSTRUCTION ACCESS TO BUILDING WILL BE THROUGH THE 1ST FLOOR DOUBLE DOORS ADJACENT TO THE STAGING AREA AS INDICATED ON WORK RESTRICTIONS PLANS. USE OF ELEVATORS IS NOT ALLOWED. ABSOLUTELY NO ACCESS THROUGH GYMNASIUM.
- STEELSTRUCTURAL MEMBERS ARE PERMITTED TO BE BROUGHT INTO THE BUILDING THROUGH THE 1ST FLOOR WEST DOORS.
- WORK INDICATED TO OCCUR OUTSIDE OF THE AREA OF WORK SHALL BE SCHEDULED WITH THE OWNER NO LESS THAN FIVE DAYS PRIOR TO COMMENCEMENT OF THAT WORK ACTIVITY.
- DURING WORK ACTIVITIES ALL AREAS IN WHICH WORK IS OCCURRING MUST BE MONITORED BY THE GENERAL CONTRACTOR EMPLOYEE TO BE AT THE AREA OF WORK DURING THE ENTIRE TIME WORK IS OCCURRING. THE AREA OF WORK SHALL BE SECURED FROM UNAUTHORIZED ENTRY.
- IDENTIFICATION OF ALL CONTRACTOR EMPLOYEES WILL BE REQUIRED WITH PHOTO ID, CONTRACTOR LOGO, AND NAME ON ID BADGE TO BE WORN AT ALL TIMES. CONTRACTOR LOGO TO BE VISABLE ON SHIRT OR VEST.
- CONTRACTORS ARE NOT PERMITTED TO EAT LUNCH INSIDE THE BUILDING.
- TEMPORARY WALL (WORK RESTRICTIONS KEY NOTE 01) ERECTION AND EXISTING CMU WALL DEMOLITION CONSTRUCTION DURATION TO BE A THREE DAY MAX OVER A WEEKEND. COORDINATE WITH BASKETBALL SCHEDULE SO THAT NO GAMES OR EVENTS WILL OCCUR DURING THIS TIME.
- TEMPORARY WALL (WORK RESTRICTIONS KEY NOTE 08) TO BE INSTALLED AFTER CORRIDOR WALL DEMOLITION. TEMPORARY WALL (WORK RESTRICTIONS KEY NOTE 01) THAT IS TO BE RE

WORK RESTRICTION KEY NOTES:

- NOTE: SEE PLANS FOR KEVED ITEM LOCATIONS. KEY NOTES SUPPLEMENT INFORMATION FOUND IN THE DRAWINGS. NOT ALL KEYNOTES ARE USED ON THIS PLAN.
- 01 PROVIDE TEMPORARY WALL FLOOR TO DECK ABOVE MINIMUM CONSTRUCTION. 1/2" PLYWOOD ON WOOD STUDS 24" O.C. PROTECT FROM DUST PASSAGE WITH 6 MIL POLY. TAPE ALL EDGES.
 - 02 LOADING ACCESS FOR STEEL STRUCTURE ONLY.
 - 03 AREA OF WORK.
 - 04 STAGING AREA
 - 05 CONTRACTOR CONSTRUCTION ACCESS DOOR.
 - 06 CONTRACTOR IS TO ADD A RAMP AT CURB FOR VEHICLE ACCESS TO STAGING AREA. CURB TO BE REPAIRED IF DAMAGED DURING CONSTRUCTION.
 - 07 VEHICLE ACCESS DRIVE. LAWN AREAS SHALL BE RETURNED TO PRE-CONSTRUCTION CONDITION IN CONJUNCTION WITH LANDSCAPE MANAGEMENT
 - 08 PROVIDE TEMPORARY WALL FLOOR TO DECK ABOVE MINIMUM CONSTRUCTION. 1/2" PLYWOOD ON WOOD STUDS 24" O.C. PROTECT FROM DUST PASSAGE WITH 6 MIL POLY. TAPE ALL EDGES. WALL TO BE LOCATED IN EXISTING CORRIDOR WALL LOCATION AFTER DEMOLITION TO ALLOW FOR EXISTING CORRIDOR WIDTH.