

**PROJECT INFORMATION**

**UNCG ATHLETICS  
 COLEMAN BUILDING  
 WEIGHT ROOM**  
 SCO ID No. 19-20597-01A | Code: 41825 Item: 304  
 1408 Walker Ave., Greensboro, NC 27402

**SEALS**

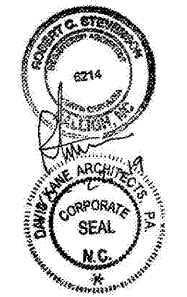

**DKA JOB NUMBER**

1915

**REVISIONS**

NO.	DESCRIPTION

These drawings are the property of Davis Kane Architects, P.A. They may not be used for any purpose without written permission. Copyright © 2019 by Davis Kane Architects, P.A. All rights reserved.

PA: RS  
 PM: SB  
 Drawn By: MS  
 Plot Date: 10/23/2019 3:58:31 PM

**DATE ISSUED**

BID DOCUMENTS  
 10/22/19

**SHEET TITLE**

LIFE SAFETY PLAN  
 THIRD FLOOR  
**T-2.3**

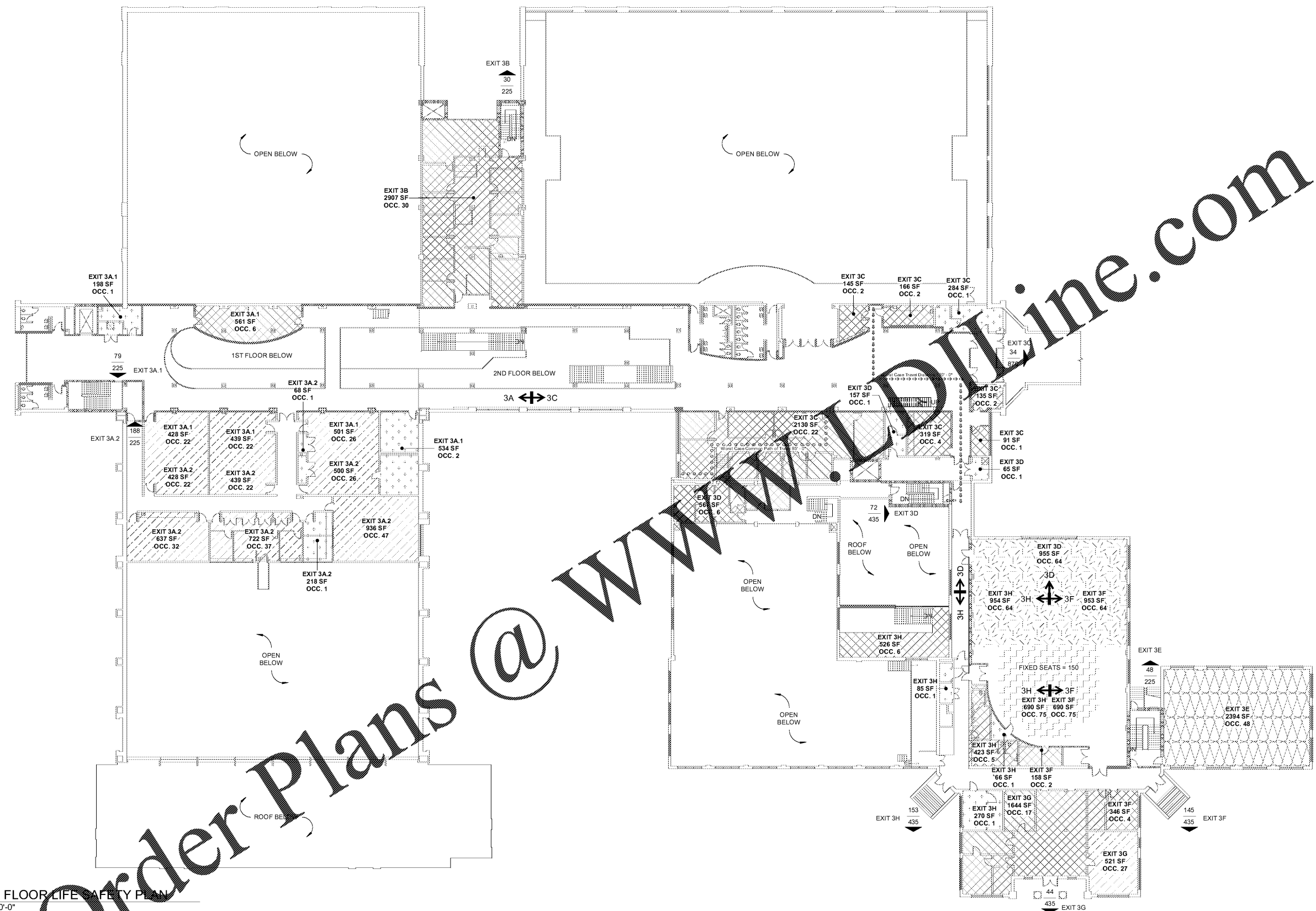

**B2 3RD FLOOR LIFE SAFETY PLAN**  
 1" = 20'-0"

- LIFE SAFETY GENERAL NOTES:**
- REFER TO SHEET T-1.2 FOR CODE SUMMARY.
  - REFER TO DOOR SCHEDULE FOR REQUIRED DOOR RATINGS.
  - REFER TO SITE PLAN FOR BUILDING ADJACENCIES AND PROPERTY LINES.
  - REFER TO FLOOR PLANS FOR FIRE EXTINGUISHER LOCATIONS.

**LIFE SAFETY SYMBOL LEGEND**

DENOTES EXIT DIRECTION ARROW, TYP.	WORST-CASE TRAVEL DISTANCE
INDICATES EXIT POPULATION	WORST CASE COMMON PATH OF TRAVEL
INDICATES EXIT CAPACITY (POPULATION)	INDICATES FIRE EXTINGUISHERS IN AREA OF WORK
DENOTES EXIT ACCESS	INDICATES PANIC HARDWARE IN AREA OF WORK
LOCATION WHERE TRAVEL DISTANCE TO 2 EXITS IS EQUIDISTANT	ROOM NAME
DEAD END CORRIDOR (1018.4- NO GREATER THAN 50' IN SPRINKLERED BUSINESS AND STORAGE)	ROOM NUMBER
EXIT LIGHT FIXTURE IN AREA OF WORK	EXIT AREA
EXIT DIRECTIONAL ARROW	OCCUPANT CAPACITY

**LIFE SAFETY OCCUPANCY KEY**

ACCESSORY STORAGE AREAS, MECHANICAL EQUIPMENT ROOM (300 SF/OCC. GROSS)	EDUCATIONAL CLASSROOM AREA (20 SF/OCC. NET)
ASSEMBLY CONCENTRATED (CHAIRS, NOT FIXED) (7 SF/OCC. NET)	EDUCATIONAL SHOPS & OTHER VOCATIONAL (50 SF/OCC. NET)
ASSEMBLY UNCONCENTRATED (TABLES & CHAIRS) (15 SF/OCC. NET)	EXERCISE ROOM (W/ EQUIPMENT) (50 SF/OCC. GROSS)
ASSEMBLY W/ FIXED SEATS	LOCKER ROOM (50 SF/OCC. GROSS)
BUSINESS AREAS (100 SF/OCC. GROSS)	STAGE (15 SF/OCC. NET)

**RATED ASSEMBLIES LEGEND:**

NOTES: RATINGS ARE NOT SHOWN THROUGH DOORS FOR CLARITY. SEE A-0.0 FOR PARTITION TYPES. SEE LIFE SAFETY PLANS ON T-2.1 - T-2.3 FOR FULL EXTENT OF RATINGS, INCLUDING HORIZONTAL RATINGS. RATINGS ARE CONTINUOUS AROUND OPENINGS AND OPENINGS ARE TO BE PROTECTED IN ACCORDANCE WITH THE NC STATE BUILDING CODE. PROTECT ALL PENETRATIONS.

SEE T-SHEETS FOR UL ASSEMBLIES AND ADDITIONAL INFORMATION.

	EXISTING 1-HR RATED FIRE BARRIER
	EXISTING 2-HR RATED FIRE BARRIER
	EXISTING SMOKE RESISTANT WALL
	NEW SMOKE RESISTANT WALL