

REVISIONS	
Δ REV 1	11/08/19

These drawings are the property of Davis Kone Architects, P.A. They may not be re-used for any purpose without written permission.
 Copyright © 2019 by Davis Kone Architects, P.A. All rights reserved.

PA: RS
 PM: SB
 Drawn By: MS
 Plot Date: 11/7/2019 2:23:05 PM

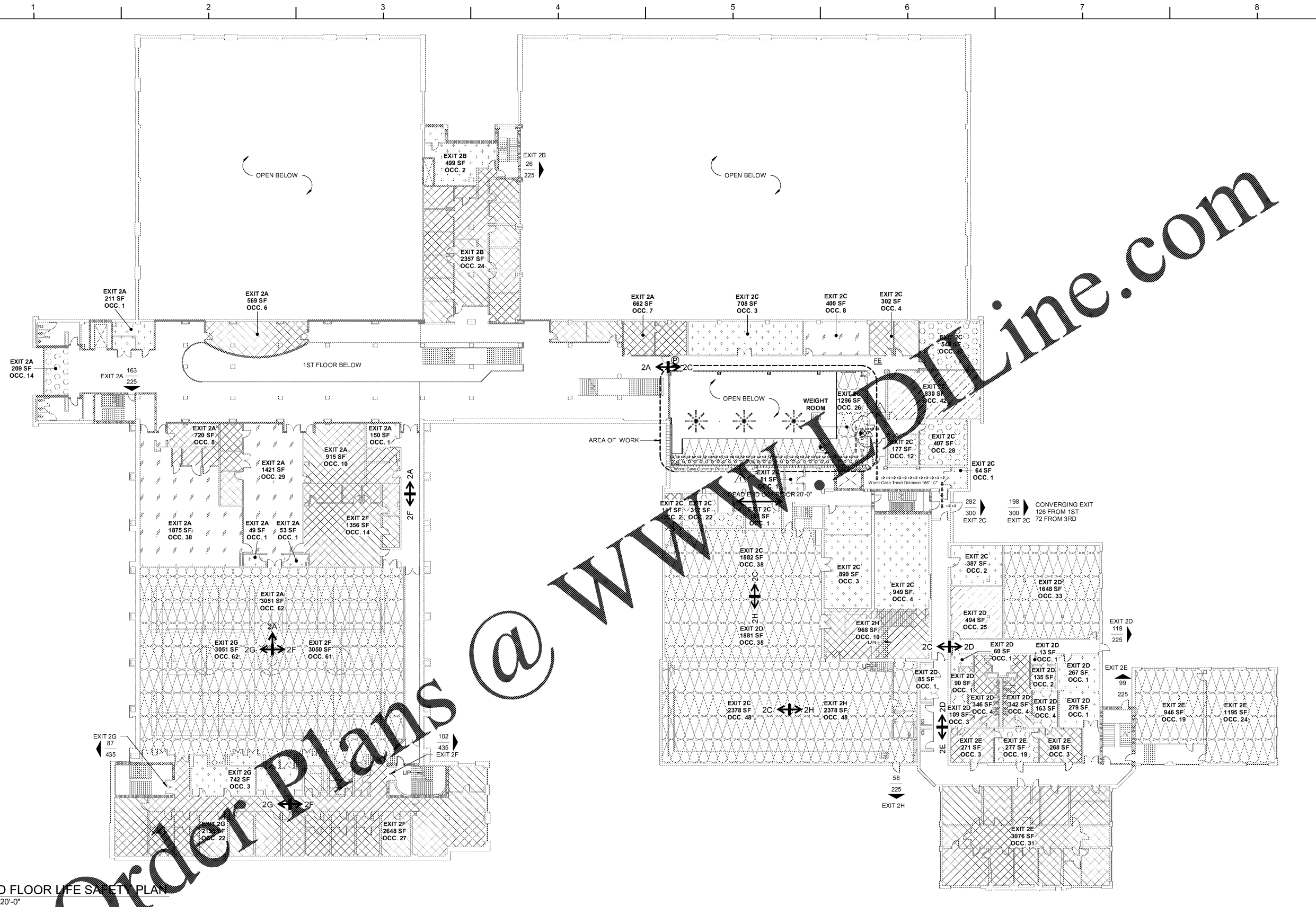

Order Plans @ WWW.IDLine.com

B1 2ND FLOOR LIFE SAFETY PLAN
 1" = 20'-0"

- LIFE SAFETY GENERAL NOTES:**
- REFER TO SHEET T-1.2 FOR CODE SUMMARY.
 - REFER TO DOOR SCHEDULE FOR REQUIRED DOOR RATINGS.
 - REFER TO SITE PLAN FOR BUILDING ADJACENCIES AND PROPERTY LINES.
 - REFER TO FLOOR PLANS FOR FIRE EXTINGUISHER LOCATIONS.

LIFE SAFETY SYMBOL LEGEND

	DENOTES EXIT DIRECTION ARROW, TYP.		WORST-CASE TRAVEL DISTANCE
	INDICATES EXIT POPULATION		WORST CASE COMMON PATH OF TRAVEL
	INDICATES EXIT CAPACITY (POPULATION)		INDICATES FIRE EXTINGUISHERS IN AREA OF WORK
	DENOTES EXIT ACCESS		INDICATES PANIC HARDWARE IN AREA OF WORK
	LOCATION WHERE TRAVEL DISTANCE TO 2 EXITS IS EQUIDISTANT		ROOM NAME ROOM NUMBER
	DEAD END CORRIDOR (1018.4- NO GREATER THAN 50' IN SPRINKLERED BUSINESS AND STORAGE)		EXIT AREA OCCUPANT CAPACITY
	EXIT LIGHT FIXTURE IN AREA OF WORK		
	EXIT DIRECTIONAL ARROW		

LIFE SAFETY OCCUPANCY KEY

	ACCESSORY STORAGE AREAS, MECHANICAL EQUIPMENT ROOM (300 SF/OCC. GROSS)		EDUCATIONAL CLASSROOM AREA (20 SF/OCC. NET)
	ASSEMBLY CONCENTRATED (CHAIRS, NOT FIXED) (7 SF/OCC. NET)		EDUCATIONAL SHOPS & OTHER VOCATIONAL (50 SF/OCC. NET)
	ASSEMBLY UNCONCENTRATED (TABLES & CHAIRS) (15 SF/OCC. NET)		EXERCISE ROOM (W/ EQUIPMENT) (50 SF/OCC. GROSS)
	ASSEMBLY W/ FIXED SEATS		LOCKER ROOM (50 SF/OCC. GROSS)
	BUSINESS AREAS (100 SF/OCC. GROSS)		STAGE (15 SF/OCC. NET)

RATED ASSEMBLIES LEGEND:

NOTES: RATINGS ARE NOT SHOWN THROUGH DOORS FOR CLARITY. SEE A-0.0 FOR PARTITION TYPES. SEE LIFE SAFETY PLANS ON T-2.1 - T-2.3 FOR FULL EXTENT OF RATINGS, INCLUDING HORIZONTAL RATINGS. RATINGS ARE CONTINUOUS AROUND OPENINGS AND OPENINGS ARE TO BE PROTECTED IN ACCORDANCE WITH THE NC STATE BUILDING CODE. PROTECT ALL PENETRATIONS.

SEE T-SHEETS FOR UL ASSEMBLIES AND ADDITIONAL INFORMATION.

	EXISTING 1-HR RATED FIRE BARRIER
	EXISTING 2-HR RATED FIRE BARRIER
	EXISTING SMOKE RESISTANT WALL
	NEW SMOKE RESISTANT WALL