

FUEL CANOPY MFR NOTES

- GENERAL
 - MANUFACTURER SHALL DESIGN AND SUPPLY ALL CANOPY FRAMING AND SUBSEQUENT CONNECTIONS (INCLUDING BASE PLATES AND ANCHOR BOLTS) TO MEET THE CANOPY DESIGN LOAD CRITERIA SHOWN ON SHEET FSS0.
 - STRUCTURAL DESIGN OF THE CANOPY SHALL BE PERFORMED BY AN ENGINEER LICENSED IN THE PROJECT STATE.
 - PROFILES ARE SHOWN FOR GRAPHICAL PURPOSES ONLY AND NOT INTENDED TO SUGGEST CONFIGURATION OF PRIMARY MEMBERS.
- FOUNDATIONS AND SUBGRADE
 - REFER TO GENERAL NOTES ON SHEET FSS0 FOR FOUNDATION GENERAL NOTES.
 - REFER TO GENERAL NOTES ON SHEET FSS0 FOR SUBGRADE GENERAL NOTES.
- CONCRETE AND REINFORCING STEEL
 - REFER TO GENERAL NOTES ON SHEET FSS0 FOR CONCRETE AND REINFORCING STEEL GENERAL NOTES.
- CANOPY REACTIONS
 - MANUFACTURER SHALL PROVIDE ALL CALCULATIONS AND SHOP DRAWINGS TO THE BUILDING ENGINEER FOR REVIEW PRIOR TO THE START OF CONSTRUCTION.
 - MANUFACTURER SHALL PROVIDE ALL FOUNDATION REACTIONS TO THE BUILDING ENGINEER FOR REVIEW AND VERIFICATION OF FOUNDATION DESIGN (FOUNDATION DESIGN BY BUILDING ENGINEER). WIND AND SEISMIC REACTIONS SHALL BE PROVIDED AT ASD SERVICE LEVEL. MANUFACTURER SHALL PROVIDE A REACTION TABLE ON THE SHOP DRAWINGS LISTING THE VERTICAL, HORIZONTAL, AND MOMENTS FOR EACH OF THE FOLLOWING LOAD CATEGORIES: DEAD, LIVE, WIND, AND SEISMIC. DO NOT PROVIDE COMBINED LOAD REACTIONS.
 - MANUFACTURER SHALL PROVIDE THE MINIMUM AND MAXIMUM REACTIONS FOR THE WIND AND SEISMIC LOAD CATEGORIES.
 - SNOW REACTIONS SHALL INCLUDE UNBALANCED SNOW LOADS AND/OR ALLOW ROOF DRIFTING FROM THE MAIN BUILDING WHEN APPLICABLE.
- CONSTRUCTION AND SAFETY
 - CANOPY ERECTOR SHALL PROVIDE ALL TEMPORARY BRACINGS FOR THE ENTIRE CANOPY STRUCTURE UNTIL ALL STRUCTURE AND CONNECTIONS ARE INSTALLED AND FUNCTIONING AS THE DESIGNED UNIT.
 - THE CONTRACTOR SHALL BE RESPONSIBLE FOR ALL CLEANING, METHODS, TECHNIQUES, SEQUENCES OR PROCEDURES OF CONSTRUCTION SELECTED.
 - THE CANOPY ERECTOR SHALL BE SOLELY AND COMPLETELY RESPONSIBLE FOR THE CONDITIONS OF THE JOB SITE IN AND AROUND THE CANOPY INCLUDING THE SAFETY OF ALL PERSONS AND PROPERTY.

FUEL CANOPY SPECIAL INSPECTIONS

SPECIAL INSPECTIONS ARE REQUIRED AT THE FUEL CANOPY. REFER TO APPENDIX B OF THE PROJECT SPECIFICATIONS FOR THE REQUIREMENTS OF SPECIAL INSPECTIONS.

ADDITIONAL INSPECTIONS ARE REQUIRED FOR THE FUEL CANOPY FOUNDATIONS. THESE SHALL INCLUDE THE STRUCTURAL CONCRETE (03310) INSPECTIONS AND FREQUENCIES LISTED IN APPENDIX B OF THE PROJECT SPECIFICATIONS.

- CONCRETE REINFORCEMENT
- EMBEDDED ITEMS
- CONCRETE FOUNDATIONS STRUCTURAL INSPECTIONS
- CONCRETE MIX
- PREPARATION AND PLACEMENT
- PROTECTION AND CURING

REFER TO APPENDIX B OF THE PROJECT SPECIFICATIONS FOR INSPECTOR QUALIFICATIONS AND RESPONSIBILITIES.

NOTE:
THE SUBSURFACE PREPARATION DIRECTLY BENEATH THE SERVICE BUILDING SHALL BE AS SPECIFIED IN THE PAD PREP NOTE ON SHEET FSS0. THE FINAL SUBGRADE ELEVATION DIRECTLY BENEATH THE SERVICE BUILDING SHALL ALIGN WITH THE TOP OF FOOTING ELEVATION. BASE MATERIAL AS SPECIFIED IN THE PAD PREP NOTE IS NOT REQUIRED DIRECTLY BENEATH THE SERVICE BUILDING. PORTIONS OF THE PAD DIRECTLY BENEATH THE SERVICE BUILDING MUST BE RECESSED FOR PLUMBING PRIOR TO PLACEMENT OF THE PRE-FAB SERVICE BLDG. COORDINATE THE PAD RECESSED AREAS WITH THE MRM. ALL UTILITY TRENCHES THROUGH THE PAD SHALL BE FILLED TO THE ADJACENT SUBGRADE ELEVATION.

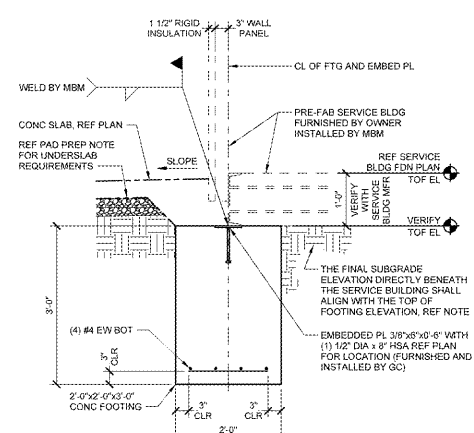

9 SERVICE BUILDING FOOTING
3/4" = 1'-0"

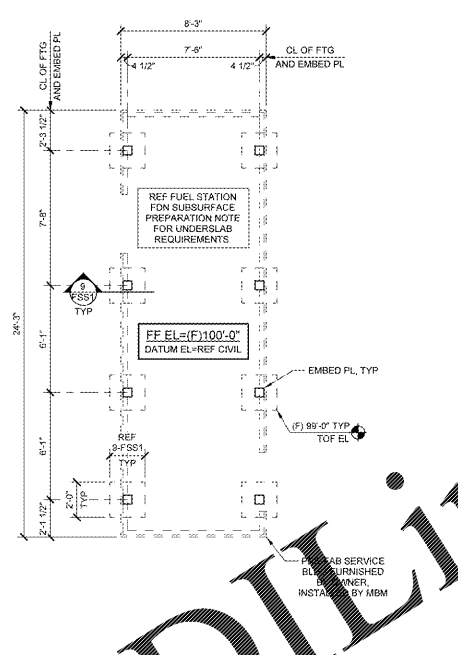

8 SERVICE BUILDING FOUNDATION PLAN
1'-0"

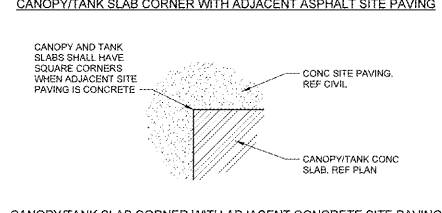
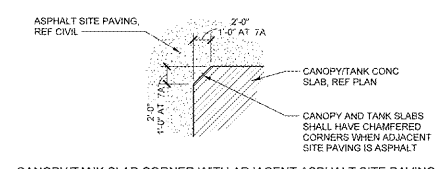

7 TYPICAL SLAB EXTERIOR CORNER
1/8" = 1'-0"

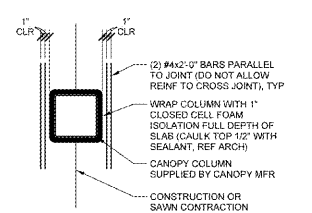

6 CANOPY COLUMN ISOLATION
3/4" = 1'-0"

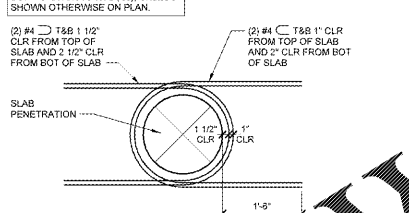

5 TANK SLAB PENETRATION REINFORCING DIAGRAM
3/4" = 1'-0"

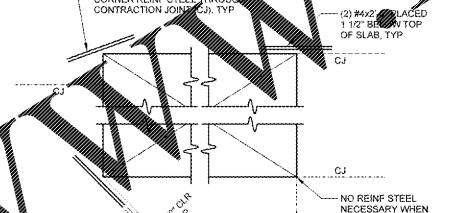

4 RE-ENTRANT CORNER REINF
1/2" = 1'-0"

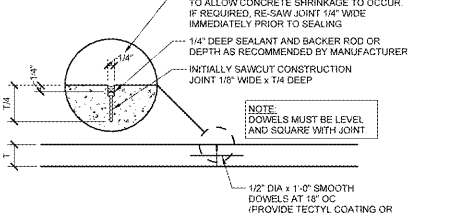

3B EXTERIOR CONC SLAB CONSTRUCTION JOINT (CONST JT)
3/4" = 1'-0"

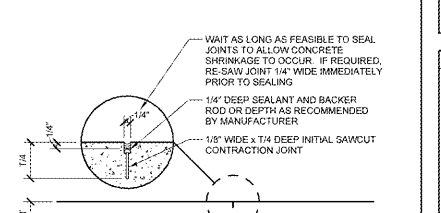

3A EXTERIOR CONC SLAB CONTRACTION JOINT (CJ)
3/4" = 1'-0"

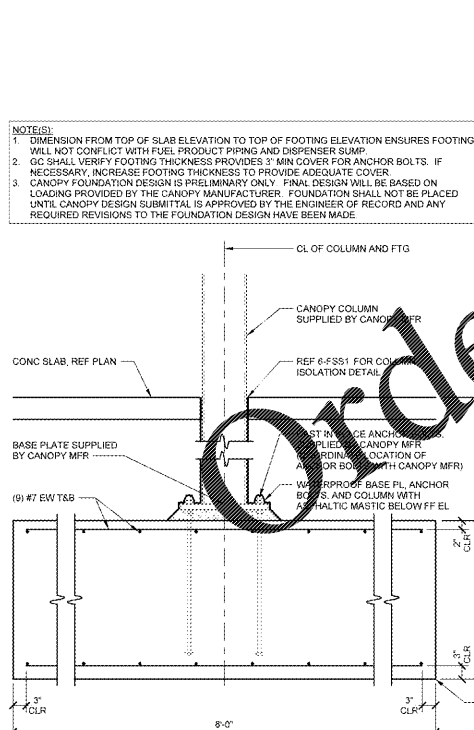

2 CANOPY COLUMN FOOTING
3/8" = 1'-0"

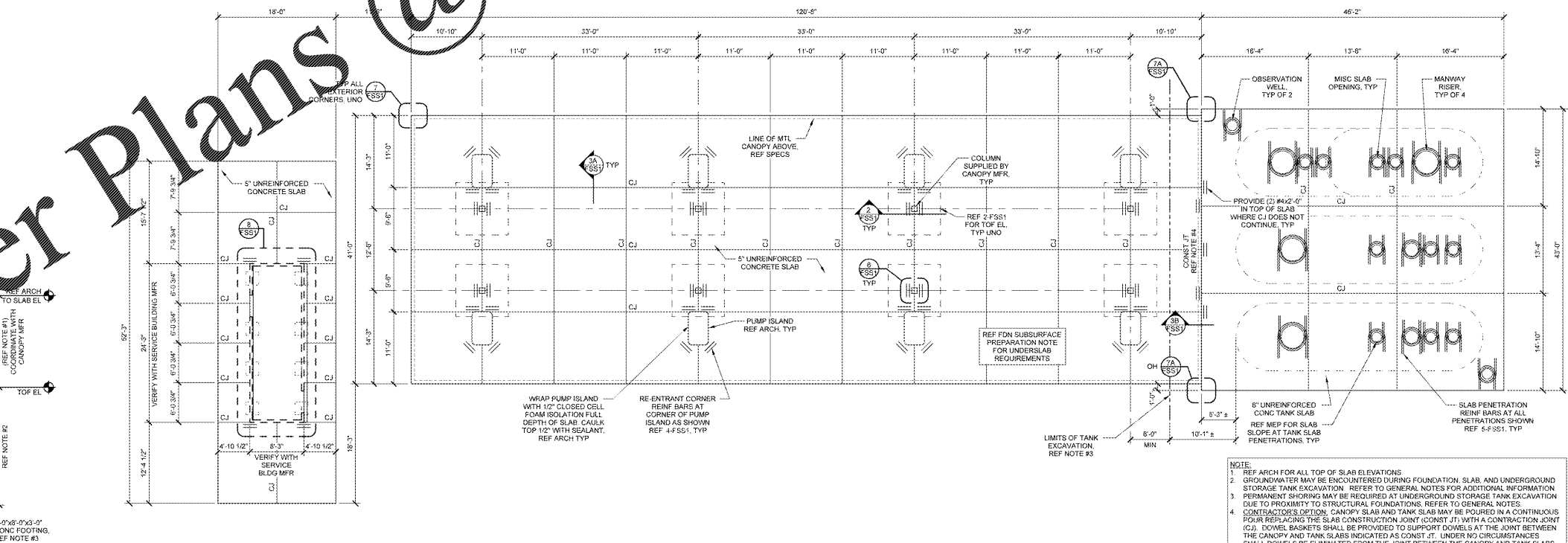

1 CANOPY FOUNDATION PLAN
1/8" = 1'-0"

NOTES:
1. DIMENSION FROM TOP OF SLAB ELEVATION TO TOP OF FOOTING ELEVATION ENSURES FOOTING WILL NOT CONFLICT WITH FUEL PRODUCT PIPING AND DISPENSER SUMP.
2. GC SHALL VERIFY FOOTING THICKNESS PROVIDES 3" MIN COVER FOR ANCHOR BOLTS. IF NECESSARY, INCREASE FOOTING THICKNESS TO PROVIDE ADEQUATE COVER.
3. CANOPY FOUNDATION DESIGN IS PRELIMINARY ONLY. FINAL DESIGN WILL BE BASED ON LOADING PROVIDED BY THE CANOPY MANUFACTURER. FOUNDATION SHALL NOT BE PLACED UNTIL CANOPY DESIGN SUBMITTAL IS APPROVED BY THE ENGINEER OF RECORD AND ANY REQUIRED REVISIONS TO THE FOUNDATION DESIGN HAVE BEEN MADE.

8/20/2019 9:28:47 AM

STIPULATION FOR REUSE
THIS DOCUMENT IS THE PROPERTY OF AND IS LOANED TO YOU BY THE ENGINEER OF RECORD. IT IS TO BE USED ONLY FOR THE PROJECT AND SITE SPECIFICALLY IDENTIFIED HEREIN. IT IS NOT TO BE REPRODUCED, COPIED, OR TRANSMITTED IN ANY FORM OR BY ANY MEANS, ELECTRONIC OR MECHANICAL, INCLUDING PHOTOCOPYING, RECORDING, OR BY ANY INFORMATION STORAGE AND RETRIEVAL SYSTEM, WITHOUT THE WRITTEN PERMISSION OF THE ENGINEER OF RECORD.

CONSULTANTS
ELIUSON GAGE & ASSOCIATES, PLLC
1000 W. BROADWAY
SUITE 200
CHARLOTTE, NC 28202
PHONE: 704.375.1234
FAX: 704.375.1235
WWW.ELIUSONGAGE.COM
REGISTERED PROFESSIONAL ENGINEER OF RECORD

ANDERSON, SOUTH CAROLINA
CLUB NO: 6463
JOB NUMBER: 1914030 | PHOTO: SAMP-152

CHECKED BY: BKE
DRAWN BY: MRH
PROTO CYCLE: 10/28/19
DOCUMENT DATE: 08/09/19

NOT FOR CONSTRUCTION

FOUNDATION PLANS AND DETAILS

SHEET: FSS1