

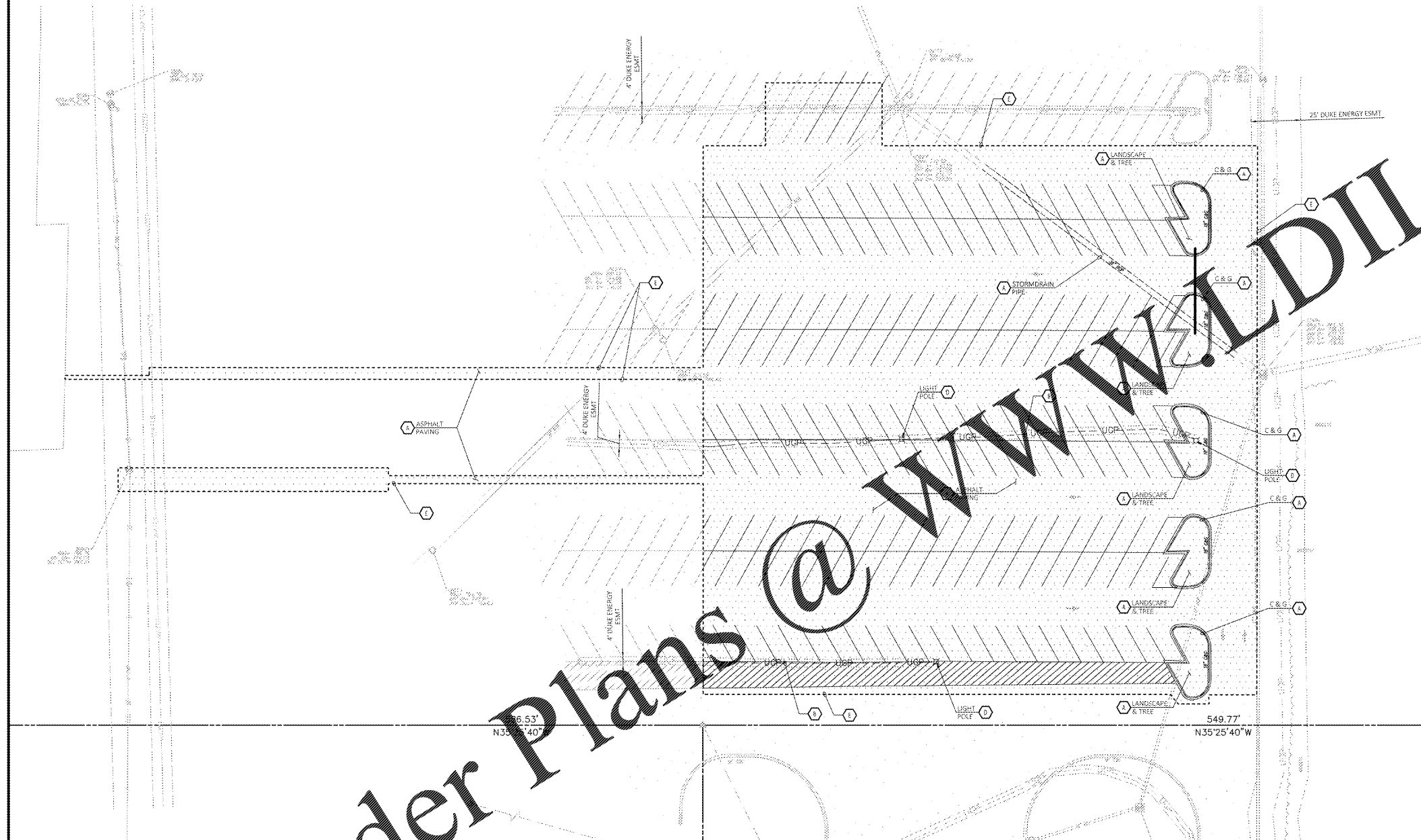

Know what's below.  
Call before you dig.

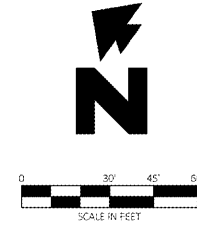

Order Plans @ [www.weldline.com](http://www.weldline.com)

GENERAL DEMOLITION NOTES

- 1. THE CONTRACTOR IS RESPONSIBLE FOR THE DEMOLITION, REMOVAL, AND DISPOSAL...
2. THE CONTRACTOR IS RESPONSIBLE FOR REMOVING ALL DEBRIS FROM THE SITE...
3. THE CONTRACTOR SHALL COORDINATE WITH RESPECTIVE UTILITY COMPANIES...
4. ALL EXISTING SEWERS, PIPING AND UTILITIES SHOWN ARE NOT TO BE INTERPRETED...
5. ELECTRICAL, TELEPHONE, CABLE, WATER, FIBER OPTIC CABLE AND GAS...
6. CONTRACTOR MUST PROTECT THE PUBLIC UTILITIES WITH FENCINGS, BARRICADES...
7. CONTINUOUS ACCESS SHALL BE MAINTAINED FOR THE SURROUNDING PROPERTIES...
8. PRIOR TO DEMOLITION OCCURRING, ALL APPROPRIATE EROSION CONTROL DEVICES...
9. AN EXISTING STRUCTURE TO REMAIN ARE DAMAGED DURING CONSTRUCTION...
10. CONTRACTOR SHALL TAKE ALL PRECAUTIONS NECESSARY TO AVOID PROPERTY DAMAGE...
11. ENGINEER'S NOTICE TO CONTRACTOR: THE CONTRACTOR IS SPECIFICALLY CAUTIONED THAT THE LOCATION AND/OR ELEVATION...

DEMOLITION LEGEND

- A EXISTING TO BE REMOVED
B EXISTING SITE LIGHTING CONDUIT TO BE REROUTED...
C EXISTING TO BE RELOCATED
E LIMITS OF SAWCUT AND PAVEMENT REMOVAL

ABBREVIATIONS

C & G CURB AND GUTTER

PROPOSED

- LIMITS OF SAWCUT AND PAVEMENT REMOVAL
--- LIMITS OF DEMOLITION

EXISTING LEGEND

- PROPERTY LINE
ADJACENT PROPERTY LINE
EASEMENT LINE
WOODS LINE
UNDERGROUND POWER
BUILDING SETBACK LINE
LANDSCAPE BUFFER LINE
EXISTING CONTOUR LINE
UNDERGROUND POWER LINE
SANITARY SEWER LINE
STORM SEWER LINE
IRON PIN FOUND (SIZE AND TYPE AS NOTED)
1/2" REBAR W/ CAP SET
NAIL FOUND
NAIL & DISK SET
LIGHT POLE
STORM MANHOLE
DROP INLET
SANITARY MANHOLE
CLEANOUT
SPOT ELEVATION
SCHEDULE BII EXCEPTION
STREET ADDRESS
ASPHALT
CONCRETE
GRAVEL

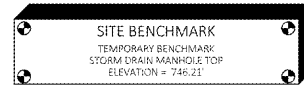

NOTE: SEE ARCHITECTURAL PLANS FOR EXACT LOCATIONS AND DIMENSIONS OF PORCHES, RAMPS, VESTIBULE, SLOPED PAVING, TRUCK DOCS, BUILDING UTILITY ENTRANCE LOCATIONS AND PRECISE BUILDING DIMENSIONS.

ALERT TO CONTRACTOR: ALL SAM'S CLUB GENERAL CONTRACTOR WORK TO BE COMPLETED (EARTHWORK, FINAL UTILITIES, AND FINAL GRADING) BY THE MILESTONE DATE IN PROJECT DOCUMENTS.

Table with 2 columns: NO., DATE, DESCRIPTION

Engineering Associates, Inc. logo and contact information: 7445 N. Ingram Ave., Suite 107, Fresno, CA 93711

SAM'S CLUB FUEL STATION #6663-502 DEMOLITION PLAN 3812 LIBERTY HWY #6 ANDERSON SOUTH CAROLINA

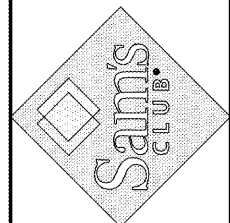

Table with 2 columns: INITIAL DESIGN, DATE (8/27/19)

Professional Engineer seal for CEI ENGINEERING ASSOCIATES, INC. No. C01441

Table with 2 columns: JOB NO., DWS NAME, DATE, SHEET NO. (C2)