

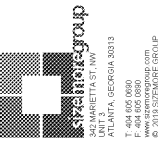

DATE	
DESCRIPTION	
No.	

CITY OF MONROE
PUBLIC SAFETY & MUNICIPAL
COURT COMPLEX RENOVATION
140 BLAINE ST., MONROE, GA 30655



THIS DRAWING IS AN INSTRUMENT OF SERVICE AND SHALL REMAIN THE PROPERTY OF THE ARCHITECT. NO PART OF THIS DOCUMENT SHALL BE REPRODUCED OR TRANSMITTED IN ANY FORM, ELECTRONICALLY OR MECHANICALLY, FOR ANY PURPOSE, WITHOUT THE EXPRESS WRITTEN PERMISSION OF THE ARCHITECT.

FOUNDATION PLAN

PROJECT # 19160MONRpo
DATE: 09/04/19
DRAWN BY: DFM
CHECKED BY: HJ

S101

SCALE As indicated

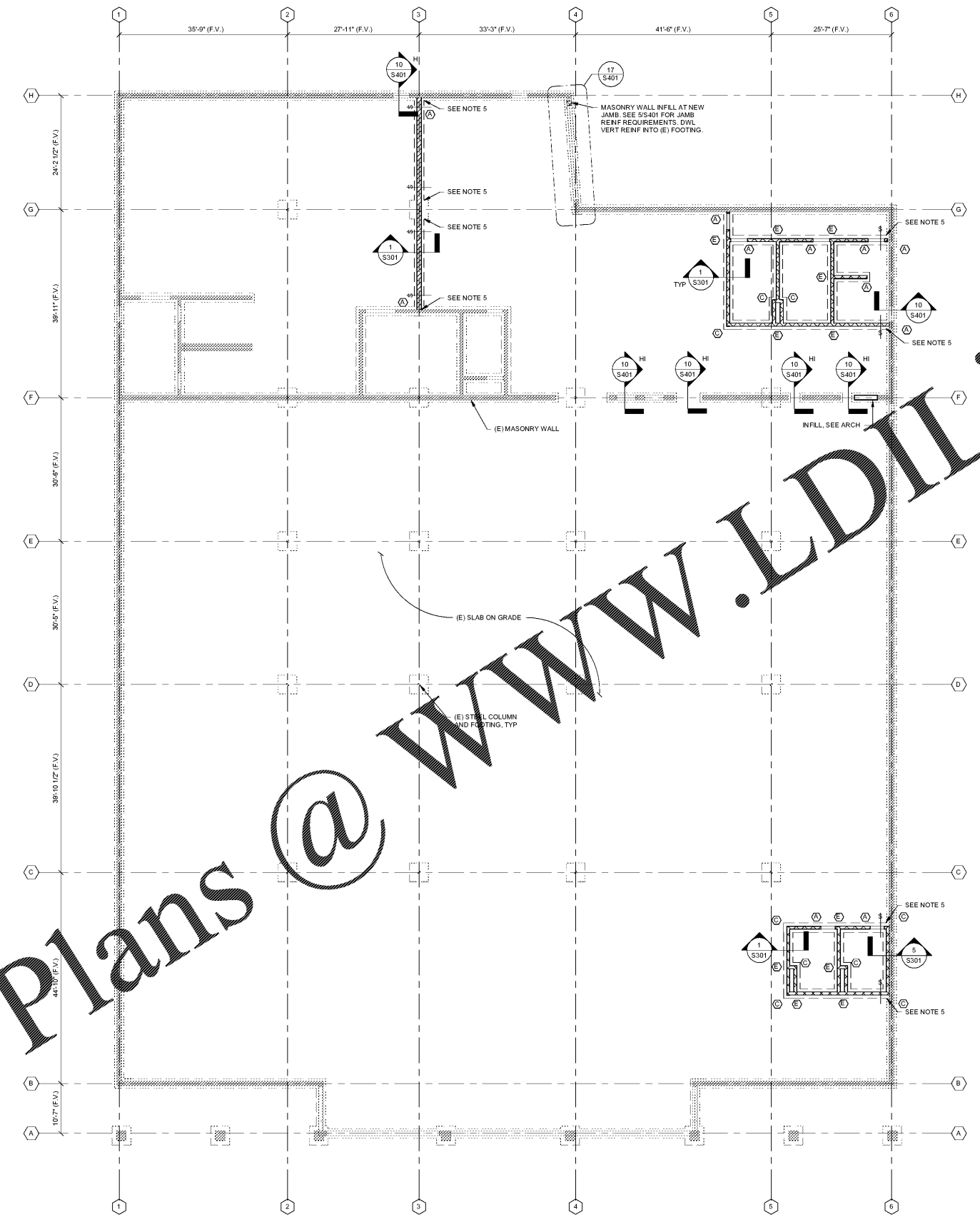

Order Plans @ WWW.LDILine.com

1 FOUNDATION PLAN
S101 3/32" = 1'-0"

- NOTES:
- SEE S301 FOR STRUCTURAL GENERAL NOTES.
 - SEE ARCH FOR ADDITIONAL INFORMATION AND DIMENSIONS.
 - SEE S301 FOR SLAB INFILL DETAIL.
 - INDICATES 6" MASONRY WALL REINFORCED W/ #6@24" O.C. SEE DETAIL 1/S401.
 - INDICATES 12" MASONRY WALL REINFORCED W/ #6 @16" O.C. SEE DETAIL 1/S401.
 - INDICATES MASONRY WALL REINFORCEMENT. SEE S/S401.
 - TOP OF NEW FOOTING SHALL MATCH TOP OF EXISTING FOOTING. CONTRACTOR TO FIELD VERIFY ELEVATION OF EXISTING FOOTING PRIOR TO FABRICATION AND PROVIDE STEP IN FOOTING AS REQUIRED.
 - INDICATES STEP FOOTING. SEE 17/S301.
 - CONTRACTOR SHALL BE RESPONSIBLE FOR COORDINATION OF ALL UTILITY AND PLUMBING LINES. SEE 18/S301.