

STIPULATION FOR REUSE
 THIS DRAWING WAS PREPARED FOR THE PROJECT AND IS NOT TO BE REUSED FOR ANY OTHER PROJECT WITHOUT THE WRITTEN CONSENT OF HARRISON FRENCH & ASSOCIATES, LTD. THE USER OF THIS DRAWING FOR ANY OTHER PROJECT IS AT THEIR OWN RISK. HARRISON FRENCH & ASSOCIATES, LTD. DOES NOT WARRANT THE ACCURACY OR COMPLETENESS OF THIS DRAWING FOR ANY OTHER PROJECT. THE USER OF THIS DRAWING FOR ANY OTHER PROJECT IS AT THEIR OWN RISK. HARRISON FRENCH & ASSOCIATES, LTD. DOES NOT WARRANT THE ACCURACY OR COMPLETENESS OF THIS DRAWING FOR ANY OTHER PROJECT. THE USER OF THIS DRAWING FOR ANY OTHER PROJECT IS AT THEIR OWN RISK.

Cumberland
 Store # TBD
 VSH # TBD
 Oracle # FL8312
 SUNRISE & NW 4TH AVE
 FORT LAUDERDALE, FL 33311
 JOB NUMBER: 41-17-06410

ISSUE BLOCK

1	90% CDs	05/10/19
2	100% SET	06/14/19
3	90% AIM 4.0	08/14/19
4	100% AIM 4.0	09/11/19
5	BUL#3	11/08/19

CHECKED BY: GGB
 DRAWN BY: AHM



ROOF FRAMING PLAN

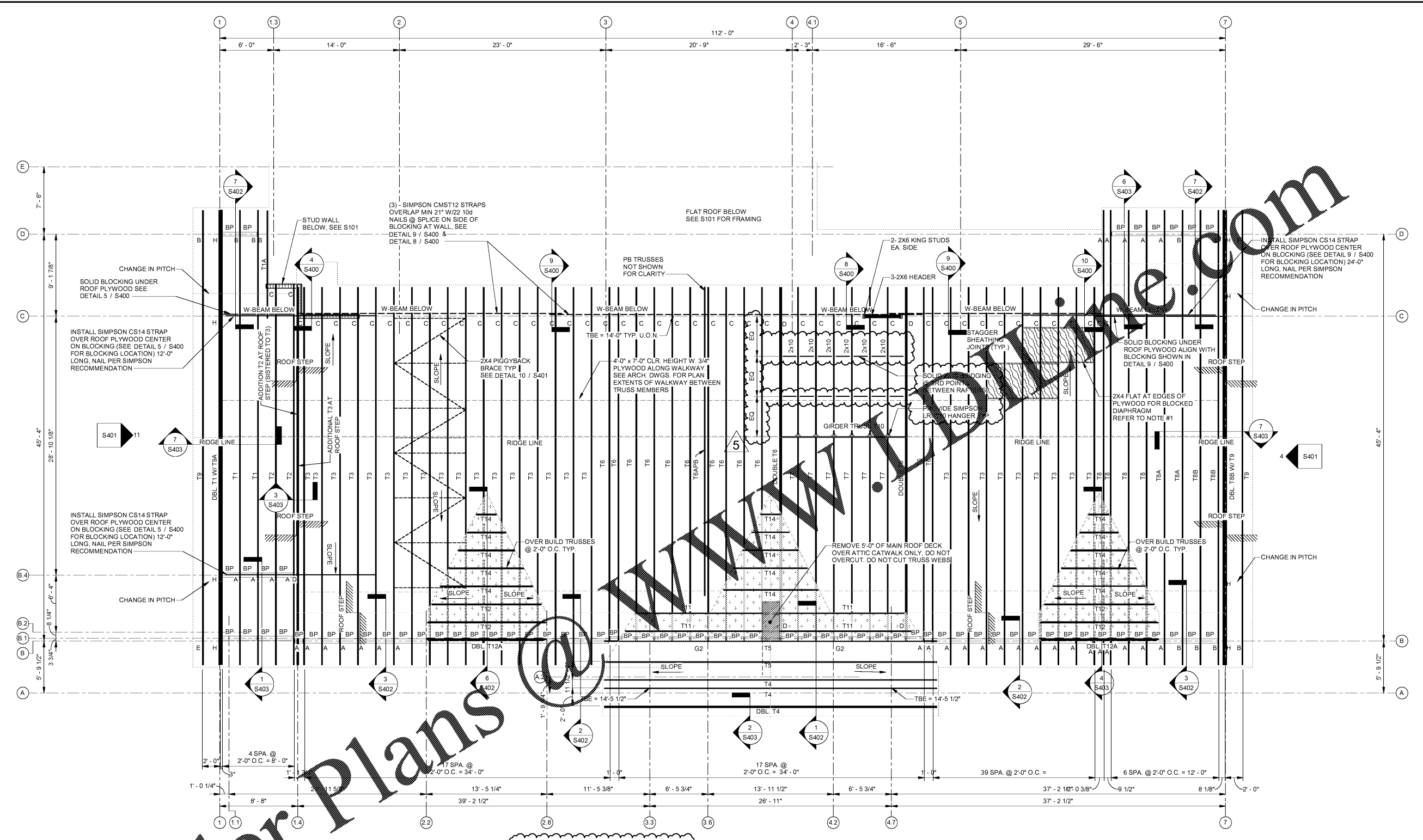

1 ROOF FRAMING PLAN
 3/16" = 1'-0"

CONTRACTOR NOTES:

- FOR ALL BRACING TO TRUSS CONNECTIONS AND FOR ALL BRACING TO WALL FRAMING CONNECTIONS, AT EACH CONNECTION, USE MINIMUM (2) 16d FACE NAILS OR 2 TOENAILS.
- REFER TO BCS' GUIDE TO GOOD PRACTICE FOR HANDLING, INSTALLING, RESTRAINING & BRACING OF METAL PLATE CONNECTED WOOD TRUSSES' SECTION B3 "PERMANENT RESTRAINT / BRACING OF CHORDS & MEMBERS" PAGES 37 THRU 52.
- SHOWN TRUSS BRIDGINGS ARE NOT FINAL. CONTRACTOR SHALL ACCOUNT IN BID FOR ADDITIONAL BRIDGING AS REQUIRED BY TRUSS MANUFACTURER AND/OR EOR WITH COORDINATION WITH TRUSS MANUFACTURER.

LEGEND:

- O.F. DENOTES OUTSIDE FACE
- TBE DENOTES TRUSS BEARING ELEVATION
- T1 DENOTES GABLE TRUSS PER MFR
- PB DENOTES PIGGYBACK TRUSS
- BP DENOTES BLOCKING PANEL (DETAIL 5 / S403)
- DENOTES LIMITS OF OVERFRAMING
- SLOPE DENOTES DIRECTION & PITCH OF ROOF SLOPE (COORD. W/ ARCH.)
- H1 DENOTES HEADER MARK (SEE HEADER SCHED. ON SHEET S101)

PLAN NOTES:

- ROOF SHEATHING: SEE PLYWOOD SHEATHING REQUIREMENTS ON S002. PLYWOOD SHALL BE BLOCKED WITH 2X4'S FLAT.
- BLOCKED DIAPHRAGM: FROM GRID "1" TO GRID "7", ATTACH DECK TO SUPPORTS W/ 10d RING SHANK NAILS AT 3" O.C. AT PANEL EDGES AND W/ 10d RING SHANK NAILS AT 6" O.C. IN FIELD.
- ALL ELEVATIONS BASED ON FIN. FLR. EL. 0'-0". FIELD VERIFY ACTUAL FIN. FLR. EL.
- ROOF TRUSS BEARING ELEVATION 14'-0". TYP. U.O.N.
- ALL TRUSSES ARE SPACED @ 24" O.C. MAXIMUM. FIELD ADJUST AS REQUIRED.
- SEE ARCH. DWGS. & FOUNDATION PLAN FOR DIMENSIONS NOT SHOWN.
- SEE DWG. S001 FOR GENERAL NOTES AND TYPICAL DETAILS.
- PROVIDE MIN. (2) JACK STUDS & (3) KING STUDS AT ALL WOOD BEAM BEARING LOCATIONS ON STUD WALL. A KING STUD IS DEFINED AS A STUD THAT GOES FULL HEIGHT.
- REFER TO TRUSS MFR. DWGS. FOR CONNECTION OF PIGGY-BACK TRUSS TO THE TRUSS BELOW. THIS ONLY APPLIES TO TRUSSES DELIVERED "BROKEN" INTO TWO PIECES FOR TRANSPORTATION PURPOSES.

- RUNS FOR MECHANICAL, ELECTRICAL AND PLUMBING (MEP) THROUGH PRE-ENGINEERED TRUSSES MUST BE COORDINATED WITH THE TRUSS DESIGNER AND MEP DWGS. (PIPING, DUCT RUNS, ETC.) FIRE SPRINKLER RUNS MUST ALSO BE COORDINATED.
- PROVIDE PANEL BLOCKING AT 2'-0" O.C. OVER CMU WALLS. TYP. AT ALL TRUSSES SHOWN.
- SEE ARCH. FOR DIMENSIONS NOT SHOWN.
- SEE ARCH. AND MECH. FOR ALL SLEEVES, PIPES, INSERTS AND EMBEDDED ITEMS.
- THE G.C. SHALL VERIFY THE WEIGHT AND LOCATION OF ALL MECHANICAL EQUIPMENT TO BE SUPPORTED BY ROOF STRUCTURE W/ MECHANICAL & EQUIPMENT SUPPLIER TO PRIOR TO FABRICATION AND CONSTRUCTION. REPORT ANY DISCREPANCIES TO ARCHITECT AND ENGINEER.
- THE G.C. SHALL PROVIDE ROOF DRAINS AND SCUPPERS AS REQUIRED TO ALLOW FOR COMPLETE DRAINAGE OF ROOF AT ALL TIMES TO AVOID PONDING OF WATER.

NOTE:
 USE 10d RING SHANK NAILS FOR ROOF SHEATHING ATTACHMENTS. SEE PLAN NOTE #1 AND SHEET S002

HURRICANE TIE SCHEDULE

DESIGNATION	TYPE	CAPACITIES (LBS)	COMMENTS
JOISTS & TRUSSES U.O.N.	2-H10A	2,280	
JOISTS & TRUSSES MARKED 'A'	DETAL20	2,480	
JOISTS & TRUSSES MARKED 'B'	2-HTS16	2,520	
JOISTS & TRUSSES MARKED 'C'	H8 & HGA10KT	1,490	DETAIL 11 / S400
JOISTS & TRUSSES MARKED 'D'	MGT	3,965	DRILL AND ANCHOR DETAIL 12 / S400
JOISTS & TRUSSES MARKED 'E'	2-LTS12	1,550	
JOISTS & TRUSSES MARKED 'F'	2-H10A & HGA10KT	2,975	
JOISTS & TRUSSES MARKED 'G'	H8, H10A & HGA10KT	2,630	
JOISTS & TRUSSES MARKED 'G2'	H8 & H10A	1,935	
JOISTS & TRUSSES MARKED 'H'	HDTB	7,345	

11/20/2019 10:41:26 AM
 C:\Users\mshah\OneDrive\My Documents\Projects\2019\1911\191101\191101_141_S102_V15.dwg, mshah, 191101_141_S102_V15.dwg, mshah, 191101_141_S102_V15.dwg, mshah, 191101_141_S102_V15.dwg