

5 SECTION AT COFFEE BAR - STONE PANEL WALL
3/4" = 1'-0"

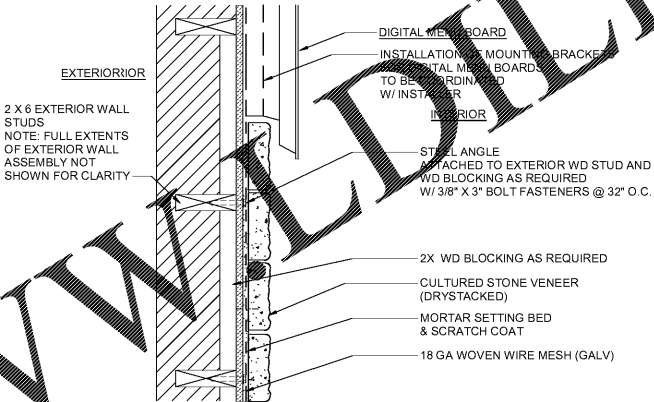

PLAN DETAIL AT COFFEE BAR - STONE PANEL WALL
1 1/2" = 1'-0"

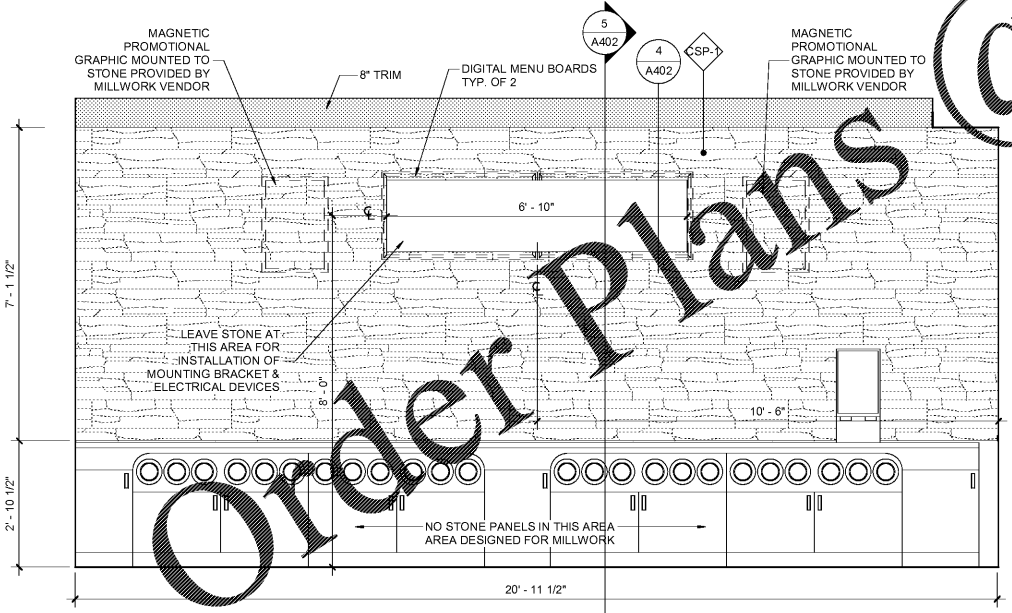

3 COFFEE COUNTER - NORTH - Callout 1
1/2" = 1'-0"

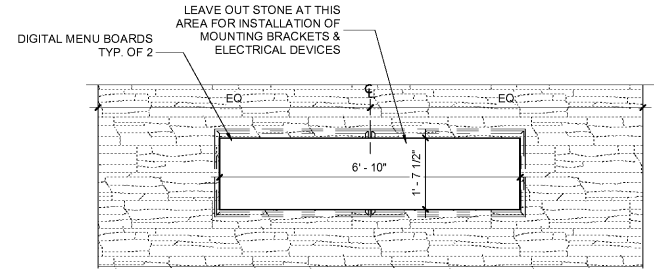

2 ENLARGED INT. ELV. - CASH WRAP AT SOFFIT
1/2" = 1'-0"

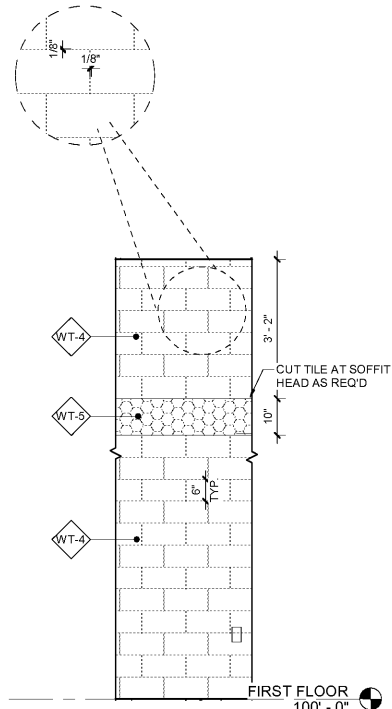

1 ENLARGED INT. ELV. - TILE @ FOOD PREP
1/2" = 1'-0"

WWW.WALDLINE.COM

Order Plans @

STIPULATION FOR REUSE: THESE DRAWINGS ARE THE PROPERTY OF HARRISON FRENCH & ASSOCIATES, LTD. AND ARE NOT TO BE REPRODUCED OR TRANSMITTED IN ANY FORM OR BY ANY MEANS, ELECTRONIC OR MECHANICAL, INCLUDING PHOTOCOPYING, RECORDING, OR BY ANY INFORMATION STORAGE AND RETRIEVAL SYSTEM, WITHOUT THE WRITTEN PERMISSION OF HARRISON FRENCH & ASSOCIATES, LTD. THIS AGREEMENT SHALL BE APPLICABLE TO ANY PROJECTS, CONTRACTS, OR AGREEMENTS, WHETHER OR NOT SPECIFICALLY MENTIONED, AND SHALL REMAIN IN FULL FORCE AND EFFECT UNTIL REVOKED IN WRITING BY HARRISON FRENCH & ASSOCIATES, LTD. ANY UNAUTHORIZED REUSE OF THESE DRAWINGS IS STRICTLY PROHIBITED AND WILL BE CONSIDERED A VIOLATION OF APPLICABLE LAWS AND REGULATIONS.

ISSUE BLOCK	
90% CDs	05/10/19
100% SET	06/14/19
90% AIM 4.0	08/14/19
100% AIM 4.0	09/11/19

CHECKED BY:	JEO
DRAWN BY:	ZC
DOCUMENT DATE:	09/11/19

STATE OF FLORIDA
JAMES E. GIBSON
ARCHITECT
AS37371
Date: 2019/09/11 17:42:49-0400
James E. Gibson, Architect
License #34820219
Harrison French & Associates, LTD
CMAA #19-22890011029

INTERIOR ELEVATIONS

SHEET: A402

9/11/2019 3:17:47 PM
C:\Users\jeh\OneDrive\Documents\2019 Rev\Projects\41-17-00410_A402\Floor\17-00410_A402_17B_2019.dwg
AutoCAD 2019