

STIPULATION FOR REUSE  
 THESE DRAWINGS ARE THE PROPERTY OF HARRISON FRENCH & ASSOCIATES, LTD. AND ARE NOT TO BE REPRODUCED, COPIED, OR TRANSMITTED IN ANY FORM OR BY ANY MEANS, ELECTRONIC OR MECHANICAL, WITHOUT THE WRITTEN PERMISSION OF HARRISON FRENCH & ASSOCIATES, LTD. ANY REUSE OF THESE DRAWINGS FOR ANY PROJECT OTHER THAN THAT SPECIFICALLY IDENTIFIED HEREON WITHOUT THE WRITTEN PERMISSION OF HARRISON FRENCH & ASSOCIATES, LTD. IS STRICTLY PROHIBITED AND MAY BE CONSIDERED AS A VIOLATION OF FEDERAL AND STATE LAWS.

ISSUE BLOCK

90% CDs	05/10/19
100% SET	06/14/19
90% AIM4.0	08/14/19
100% AIM 4.0	09/11/19

CHECKED BY: JEO  
 DRAWN BY: ZC  
 DOCUMENT DATE: 09/11/19

STATE OF FLORIDA  
 JAMES E. CHEN  
 ARCHITECT  
 AR37371  
 Date: 2019/09/11/19 09:29:04:00  
 James E. Chen, Architect  
 License #24382/019  
 Harrison French & Associates, Ltd.  
 31 Hayward Street  
 Franklin, MA 02038

- GENERAL NOTES**
- ALL CEILING FIXTURE DIMENSIONS ARE TO C.L. U.N.O.
  - REFER TO ELECTRICAL DRAWINGS FOR ADDITIONAL INFORMATION ON LIGHTING AND FIRE ALARM DEVICES
  - REFER TO MECHANICAL DRAWINGS FOR ADDITIONAL INFORMATION ON MECHANICAL DEVICES
  - ITEMS SHOWN IN LEGEND MAY NOT NECESSARILY APPEAR ON RCP.
  - SEE A600 FOR CEILING FINISH SCHEDULE

- RCP KEY NOTES**
- 3/4" PLYWOOD @ UNDERSIDE OF SOFFIT TO BE PROVIDED BY MILLWORK VENDOR & INSTALLED BY G.C.  
 G.C. TO CALL MILLWORK VENDOR (LONG BEACH CAS #7401-785-3900 EXT. 121) PRIOR TO FRAMING SOFFIT FOR PLYWOOD TEMPORARY PLYWOOD TO BE PRECUT SHOWING LIGHT FIXTURE LOCATIONS.

**RCP SYMBOL LEGEND**

- 2x2 RECESSED LED LIGHT
- 2x4 RECESSED LED LIGHT
- SURFACE MOUNTED LED STRIP FOR COOLER/FREEZER
- SURFACE MOUNTED LED WRAP
- RECESSED DOWN LIGHT
- BATHROOM WALL MTD. VANITY FIXTURE
- SURFACE MTD. EXTERIOR EMERGENCY LIGHT
- EXIT SIGN
- WALL MTD. MOTION SENSOR
- CEILING MTD. MOTION SENSOR
- CEILING MTD. VISUAL DEVICE
- WALL MTD. VISUAL DEVICE
- CEILING MTD. AUDIBLE/VISUAL DEVICE
- SMOKE DETECTOR
- SPEAKER
- SUPPLY DIFFUSER
- 24"x24" RETURN AIR GRILLE
- CUSTOM DROP-DOWN FILTERED RETURN AIR GRILLE: PROVIDED BY CFI, INSTALLED BY GC
- 12"x24" RETURN AIR GRILLE
- EXHAUST FAN
- LINEAR SUPPLY DIFFUSER
- WALL MTD. LINEAR SUPPLY DIFFUSER
- WALL MTD. LINEAR SUPPLY DIFFUSER
- CEILING MTD. EVAPORATION FAN
- SURFACE MTD. ROLLER SHADE
- INDICATES SLOPED SOFFIT
- SMOOTH WHITE FRP. (FRP-1)
- VINYL SOFFIT PANELS (VP-1)
- GYPSUM WALLBOARD (GWB)
- SYNTHETIC WOOD PANELING (SWP-1)
- PLAM WOOD PANELING (PWP-1)
- COLOR CHANGING LED STRIP (ABOVE WOOD CEILING)

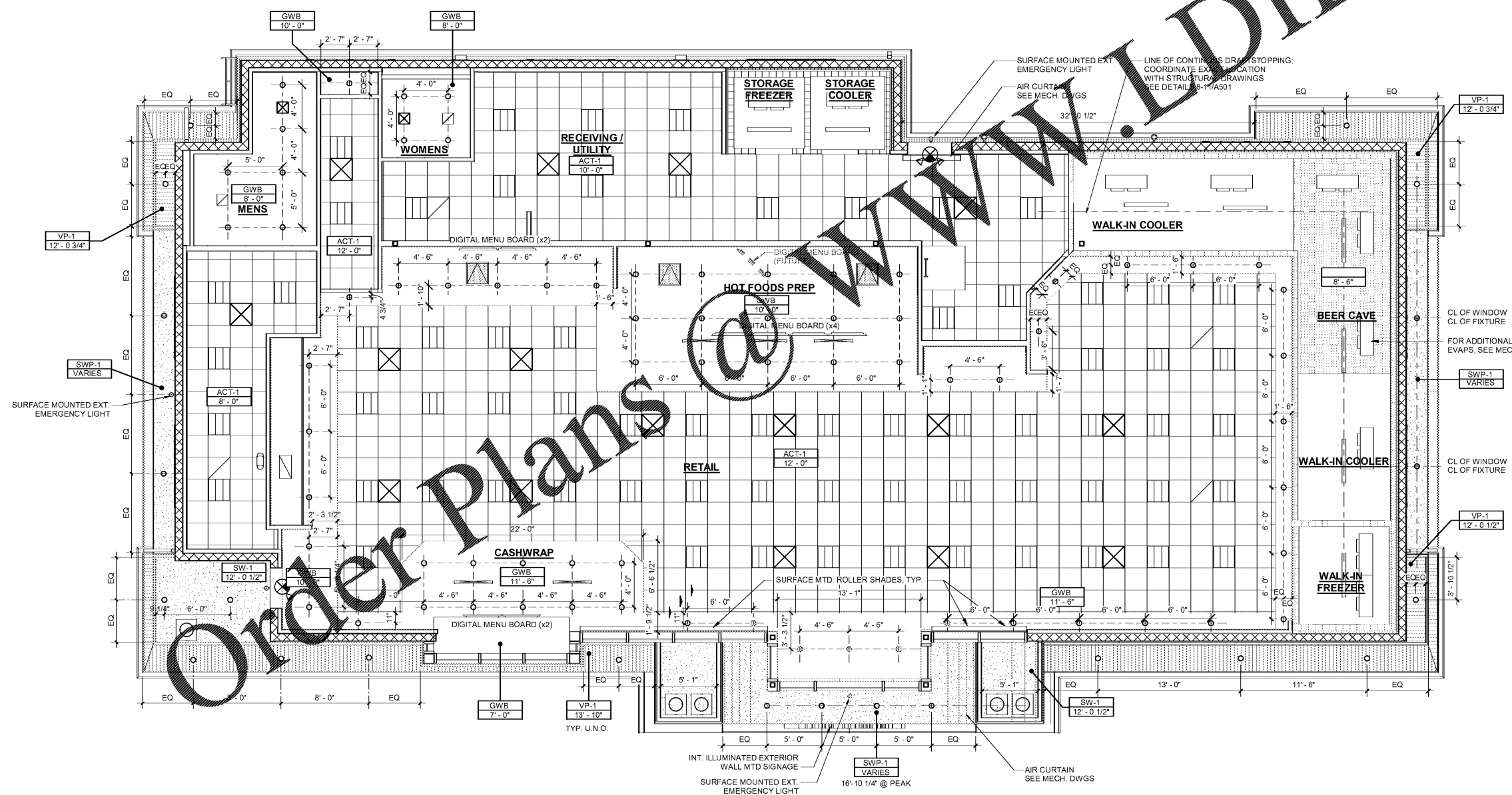

1 REFLECTED CEILING PLAN  
 3/16" = 1'-0"

9/11/2019 3:20:56 PM  
 C:\Users\chamrind\Documents\2019 Rev\Projects\41-17-06410\_A130\A130\_RCP.dwg  
 PLOT: REFLECTED CEILING PLAN