

CORNER GUARD SPECIFICATIONS				
CODE	MATERIAL	MANUFACTURER	PRODUCT NO.	DESCRIPTION/REMARKS
CG-1	16 GA STAINLESS STEEL	CUSTOM	1 1/2" X 1 1/2" S.S. CORNER GAIRD #4 SATIN FINISH. ADHERE CORNER GARDS TO SUBSTRATE AS REQUIRED	FULL HEIGHT OF WALL FROM BASE TO CEILING
CG-2	16 GA STAINLESS STEEL	CUSTOM	S.S. END WALL CAP W/ 1 1/2" WINGS EA. SIDE X WIDTH OF WALL #4 SATIN FINISH. ADHERE CORNER GAIRD TO SUBSTRATE AS REQUIRED	FULL HEIGHT OF WALL FROM BASE TO CEILING

**GENERAL NOTES**

- SEE A600 FOR FINISH SCHEDULE
- CORNER GUARD NOTES**
- ALL CORNER GUARDS TO HAVE A 10' RETURN AT ENDS.
  - ADHERE CORNER GUARDS TO SUBSTRATE AS REQUIRED.
  - SEE A004 FOR WALL TYPES.
  - VERIFY ALL DIMENSIONS IN FIELD.
  - NOTCH CORNER GUARDS AT COUNTERS WHERE REQUIRED. FILE EDGES SMOOTH.
  - SEE A600 FOR CORNER GUARD SPECIFICATIONS.

**FINISH PLAN LEGEND**

	FT-1		EP-2
	FT-2		CPT-1 SEE NOTE
	FT-3		RES-1

- - - - - WALL TILE (WT-1)  
 - - - - - WALL TILE (WT-4)  
 - - - - - WALL TILE (WT-6)

REFER TO INTERIOR ELEVATIONS FOR ADDITIONAL INFORMATION ON WALL FINISHES.

FLOOR FINISH DESIGNATION  
 BASE FINISH DESIGNATION  
 COUNTER TYPE  
 (BY CFI MILLWORK VENDOR)

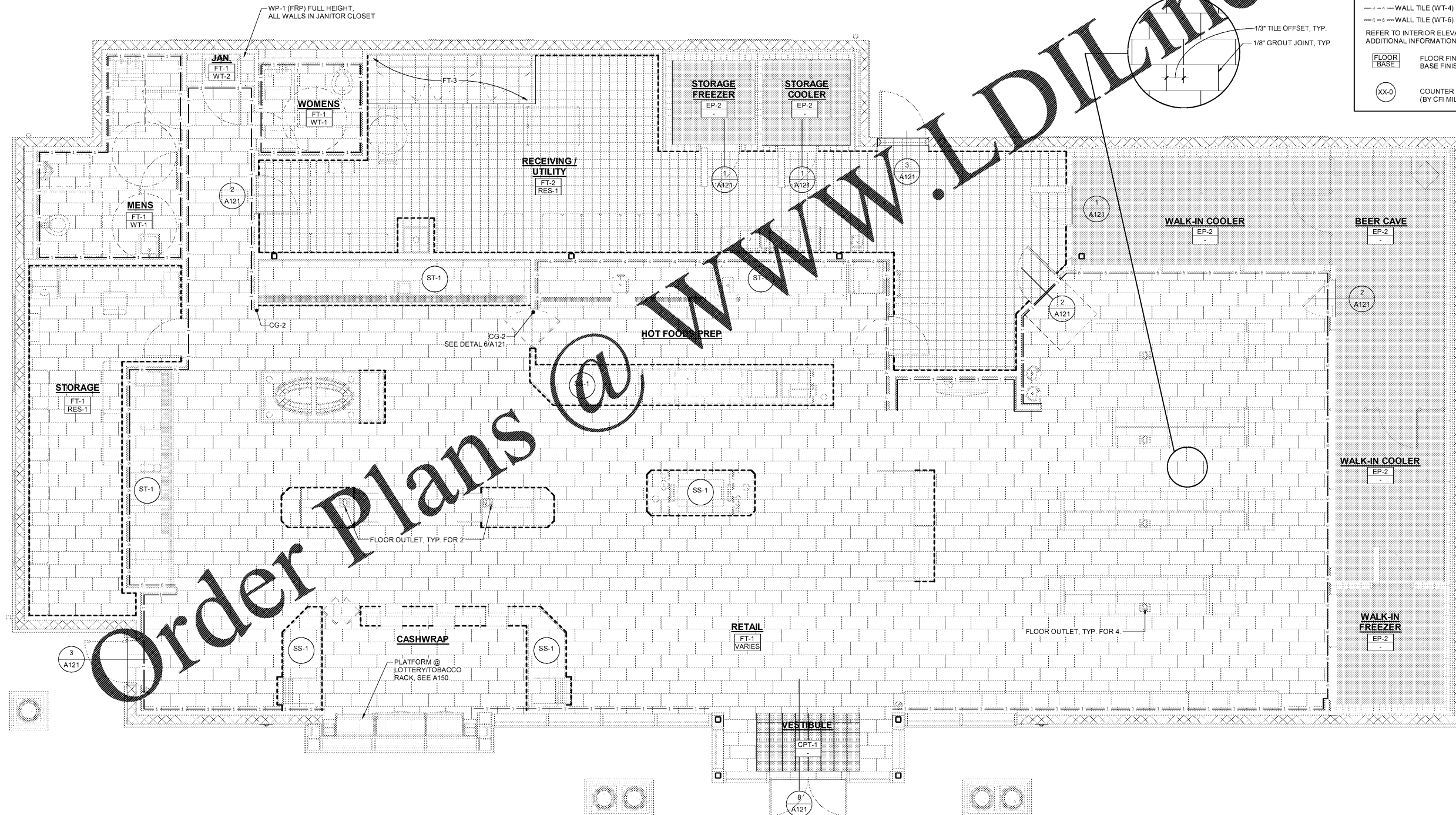

**HFA**  
 HARRISON FRENCH & ASSOCIATES, LTD.  
 508.528.0770  
 31 Hayward Street  
 Franklin, Massachusetts 02038  
 www.hfa-ae.com

STIPULATION FOR REUSE  
 THESE DRAWINGS ARE THE PROPERTY OF HARRISON FRENCH & ASSOCIATES, LTD. AND ARE NOT TO BE REPRODUCED, COPIED, OR TRANSMITTED IN ANY FORM OR BY ANY MEANS, ELECTRONIC OR MECHANICAL, INCLUDING PHOTOCOPYING, RECORDING, OR BY ANY INFORMATION STORAGE AND RETRIEVAL SYSTEM, WITHOUT THE WRITTEN PERMISSION OF HARRISON FRENCH & ASSOCIATES, LTD. ANY REUSE OF THESE DRAWINGS FOR ANY PROJECT OTHER THAN THAT SPECIFICALLY AUTHORIZED BY HARRISON FRENCH & ASSOCIATES, LTD. IS STRICTLY PROHIBITED. UNAUTHORIZED REUSE OF THESE DRAWINGS FOR ANY PROJECT OTHER THAN THAT SPECIFICALLY AUTHORIZED BY HARRISON FRENCH & ASSOCIATES, LTD. IS STRICTLY PROHIBITED.

**Cumberland**  
 SUNRISE & 4TH  
 FORT LAUDERDALE, FL 33304  
 JOB NUMBER: 41-17-00410

ISSUE BLOCK	
90% CDs	05/10/19
100% SET	06/14/19
90% AIM4.0	08/14/19
100% AIM 4.0	09/11/19

CHECKED BY:	JEO
DRAWN BY:	ZC
DOCUMENT DATE:	09/11/19

STATE OF FLORIDA  
 JAMES E. O'NEILL  
 ARCHITECT  
 ARS7371  
 Date: 2019/09/11 11:19:56-0400  
 James E. O'Neill, Architect  
 License #43822019  
 Harrison French & Associates, LTD  
 CCA #19-22890-1102

WALL & FLOOR FINISH PLAN

SHEET: A120

1 FLOOR FINISH PLAN  
 1/4" = 1'-0"

9/11/2019 3:20:41 PM  
 C:\Users\joh\OneDrive\Documents\2019 Rev\Projects\41-Fort Lauderdale\_A120\A120\_F1\_Landmark\_0202.dwg - A120\_F1.dwg (saved as)  
 1/4" WALL & FLOOR FINISH PLAN