

2 WALL SHEATHING (TYPE-5)  
3" = 1'-0"

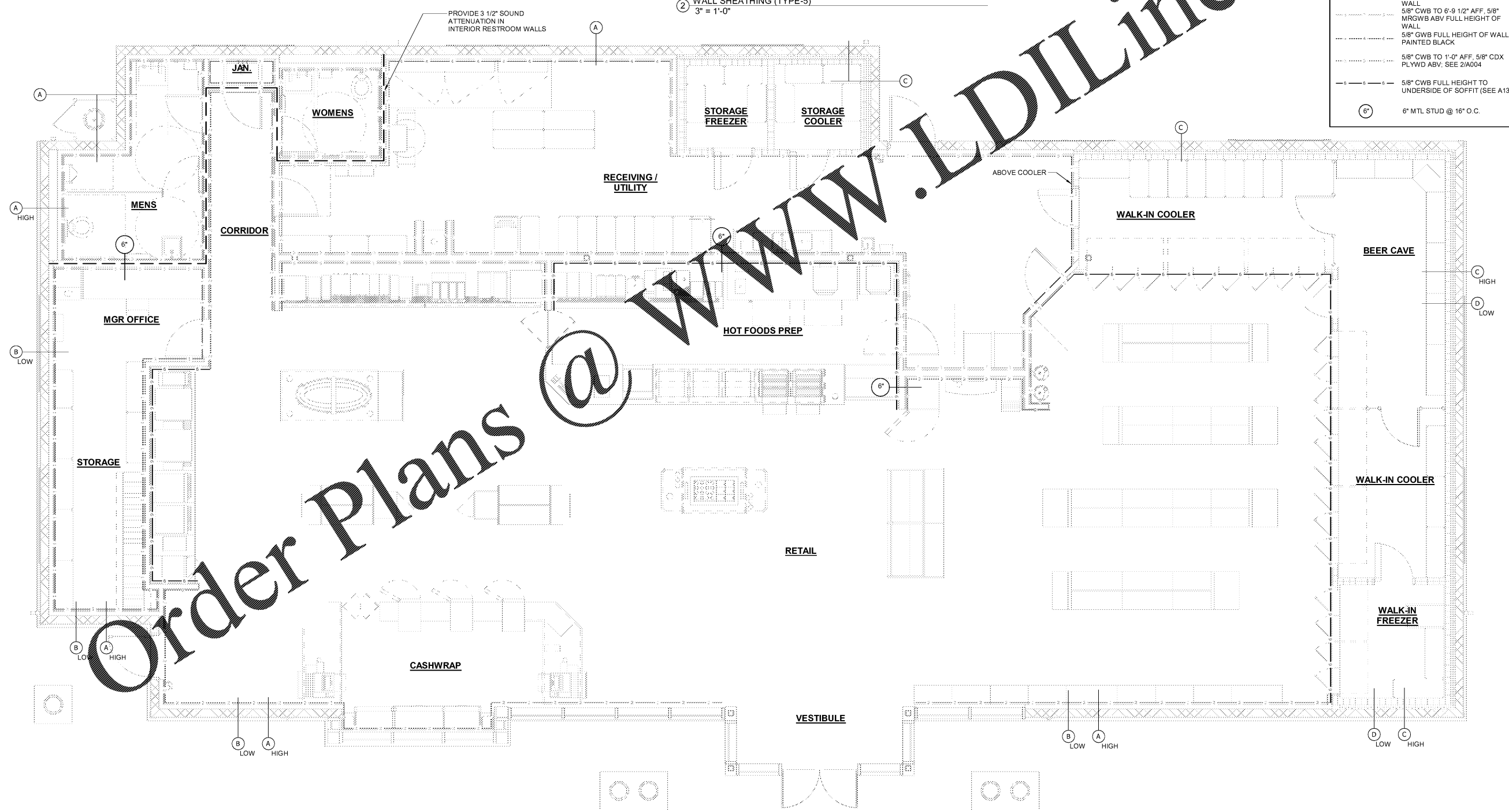

1 WALL SHEATHING PLAN  
1/4" = 1'-0"

**SPECIFICATIONS**

- BUILDING FIRE EXTINGUISHER:**  
LARSEN MODEL MP10 10 L13 MULTIPURPOSE DRY CHEMICAL UNIT FIRE EXTINGUISHER WITH WALL MOUNTING BRACKETS. UL RATING 4A-80B/C OR OTHER APPROVED EQUAL.  
FIRE EXTINGUISHERS SHALL BE INSTALLED BY G.C. IN ACCORDANCE WITH NFPA 10 & MANUFACTURERS INSTRUCTIONS. FINAL PLACEMENT IS TO BE COORDINATED IN THE FIELD WITH THE LOCAL AUTHORITY HAVING JURISDICTION.
- GYPSUM WALL BOARD MANUFACTURERS:**  
- US GYPSUM COMPANY  
- GOLD BOND BUILDING PRODUCTS  
- GEORGIA PACIFIC CORPORATION  
MATERIALS:  
- MAXIMUM PERMISSIBLE LENGTH: SQUARECUT ENDS, TAPERED EDGES; THICKNESS AS SHOWN ON DRAWINGS  
- STANDARD TYPE: ANSI/ASTM C36  
- MOISTURE RESISTANT TYPE: ANSI/ASTM C79; WATER REPELLANT PAPER FACES
- INTERIOR PAINT:**  
ALL INTERIOR PAINT IS TO BE "REGAL" BY BENJAMIN MOORE. ALL WALLS, DOORS, FRAMES & VERTICAL FACES OF SOFFITS SHALL BE PAINTED WITH AN EGGSHELL FINISH. ALL GWB CEILINGS & UNDERSIDE OF SOFFITS SHALL BE PAINTED WITH A FLAT FINISH.

**GENERAL NOTES**

- 5/8" GWB TO BE USED AT ALL WALLS NOT INDICATED WITH SHEATHING. NO SHEATHING REQUIRED BEHIND COOLERS AT EXTERIOR WALLS U.N.O.
- ALL METAL FRAMING SHALL BE 3-5/8" METAL STUDS @ 16" O.C. U.N.O.
- PROVIDE DEFLECTION TRACK AT THE TOP OF ALL WALLS RUNNING FROM THE FLOOR TO THE STRUCTURE ABOVE.
- PROVIDE TAPE & (3) COATS OF JOINT COMPOUND AT WALLS SCHEDULED TO RECEIVE A PAINT FINISH. (LEVEL 5 FINISH).
- PROVIDE (1) PRIME COAT & (2) FINISH COATS AT ALL AREAS SCHEDULED TO RECEIVE PAINT FINISH. ALL WALLS BEHIND MILLWORK TO BE PAINTED.
- ALL PARTS TO CONTINUE TO FLOOR BEHIND LONG SEAM WALLS OF HOT FOODS, CHILL ZONE EQUIPMENT & COFFEE EQUIPMENT.  
SEE A1 FOR SOFFIT FINISH COLORS.  
SEE A20 FOR FLOOR FINISHES.  
SEE A400 & A401 FOR INTERIOR ELEVATIONS.

**WALL SHEATHING PLAN LEGEND**

- 1 5/8" MRGWB FULL HEIGHT OF WALL
- 2 5/8" CWB TO 3'-11 1/2" AFF, 5/8" GWB ABOVE FULL HEIGHT OF WALL
- 3 5/8" CWB TO 6'-9 1/2" AFF, 5/8" MRGWB ABV FULL HEIGHT OF WALL
- 4 5/8" GWB FULL HEIGHT OF WALL PAINTED BLACK
- 5 5/8" CWB TO 1'-0" AFF, 5/8" CDX PLYWD ABV; SEE 2/A004
- 6 5/8" CWB FULL HEIGHT TO UNDERSIDE OF SOFFIT (SEE A130)
- 7 6" MTL STUD @ 16" O.C.

**HFA**  
HARRISON FRENCH & ASSOCIATES, LTD.  
508.528.0770  
31 Hayward Street  
Franklin, Massachusetts 02038  
www.hfa-ac.com

STIPULATION FOR REUSE  
THESE DRAWINGS ARE THE PROPERTY OF HARRISON FRENCH & ASSOCIATES, LTD. AND ARE NOT TO BE REPRODUCED, COPIED, OR TRANSMITTED IN ANY FORM OR BY ANY MEANS, ELECTRONIC OR MECHANICAL, INCLUDING PHOTOCOPYING, RECORDING, OR BY ANY INFORMATION STORAGE AND RETRIEVAL SYSTEM, WITHOUT THE WRITTEN PERMISSION OF HARRISON FRENCH & ASSOCIATES, LTD. ANY UNAUTHORIZED REUSE OF THESE DRAWINGS IS PROHIBITED AND WILL BE CONSIDERED A VIOLATION OF THE PROFESSIONAL ENGINEERING BOARD OF REGISTRATION FOR PROFESSIONAL ENGINEERS AND ARCHITECTS ACT AND MAY BE CONSIDERED A VIOLATION OF THE PROFESSIONAL ENGINEERING BOARD OF REGISTRATION FOR PROFESSIONAL ENGINEERS AND ARCHITECTS ACT.

**Cumberland**  
SUNRISE & 4TH  
FORT LAUDERDALE, FL 33304  
JOB NUMBER: 41-17-00410

**ISSUE BLOCK**

90% CDs	05/10/19
100% SET	06/14/19
90% AIM4.0	08/14/19
100% AIM 4.0	09/11/19

CHECKED BY: JEO  
DRAWN BY: ZC  
DOCUMENT DATE: 09/11/19

STATE OF FLORIDA  
JAMES E. CHERRY  
ARCHITECT  
A037371  
James E. Cherry  
Date: 2019/09/11 11:21:16-04'00'  
James E. Cherry, Architect  
11000 E. Colonial Dr.  
Harrison French & Associates, LTD.  
Franklin, MA 02038-1100

WALL SHEATHING PLAN

SHEET: A004

9/11/2019 3:28:38 PM  
C:\Users\cherry\Documents\2019 Revit Projects\41-17-00410\_A004\F1\_Laundry\_5022\_M\_Arch\_17B\_2019.dwg (shaded.plt)  
WALL SHEATHING PLAN