

PLANT SCHEDULE

TREES	QTY	COMMON NAME	BOTANICAL NAME	SPECIFICATIONS	CAL/DBH	HEIGHT	SPREAD	NATIVE	XERIC	REMARKS
CS	7	Orange Geiger Tree	Cordia sebestena	25 gal	2" Cal	10' Ht	4'	Yes	High	4.5' clear trunk
IC2	7	Dahoon Holly	Ilex cassine	B & B	2.5" Cal	12' Ht	4'-5'	Yes	High	4' CT
LN	8	Crape Myrtle	Lagerstroemia x 'Natchez'	25 gal	2.5" Cal	12' Ht	5'	No	High	STANDARD
LT	14	Tuskegee Crape Myrtle	Lagerstroemia x 'Tuskegee'	25 gal	2" Cal	10' Ht	4'	No	High	4' CT; Standard
LW	5	Wild Tamarind	Lysioloma latisiliqua	B & B	3.5" Cal	14' Ht	5'-6'	Yes	High	7' ct
LW2	6	Wild Tamarind	Lysioloma latisiliqua	B & B	2.5" Cal	12' Ht	5'-6'	Yes	High	7' ct
QV	5	Southern Live Oak	Quercus virginiana	B & B	3.5" Cal	16' Ht	5'-6'	Yes	High	5' CT

RELOCATIONS	QTY	COMMON NAME	BOTANICAL NAME	SPECIFICATIONS	CAL/DBH	HEIGHT	SPREAD	NATIVE	XERIC	REMARKS
SPR	4	Cabbage Palmetto	Sabal palmetto	NA	Varies	As Noted on Sheet L-1	varies	Yes	High	

STREET TREES	QTY	COMMON NAME	BOTANICAL NAME	SPECIFICATIONS	CAL/DBH	HEIGHT	SPREAD	NATIVE	XERIC	REMARKS
CE3	13	Silver Button Wood	Conocarpus erectus sericeus	B & B	3" Cal	12' Ht	5'-6'	Yes	High	
QV3	6	Southern Live Oak	Quercus virginiana	B & B	3" Cal	14-16' ht.	5'	Yes	High	5' CT
RE	7	Florida Royal Palm	Roystonea elata	B & B		20' gw	20'	Yes	High	Matched

PALM TREES	QTY	COMMON NAME	BOTANICAL NAME	SPECIFICATIONS	CAL/DBH	HEIGHT	SPREAD	NATIVE	XERIC	REMARKS
SP	4	Cabbage Palmetto	Sabal palmetto	B & B		16' c.t.	10'	Yes	High	hurricane cut
VM	8	Montgomery Palm	Veitchia montgomeryana	30 gal		18-22' oa	12'	No	High	single trunk

SHRUBS	QTY	COMMON NAME	BOTANICAL NAME	SPECIFICATIONS	SPACING	HEIGHT	SPREAD	NATIVE	XERIC	REMARKS
CHH	455	Red Tip Cocoplum	Chrysobalanus icaco 'Red Tip'	NA	24"	24"	18-24"	Yes	High	full to base

SHRUB AREAS	QTY	COMMON NAME	BOTANICAL NAME	SPECIFICATIONS	SPACING	HEIGHT	SPREAD	NATIVE	XERIC	REMARKS
DUR	201	Sky Flower	Duranta repens 'Dwarf Golden'	n/a	18"	16-18"	16-18"	Yes	High	Full
HAP	337	Dwarf Fire Bush	Hamelia patens 'compacta'	-	24"	18-24"	18-24"	Yes	High	Full to base
MUH	306	Pink Muhly Grass	Muhlenbergia capillaris	n/a	24"	16-18"	16-18"	Yes	High	
NEB	77	Boston Fern	Nephrolepis exaltata 'Bostoniensis'	n/a	24"	18"	18"	Yes	High	

GROUND COVERS	QTY	COMMON NAME	BOTANICAL NAME	SPECIFICATIONS	SPACING	HEIGHT	SPREAD	NATIVE	XERIC	REMARKS
FIM	728	Green Island Ficus	Ficus microcarpa 'Green Island'	1 gal	18"	14-16"	14-16"	No	Medium	
ILX	140	Dwarf Schillings Holly	Ilex vomitoria 'Schillings Dwarf'	n/a	18"	14-16"	14-16"	Yes	High	

SOD/SEED	QTY	COMMON NAME	BOTANICAL NAME	SPECIFICATIONS	SPACING	HEIGHT	SPREAD	NATIVE	XERIC	REMARKS
BAH	668 sf	Bahia Grass	Paspalum notatum 'Argentine'	grass					High	
SO2	2,453 sf	St. Augustine Grass	Stenotaphrum secundatum	grass				No	Medium	Right-of-Way Sod
SOD	4,365 sf	St. Augustine Grass	Stenotaphrum secundatum	grass				No	Medium	

NOTE: GALLON SIZES ARE SHOWN AS AN AID TO BIDDERS. SIZE SPECIFICATIONS PREVAIL. UNLESS OTHERWISE NOTED, ALL SOD TO BE STENOTAPHRUM SECUNDATUM, V. FLORITAM, ST. AUGUSTINE SOLID SOD. ANY EXISTING SOD DAMAGED DURING CONSTRUCTION SHALL BE REPLACED BY CONTRACTOR.

CITY OF FORT LAUDERDALE, FLORIDA - LANDSCAPE REQUIREMENTS
CUMBERLAND FARMS - SUNRISE BLVD & SE 4TH AVE

ZONING: B-2
PROPOSED USE: COMMUNITY BUSINESS
NET SITE AREA: 58,987.02 sq.ft. (1,354.1 Ac.)
VEHICULAR USE AREA: 36,836 sq.ft. (.84 Ac.)

REQUIRED	PROVIDED
7,307.2 sq.ft. 11 Trees	11,823 sf 11 Trees
1,260 sq.ft. 8 Trees	1,432.49 sf 8 Trees
38 Trees	38 Trees
10 Trees	10 Trees
8 Trees	8 Trees
4 Trees	7 Trees
445 Shrubs	1478 Shrubs
13 Shrubs	13 Shrubs
7 Trees	8 Trees
8 Trees	8 Trees
83 TREES	83 TREES
5,811.5 sq. ft.	4,819 sq. ft.
34 TREES	57 TREES

FLORIDA FRIENDLY GUIDELINES
50% Max of VUA Landscape to be Turf Grass (11,823 sq. ft.)

NATIVE TREE REQUIREMENT
A. 40% Minimum of Required Trees Shall Be Native

MITIGATION (REFER TO SHEET LD-11)
TOTAL CALIPER REPLACEMENT REQUIRED FOR NON-SPECIMEN TREES IN FAIR OR POOR CONDITION & AFFECTED AREA REMOVED FROM SITE: 37.64" (FROM 8 REMOVED TREES; SEE SHEET CF08.1 & CF08.2)
TOTAL CAL. REPLACEMENT PROVIDED: 0"
37.64" CAL. REPLACEMENT REMAINING X \$85 = \$2,446.80
79 TRUNK FEET OF PALMS REMOVED FROM SITE X \$30/TRUNK FOOT = \$2,370.00
\$2,446.80 + \$2,370 = \$4,816.80 DEPOSITED INTO TREE CANOPY TRUST FUND (8 CLASS F TREES TO BE REMOVED - NO VALUE)

TOTAL PALMS REMOVED FROM SITE, TO BE REPLACED @ 1:1 = 9 PALMS
TOTAL REPLACEMENT PALMS PROVIDED: 9 PALMS (SEE ABOVE)

24 TRUNK FEET OF CABBAGE PALM TO BE RELOCATED ON SITE
TOTAL PALM REPLACEMENT VALUE @ \$30/TRUNK FOOT = \$720.00
TOTAL PALM BOND VALUE: \$720.00

1 TYP. C.U. STRUCTURAL SOIL DETAIL (FT. LAUDERDALE STD. DETAIL)

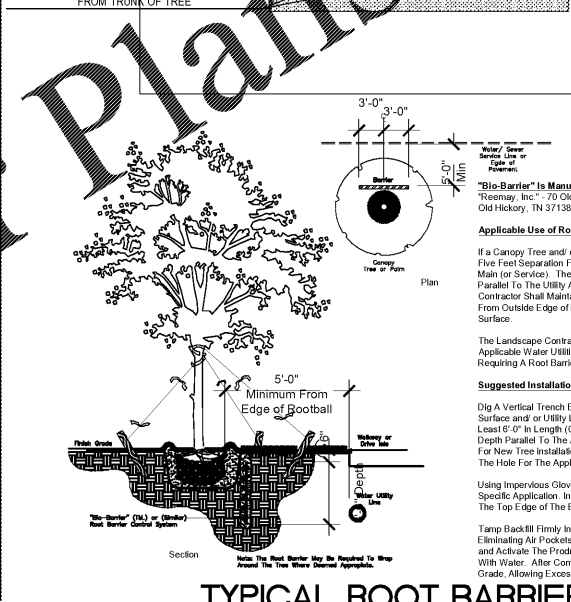
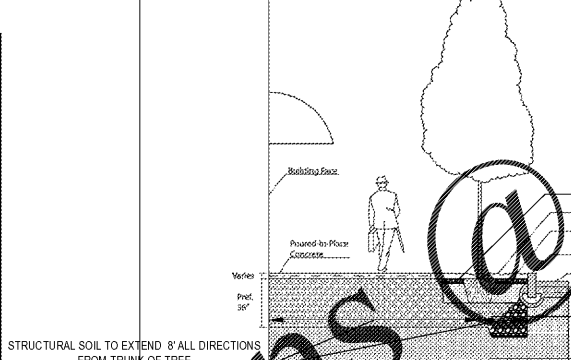

NOTE: STREET TREES SHOW STRUCTURAL SOIL AREA FOR CLARITY, HOWEVER ALL PROPOSED LARGE TREES/PALMS SURROUNDED ON 4 SIDES BY PAVED AREAS SHALL BE PLANTED IN STRUCTURAL SOIL WITH A MINIMUM OF 8' RADII FROM TRUNK OF TREE IN ALL DIRECTIONS UNTIL MEETING EXISTING CURB. SEE STRUCTURAL SOIL DETAIL ON SHEET LD-11.

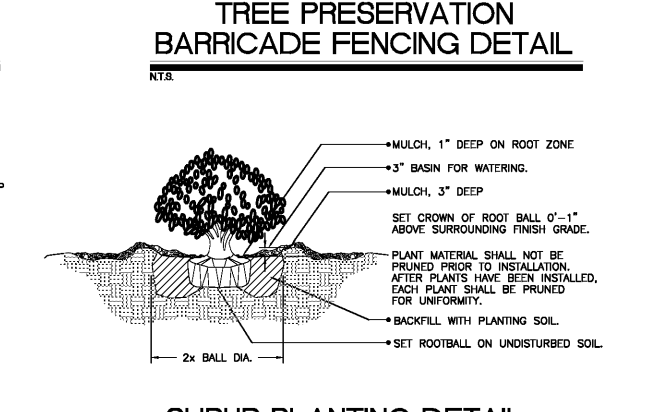
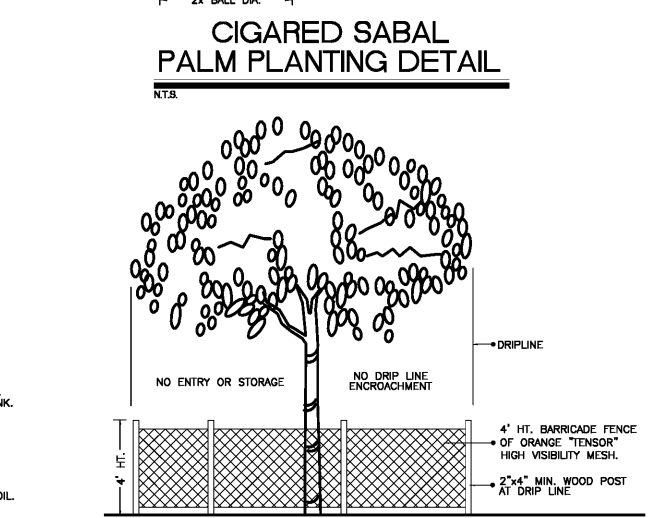
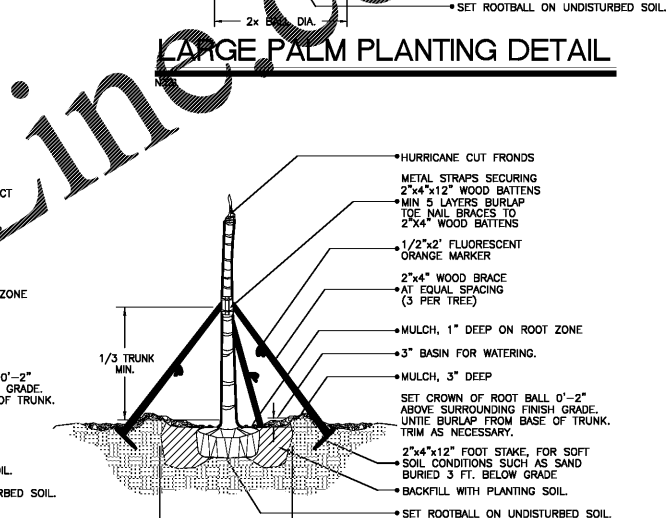
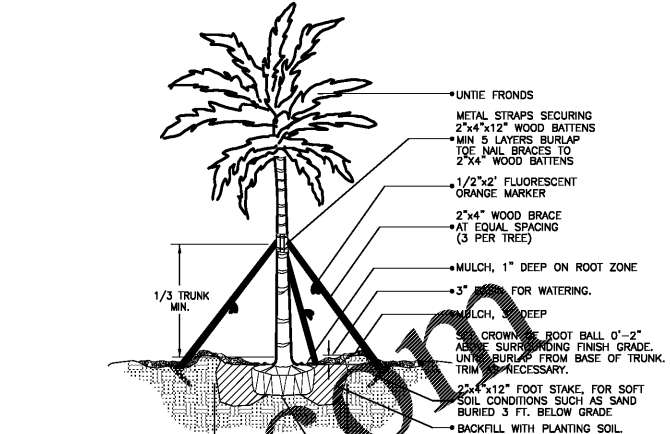
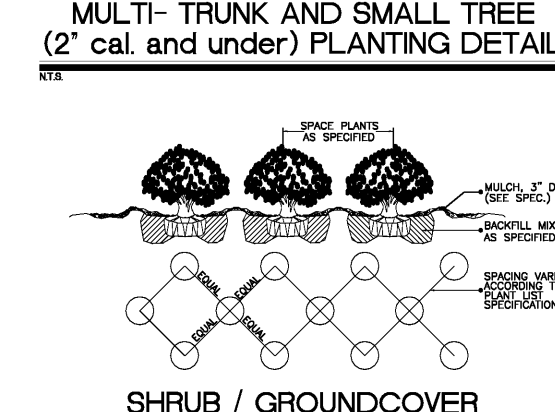
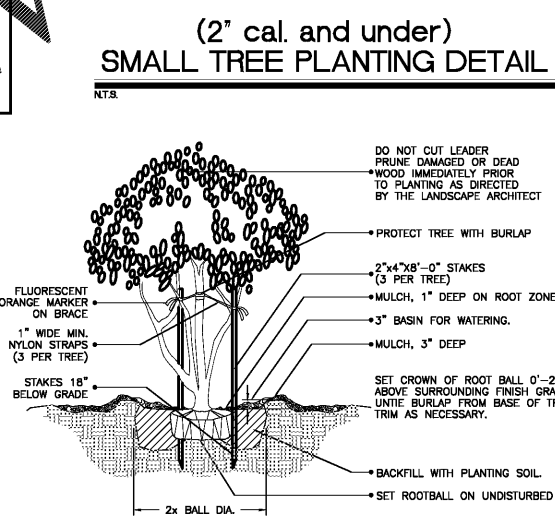
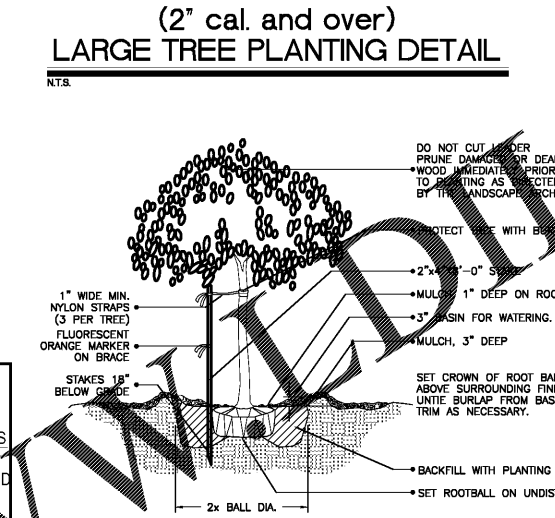
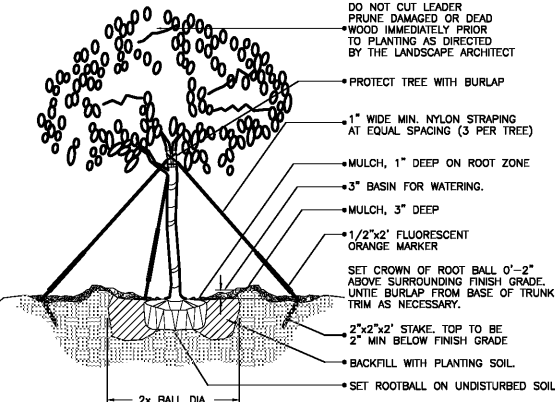

THOMAS ENGINEERING GROUP
CIVIL ENGINEERS - PROJECT MANAGERS - LAND PLANNING - LANDSCAPE ARCHITECTS
1000 CORPORATE DR. SUITE 600 FORT LAUDERDALE, FL 33304
PH: (954) 202-7000 FAX: (954) 202-7070
WWW.THOMASENGINEERINGGROUP.COM

REVISIONS:

REV.	DATE	COMMENT	BY
1	03/07/18	ISSUED 75% RESUBMITTAL	MDG
2	09/25/18	ISSUED 75% RESUBMITTAL	MDG
3	11/06/18	RESPONSE TO 75% COMMENTS	MAT
4	01/04/19	ADDRESS TRAFFIC ENG. CONDITIONS	MAT
6	10/09/19	REVISED SIGNS	MDG

811 KNOW WHAT'S BELOW ALWAYS CALL 811 BEFORE YOU DIG
www.callsunshine.com

100% PLANS SUBMITTAL
PROJECT No.: F150057
DRAWN BY: JFV
CHECKED BY: MAT
DATE: 09/11/2019
CAD I.D.: F150057-LANDSCAPE PLAN

CUMBERLAND FARMS
SUNRISE BLVD. & NE 4TH AVENUE
FOR CUMBERLAND FARMS

THOMAS ENGINEERING GROUP
RADICE III
1000 CORPORATE DRIVE, SUITE 250
FORT LAUDERDALE, FL 33334
PH: (954) 202-7000
FX: (954) 202-7070
www.ThomasEngineeringGroup.com

MICHAEL D. GROSSWIRTH
REGISTERED LANDSCAPE ARCHITECT
October 10, 2019
FLORIDA REGISTRATION #15871
FLORIDA BUSINESS REGISTRATION #17178

SHEET TITLE: **LANDSCAPE SCHEDULES AND DETAILS**
SHEET NUMBER: **CFG08.3**