



PRH
MEDICAL OFFICE BUILDING
NAPLES, FLORIDA

THIS DOCUMENT CONTAINS PROPRIETARY TO DAVIS STORES ARCHITECTS INFORMATION. IT IS THE PROPERTY OF DAVIS STORES ARCHITECTS AND IS NOT TO BE REPRODUCED, COPIED, OR OTHERWISE TRANSMITTED IN ANY FORM OR BY ANY MEANS, WITHOUT THE PRIOR WRITTEN PERMISSION OF DAVIS STORES COLLABORATIVE, P.C. COPYRIGHT 2019. ALL RIGHTS RESERVED.

DAVIS STORES COLLABORATIVE P.C.
7121 CROSSROADS BVD
888-HYWOOD, IN 37027
TEL: (615) 726-0310
FAX: (615) 726-0310
www.dscarch.com

DSC ARCHITECTS

REVISIONS	
NO.	DESCRIPTION

ELECTRICAL
SITE PLAN

E0.01

ISSUE DATE: 11.12.19 JOB NUMBER: 19020

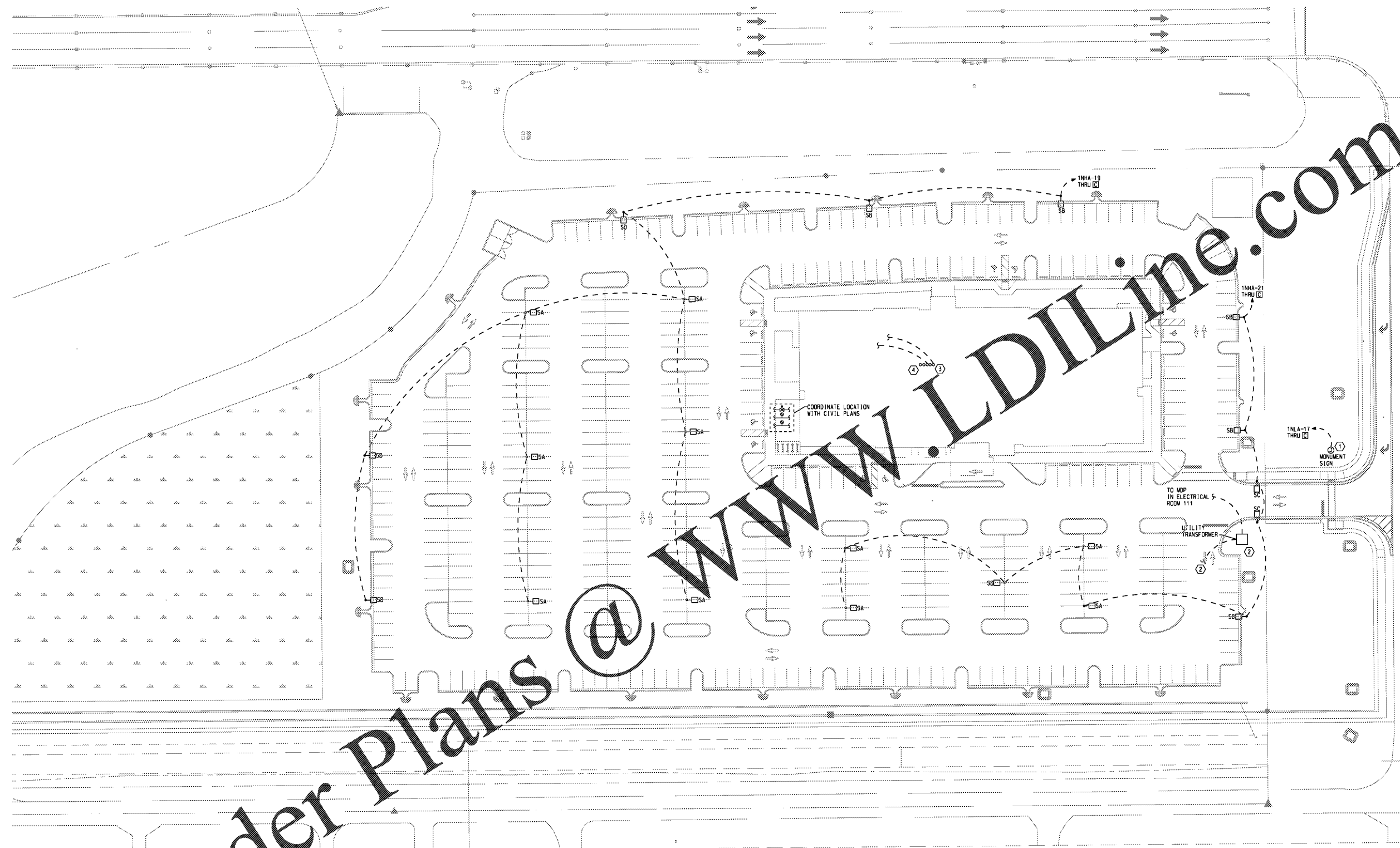

Order Plans @ www.LDILine.com

- PLAN NOTES:**
- COORDINATE EXACT LOCATION OF MONUMENT SIGN WITH CIVIL SITE PLAN. COORDINATE ADDITIONAL REQUIREMENTS WITH SIGN VENDOR/INSTALLER.
 - PROVIDE QUANTITY AND SIZE OF CONDUITS AS REQUIRED BY LOCAL POWER COMPANY FROM PAD MOUNTED TRANSFORMER TO PRIMARY CONNECTION POINT. COORDINATE EXACT LOCATION OF PRIMARY CONNECTION POINT, TRANSFORMER PAD SIZE, TRANSFORMER LOCATION, REQUIREMENTS, ETC. WITH LOCAL POWER COMPANY PRIOR TO BID.
 - PROVIDE (4) 4" CONDUITS WITH PULL STRING TO TELEPHONE SERVICE CONNECTION. COORDINATE ALL REQUIREMENTS WITH TELEPHONE COMPANY.
 - PROVIDE (1) 4" CONDUITS WITH PULL STRING TO CABLE SERVICE CONNECTION. COORDINATE ALL REQUIREMENTS WITH CABLE COMPANY.

**ELECTRICAL
SITE PLAN**

