

TILT-UP PANEL ELEVATIONS

- NOTES:
- 1) SEE 91.00 FOR ADDITIONAL TILT-UP NOTES.
 - 2) COORDINATE ALL DIMENSIONS WITH ARCHITECTURAL DRAWINGS.
 - 3) PROVIDE 15' TILT-UP PANELS W/ #4@12\"/>
 - 4) MAXIMUM REVEAL DEPTH ALLOWED SHALL BE $\frac{3}{8}$ ".
 - 5) STAGGER LAP SPICES WITHIN WALL PIERS.
 - 6) CONTRACTOR TO COORDINATE ALL DOOR, WINDOW, & BLOCKOUT OPENING SIZES & LOCATIONS W/ ARCHITECTURAL DRAWINGS.
 - 7) DO NOT CORE THRU WALL PANELS WITHOUT PRIOR WRITTEN APPROVAL OF STRUCTURAL ENGINEER. CONTRACTOR TO COORDINATE LOCATIONS OF ANY MECHANICAL, ELECTRICAL, & PLUMBING PENETRATIONS PRIOR TO THE SHOP DRAWING PROCESS.
 - 8) ELEVATIONS DRAWN AS VIEWED FROM BUILDING INTERIOR UNO, SEE 91.01.
 - 9) Ⓜ - INDICATES TIED COLUMN MARK, SEE 5/86.01 FOR COLUMN SCHEDULE.
 - 10) SEE TYPICAL TILT-UP PANEL LAYOUT ON 9/86.00 FOR REMAINDER OF INFORMATION.
 - 11) PROVIDE PANEL-TO-PANEL CONNECTIONS AT CORNERS AND INTERSECTING PANELS. SEE 4/86.00 & 7/86.00 FOR REMAINDER OF INFORMATION.
 - 12) SEE 9/86.00 FOR HOOKED HORIZONTAL REINFORCING AT PIERS LESS THAN 2'-0" WIDE.
 - 13) SEE 9/82.01 AND 9/86.00 FOR HOOKED VERTICAL REINFORCING AT LOW FIRST FLOOR WINDOWS AND FIRST FLOOR DOORS.
 - 14) COORDINATE LOCATION OF EMBEDS FOR FLOOR FRAMING MEMBERS AND ROOF FRAMING MEMBERS WITH FRAMING PLANS AND DETAILS.
 - 15) ≡≡≡ INDICATES T RECESSES IN 15' PANEL W/ #4@6\"/>
 - 16) ≡≡≡ INDICATES R RECESSES IN 17' PANEL W/ #4@6\"/>

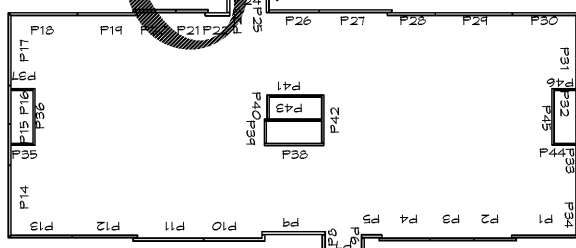

WWW.LDILine.com



PRM MEDICAL OFFICE BUILDING
 NAPLIS, FLORIDA

THIS DOCUMENT CONTAINS INFORMATION THAT IS PROPRIETARY AND CONFIDENTIAL TO DAVIS STOKES COLLABORATIVE P.C. ANY REPRODUCTION OR DISCLOSURE TO OTHERS WITHOUT THE WRITTEN CONSENT OF DAVIS STOKES COLLABORATIVE P.C. IS PROHIBITED. COPYRIGHT RIGHTS RESERVED.

DAVIS STOKES COLLABORATIVE P.C. | 7121 CROSSROADS BLVD. | BRENTWOOD, TN 37027
 TEL: (615) 726-0000 | FAX: (615) 726-0000
 MAIL: dca@dsccol.com | WWW: www.dsccol.com

DSC ARCHITECTS

| REVISIONS | |
|-----------|-------------|
| NO. | DESCRIPTION |
| | |
| | |
| | |
| | |
| | |
| | |

TILT WALL PANEL ELEVATIONS

S5.04

ISSUE DATE: 11/12/19 | JOB NUMBER: 19020