

**CEILING SYMBOL LEGEND**

TYPE	CEILING TYPE	CEILING HEIGHT	NOTE	LIGHT FIXTURES (REFER TO ELECTRICAL DRAWINGS)
(X-X)	CEILING TYPE	CEILING HEIGHT		(P-X) CEILING MOUNTED PENDANT LIGHT
[Symbol]	HVAC SUPPLY DEVICES (REFER TO MECHANICAL DRAWINGS)			(DL-X) CEILING MOUNTED SEMI-RECESSED FIXTURE W/ FIRE RATED JUNCTION BOX
[Symbol]				(L-X) LED COVE LIGHTING
[Symbol]	2X2 ACOUSTICAL LAY-IN CEILING TILE			(LP-X) LINEAR PENDANT (SEE LIST OF FINISHES FOR TYPE)
[Symbol]	GYP-SUM BOARD			(SC-X) WALL SCONCE
				(X) FIRE PROTECTION SPRINKLER HEAD
				(F) FIRE ALARM PULL STATION
				(A) ACCESS DOOR

**GENERAL RCP NOTES**

- DO NOT SCALE DRAWINGS. IF DIMENSIONS CANNOT BE DETERMINED OR DOCUMENTS ARE IN CONFLICT, THE CONTRACTOR SHALL OBTAIN CLARIFICATION FROM THE ARCHITECT PRIOR TO CONTINUATION OF WORK.
- REFER TO PROJECT INFORMATION SHEET FOR MATERIAL / REFERENCE SYMBOLS AND ABBREVIATIONS.
- REFER TO MECHANICAL, ELECTRICAL, FIRE SUPPRESSION & TECHNOLOGY DRAWINGS FOR QUANTITY AND TYPE OF CEILING MOUNTED FIXTURES / DEVICES.
- ALL CEILING MOUNTED FIXTURES, DEVICES, ETC. ARE TO BE CENTERED WITHIN THE CEILING TILE, UNLESS OTHERWISE NOTED.
- WHERE PENDANT LIGHT FIXTURES ARE UTILIZED, GENERAL CONTRACTOR TO PROVIDE APPROPRIATE BLOCKING FOR FIXTURE WEIGHT AND ASSEMBLY.
- PROVIDE CONTROL JOINTS @ 30'-0" O.C. MAX AT ALL GYP-SUM BOARD BULKHEADS. LOCATE TO BE EVENLY SPACED OR TO ALIGN WITH COLUMN CENTERLINES, ADJACENT WALLS, OR OTHER ARCHITECTURAL ELEMENTS. REVIEW PROPOSED LOCATIONS WITH ARCHITECT PRIOR TO INSTALLATION.
- REFER MECHANICAL AND ELECTRICAL DRAWINGS FOR MOUNTING LOCATIONS OF ITEMS WHERE NO CEILING ARE REQUIRED OR INDICATED.
- REFER TO ELECTRICAL DRAWINGS FOR LIGHTING FIXTURE SCHEDULE.
- REFER TO MECHANICAL DRAWINGS FOR DIFFUSER FINISH SCHEDULE.
- SPRINKLER HEADS WITH GYP-SUM BOARD CEILING TO BE FULLY CONCEALED WITH WHITE COVER PLATES. SPRINKLER LOCATIONS SHOWN ARE FOR PRELIMINARY INTENT. VERIFY LOCATION WITH FIRE MARSHALL PRIOR TO INSTALLATION.
- PROVIDE INDIVIDUAL SWITCHES FOR EACH LIGHT FIXTURE WITHIN AN ENCLOSED ROOM, UNLESS OTHERWISE NOTED. MULTIPLE SWITCHES WITHIN A SINGLE COVER PLATE, IF SPACING OF SWITCHES IS NOT POSSIBLE, INDIVIDUAL SWITCHES SHALL BE FULLY SPACED TO THE CENTER OF THE COVER PLATE.
- WHERE ACOUSTICAL CEILING TILES TO BE INSTALLED, CENTER THE CEILING GRID WITHIN THE ROOM IN BOTH DIRECTIONS, UNLESS OTHERWISE NOTED.

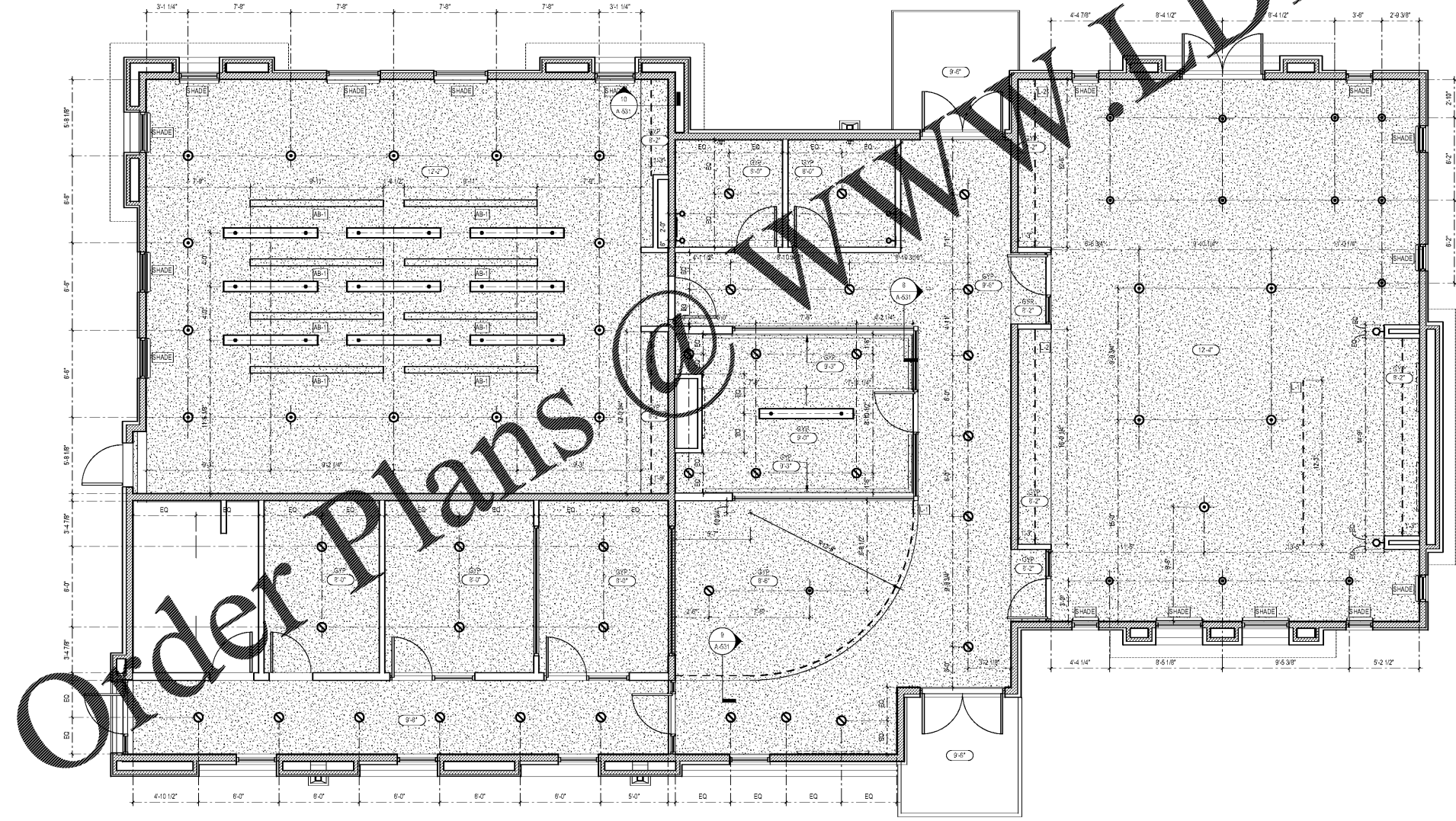

1 FLOOR 1 REFLECTED CEILING PLAN  
1/4" = 1'-0"

1925 Prospect Ave.  
Orlando, FL 32814  
P (407) 661-9100  
F (407) 661-9101  
www.r.p.com



CLIENT NAME  
**HUTTON DEVELOPMENT**  
756 Cherry Street  
Chattanooga, TN 37402

PROJECT NAME  
**ROCKLEDGE FLATS - BUILDING C**  
220 Barton Boulevard  
Rockledge, FL 32955

FLOOR TITLE  
**FLOOR 1 REFLECTED CEILING PLAN**

Revision Schedule	
No.	Description

PROJECT NO. 21002	DATE 20/01/01	DRAWN [Name]	CHECKED [Name]
----------------------	------------------	-----------------	-------------------

A-701

GMP PRICING SET 15 NOVEMBER 2019