

Order Plans @ www.walldesign.com

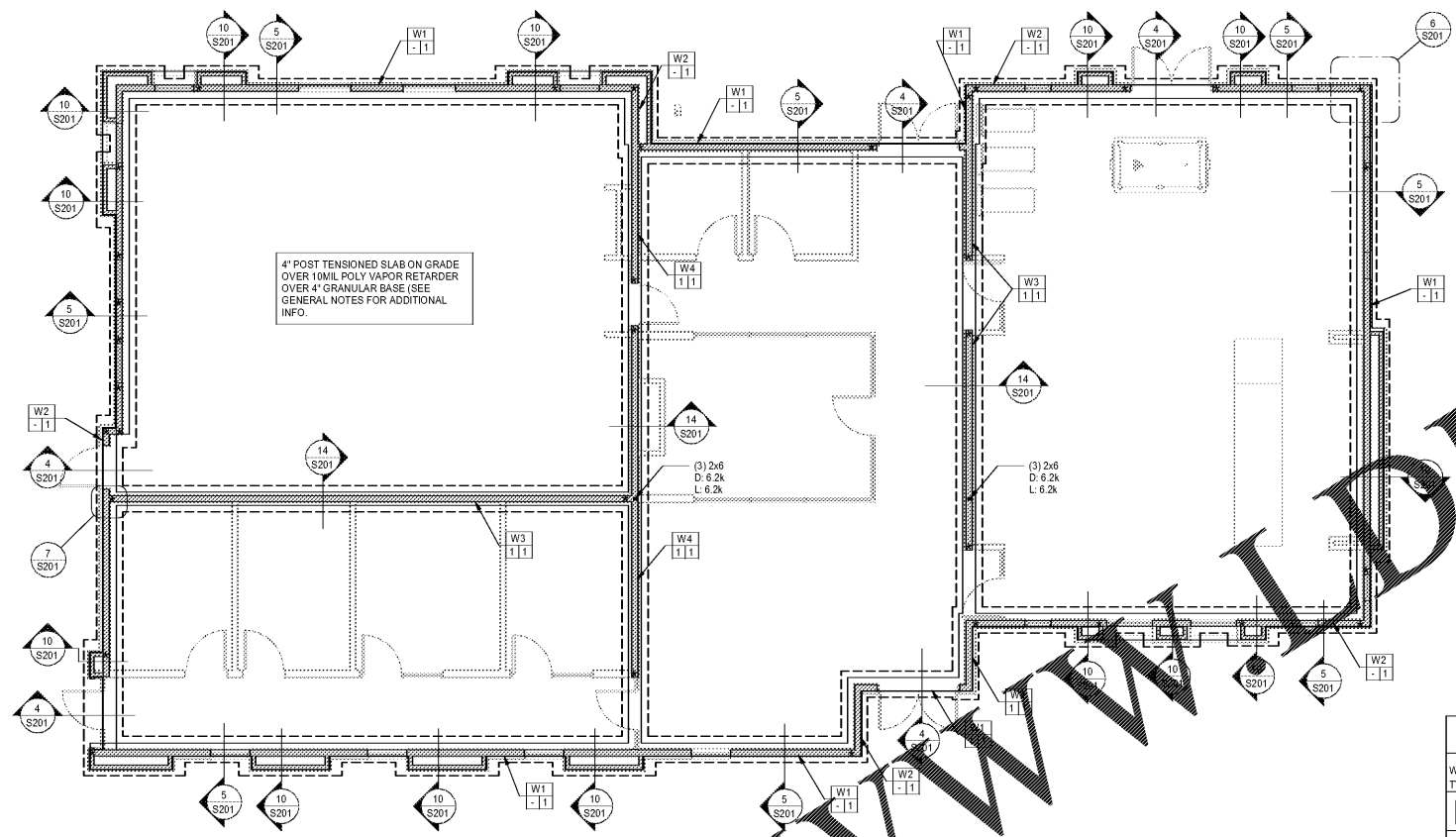

WALL LOADING INFORMATION

MARK	DL (L)	LL (PLF)
W1	925	525
W2	675	100
W3	525	725
W4	100	325

NOTES:
 1) DL INDICATES TOTAL DEAD LOAD
 2) LL INDICATES TOTAL LIVE LOAD
 3) ALL LOADS ARE SERVICE LEVEL
 4) (PLF) INDICATES POUNDS PER LINEAL FOOT

STRUCTURAL WALL LEGEND

WALL TYPE	FRAMING SIZE	STUD SPACING	NOTES
W1	2x6	16" O.C.	No. 2 SYP OR DFL
W2	2x6	16" O.C.	No. 2 SYP OR DFL
W3	2x6	16" O.C.	No. 2 SYP OR DFL
W4	2x6	16" O.C.	No. 2 SYP OR DFL

NOTES:
 1. NON-LOAD BRG. WALL SHALL BE 2x4 @ 16" O.C.
 2. BEARING WALL STUDS SHALL BE ALIGNED DIRECTLY BELOW FLOOR OR ROOF TRUSS.
 3. ALL FRAMING SHALL BE PLATFORM FRAMED.
 4. STUDS SHALL BE CONT. AND BALLOONED FRAMED.
 5. SEE ARCH FOR ADDITIONAL INFORMATION.

1 FOUNDATION PLAN - CLUBHOUSE
 SCALE: 3/16" = 1'-0"

- NOTES:**
- TOP OF INTERIOR FTG. = F.E. - 4'-0"
 - TOP OF EXTERIOR FTG. = F.E. - 1'-0" (1'-0" BELOW EXTERIOR GRADE WHICHEVER IS LOWER U.N.O.)
 - THE CONTRACTOR SHALL COORDINATE ANY UNDER SLAB PIPING, CONDUITS OR ANY UTILITIES PRIOR TO POURING FOOTINGS. RESOLVE ANY CONFLICT TO ENGINEER IMMEDIATELY. SEE ARCH FOR ANY LOCATIONS AND OR DIMENSIONS NOT SHOWN.
 - SEE DETAIL 11S/31 FOR SLAB CONTROL JOINTS.
 - SEE DETAIL 11S/31 FOR FOOTING SCHEDULE.
 - TEXT - INDICATE FOOTING MARK. SEE PLAN FOR FOOTING SCHEDULE.
 - INDICATES LOAD BEARING WOOD STUD WALLS.
 - 0'-0" - INDICATES STEP IN FOOTING SEE DETAIL 2/S201 FOR REINFORCING
 - SEE 6&7/S201 FOR TYPICAL CONTINUITY REINFORCING DETAILS FOR CORNERS AND INTERSECTIONS OF FOOTINGS AND WALLS.
 - STRUCTURAL WALL LEGEND WALL FRAMING DESIGNATION. (SEE PLAN FOR STRUCTURAL WALL LEGEND)
 - ARROW SIDE SHEATHING. (SEE PLAN FOR SHEATHING SCHEDULE)
 - OPPOSITE SIDE SHEATHING. (SEE PLAN FOR SHEATHING SCHEDULE)
 - ALL FRAMING TO BE PLATFORM FRAMED. (U.N.O.)
 - ▲ DENOTES SHEARWALL HOLDDOWN. SEE DETAIL 4/S301 FOR SCHEDULE.

SHEATHING/SHEAR WALL SCHEDULE

WALL TYPE	WALL MATERIAL	EDGE NAILING	SILL ANCHORS	SOLE > NAILING	REMARKS					
MARK	TYPE	THICKNESS	SIDES	SPA	SIZE	SPA	SIZE	SPA	SIZE	RE. NOTES
1	PLYWOOD (STRUCT 1)	15/32"	1	0"	10d COMMON	16"	1/2"	-	-	1, 4

NOTES:
 IF ARCH SHOWS 1 HR. WALL ASSEMBLY, REFER TO UL ASSEMBLY REQUIREMENTS FOR MINIMUM WALL MATERIAL THICKNESS.

- NAIL SPACING INDICATED IS FOR EDGE NAILING OF THE SPECIFIED WALL MATERIAL. TYPICAL INTERMEDIATE STUDS (FIELD NAILING) AND BLOCKING, IF PRESENT, SHALL BE NAILED AT 12" O.C. @ PLYWOOD SHEARWALLS. OMIT SILL ANCHORS AT UPPER LEVELS.
- WALL SEGMENTS WITH HEIGHT TO WIDTH RATIOS GREATER THAN 2 TO 1 SHALL BE BLOCKED CONSTRUCTION. ALL WALL SEGMENTS SHALL BE UNBLOCKED CONSTRUCTION.
- SINKER NAILS MAY BE SUBSTITUTED PROVIDED THE SHEAR CAPACITY MATCHES COMMON NAILS. SEE 3/S301 FOR TYP. SHEARWALLS.

1925 Prospect Ave.
 Orlando, FL 32814
 P (407) 661-9100
 F (407) 661-9101
 www.c-p.com

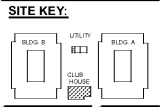

PROJECT TITLE: HUTTON DEVELOPMENT

PROJECT NAME: ROCKLEDGE FLATS - BUILDING C
 220 Barton Boulevard
 Rockledge, FL 32955



Revision Schedule

No.	Description	Date

PROJECT NO.: 060-15010
DATE: 20/09/19
DRAWN: EMC
CHECKED: EMC

S111C