

Order Plans @ www.LDILine.com

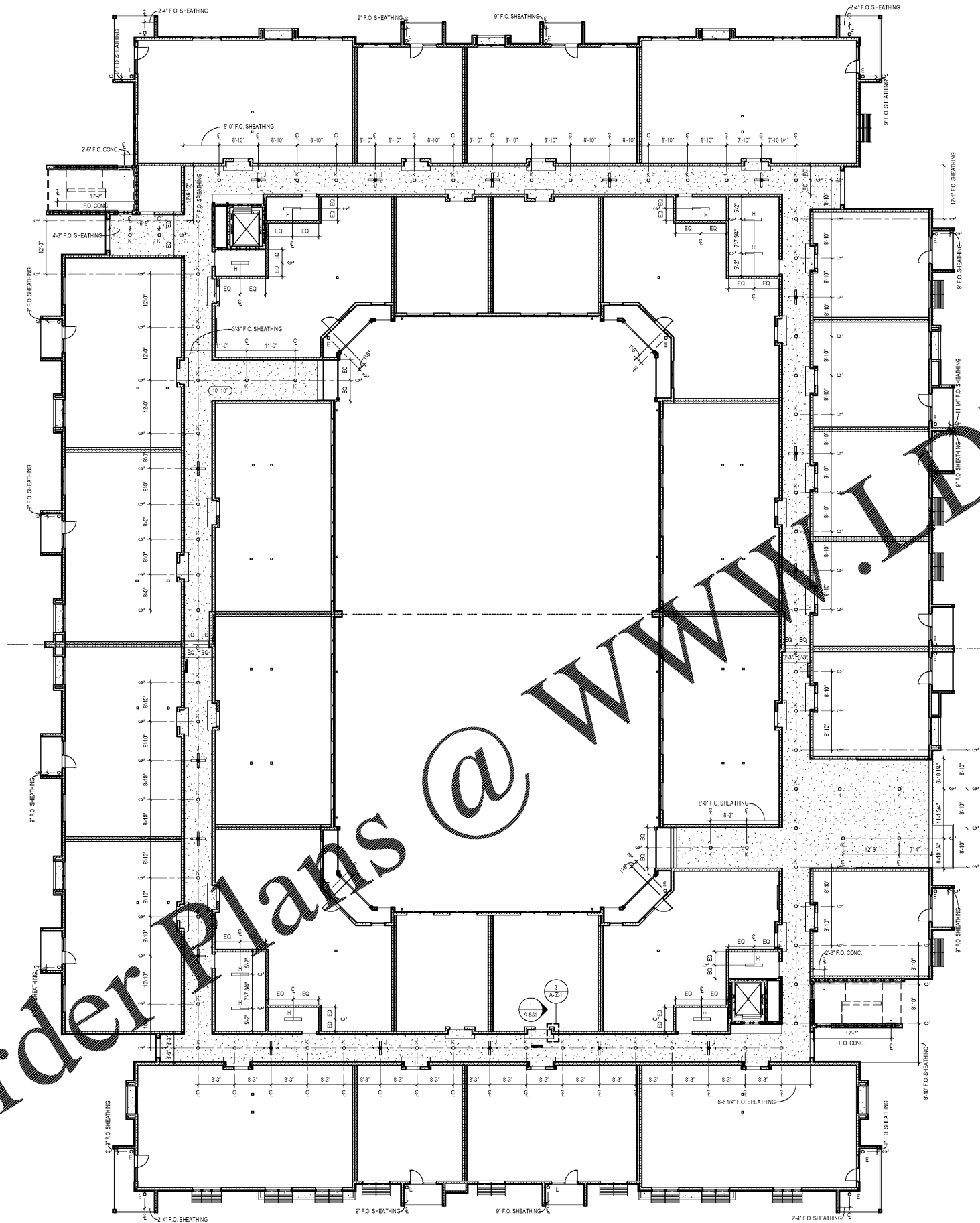

1 FLOOR 1 REFLECTED CEILING PLAN
352' x 170'

GENERAL RCP NOTES

- DO NOT SCALE DRAWINGS. IF DIMENSIONS CANNOT BE DETERMINED OR DOCUMENTS ARE IN CONFLICT, THE CONTRACTOR SHALL OBTAIN CLARIFICATION FROM THE ARCHITECT PRIOR TO CONTINUATION OF WORK.
- REFER TO PROJECT INFORMATION SHEET FOR MATERIAL / REFERENCE SYMBOLS AND ABBREVIATIONS.
- REFER TO MECHANICAL, ELECTRICAL, FIRE SUPPRESSION & TECHNOLOGY DRAWINGS FOR QUANTITY AND TYPE OF CEILING MOUNTED FIXTURES / DEVICES.
- ALL CEILING MOUNTED FIXTURES, DEVICES, ETC. ARE TO BE CENTERED WITHIN THE CEILING TILE, UNLESS OTHERWISE NOTED.
- WHERE PENDANT LIGHT FIXTURES ARE UTILIZED, GENERAL CONTRACTOR TO PROVIDE APPROPRIATE BLOCKING FOR FIXTURE WEIGHT AND ASSEMBLY.
- PROVIDE CONTROL JOINTS @ 30'-0" O.C. MAX AT ALL GYPSUM BOARD BULKHEADS. LOCATE TO BE EVENLY SPACED OR TO ALIGN WITH COLUMN CENTERLINES, ADJACENT WALLS, OR OTHER ARCHITECTURAL ELEMENTS. REVIEW PROPOSED LOCATIONS WITH ARCHITECT PRIOR TO INSTALLATION.
- REFERENCE MECHANICAL AND ELECTRICAL DRAWINGS FOR MOUNTING LOCATIONS OF ITEMS WHERE NO CEILING ARE REQUIRED OR INDICATED.
- REFER TO ELECTRICAL DRAWINGS FOR LIGHTING FIXTURE SCHEDULE.
- REFER TO MECHANICAL DRAWINGS FOR DIFFUSER FINISH SCHEDULE.
- SPRINKLER HEADS WITHIN GYPSUM BOARD ARE TO BE FULLY CONCEALED WITH WHITE COVER PLATES. SPRINKLER LOCATIONS SHOWN ARE FOR PRELIMINARY REVIEW ONLY. VERIFY LOCATION WITH FIRE MARSHALL PRIOR TO INSTALLATION.
- PROVIDE INDIVIDUAL SWITCHES FOR EACH FIXTURE WITHIN AN ENCLOSED ROOM, UNLESS OTHERWISE NOTED. MULTIPLE SWITCHES WITHIN A SINGLE COVER PLATE OR BANKING OF SWITCHES IS NOT POSSIBLE. INDIVIDUAL SWITCHES SHALL BE EVENLY SPACED. SWITCHES SHALL BE LOCATED AT THE SAME HEIGHT AS THE FIXTURE.
- WHERE ACOUSTICAL CEILING IS TO BE INSTALLED, CENTER THE CEILING GRID WITHIN THE ROOM IN BOTH DIRECTIONS, UNLESS OTHERWISE NOTED.
- REFER TO LIST OF FINISHES FOR LIGHTING SPECIFICATIONS.

1925 Prospect Ave.
Orlando, FL 32814
P (407) 661-9100
F (407) 661-9101
www.rp.com

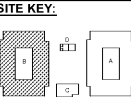

PROJECT NAME: **ROCKLEDGE FLATS - BUILDING B**
220 Baron Boulevard
Rockledge, FL 32955

CLIENT: **HUTTON DEVELOPMENT**

SHEET TITLE: **FLOOR 1 REFLECTED CEILING PLAN**

NOV 02, 2015

- GYPSUM BOARD
- TYPE: CEILING TYPE
CEILING ELEVATION
- RECESSED CAN
- PENDANT
- SEMI FLUSH
- FAN
- 2 X 4 TROUFFLER
- TAPE LIGHT
- HVAC DEVICES (REFER TO MECHANICAL DRAWINGS)
- FIRE PROTECTION SPRINKLER HEAD
- FIRE ALARM PULL STATION
- ACCESS DOOR

Revision Schedule	
No.	Description

PROJECT NO. 210022	DATE 20/11/15	DRAWN [Signature]	CHECKED [Signature]
--------------------	---------------	-------------------	---------------------

A-701

GMP PRICING SET 15 NOVEMBER 2019