

BEAM SCHEDULE

MARK	MEMBER
B1	(2) 2x12 LVL
B2	(5) 1-3/4x24 LVL
B3	TRUSS GIRDER
B5	(2) 2x12 PT
B6	(3) 2x12 PT
B7	(2) 2x10 PT
B8	(3) 2x10 PT
B9	(2) 2x6 PT

COLUMN SCHEDULE

MARK #	MEMBER
C1	(3)-2x6
C2	(3)-2x4
C4	(4)-2x4
C5	(2)-2x6

WOOD FRAMING SCHEDULE

MARK #	MEMBER	SPACING
A	24" FLOOR TRUSS	24" O.C.
B	24" FLOOR TRUSS	16" O.C.
C	2x10 (PRESSURE TREATED)	16" O.C.
D	2x6 (PRESSURE TREATED)	16" O.C.
E	2x6	24" O.C.

STRUCTURAL WALL LEGEND

MARK	FRAMING SIZE	STUD SPACING	NOTES
W1A	2x6	16" O.C.	No. 2 SYP OR DOUG-FIR-LARCH
W1	2x6	16" O.C.	No. 2 SYP OR DOUG-FIR-LARCH
W2	2-2x6	16" O.C.	No. 2 SYP OR DOUG-FIR-LARCH

NOTES:
 1. NON-LOAD BRG. WALL SHALL BE 2x4 @ 16" O.C.
 2. BEARING WALL STUDS SHALL BE SPACED TO ALIGN DIRECTLY BELOW FLOOR OR ROOF TRUSSES AT AS MANY LOCATIONS AS POSSIBLE.
 3. ALL FRAMING SHALL BE PLATFORM FRAMED.
 4. SEE ARCH FOR ADDITIONAL INFORMATION.

SHEATHING/SHEAR WALL SCHEDULE

WALL TYPE	WALL MATERIAL	EDGE NAILING	SILL ANCHORS	SOLE NAILING	REMARKS					
MARK	TYPE	THICKNESS	SIDES	SPA	SIZE	SPA	SIZE	SPA	SIZE	RE- NOTES
1	PLYWOOD (STRUCT.1)	15/32"	1	6"	10d COMMON	16"	1/2"	4"	16d	1, 4
2	PLYWOOD (STRUCT.1)	15/32"	1	4"	10d COMMON	16"	1/2"	8"	1/4"tw@8" S/M/P. SDS	1, 4

IF ARCH SHOWS 1 HR. WALL ASSEMBLY, REFER TO UL ASSEMBLY REQUIREMENTS FOR MINIMUM WALL MATERIAL THICKNESS.

NOTES:
 1) NAIL SPACING INDICATED IS FOR EDGE NAILING OF THE SPECIFIED WALL MATERIAL TYPICAL INTERMEDIATE STUDS (FIELD NAILING) AND BLOCKING. IF PRESENT, SHALL BE NAILED AT 12" O.C. @ PLYWOOD SHEARWALLS. OMIT SILL ANCHORS AT UPPER LEVELS.
 2) WALL SEGMENTS WITH HEIGHT TO WIDTH RATIOS GREATER THAN 2 TO 1 SHALL BE BLOCKED CONSTRUCTION. ALL WALL SEGMENTS SHALL BE UNBLOCKED CONSTRUCTION.
 3) SINKER NAILS MAY BE SUBSTITUTED PROVIDED THE SHEAR CAPACITY MATCHES COMMON NAILS.
 4) SEE S301 FOR TYP. SHEARWALLS.

① THIRD FLOOR FRAMING PLAN - PART B
 SCALE: 1/8" = 1'-0"

- NOTES:
- SEE ARCH. DWGS. FOR ANY LOCATIONS AND/OR DIMENSION NOT SHOWN.
 - REFER TO THE T.P.1 "HIB-91 SUMMARY SHEET COMMENTARY AND RECOMMENDATIONS FOR HANDLING, INSTALLING, & BRACING METAL PLATE CONNECTED WOOD TRUSSES." INCLUDED IN THE DELIVERY PACKAGE.
 - ALL BLOCKING AND BRACING TO BE JOB CUT AND FRAMED.
 - FLOOR TRUSSES TO BE DESIGNED PER NOTES ON SHT. S001.
 - SEE _____ FOR WOOD HEADERS.
 - SEE _____ FOR TOP PLATE DETAIL.
 - TRUSS BEARING ELEVATION = A.F.F.
 - SEE _____ FOR STANDARD MASONRY LINTEL SCHEDULE.
 - SEE _____ FOR THE NAILING SCHEDULE.
 - SEE FOUNDATION PLAN FOR WALL FRAMING DESIGNATION.
 - SEE _____ FOR THE NAILING SCHEDULE.
 - SEE FOUNDATION PLAN FOR WALL FRAMING DESIGNATION.
 - - INDICATES WOOD FLOOR FRAMING. SEE PLAN FOR FRAMING SCHEDULE.
 - - INDICATES WOOD BEAM. SEE PLAN FOR WOOD BEAM SCHEDULE.
 - ▬ - INDICATES LOAD BEARING WOOD STUD WALLS.
 - ▬ - INDICATES LOAD BEARING WOOD STUD WALLS BELOW.
 - ALL FRAMING TO BE PLATFORM FRAMED (U.N.O.)

Order Plans @ www.walddeline.com

www.walddeline.com

1925 Prospect Ave.
 Orlando, FL 32814
 P (407) 661-9100
 F (407) 661-9101
 www.r.p.com

Calacaci & Peterson
 Architects Engineers Planners



SITE KEY:

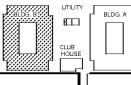

CLIENT NAME
HUTTON DEVELOPMENT

PROJECT NAME
ROCKLEDGE FLATS - BUILDING "B"
 220 Baron Boulevard
 Rockledge, FL 32955

SHEET TITLE
THIRD FLOOR FRAMING PLAN - PART B



No.	Description	Date

PROJECT NO. 054-15070	DATE 20/09/23	DRAWN 	CHECKED
--------------------------	------------------	-----------	-------------

S132B

GMP PRICING SET 15 NOVEMBER 2019

19181-RC19