

BEAM SCHEDULE

MARK #	MEMBER
B1	(2)-1-3/4"x24" LVL
B2	(3)-1-3/4"x24" LVL
B3	TRUSS GIRDER
B4	(2)-2"x12" PT
B5	(3)-2"x12" PT
B6	(2)-2"x10" PT
B7	(3)-2"x10" PT
B8	(3)-2"x10" PT
B9	(2)-2"x6" PT

COLUMN SCHEDULE

MARK #	MEMBER
C1	(3)-2x6
C2	(3)-2x4
C3	(4)-2x4
C4	(2)-2x6
C5	(2)-2x6

WOOD FRAMING SCHEDULE

MARK #	MEMBER	SPACING
A	24" FLOOR TRUSS	24" O.C.
B	24" FLOOR TRUSS	16" O.C.
C	2x10 (PRESSURE TREATED)	16" O.C.
D	2x6 (PRESSURE TREATED)	16" O.C.
E	2x8	24" O.C.

STRUCTURAL WALL LEGEND

MARK	FRAMING SIZE	STUD SPACING	NOTES
W1A	2x6	16" O.C.	No. 2 SYP OR DOUG-FIR-LARCH
W1	2x6	16" O.C.	No. 2 SYP OR DOUG-FIR-LARCH
W2	2-2x6	16" O.C.	No. 2 SYP OR DOUG-FIR-LARCH

NOTES:
 1. NON-LOAD BRG. WALL SHALL BE 2x4 @ 16" O.C.
 2. BEARING WALL STUDS SHALL BE SPACED TO ALIGN DIRECTLY BELOW FLOOR OR ROOF TRUSSES AT AS MANY LOCATIONS AS POSSIBLE.
 3. ALL FRAMING SHALL BE PLATFORM FRAMED.
 4. SEE ARCH FOR ADDITIONAL INFORMATION.

SHEATHING/SHEAR WALL SCHEDULE

WALL TYPE	WALL MATERIAL	EDGE NAILING	SILL ANCHORS	SOLE NAILING	REMARKS			
MARK	TYPE	THICKNESS	SIDES	SPA	SIZE	SPA	SIZE	RE. NOTES
1	PLYWOOD (STRUCT.1)	1/2"	1	6"	10d COMMON	16"	1/2" 4"	1, 4
2	PLYWOOD (STRUCT.1)	1/2"	1	4"	10d COMMON	16"	1/2" 8"	1/4"x6" SIMP. SDS

IF ARCH SHOWS 1 HR. WALL ASSEMBLY, REFER TO UL ASSEMBLY REQUIREMENTS FOR MINIMUM WALL MATERIAL THICKNESS.

NOTES:
 1) NAIL SPACING INDICATED IS FOR EDGE NAILING OF THE SPECIFIED WALL MATERIAL TYPICAL INTERMEDIATE STUDS (FIELD NAILING) AND BLOCKING. IF PRESENT, SHALL BE NAILED AT 12" O.C. @ PLYWOOD SHEARWALLS. OMIT SILL ANCHORS AT UPPER LEVELS.
 2) WALL SEGMENTS WITH HEIGHT TO WIDTH RATIOS GREATER THAN 2 TO 1 SHALL BE BLOCKED CONSTRUCTION. ALL WALL SEGMENTS SHALL BE UNBLOCKED CONSTRUCTION.
 3) SINKER NAILS MAY BE SUBSTITUTED PROVIDED THE SHEAR CAPACITY MATCHES COMMON NAILS.
 4) SEE 9/S301 FOR TYP. SHEARWALLS.

1 SECOND FLOOR FRAMING PLAN - PART B

SCALE: 1/8" = 1'-0"

- NOTES:
- SEE ARCH. DWGS. FOR ANY LOCATIONS AND/OR DIMENSION NOT SHOWN.
 - REFER TO THE T.P.J. "HIB-91 SUMMARY SHEET COMMENTARY AND RECOMMENDATIONS FOR HANDLING, INSTALLING, & BRACING METAL PLATE CONNECTED WOOD TRUSSES," INCLUDED IN THE DELIVERY PACKAGE.
 - ALL BLOCKING AND BRACING TO BE JOB CUT AND FRAMED.
 - FLOOR TRUSSES TO BE DESIGNED PER NOTES ON SHT. S301.
 - SEE _____ FOR WOOD HEADERS.
 - SEE _____ FOR TOP PLATE DETAIL.
 - TRUSS BEARING ELEVATION = A.F.F.
 - SEE _____ FOR STANDARD MASONRY LINTEL SCHEDULE.
 - SEE _____ FOR THE NAILING SCHEDULE.
 - SEE FOUNDATION PLAN FOR WALL FRAMING DESIGNATION.
 - INDICATES WOOD FLOOR FRAMING. SEE PLAN FOR FRAMING SCHEDULE.
 - INDICATES WOOD BEAM. SEE PLAN FOR WOOD BEAM SCHEDULE.
 - INDICATES LOAD BEARING WOOD STUD WALLS.
 - INDICATES LOAD BEARING WOOD STUD WALLS BELOW.
 - ALL FRAMING TO BE PLATFORM FRAMED (U.N.O.)

Order Plans @

1925 Prospect Ave.
Orlando, FL 32814
P (407) 661-9100
F (407) 661-9101
www.r.p.com

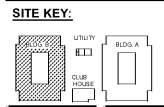
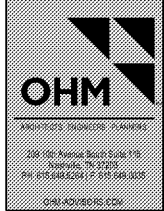

PROJECT TITLE: HUTTON DEVELOPMENT
 CLIENT: HUTTON DEVELOPMENT
 PROJECT NO.: 19181-RC19

PROJECT TITLE: ROCKLEDGE FLATS - BUILDING "B"
 PROJECT NO.: 19181-RC19
 PROJECT ADDRESS: 220 Baron Boulevard, Rockledge, FL 32955



No.	Description	Date

PROJECT NO.: 054015010
 DATE: 20/09/20
 DRAWN: [Signature]
 CHECKED: [Signature]

S122B
 19181-RC19

GMP PRICING SET 15 NOVEMBER 2019