

**BEAM SCHEDULE**

MARK #	MEMBER
B1	(2)-1-1/4"x24" LVL
B2	(3)-1-3/4"x24" LVL
B3	TRUSS GIRDER
B4	(2)-2"x12" PT
B5	(2)-2"x12" PT
B6	(3)-2"x12" PT
B7	(2)-2"x10" PT
B8	(3)-2"x10" PT
B9	(2)-2"x6" PT

**COLUMN SCHEDULE**

MARK #	MEMBER
C1	(3)-2x6
C2	(3)-2x4
C4	(4)-2x4
C5	(2)-2x6

**WOOD FRAMING SCHEDULE**

MARK #	MEMBER	SPACING
A	24" FLOOR TRUSS	24" O.C.
B	24" FLOOR TRUSS	16" O.C.
C	2x10 (PRESSURE TREATED)	16" O.C.
D	2x6 (PRESSURE TREATED)	16" O.C.
E	2x6	24" O.C.

**STRUCTURAL WALL LEGEND**

MARK	FRAMING SIZE	STUD SPACING	NOTES
W1A	2x6	16" O.C.	No. 2 SYP OR DOUG-FIR-LARCH
W1	2x6	16" O.C.	No. 2 SYP OR DOUG-FIR-LARCH
W2	2-2x6	16" O.C.	No. 2 SYP OR DOUG-FIR-LARCH

NOTES:  
 1. NON-LOAD BRG. WALL SHALL BE 2x4 @ 16" O.C.  
 2. BEARING WALL STUDS SHALL BE SPACED TO ALIGN DIRECTLY BELOW FLOOR OR ROOF TRUSSES AT AS MANY LOCATIONS AS POSSIBLE.  
 3. ALL FRAMING SHALL BE PLATFORM FRAMED.  
 4. SEE ARCH FOR ADDITIONAL INFORMATION.

**SHEATHING/SHEAR WALL SCHEDULE**

WALL TYPE	WALL MATERIAL	EDGE NAILING	SILL ANCHORS	SOLE NAILING	REMARKS
1	PLYWOOD (STRUCT.1)	15/32" x 1" x 6"	10d COMMON	16" x 1/2" x 4"	1, 4
2	PLYWOOD (STRUCT.1)	15/32" x 1" x 4"	10d COMMON	16" x 1/2" x 8"	1/4"x6"x1" SIMP. SDS

IF ARCH SHOWS 1 HR. WALL ASSEMBLY, REFER TO UL ASSEMBLY REQUIREMENTS FOR MINIMUM WALL MATERIAL THICKNESS.

NOTES:  
 1) NAIL SPACING INDICATED IS FOR EDGE NAILING OF THE SPECIFIED WALL MATERIAL. TYPICAL INTERMEDIATE STUDS (FIELD NAILING) AND BLOCKING, IF PRESENT, SHALL BE NAILED AT 12" O.C. @ PLYWOOD SHEARWALLS. OMIT SILL ANCHORS AT UPPER LEVELS.  
 2) WALL SEGMENTS WITH HEIGHT TO WIDTH RATIOS GREATER THAN 2 TO 1 SHALL BE BLOCKED CONSTRUCTION. ALL WALL SEGMENTS SHALL BE UNBLOCKED CONSTRUCTION.  
 3) SINKER NAILS MAY BE SUBSTITUTED PROVIDED THE SHEAR CAPACITY MATCHES COMMON NAILS.  
 4) SEE 9-S301 FOR TYP. SHEARWALLS.

1 SECOND FLOOR FRAMING PLAN - PART A  
 SCALE: 1/8" = 1'-0"

- NOTES:
- SEE ARCH. DWGS. FOR ANY LOCATIONS AND/OR DIMENSION NOT SHOWN.
  - REFER TO THE T.P. 1 "88-91 SUMMARY SHEET COMMENTARY" AND RECOMMENDATIONS FOR HANDLING, INSTALLING, & BRACING METAL PLATE CONNECTED WOOD TRUSSES." INCLUDED IN THE DELIVERY PACKAGE.
  - ALL BLOCKING AND BRACING TO BE JOB CUT AND FRAMED.
  - FLOOR TRUSSES TO BE DESIGNED PER NOTES ON SHT. S001.
  - SEE \_\_\_\_\_ FOR WOOD HEADERS.
  - SEE \_\_\_\_\_ FOR TOP PLATE DETAIL.
  - TRUSS BEARING ELEVATION = A.F.F.
  - SEE \_\_\_\_\_ FOR STANDARD MASONRY LINTEL SCHEDULE.
  - SEE \_\_\_\_\_ FOR THE NAILING SCHEDULE.
  - SEE FOUNDATION PLAN FOR WALL FRAMING DESIGNATION.
  - [ ] - INDICATES WOOD FLOOR FRAMING. SEE PLAN FOR FRAMING SCHEDULE.
  - [ ] - INDICATES WOOD BEAM. SEE PLAN FOR WOOD BEAM SCHEDULE.
  - [ ] - INDICATES LOAD BEARING WOOD STUD WALLS.
  - [ ] - INDICATES LOAD BEARING WOOD STUD WALLS BELOW.
  - ALL FRAMING TO BE PLATFORM FRAMED (U.N.O.)

Order Plans @

1925 Prospect Ave.  
 Orlando, FL 32814  
 P (407) 661-9100  
 F (407) 661-9101  
 www.r.p.com

**Colucci & Peterson**  
 Architects Engineers Planners

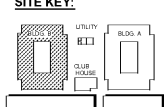
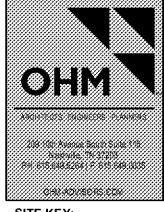

PROJECT NAME: **ROCKLEDGE FLATS - BUILDING "B"**  
 220 Barton Boulevard  
 Rockledge, FL 32955

PROJECT TITLE: **SECOND FLOOR FRAMING PLAN - PART A**



No.	Description	Date

PROJECT NO. 054-15/010  
 DATE 2/15/23  
 DRAWN  
 CHECKED

19181-RC19

GMP PRICING SET 15 NOVEMBER 2019

S122A