

① LIGHTING PLAN B - 1ST FLOOR  
1/8" = 1'-0"

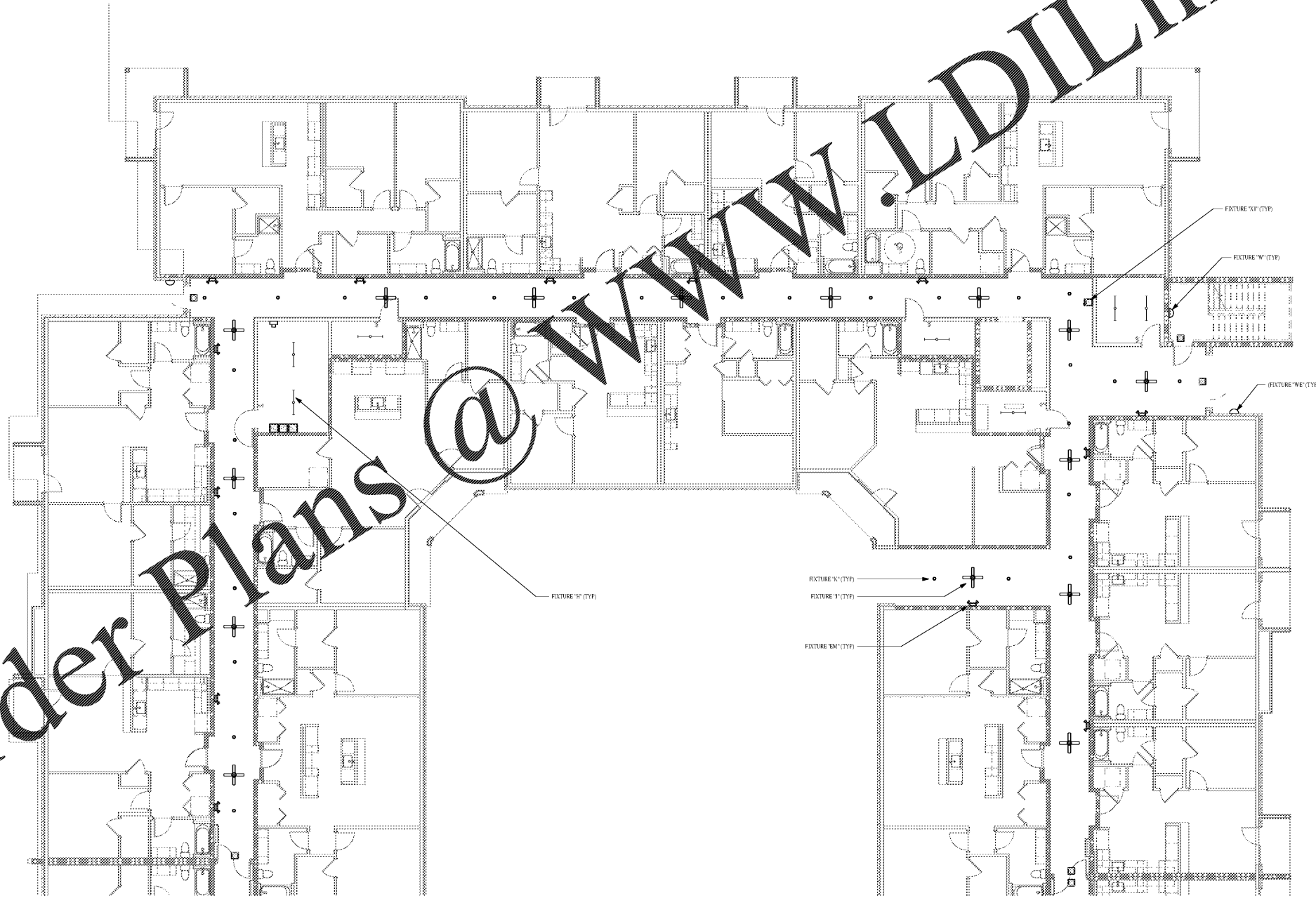

**GENERAL NOTES**

1. CONTRACTOR TO PROVIDE AND INSTALL TIMER SWITCH CONTROLS IN ELECTRICAL ROOM FOR AUTOMATIC ON/OFF CONTROL OF CORRIDOR LIGHTING, CORRIDOR FANS, LIVING UNIT ENTRY SCENES, AND EXTERIOR LANDSCAPING LIGHTING. FIELD COORDINATE EXACT QUANTITY OF TIMER SWITCH CONTROLS WITH OWNER.
2. CONTRACTOR TO PROVIDE AND INSTALL SINGLE ON/OFF WATER PROOF LIGHT SWITCH LOCATED IN ELEVATOR FIT FOR FIT LIGHTING CONTROL.
3. CONTRACTOR SHALL REFER TO ARCHITECTURAL REFLECTING CEILING PLANS FOR ADDITIONAL INFORMATION ON LIGHTING LOCATIONS AND FIXTURE TYPES.

Order Plans @ [www.LDILine.com](http://www.LDILine.com)

Revision Schedule	
No.	Description

PROJECT NO.	0540150010
DATE	20/04/10
DESIGNER	
CHECKED	

PROJECT NAME	ROCKLEDGE MULTI-FAMILY
PROJECT ADDRESS	220 Baron Boulevard Rockledge, FL 32955
SHEET TITLE	FIRST FLOOR LIGHTING PLAN B
DATE	NOV 03, 2015

CLIENT NAME	
PROJECT NAME	ROCKLEDGE MULTI-FAMILY
PROJECT ADDRESS	220 Baron Boulevard Rockledge, FL 32955
SHEET TITLE	FIRST FLOOR LIGHTING PLAN B

CLIENT NAME	
-------------	--



1925 Prospect Ave.  
Orlando, FL 32814  
P (407) 661-9100  
F (407) 661-9101  
[www.cpa.com](http://www.cpa.com)

GMP PRICING SET

E101B