

Order Plans @ www.LDLine.com

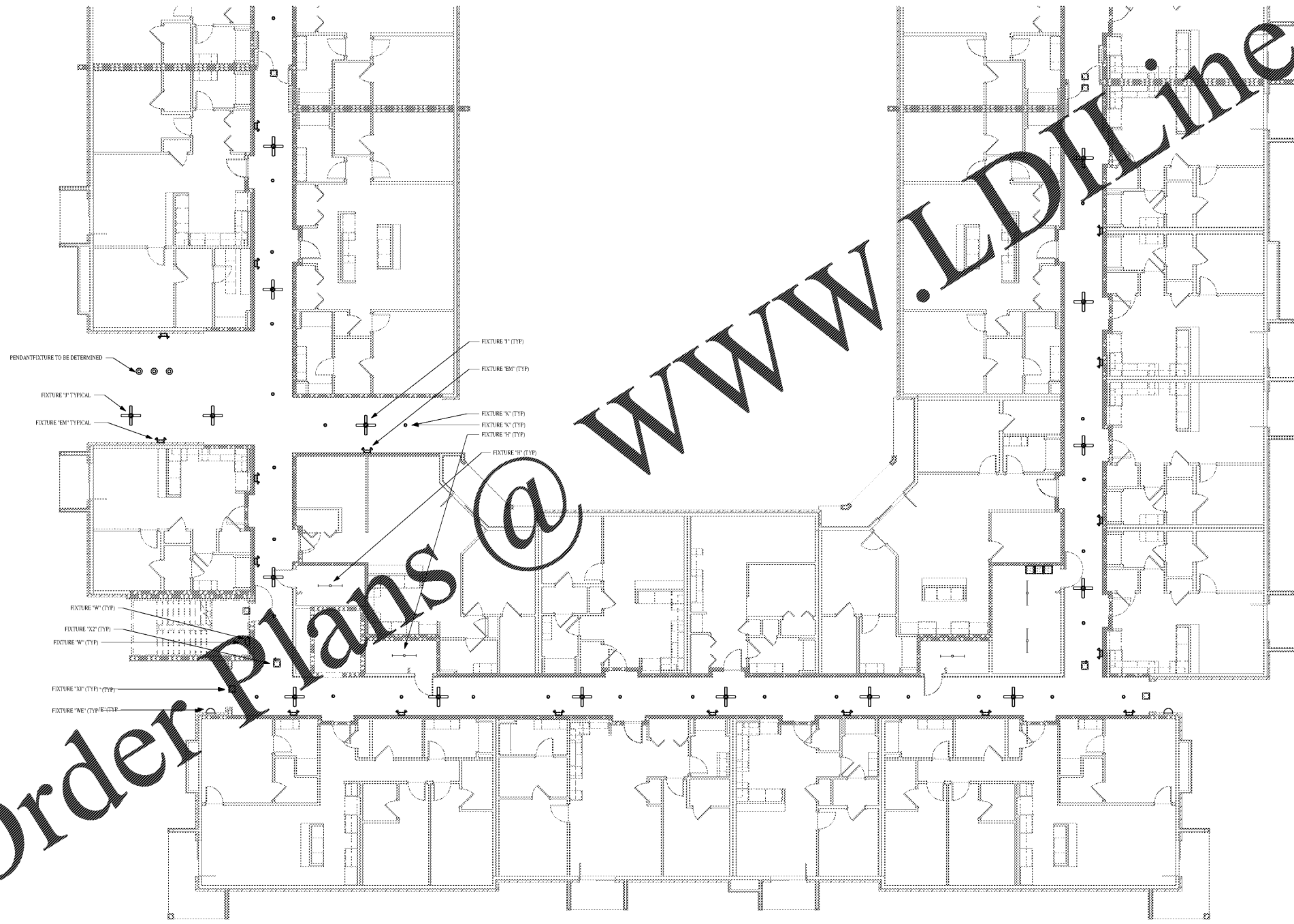

GENERAL NOTES

1. CONTRACTOR TO PROVIDE AND INSTALL TIMER SWITCH CONTROLS IN ELECTRICAL ROOM FOR AUTOMATIC ON/OFF CONTROL OF CORRIDOR LIGHTING, CORRIDOR FANS, LIVING UNIT ENTRY SCOVES, AND EXTERIOR LANDSCAPING LIGHTING. FIELD COORDINATE EXACT QUANTITY OF TIMER SWITCH CONTROLS WITH OWNER.
2. CONTRACTOR TO PROVIDE AND INSTALL SINGLE ON/OFF WATER PROOF LIGHT SWITCH LOCATED IN ELEVATOR PIT FOR PIT LIGHTING CONTROL.
3. CONTRACTOR SHALL REFER TO ARCHITECTURAL REFLECTING CEILING PLANS FOR ADDITIONAL INFORMATION ON LIGHTING LOCATIONS AND FIXTURE TYPES.

1925 Prospect Ave.
Orlando, FL 32814
P (407) 661-9100
F (407) 661-9101
www.r.p.e.com

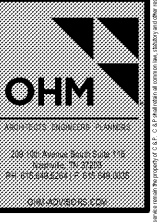

PROJECT NAME
ROCKLEDGE MULTI-FAMILY
220 Baron Boulevard
Rockledge, FL 32955

CLIENT NAME
ROCKLEDGE MULTI-FAMILY

SHEET TITLE
FIRST FLOOR LIGHTING PLAN A

NOV 03, 2015

Revision Schedule	
No.	Description

PROJECT NO. 0540150010	DATE 20/04/10	DESIGNER [Signature]	CHECKED [Signature]
---------------------------	------------------	-------------------------	------------------------

E101A