

CORRIDOR SLAB  
 2" NORMAL WT. CONCRETE  
 SLAB REINF. w/ WWF 6x6  
 W1.4+W1.4 OVER 10 MIL.  
 POLY VAPOR BARRIER OVER  
 1/2" T&G EXTERIOR PLYWOOD.  
 GLUE AND SCREW PLYWOOD  
 TO JOIST (TYP. U.N.O.)

CORRIDOR SLAB  
 2" NORMAL WT. CONCRETE  
 SLAB REINF. w/ WWF 6x6  
 W1.4+W1.4 OVER 10 MIL.  
 POLY VAPOR BARRIER OVER  
 1/2" T&G EXTERIOR PLYWOOD.  
 GLUE AND SCREW PLYWOOD  
 TO JOIST (TYP. U.N.O.)

CORRIDOR SLAB  
 2" NORMAL WT. CONCRETE  
 SLAB REINF. w/ WWF 6x6  
 W1.4+W1.4 OVER 10 MIL.  
 POLY VAPOR BARRIER OVER  
 1/2" T&G EXTERIOR PLYWOOD.  
 GLUE AND SCREW PLYWOOD  
 TO JOIST (TYP. U.N.O.)

FLOOR DECK: APA RATED  
 1/2" STURDFLOOR, T&G  
 EXPOSURE I PLYWOOD  
 (TYP. U.N.O.)

**BEAM SCHEDULE**

MARK #	MEMBER
B1	(2)-1-3/4"x24" LVL
B2	(3)-1-3/4"x24" LVL
B3	TRUSS GIRDER
B4	
B5	(2)-2"x12" PT
B6	(3)-2"x12" PT
B7	(2)-2"x10" PT
B8	(3)-2"x10" PT
B9	(2)-2"x6" PT

**COLUMN SCHEDULE**

MARK #	MEMBER
C1	(3)-2x6
C2	(3)-2x4
C4	(4)-2x4
C5	(2)-2x6

**WOOD FRAMING SCHEDULE**

MARK #	MEMBER	SPACING
A	24" FLOOR TRUSS	24" O.C.
B	24" FLOOR TRUSS	16" O.C.
C	2x10 (PRESSURE TREATED)	16" O.C.
D	2x6 (PRESSURE TREATED)	16" O.C.
E	2x8	24" O.C.

**STRUCTURAL WALL LEGEND**

MARK	FRAMING SIZE	STUD SPACING	NOTES
W1A	2x6	16" O.C.	No. 2 SYP OR DOUG-FIR-LARCH
W1	2x6	16" O.C.	No. 2 SYP OR DOUG-FIR-LARCH
W2	2-2x6	16" O.C.	No. 2 SYP OR DOUG-FIR-LARCH

NOTES:  
 1. NON-LOAD BRG. WALL SHALL BE 2x4 @ 16" O.C.  
 2. BEARING WALL STUDS SHALL BE SPACED TO ALIGN DIRECTLY BELOW FLOOR OR ROOF TRUSSES AT AS MANY LOCATIONS AS POSSIBLE.  
 3. ALL FRAMING SHALL BE PLATFORM FRAMED.  
 4. SEE ARCH FOR ADDITIONAL INFORMATION.

**SHEATHING/SHEAR WALL SCHEDULE**

WALL TYPE	WALL MATERIAL		EDGE NAILING		SILL ANCHORS		SOLE NAILING		REMARKS	
	TYPE	THICKNESS	SPA	SIZE	SPA	SIZE	SPA	SIZE		
1	PLYWOOD (STRUCT.1)	15/32"	1	6"	10d COMMON	16"	1/2"	4"	16d	1, 4
2	PLYWOOD (STRUCT.1)	15/32"	1	4"	10d COMMON	16"	1/2"	8"	1/4"x6"x8" SIMP. SDS	1, 4

IF ARCH SHOWS 1 HR. WALL ASSEMBLY, REFER TO UL ASSEMBLY REQUIREMENTS FOR MINIMUM WALL MATERIAL THICKNESS.

NOTES:  
 1) NAIL SPACING INDICATED IS FOR EDGE NAILING OF THE SPECIFIED WALL MATERIAL TYPICAL INTERMEDIATE STUDS (FIELD NAILING) AND BLOCKING. IF PRESENT, SHALL BE NAILED AT 12" O.C. @ PLYWOOD SHEARWALLS. OMIT SILL ANCHORS AT UPPER LEVELS.  
 2) WALL SEGMENTS WITH HEIGHT TO WIDTH RATIOS GREATER THAN 2 TO 1 SHALL BE BLOCKED CONSTRUCTION. ALL WALL SEGMENTS SHALL BE UNBLOCKED CONSTRUCTION.  
 3) SIMP. NAILS MAY BE SUBSTITUTED PROVIDED THE SHEAR CAPACITY MATCHES COMMON NAILS.  
 4) SEE S301 FOR TYP. SHEARWALLS.

**1 FOURTH FLOOR FRAMING PLAN - PART B**  
 SCALE: 1/8" = 1'-0"

- NOTES:
- SEE ARCH. DWGS. FOR ANY LOCATIONS AND/OR DIMENSION NOT SHOWN.
  - REFER TO THE T.P.I. "HIB-91 SUMMARY SHEET COMMENTARY AND RECOMMENDATIONS FOR HANDLING, INSTALLING, & BRACING METAL PLATE CONNECTED WOOD TRUSSES." INCLUDED IN THE DELIVERY PACKAGE.
  - ALL BLOCKING AND BRACING TO BE JOB CUT AND FRAMED.
  - FLOOR TRUSSES TO BE DESIGNED PER NOTES ON SHT. S001.
  - SEE 4S302 FOR WOOD HEADERS.
  - SEE 5S302 FOR TOP PLATE DETAIL.
  - TRUSS BEARING ELEVATION = A.F.F.
  - ▲ DENOTES SHEARWALL HOLDDOWN. SEE DETAIL 5/S301 FOR SCHEDULE.
  - 9 - INDICATES THE NAILING SCHEDULE.
  - SEE FOUNDATION PLAN FOR WALL FRAMING DESIGNATION.
  - - INDICATES WOOD FLOOR FRAMING. SEE PLAN FOR FRAMING SCHEDULE.
  - "B" - INDICATES WOOD BEAM. SEE PLAN FOR WOOD BEAM SCHEDULE.
  - ▨ - INDICATES LOAD BEARING WOOD STUD WALLS.
  - ▨ - INDICATES LOAD BEARING WOOD STUD WALLS BELOW.
  - ALL FRAMING TO BE PLATFORM FRAMED (U.N.O.)

Order Plans @ [www.dltime.com](http://www.dltime.com)

1925 Prospect Ave.  
 Orlando, FL 32814  
 P (407) 661-9100  
 F (407) 661-9101  
[www.r.p.com](http://www.r.p.com)

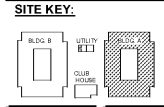
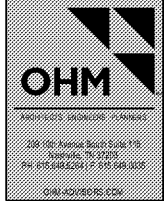

PROJECT NAME: **ROCKLEDGE FLATS - BUILDING "A"**  
 1220 Baron Boulevard  
 Rockledge, FL 32955

CLIENT NAME: **HUTTON DEVELOPMENT**

SHEET TITLE: **FOURTH FLOOR FRAMING PLAN - PART B**

PROJECT NO. 0540-15/010  
 DATE 2/15/2019  
 DRAWN  
 CHECKED



PROJECT NO. 0540-15/010  
 DATE 2/15/2019  
 DRAWN  
 CHECKED

**S141B**

GMP PRICING SET 15 NOVEMBER 2019