

Order Plans @

1 THIRD FLOOR FRAMING PLAN - PART A
SCALE: 1/8" = 1'-0"

- NOTES:
- SEE ARCH. DWGS. FOR ANY LOCATIONS AND/OR DIMENSION NOT SHOWN.
 - REFER TO THE T.P.1 "HIB-91 SUMMARY SHEET COMMENTARY AND RECOMMENDATIONS FOR HANDLING, INSTALLING, & BRACING METAL PLATE CONNECTED WOOD TRUSSES," INCLUDED IN THE DELIVERY PACKAGE.
 - ALL BLOCKING AND BRACING TO BE JOB CUT AND FRAMED.
 - FLOOR TRUSSES TO BE DESIGNED PER NOTES ON SHT. S301.
 - SEE 4/S302 FOR WOOD HEADERS.
 - SEE 5/S302 FOR TOP PLATE DETAIL.
 - TRUSS BEARING ELEVATION = A.F.F.
 - * - DENOTES SHEARWALL HOLDDOWN. SEE DETAIL 5/S301 FOR SCHEDULE.
 - SEE S301 FOR THE NAILING SCHEDULE.
 - SEE FOUNDATION PLAN FOR WALL FRAMING DESIGNATION.
 - SEE PLAN FOR FRAMING SCHEDULE.
 - 1) - INDICATES WOOD FLOOR FRAMING. SEE PLAN FOR FRAMING SCHEDULE.
 - 2) - INDICATES WOOD BEAM. SEE PLAN FOR WOOD BEAM SCHEDULE.
 - 3) - INDICATES LOAD BEARING WOOD STUD WALLS.
 - 4) - INDICATES LOAD BEARING WOOD STUD WALLS BELOW.
 - 5) ALL FRAMING TO BE PLATFORM FRAMED (U.N.O.)

BEAM SCHEDULE

MARK #	MEMBER
B1	(2)-1-3/4"x24" LVL
B2	(3)-1-3/4"x24" LVL
B3	TRUSS GIRDER
B4	
B5	(2)-2"x12" PT
B6	(3)-2"x12" PT
B7	(2)-2"x10" PT
B8	(3)-2"x10" PT
B9	(2)-2"x8" PT

COLUMN SCHEDULE

MARK #	MEMBER
C1	(3)-2x6
C2	(3)-2x4
C4	(4)-2x4
C5	(2)-2x6

WOOD FRAMING SCHEDULE

MARK #	MEMBER	SPACING
A	24" FLOOR TRUSS	24" O.C.
B	24" FLOOR TRUSS	16" O.C.
C	2x10 (PRESSURE TREATED)	16" O.C.
D	2x6 (PRESSURE TREATED)	16" O.C.
E	2x8	24" O.C.

STRUCTURAL WALL LEGEND

MARK	FRAMING SIZE	STUD SPACING	NOTES
W1A	2x6	16" O.C.	No. 2 SYP OR DOUG-FIR-LARCH
W1	2x6	16" O.C.	No. 2 SYP OR DOUG-FIR-LARCH
W2	2-2x6	16" O.C.	No. 2 SYP OR DOUG-FIR-LARCH

NOTES:

- NON-LOAD BRG. WALL SHALL BE 2x4 @ 16" O.C.
- BEARING WALL STUDS SHALL BE SPACED TO ALIGN DIRECTLY BELOW FLOOR OR ROOF TRUSSES AT AS MANY LOCATIONS AS POSSIBLE.
- ALL FRAMING SHALL BE PLATFORM FRAMED.
- SEE ARCH FOR ADDITIONAL INFORMATION.

SHEATHING/SHEAR WALL SCHEDULE

WALL TYPE	WALL MATERIAL	EDGE NAILING	SILL ANCHORS		SOLE NAILING		REMARKS	
			SPA	SIZE	SPA	SIZE		
1	PLYWOOD (STRUCT.1)	15/32"	1	6"	10d COMMON	16" 1/2" 4"	16d	1, 4
2	PLYWOOD (STRUCT.1)	15/32"	1	4"	10d COMMON	16" 1/2" 8"	14"x6" SIMP. SDS	1, 4

IF ARCH SHOWS 1 HR. WALL ASSEMBLY, REFER TO UL ASSEMBLY REQUIREMENTS FOR MINIMUM WALL MATERIAL THICKNESS.

NOTES:

- NAIL SPACING INDICATED IS FOR EDGE NAILING OF THE SPECIFIED WALL MATERIAL TYPICAL INTERMEDIATE STUDS (FIELD NAILING) AND BLOCKING. IF PRESENT, SHALL BE NAILED AT 12" O.C. @ PLYWOOD SHEARWALLS. OMIT SILL ANCHORS AT UPPER LEVELS.
- WALL SEGMENTS WITH HEIGHT TO WIDTH RATIOS GREATER THAN 2 TO 1 SHALL BE BLOCKED CONSTRUCTION. ALL WALL SEGMENTS SHALL BE UNBLOCKED CONSTRUCTION.
- SINKER NAILS MAY BE SUBSTITUTED PROVIDED THE SHEAR CAPACITY MATCHES COMMON NAILS.
- SEE 9/S301 FOR TYP. SHEARWALLS.

1925 Prospect Ave.
Orlando, FL 32814
P (407) 661-9100
F (407) 661-9101
www.r.p.com

Calaci & Peterson
Architects Engineers Planners

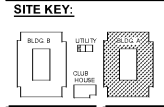
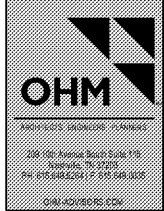

CLIENT NAME
HUTTON DEVELOPMENT

PROJECT NAME
ROCKLEDGE FLATS - BUILDING "A"
1220 Baron Boulevard
Rockledge, FL 32955

SHEET TITLE
THIRD FLOOR FRAMING PLAN - PART A



No.	Description	Date

PROJECT NO. 054015000
DATE 20/09/20
DRAWN
CHECKED
19181-RC19

S131A

GMP PRICING SET 15 NOVEMBER 2019