

1 ROOF FRAMING PLAN - PART B
1/8" = 1'-0"

- NOTES:
- SEE S0-01 FOR STRUCTURAL GENERAL NOTES.
 - SEE ARCH FOR ADDITIONAL INFORMATION AND DIMENSIONS.
 - DECK BEARING ELEVATION RELATIVE TO LEVEL 01 FLOOR REFERENCE ELEVATION = 0'-0" UNO.
 - INDICATES DIRECTIONAL SPAN OF 1 1/2" 22 GA GALV ROOF DECK. SEE 4'S5-03.
 - INDICATES BRACED FRAME. SEE SHEET S3-07.
 - INDICATES CONT. HORIZ. BRIDGING AT TOP AND BOTTOM CHORD OF JOISTS WITH ADDITIONAL X-TYPE BRIDGING IN THE FIRST PANEL AND EVERY SIXTH PANEL. BRIDGING SHALL BE WELDED TO JOISTS, FRAMING, AND AT CROSSOVER POINTS. USE 1 1/2" x 1 1/2" x 1/8".
 - PROVIDE JOIST REINFORCEMENT AT CONCENTRATED LOADS. SEE 12'S5-03.
 - CONTRACTOR TO COORDINATE LOCATION AND WEIGHTS OF ALL RTU UNITS PRIOR TO INSTALLATION. CONTACT ENGINEER W/ ANY DISCREPANCIES.
 - SEE DETAILS 8, 12, 16 AND 20'S4-01 FOR TYPICAL BRACING OF CMU PARTITION WALLS AT ROOF.
 - SEE S5-03 FOR TYPICAL SUPPORT FRAMING AT ROOF OPENINGS.
 - SEE DETAIL 12'S5-03 FOR JOIST REINFORCEMENT AT CONCENTRATED LOAD.
 - SEE 2 AND 6'S4-01 FOR LOOSE LINTEL SCHEDULE AT BRICK OPENINGS NOT SHOWN ON DRAWINGS.

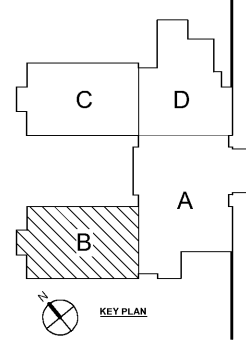

Order Plans @

Smallwood, Reynolds, Stewart & Associates, Inc. Architects

One Piedmont Center, Suite 303 3565 Piedmont Road Atlanta, Georgia 30305

ROOF FRAMING PLAN - PART B

J.H. HOUSE ELEMENTARY SCHOOL
3100 Zingira Road NE, Conyers, GA 30012

DATE: 10.01.2019
JOB NO: 218036.00
SHEET NO: S1-03B

ISSUED FOR CONSTRUCTION

REV. NO.	DATE	REMARKS
1	10.01.19	ISSUED FOR PERMIT/ISSUE PAUL
2	10.01.19	ISSUED FOR PERMIT/ISSUE PAUL
3	10.01.19	ISSUED FOR PERMIT/ISSUE PAUL
4	10.01.19	ISSUED FOR PERMIT/ISSUE PAUL

REVISIONS / PRINTED	DATE	REMARKS
46	10.01.19	ISSUED FOR PERMIT/ISSUE PAUL
47	10.01.19	ISSUED FOR PERMIT/ISSUE PAUL
48	10.01.19	ISSUED FOR PERMIT/ISSUE PAUL
49	10.01.19	ISSUED FOR PERMIT/ISSUE PAUL
50	10.01.19	ISSUED FOR PERMIT/ISSUE PAUL
51	10.01.19	ISSUED FOR PERMIT/ISSUE PAUL

INSTRUCTIONAL UNIT	BLDG AREA	LEVEL SQ	COVERED AREAS (IE CANOPIES)	TOTAL
REGULAR CLASSROOMS	71,153 SF	71,153 SF	0 SF	71,153 SF
MUSIC	3,228 SF	3,228 SF	0 SF	3,228 SF
PHYSICAL EDUCATION	10,631 SF	10,631 SF	0 SF	10,631 SF
ART CENTER	5,198 SF	5,198 SF	0 SF	5,198 SF
TOTAL	90,210 SF	90,210 SF	0 SF	90,210 SF

PROJECT SUMMARY: J.H. HOUSE ELEMENTARY SCHOOL
GRADE: PRE-K THROUGH 5TH
P.T.E. 900
G.O.D.E.# TO BE ASSIGNED

RCPS

STATE OF GEORGIA
REGISTERED PROFESSIONAL ARCHITECT
STEWART & ASSOCIATES, INC.
1000 WOODLAND DRIVE, SUITE 303
ATLANTA, GEORGIA 30305
PHONE: 404.525.1234
FAX: 404.525.1235
WWW.STA-ARCHITECTS.COM