

1 LEVEL 02 FLOOR FRAMING PLAN - PART B
1/8" = 1'-0"

- NOTES:
- SEE S5-01 FOR STRUCTURAL GENERAL NOTES.
 - SEE ARCH FOR ADDITIONAL INFORMATION AND DIMENSIONS.
 - DECK BEARING ELEVATION = 10'-6 3/4" RELATIVE TO LEVEL 01 FLOOR REFERENCE ELEVATION, UNO.
 - INDICATES DIRECTIONAL SPAN OF 2" 18 GA COMPOSITE FLOOR DECK W/ 3 1/4" LIGHTWEIGHT CONCRETE (5 1/4" TOTAL DEPTH) W/ W/WF 6X6 W/ 2-WAL2.0. SEE S55-02.
 - INDICATES BRACED FRAME. SEE SHEET S5-07.
 - (x) INDICATES NUMBER OF 3/4" Ø HEADED STUDS EQUALLY SPACED. SEE 19S55-02.
 - INDICATES MOMENT CONNECTION.
 - V-x INDICATES MAXIMUM SHEAR REACTION OF 10 KIPS, UNO.
 - INDICATES EXTENTS OF DROP IN SLAB FOR FINISH. SEE ARCH EDGE OF SLAB PLAN FOR DIMENSIONS AND DEPTH OF DEPRESSION.
 - SEE DETAIL S55-02 FOR OPENINGS IN COMPOSITE SLAB.
 - F.D. INDICATES FLOOR DRAIN. SLOPE SLAB TO DRAIN.
 - SEE 17S-4-01 FOR TYPICAL BRACING OF CMU PARTITION WALLS AT COMPOSITE DECK.
 - SEE 13S5-02 FOR REINF AT INTERIOR CMU WALLS AT COMPOSITE SLAB.

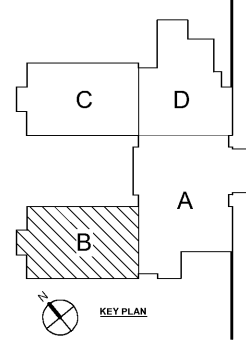

Order Plans @ www.dawgdrawings.com

Smallwood, Reynolds, Stewart & Associates, Inc. Architects

LEVEL 02 FLOOR FRAMING PLAN - PART B

J.H. HOUSE ELEMENTARY SCHOOL
3100 Zingira Road NE, Conyers, GA 30012

DATE: 10.01.2019
JOB NO: 218036.00
SHEET NO: S1-02B

ISSUED FOR CONSTRUCTION

REV. NO.	DATE	REMARKS
1	10.01.19	ISSUED FOR PERMIT/ISSUE FOR
2	10.01.19	ISSUED FOR PERMIT/ISSUE FOR
3	10.01.19	ISSUED FOR PERMIT/ISSUE FOR
4	10.01.19	ISSUED FOR PERMIT/ISSUE FOR
5	10.01.19	ISSUED FOR PERMIT/ISSUE FOR
6	10.01.19	ISSUED FOR PERMIT/ISSUE FOR
7	10.01.19	ISSUED FOR PERMIT/ISSUE FOR
8	10.01.19	ISSUED FOR PERMIT/ISSUE FOR
9	10.01.19	ISSUED FOR PERMIT/ISSUE FOR
10	10.01.19	ISSUED FOR PERMIT/ISSUE FOR
11	10.01.19	ISSUED FOR PERMIT/ISSUE FOR
12	10.01.19	ISSUED FOR PERMIT/ISSUE FOR
13	10.01.19	ISSUED FOR PERMIT/ISSUE FOR
14	10.01.19	ISSUED FOR PERMIT/ISSUE FOR
15	10.01.19	ISSUED FOR PERMIT/ISSUE FOR
16	10.01.19	ISSUED FOR PERMIT/ISSUE FOR
17	10.01.19	ISSUED FOR PERMIT/ISSUE FOR
18	10.01.19	ISSUED FOR PERMIT/ISSUE FOR
19	10.01.19	ISSUED FOR PERMIT/ISSUE FOR
20	10.01.19	ISSUED FOR PERMIT/ISSUE FOR
21	10.01.19	ISSUED FOR PERMIT/ISSUE FOR
22	10.01.19	ISSUED FOR PERMIT/ISSUE FOR
23	10.01.19	ISSUED FOR PERMIT/ISSUE FOR
24	10.01.19	ISSUED FOR PERMIT/ISSUE FOR
25	10.01.19	ISSUED FOR PERMIT/ISSUE FOR
26	10.01.19	ISSUED FOR PERMIT/ISSUE FOR
27	10.01.19	ISSUED FOR PERMIT/ISSUE FOR
28	10.01.19	ISSUED FOR PERMIT/ISSUE FOR
29	10.01.19	ISSUED FOR PERMIT/ISSUE FOR
30	10.01.19	ISSUED FOR PERMIT/ISSUE FOR
31	10.01.19	ISSUED FOR PERMIT/ISSUE FOR
32	10.01.19	ISSUED FOR PERMIT/ISSUE FOR
33	10.01.19	ISSUED FOR PERMIT/ISSUE FOR
34	10.01.19	ISSUED FOR PERMIT/ISSUE FOR
35	10.01.19	ISSUED FOR PERMIT/ISSUE FOR
36	10.01.19	ISSUED FOR PERMIT/ISSUE FOR
37	10.01.19	ISSUED FOR PERMIT/ISSUE FOR
38	10.01.19	ISSUED FOR PERMIT/ISSUE FOR
39	10.01.19	ISSUED FOR PERMIT/ISSUE FOR
40	10.01.19	ISSUED FOR PERMIT/ISSUE FOR
41	10.01.19	ISSUED FOR PERMIT/ISSUE FOR
42	10.01.19	ISSUED FOR PERMIT/ISSUE FOR
43	10.01.19	ISSUED FOR PERMIT/ISSUE FOR
44	10.01.19	ISSUED FOR PERMIT/ISSUE FOR
45	10.01.19	ISSUED FOR PERMIT/ISSUE FOR
46	10.01.19	ISSUED FOR PERMIT/ISSUE FOR
47	10.01.19	ISSUED FOR PERMIT/ISSUE FOR
48	10.01.19	ISSUED FOR PERMIT/ISSUE FOR
49	10.01.19	ISSUED FOR PERMIT/ISSUE FOR
50	10.01.19	ISSUED FOR PERMIT/ISSUE FOR
51	10.01.19	ISSUED FOR PERMIT/ISSUE FOR
52	10.01.19	ISSUED FOR PERMIT/ISSUE FOR
53	10.01.19	ISSUED FOR PERMIT/ISSUE FOR
54	10.01.19	ISSUED FOR PERMIT/ISSUE FOR
55	10.01.19	ISSUED FOR PERMIT/ISSUE FOR
56	10.01.19	ISSUED FOR PERMIT/ISSUE FOR
57	10.01.19	ISSUED FOR PERMIT/ISSUE FOR
58	10.01.19	ISSUED FOR PERMIT/ISSUE FOR
59	10.01.19	ISSUED FOR PERMIT/ISSUE FOR
60	10.01.19	ISSUED FOR PERMIT/ISSUE FOR
61	10.01.19	ISSUED FOR PERMIT/ISSUE FOR
62	10.01.19	ISSUED FOR PERMIT/ISSUE FOR
63	10.01.19	ISSUED FOR PERMIT/ISSUE FOR
64	10.01.19	ISSUED FOR PERMIT/ISSUE FOR
65	10.01.19	ISSUED FOR PERMIT/ISSUE FOR
66	10.01.19	ISSUED FOR PERMIT/ISSUE FOR
67	10.01.19	ISSUED FOR PERMIT/ISSUE FOR
68	10.01.19	ISSUED FOR PERMIT/ISSUE FOR
69	10.01.19	ISSUED FOR PERMIT/ISSUE FOR
70	10.01.19	ISSUED FOR PERMIT/ISSUE FOR
71	10.01.19	ISSUED FOR PERMIT/ISSUE FOR
72	10.01.19	ISSUED FOR PERMIT/ISSUE FOR
73	10.01.19	ISSUED FOR PERMIT/ISSUE FOR
74	10.01.19	ISSUED FOR PERMIT/ISSUE FOR
75	10.01.19	ISSUED FOR PERMIT/ISSUE FOR
76	10.01.19	ISSUED FOR PERMIT/ISSUE FOR
77	10.01.19	ISSUED FOR PERMIT/ISSUE FOR
78	10.01.19	ISSUED FOR PERMIT/ISSUE FOR
79	10.01.19	ISSUED FOR PERMIT/ISSUE FOR
80	10.01.19	ISSUED FOR PERMIT/ISSUE FOR
81	10.01.19	ISSUED FOR PERMIT/ISSUE FOR
82	10.01.19	ISSUED FOR PERMIT/ISSUE FOR
83	10.01.19	ISSUED FOR PERMIT/ISSUE FOR
84	10.01.19	ISSUED FOR PERMIT/ISSUE FOR
85	10.01.19	ISSUED FOR PERMIT/ISSUE FOR
86	10.01.19	ISSUED FOR PERMIT/ISSUE FOR
87	10.01.19	ISSUED FOR PERMIT/ISSUE FOR
88	10.01.19	ISSUED FOR PERMIT/ISSUE FOR
89	10.01.19	ISSUED FOR PERMIT/ISSUE FOR
90	10.01.19	ISSUED FOR PERMIT/ISSUE FOR
91	10.01.19	ISSUED FOR PERMIT/ISSUE FOR
92	10.01.19	ISSUED FOR PERMIT/ISSUE FOR
93	10.01.19	ISSUED FOR PERMIT/ISSUE FOR
94	10.01.19	ISSUED FOR PERMIT/ISSUE FOR
95	10.01.19	ISSUED FOR PERMIT/ISSUE FOR
96	10.01.19	ISSUED FOR PERMIT/ISSUE FOR
97	10.01.19	ISSUED FOR PERMIT/ISSUE FOR
98	10.01.19	ISSUED FOR PERMIT/ISSUE FOR
99	10.01.19	ISSUED FOR PERMIT/ISSUE FOR
100	10.01.19	ISSUED FOR PERMIT/ISSUE FOR

One Piedmont Center, Suite 303 3565 Piedmont Road Atlanta, Georgia 30305

REVISIONS / PRINTED
46
45
44
43
42
41
40
39
38
37
36
35
34
33
32
31
30
29
28
27
26
25
24
23
22
21
20
19
18
17
16
15
14
13
12
11
10
9
8
7
6
5
4
3
2
1
TOTAL

INSTRUCTIONAL UNIT	BLU AREA	LEVEL 02	TOTAL
REGULAR CLASSROOMS	71,155 SF		
MUSIC	3,238 SF		
PHYSICAL EDUCATION	106,331 SF		
ART CENTER	5,188 SF		
ART	5,188 SF		
TOTAL	191,100 SF		

PROJECT SUMMARY	PROJECT AREA	LEVEL 02	TOTAL
REGULAR CLASSROOMS	71,155 SF		
MUSIC	3,238 SF		
PHYSICAL EDUCATION	106,331 SF		
ART CENTER	5,188 SF		
ART	5,188 SF		
TOTAL	191,100 SF		



SMALLWOOD, REYNOLDS, STEWART & ASSOCIATES, INC.
REGISTERED PROFESSIONAL ARCHITECTS
STATE OF GEORGIA
NO. 10000
J. STEWART REYNOLDS
10/1/2019