

**Order Plans**

**WWW.LDILine.com**

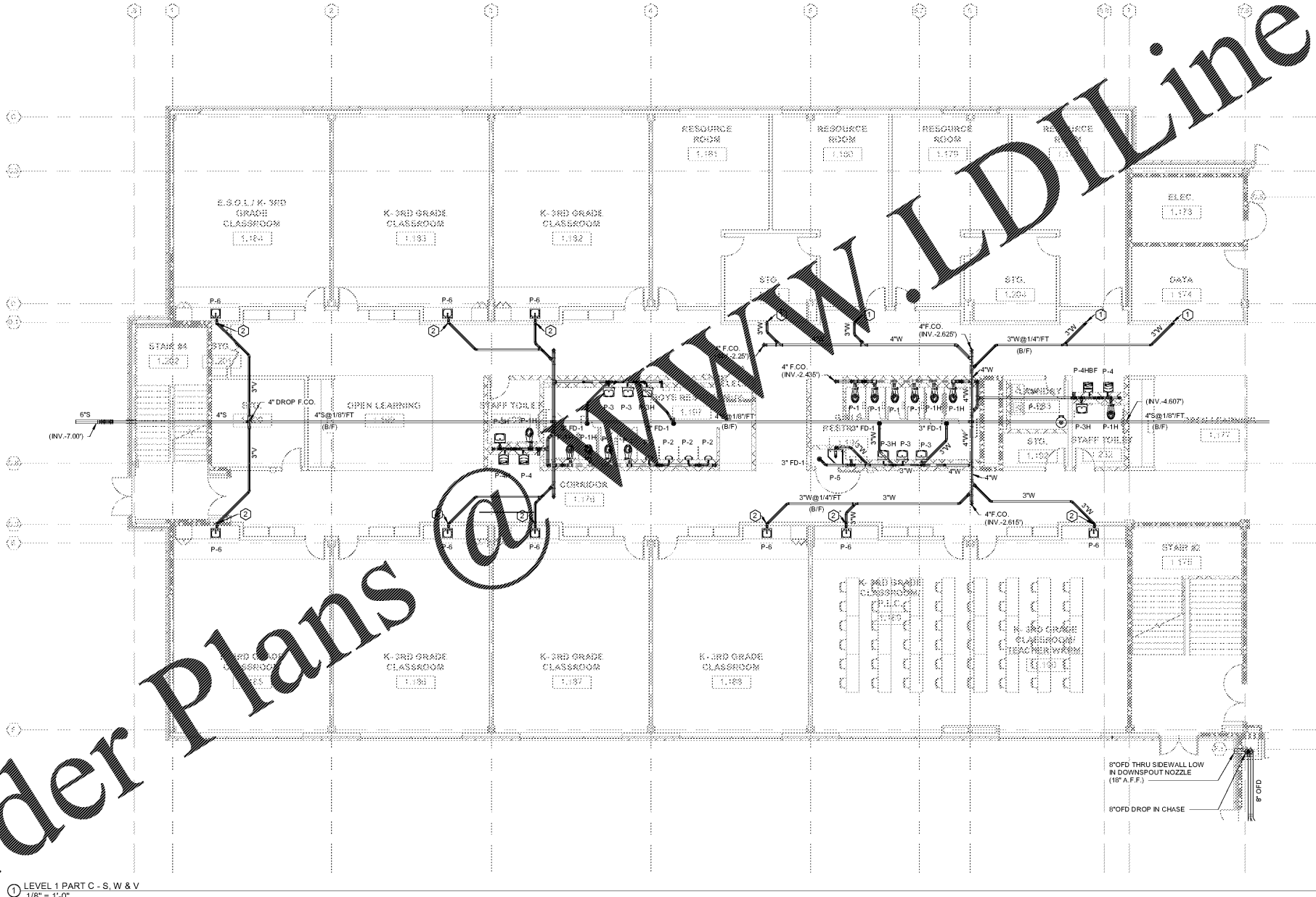

① LEVEL 1 PART C - S, W & V  
1/8" = 1'-0"

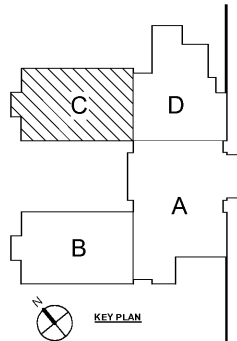

**MBA CONSULTING ENGINEERS**  
MBA# 18033  
MATHESON HALL & ASSOCIATES, INC.  
11380 ELKING RD., SUITE F-3  
ROSWELL, GEORGIA 30076  
PHONE: (770) 784-1073  
WWW.MATHESONHALL.COM

- PLUMBING NOTES-SHEET P1-01 B ONLY:**
- ① 2" W&V DN IN WALL.
  - ② 3" W&V STACK UP AND DN IN WALL. CONTINUED ON P1-02.B.
  - ③ 3" V UP TO FLOOR ABOVE. CONTINUED ON P1-02.B.

REV. NO.	DATE	REMARKS
00019		001 OF 3 CHECK SET
00019		002 OF 3 FOR BAY PERMIT QUEUE



**LEVEL 01 PART C - S, W & V**  
**J.H. HOUSE ELEMENTARY SCHOOL**  
3100 Zingira Road NE, Conyers, GA 30012

DATE	10-01-2019
JOB NO.	218036.00
SHEET NO.	P1-01.C

Smallwood, Reynolds, Stewart & Associates, Inc. Architects      One Piedmont Center, Suite 303 3565 Piedmont Road Atlanta, Georgia 30305

ISSUED FOR CONSTRUCTION