

Order Plans

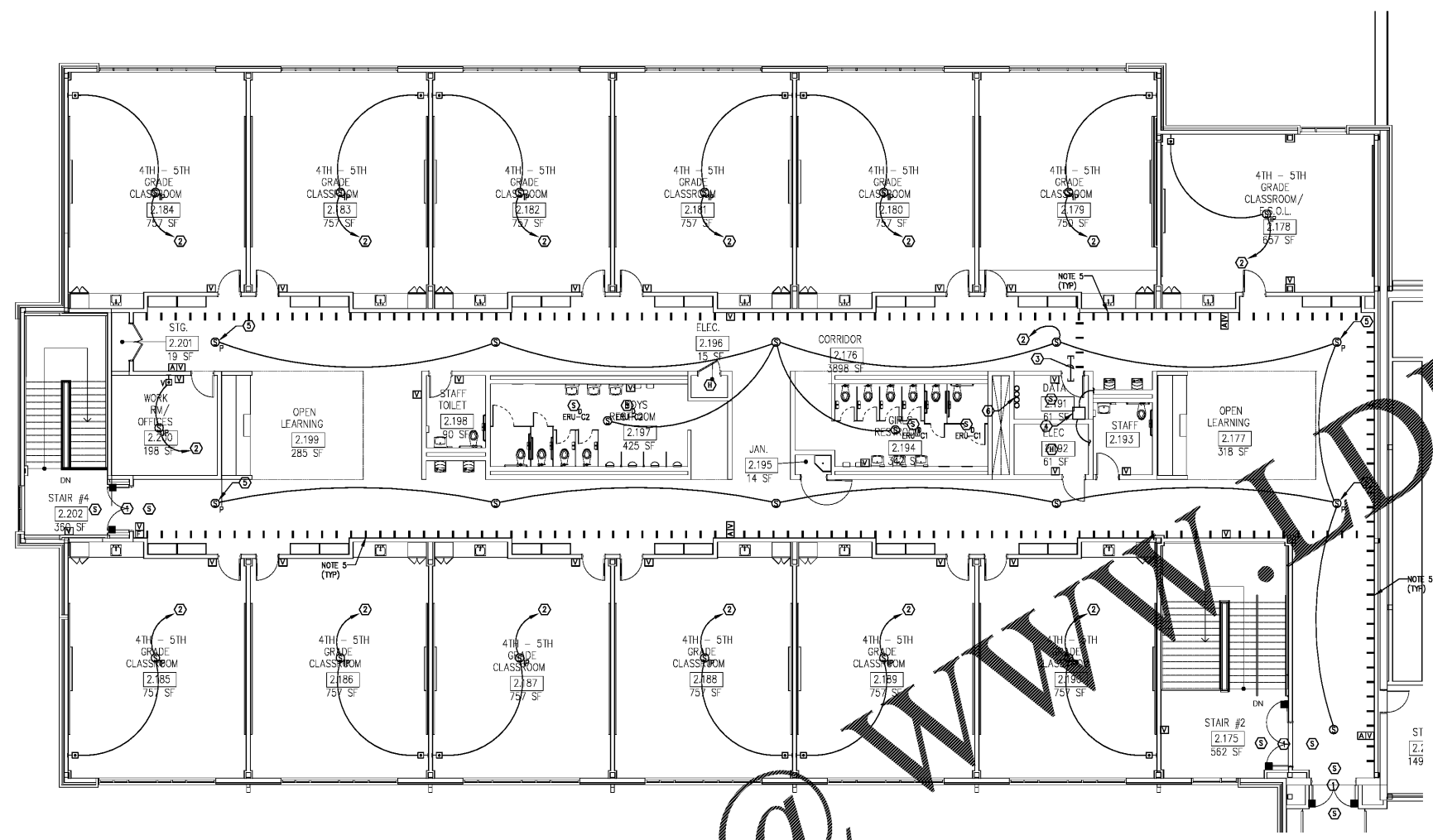

1 LEVEL 02 PART C - SYSTEMS PLAN  
E3-02.C 1/8" = 1'-0"

- NOTES:**
1. ALL SYSTEMS CABLING SHALL BE PLENUM RATED. REFER TO SPECIFICATIONS FOR ADDITIONAL CABLING REQUIREMENTS.
  2. ALL PLENUM RATED SYSTEMS CABLING INSTALLED IN WALLS SHALL BE INSTALLED IN CONDUIT. PROVIDE JUNCTION BOX ABOVE CEILING, AND ROUTE CABLING IN CONDUIT FROM JUNCTION BOX DOWN TO FLUSH DEVICE BOX.
  3. ALL SYSTEMS CABLING INSTALLED EXPOSED (IN AREAS WITHOUT CEILINGS) SHALL BE ROUTED IN CONDUIT. THIS DOES NOT APPLY TO AREAS OF CORRIDORS WITHOUT CEILINGS OR CLASSROOMS WHERE PORTIONS OF THE CEILING SPACE ARE EXPOSED. IN THOSE AREAS, CABLING MAY REMAIN UNPROTECTED, BUT SHALL BE NEATLY BUNDLED AND SUPPORTED IN CABLE HANGERS OR SIMILAR.
  4. WHERE CABLING PASSES THROUGH WALLS INTO INDIVIDUAL ROOMS, PROVIDE (2) 1" CONDUIT SLEEVES THROUGH THE WALL WITH BUSHINGS ON EACH END. FIRE STOP SLEEVES FOR ALL CABLING IS TO BE INSTALLED. SLEEVES SHALL BE INSTALLED ABOVE THE DOOR TO THE ROOM. THIS APPLIES TO ALL ROOMS.
  5. CABLE HANGER MOUNTED ABOVE CEILING. SEE DETAIL 1, SHEET E3-01.

- KEYNOTES:**
1. PROVIDE MANTIC DOOR HOLDERS AND SMOKE DETECTORS. COORDINATE EXACT LOCATION WITH ARCHITECT PRIOR TO ROUGH-IN. WHERE A MANUFACTURER USES A LOW VOLTAGE TRANSFORMER TO CONTROL AND OPERATE THE DOOR HOLDERS, MOUNT TRANSFORMER ABOVE CEILING IN NEMA 1 ENCLOSURE WITHIN FOUR FEET OF DOORS. SMOKE DETECTORS SHALL BE MOUNTED WITHIN FIVE FEET OF THE DOOR OPENING.
  2. ROUTE PLENUM RATED CAT 6 INTERCOM CABLING IN CABLE HANGERS ABOVE CORRIDOR CEILINGS TO THE WALL MOUNTED INTERCOM RACK IN DATA ROOM 2.191.
  3. PROVIDE (3) 3" SLEEVES THROUGH WALL ABOVE CEILING FOR INSTALLATION OF PLENUM RATED CABLING. PROVIDE BUSHINGS ON EACH END OF SLEEVES. FIRE STOP SLEEVES AFTER ALL CABLING IS INSTALLED.
  4. WALL MOUNTED INTERCOM RACK. COORDINATE LOCATION WITH THE OWNER'S DATA INSTALLERS TO ENSURE ADEQUATE SPACE FOR THE DATA RACK INSTALLATION. INTERCONNECT THE INTERCOM RACKS IN THE MDF AND IN THE FIVE DATA ROOMS WITH 6-STRAND MULTI-MODE, 10-GIG PLENUM RATED FIBER OPTIC CABLE TO FORM A LOOP FROM ROOM TO ROOM. FIBER OPTIC CABLE SHALL BE INSTALLED IN 1" CONDUIT, AND SHALL BE INSTALLED IN THE SLAB WHERE ROUTED ON THE LOWER LEVEL.
  5. PENDANT MOUNT SPEAKER TO 10'-0" AFF TO BOTTOM.
  6. PROVIDE (4) 3" SLEEVES THROUGH THE FLOOR TO THE CEILING SPACE OF THE LOWER LEVEL. PROVIDE BUSHINGS ON ENDS OF SLEEVES AND FIRE STOP AFTER ALL CABLING IS INSTALLED.

- INTERCOM NOTES:**
1. PRIOR TO ORDERING INTERCOM SPEAKERS, CONFIRM CEILING TYPE (GRID, GYP BOARD, OPEN STRUCTURE) WITH THE ARCHITECT'S REFLECTED CEILING PLAN. ORDER THE CORRECT TYPE OF SPEAKER FOR THE CEILING IN/ON WHICH IT WILL BE INSTALLED IN EACH SPACE.

- FIRE ALARM NOTES:**
1. FIRE ALARM CABLING ROUTED FROM THIS WING BACK TO THE FACP IN RECEPTION 1.103 SHALL BE ROUTED IN CONDUIT DOWN TO THE FIRST FLOOR SLAB, AND EXTENDED IN THE SLAB TO THE FACP IN ORDER TO MINIMIZE OVERHEAD CONDUIT RUNS IN PART A. CABLING INSTALLED WITHIN THIS WING CAN BE INSTALLED OVERHEAD IN CABLE HANGERS.
  2. FIRE ALARM CABLING INSTALLED IN CONDUIT IN THE SLAB SHALL BE AQUESEAL OR EQUAL.

REV. NO.	DATE	REVISIONS / PRINTED
06/16/19		GOE Check Set
10/01/19		ISSUED FOR BID/ PERMIT/ADDC

INSTRUCTIONAL UNITS	45	2	1	51
REGULAR CLASSROOMS				
PAIRED FLEX AREAS				
MUSICAL EDUCATION				
MEDIA CENTER				
ART				
TOTAL				

BUILDING AREA	71,452 SF
LEVEL 01	108,337 SF
TOTAL	179,789 SF

PROJECT SUMMARY	71,452 SF
NAME: J.H. HOUSE ELEMENTARY SCHOOL	108,337 SF
GRABES PREK THRU 5TH	179,789 SF
G.D.C.E.# TO BE ASSIGNED	

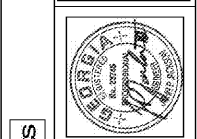

© 2019 STUART & ASSOCIATES, INC. ALL RIGHTS RESERVED. THIS DOCUMENT IS THE PROPERTY OF STUART & ASSOCIATES, INC. AND IS NOT TO BE REPRODUCED OR TRANSMITTED IN ANY FORM OR BY ANY MEANS, ELECTRONIC OR MECHANICAL, INCLUDING PHOTOCOPYING, RECORDING, OR BY ANY INFORMATION STORAGE AND RETRIEVAL SYSTEM.

Smallwood, Reynolds, Stewart & Associates, Inc. Architects

**LEVEL 02 PART C - SYSTEMS PLAN**

J.H. HOUSE ELEMENTARY SCHOOL  
3100 Zingara Road NE, Conyers, GA 30012

DATE: 10-01-2019  
JOB NO: 218036.00  
SHEET NO: E3-02.C

One Piedmont Center, Suite 303 3565 Piedmont Road Atlanta, Georgia 30305

ISSUED FOR CONSTRUCTION