

Order Plans

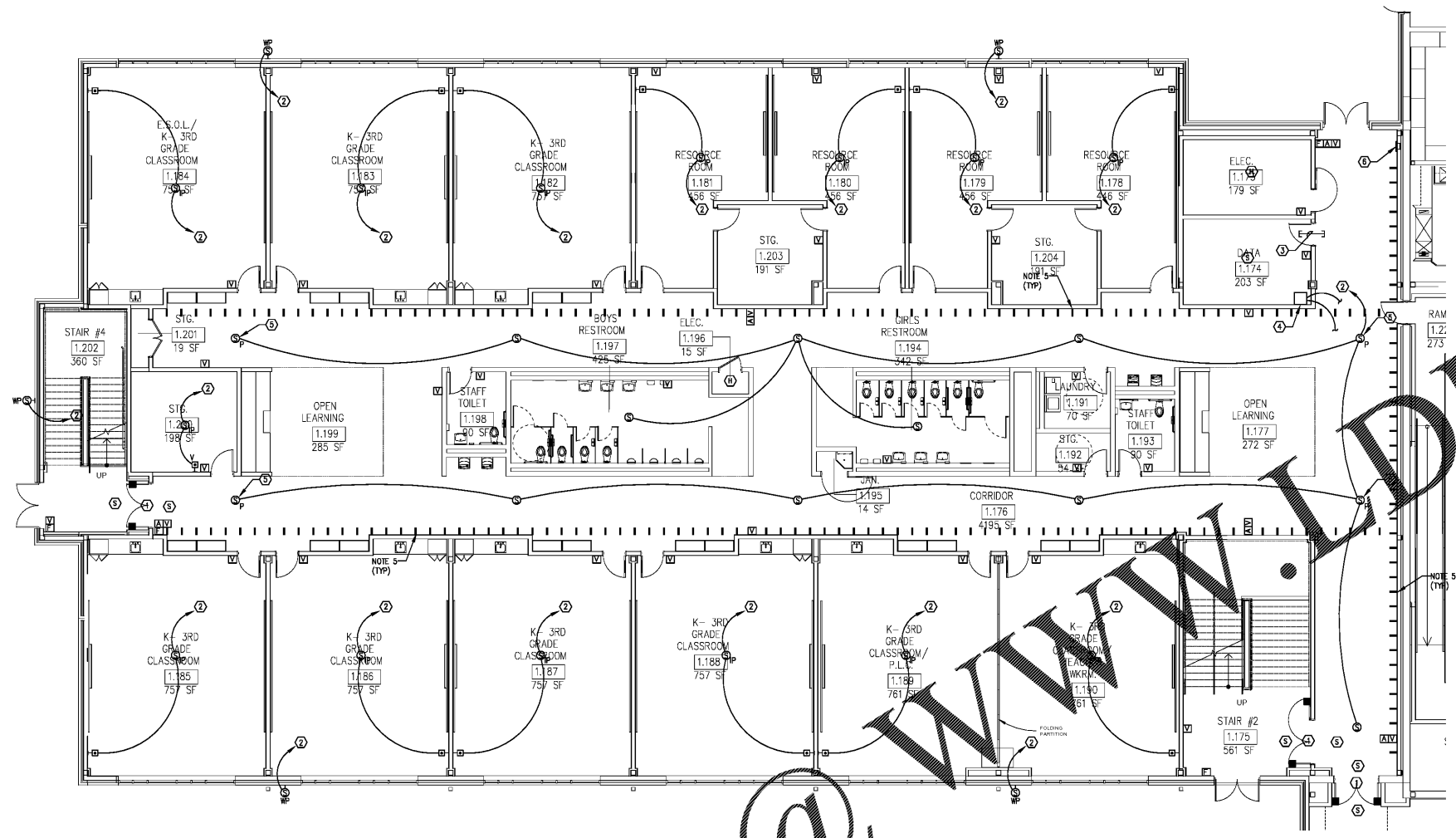

1 LEVEL 01 PART C - SYSTEMS PLAN
E3-01.C 1/8" = 1'-0"

- NOTES:**
1. ALL SYSTEMS CABLING SHALL BE PLENUM RATED. REFER TO SPECIFICATIONS FOR ADDITIONAL CABLING REQUIREMENTS.
 2. ALL PLENUM RATED SYSTEMS CABLING INSTALLED IN WALLS SHALL BE INSTALLED IN CONDUIT. PROVIDE JUNCTION BOX ABOVE CEILING, AND ROUTE CABLING IN CONDUIT FROM JUNCTION BOX DOWN TO FLUSH DEVICE BOX.
 3. ALL SYSTEMS CABLING INSTALLED EXPOSED (IN AREAS WITHOUT CEILINGS) SHALL BE ROUTED IN CONDUIT. THIS DOES NOT APPLY TO AREAS OF CORRIDORS WITHOUT CEILINGS OR CLASSROOMS WHERE PORTIONS OF THE CEILING SPACE ARE EXPOSED. IN THOSE AREAS, CABLING MAY REMAIN EXPOSED, BUT SHALL BE NEATLY BUNDLED AND SUPPORTED IN CABLE HANGERS OR SIMILAR.
 4. WHERE CABLING PASSES THROUGH WALLS INTO INDIVIDUAL ROOMS, PROVIDE (2) 1" CONDUIT SLEEVES THROUGH THE WALL WITH BUSHINGS ON EACH END. FIRE STOP SLEEVES AFTER ALL CABLING IS INSTALLED. SLEEVES SHALL BE INSTALLED ABOVE THE DOOR TO THE ROOM. THIS APPLIES TO ALL ROOMS.
 5. CABLE HANGER MOUNTED ABOVE CEILING. SEE DETAIL SHEET ES-01.
 6. SEE ARCHITECTURAL EXTERIOR ELEVATIONS FOR EXACT LOCATIONS OF EXTERIOR WALL MOUNTED DEVICES.

- KEYNOTES:**
1. PROVIDE MAGNETIC DOOR HOLDERS AND SMOKE DETECTORS. COORDINATE EXACT LOCATION WITH ARCHITECT PRIOR TO ROUGH-IN. WHERE A MANUFACTURER USES A LOW VOLTAGE TRANSFORMER TO CONTROL AND OPERATE THE DOOR HOLDERS, MOUNT TRANSFORMER ABOVE CEILING IN NEMA 1 ENCLOSURE WITHIN FOUR FEET OF DOORS. SMOKE DETECTORS SHALL BE MOUNTED WITHIN FIVE FEET OF THE DOOR OPENING.
 2. ROUTE PLENUM RATED CAT 6 INTERCOM CABLING IN CABLE HANGERS ABOVE CORRIDOR CEILING TO THE WALL MOUNTED INTERCOM RACK IN DATA ROOM 1.174.
 3. PROVIDE (3) 3" SLEEVES THROUGH WALL ABOVE CEILING FOR INSTALLATION OF PLENUM RATED CABLING. PROVIDE BUSHINGS ON EACH END OF SLEEVES. FIRE STOP SLEEVES AFTER ALL CABLING IS INSTALLED.
 4. WALL MOUNTED INTERCOM RACK. COORDINATE LOCATION WITH THE OWNER'S DATA INSTALLERS TO ENSURE ADEQUATE SPACE FOR THE DATA RACK INSTALLATION. INTERCONNECT THE INTERCOM RACKS IN THE MDF AND IN THE FIVE DATA ROOMS WITH 6-STRAND MULTI-MODE, 10-GG PLENUM RATED FIBER OPTIC CABLE TO FORM A LOOP FROM ROOM TO ROOM. FIBER OPTIC CABLE SHALL BE INSTALLED IN 1" CONDUIT ROUTED IN THE SLAB.
 5. PENDANT MOUNT SPEAKER TO 10'-0" AFF TO BOTTOM.
 6. FLUSH MOUNTED LCD TYPE FIRE ALARM ANNUNCIATOR PANEL. ROUTE SIGNAL CABLING IN 1" CONDUIT TO THE FIRE ALARM CONTROL PANEL IN RECEPTION 1.103. SEE E3-01.A.

- INTERCOM NOTES:**
1. PRIOR TO ORDERING INTERCOM SPEAKERS, CONFIRM CEILING TYPE (GRID, GYP BOARD, OPEN STRUCTURE) WITH THE ARCHITECT'S REFLECTED CEILING PLAN. ORDER THE CORRECT TYPE OF SPEAKER FOR THE CEILING IN/ON WHICH IT WILL BE INSTALLED IN EACH SPACE.

- FIRE ALARM NOTES:**
1. FIRE ALARM CABLING ROUTED FROM THIS WING BACK TO THE FACP IN RECEPTION 1.103 SHALL BE ROUTED IN CONDUIT IN THE SLAB IN ORDER TO MINIMIZE OVERHEAD CONDUIT RUNS IN PART A. CABLING INSTALLED WITHIN THIS WING CAN BE INSTALLED OVERHEAD IN CABLE HANGERS.
 2. FIRE ALARM CABLING INSTALLED IN CONDUIT IN THE SLAB SHALL BE AQUASEAL OR EQUAL.

REV. NO.	DATE	REVISIONS / PRINTED
06/16/19	GOE Check Set	
10/01/19	ISSUED FOR BID/PERMIT/GOE	

INSTRUCTIONAL UNITS	45
REGULAR CLASSROOMS	2
PAIRED FLEX AREAS	1
MUSICAL EDUCATION	1
MEDIA CENTER	1
ART	1
TOTAL	51

BUILDING AREA	71,452 SF
LEVEL 01	10,837 SF
TOTAL	82,289 SF

PROJECT SUMMARY	71,452 SF
NAME: J.H. HOUSE ELEMENTARY SCHOOL	10,837 SF
GRADE: PREK THRU 5TH	5,180 SF
G.D.C.E. # TO BE ASSIGNED	7,657 SF
TOTAL	22,674 SF



© 2019 STEWART & ASSOCIATES, INC. ALL RIGHTS RESERVED. THIS DOCUMENT IS THE PROPERTY OF STEWART & ASSOCIATES, INC. AND IS NOT TO BE REPRODUCED OR TRANSMITTED IN ANY FORM OR BY ANY MEANS, ELECTRONIC OR MECHANICAL, INCLUDING PHOTOCOPYING, RECORDING, OR BY ANY INFORMATION STORAGE AND RETRIEVAL SYSTEM.

Smallwood, Reynolds, Stewart, Stewart & Associates, Inc. Architects

LEVEL 01 PART C - SYSTEMS PLAN
J.H. HOUSE ELEMENTARY SCHOOL
3100 Zingara Road NE, Conyers, GA 30012

DATE	10-01-2019
JOB NO.	218036.00
SHEET NO.	E3-01.C

ISSUED FOR CONSTRUCTION