

Order Plans @ www.dilling.com

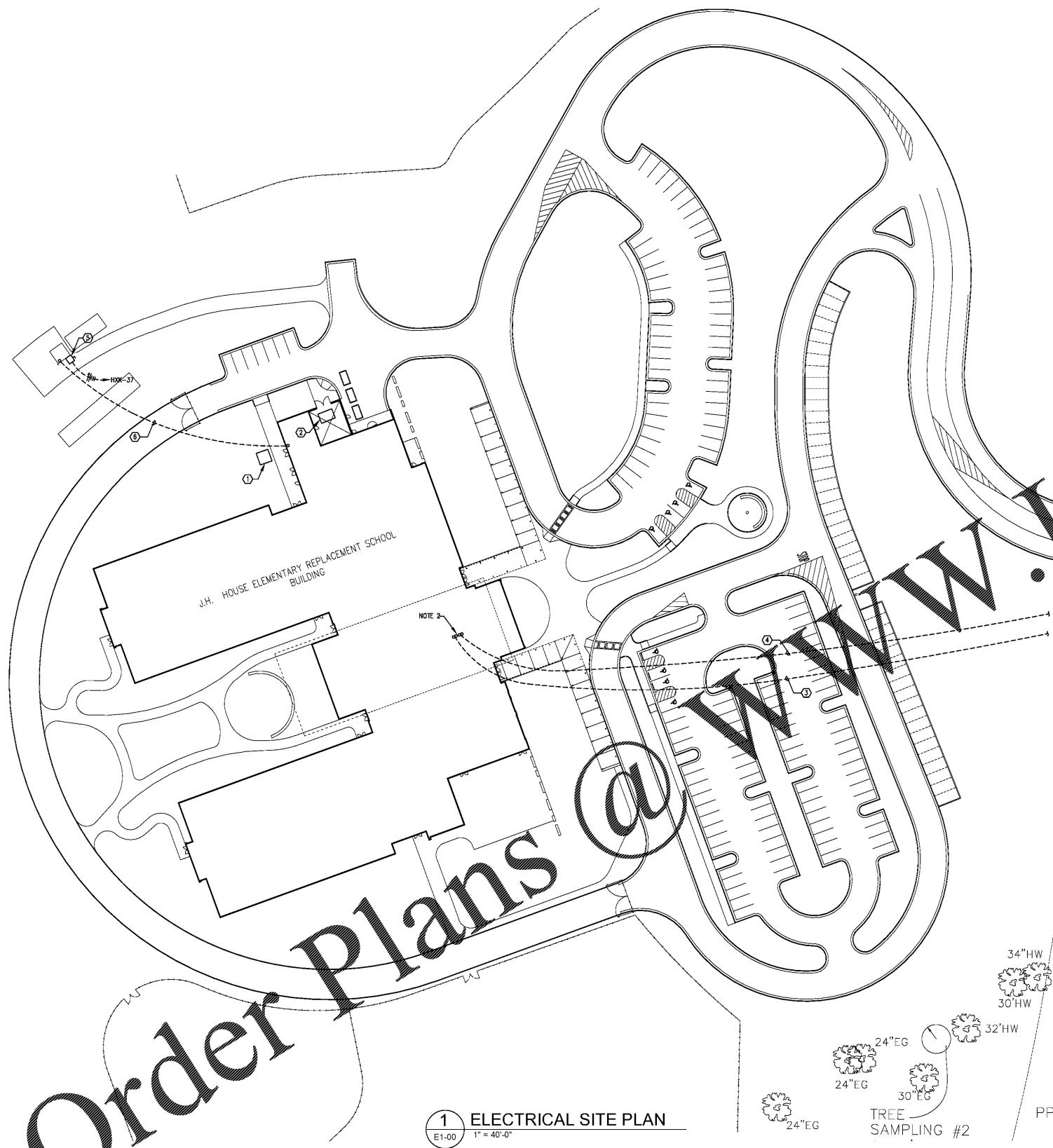

1 ELECTRICAL SITE PLAN
E1-00 1" = 40'-0"

24"EG 30"EG
24"EG 30"EG
TREE SAMPLING #2

A=366.90'
R=1907.75'
S10°55'50"W
CH=366.33'

- NOTES:
1. ALL SITE CONDUITS SHALL BE INSTALLED A MINIMUM OF 48" BELOW GRADE. REFER TO SPECIFICATIONS AND RISER DIAGRAM FOR CONCRETE ENCASEMENT, MARKING, AND ADDITIONAL REQUIREMENTS.
 2. COORDINATE CONDUIT STUB-UP AND TERMINATION LOCATIONS IN THE MDF ROOM WITH THE OWNER'S DATA EQUIPMENT INSTALLERS PRIOR TO ROUGH-IN.

- KEYNOTES:
1. PROPOSED LOCATION OF UTILITY TRANSFORMER FOR ELECTRICAL SERVICE TO SWITCHBOARD "SSA". COORDINATE EXACT LOCATION OF TRANSFORMER WITH THE UTILITY COMPANY AND CIVIL PLANS. INCLUDE IN BID ANY AND ALL COSTS ASSOCIATED WITH THE LOCATION AND CONNECTION OF THE ELECTRICAL SERVICE.
 2. EMERGENCY GENERATOR COORDINATE EXACT LOCATION WITH CIVIL PLANS.
 3. ROUTE TELEPHONE AND CABLE TV SERVICE FROM MDF ROOM 1.121 TO THE PROPERTY. EXTEND TO A LOCATION DETERMINED BY THE CABLE TV COMPANY, AND TERMINATE AS DIRECTED.
 4. PROVIDE (2) 4" CONDUITS FOR TELEPHONE AND DATA SERVICE FROM MDF ROOM 1.121 TO THE PROPERTY. ONE OF THE CONDUITS SHALL BE PROVIDED WITH THREE 1.25" INNER DUCTS. PROVIDE A PULL WIRE IN EACH INNER DUCT AND IN THE CONDUIT WITHOUT INNER DUCT. EXTEND THE CONDUITS TO A LOCATION ON THE PROPERTY LINE DETERMINED BY THE TELEPHONE COMPANY, AND TERMINATE AS DIRECTED.
 5. PROVIDE 100A/3P/FUSE/RIT DISCONNECT SWITCH ON THE EXTERIOR WALL OF THE LIFT STATION PUMP BUILDING. COORDINATE DISCONNECT LOCATION AND INSTALLATION WITH THE LIFT STATION INSTALLER PRIOR TO ROUGH-IN.
 6. PROVIDE 1" CONDUIT FROM THE LIFT STATION PUMP BUILDING TO MECHANICAL ROOM 1.223 FOR MONITORING OF THE LIFT STATION ALARM. COORDINATE STUB UP LOCATION INSIDE OF THE PUMP BUILDING WITH THE LIFT STATION INSTALLER PRIOR TO ROUGH-IN. SEE KEYNOTE 25, SHEET E4-01 FOR STUB-UP LOCATION IN THE MECHANICAL ROOM.

PLENUM SPACE NOTES (REFER TO ALL PLANS):
ABOVE CEILING SPACES ARE USED AS RETURN AIR PLENUMS. MATERIALS EXPOSED ABOVE CEILINGS SHALL BE NON-COMBUSTIBLE OR SHALL HAVE A FLAME SPREAD INDEX OF NOT MORE THAN 25 AND A SMOKE-DEVELOPED INDEX OF NOT MORE THAN 50 AS DETERMINED IN ACCORDANCE WITH ASTM E 84 (SBC SECTIONS 707.2 AND 1005.3, SMC SECTION 602.2.1).
ALL LOW VOLTAGE CABLING INSTALLED IN PLENUM SPACES SHALL EITHER BE INSTALLED IN CONDUIT OR SHALL BE PLENUM RATED.

REV. NO.	DATE	REVISIONS / PRINTED
06/16/19	06/16/19	ISSUED FOR PERMIT/ADDC
10/01/19	10/01/19	ISSUED FOR PERMIT/ADDC

REVISIONS / PRINTED	DATE	REMARKS
46		
2		
1		
51		

INSTRUCTIONAL UNITS	BUILDING AREA	COVERED AREAS (LE CHAIRS)
REGULAR CLASSROOMS	71,452 SF	5,180 SF
PAIRED READING AREAS	10,837 SF	5,180 SF
MUSICAL EDUCATION		
MEDIA CENTER		
LAB		
TOTAL	82,289 SF	10,360 SF

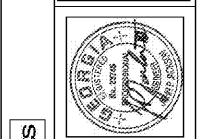

© 2019 Stewart Reynolds & Associates, Inc. All rights reserved. This drawing is the property of Stewart Reynolds & Associates, Inc. and shall not be reproduced without the written permission of Stewart Reynolds & Associates, Inc.

Smallwood, Reynolds, Stewart, Stewart & Associates, Inc. Architects

ELECTRICAL SITE PLAN

J.H. HOUSE ELEMENTARY SCHOOL
3100 Zingara Road NE, Conyers, GA 30012

DATE: 10-01-2019
JOB NO: 218036.00
SHEET NO: E1-00

One Piedmont Center, Suite 303 3565 Piedmont Road Atlanta, Georgia 30305

ISSUED FOR CONSTRUCTION