

ROCKDALE COUNTY NOTES

- A. DESIGN AND CONSTRUCTION OF ALL WATER AND SANITARY SEWER LINES SHALL CONFORM TO ROCKDALE WATER RESOURCES WATER AND WASTEWATER STANDARDS AND SPECIFICATIONS, LATEST EDITION.
- B. CONTRACTOR WILL NOTIFY RWR ENGINEERING DEPARTMENT AT LEAST 10 HOURS PRIOR TO BEGINNING OF CONSTRUCTION ON WATER AND SEWER. INSPECTION WILL BE ASSIGNED AND A PRE-CONSTRUCTION MEETING SCHEDULED AT THIS TIME.
- C. "AS-BUILT" DRAWINGS SHALL BE FIELD VERIFIED AND STAMPED BY A REGISTERED PROFESSIONAL ENGINEER OR LAND SURVEYOR LICENSED IN THE STATE OF GEORGIA.
- D. THE CONTRACTOR SHALL COMPLY WITH ALL UTILITIES PROTECTION CENTER REQUIREMENTS.

ELECTRICITY
 MITCH REISE
 GEORGIA POWER COMPANY
 3800 N. TUCKER DRIVE
 LITHONIA, GA 30058
 OFFICE: 770-337-5400
 FAX: 770-337-5404
 REISE@GPOWER.COM

PROJECT CONTACTS
OWNER/PRIMARY PERMITTEE:
 ROCKDALE COUNTY PUBLIC SCHOOLS
 1062 NORTH MAIN STREET
 CONYERS, GA 30012
 CONTACT: BRUCE STUART
 PHONE: (678) 873-7942

SITE DESIGN PROFESSIONAL:
 BREEDLOVE LAND PLANNING, INC.
 15 SIMPSON STREET
 ATLANTA, GA 30308
 CONTACT: MICHAEL W. BREEDLOVE, RIA
 PHONE: (770) 483-5373
 MOBILE: (770) 652-0076

SURVEYOR:
 PATRICK & ASSOCIATES, INC.
 928 BLACKAWN ROAD
 CONYERS, GA 30004
 CONTACT: JAMES S. HULL, JR., RLS
 PHONE: (770) 483-9745

CONTRACTOR/OPERATOR:
 DANIEL DANIEL CONSTRUCTION
 PO BOX 1439
 GAINESVILLE, GA 30503
 CONTACT: HENRY IRVIN
 PHONE: (770) 604-3045
BLP JOB No. 18151

NOTE: NO IRRIGATION SERVICE LINE OR SYSTEM IS BEING PROVIDED OR INSTALLED AS PART OF THIS SUBMITTAL

VICINITY MAP

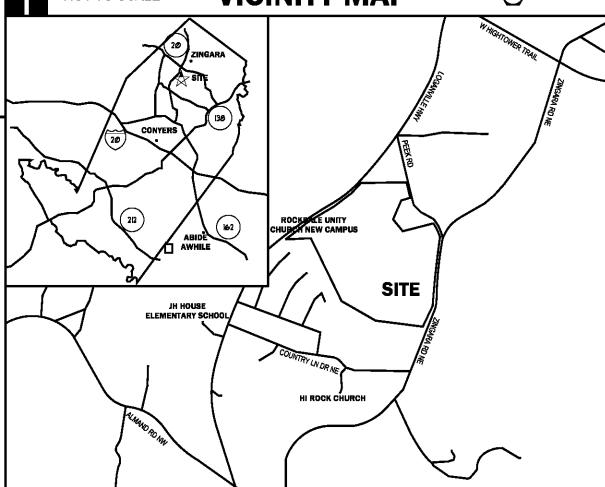

THERE ARE NO WETLANDS LOCATED ON OR WITHIN 200' OF THIS SITE.
 THERE ARE NO STATE WATERS LOCATED ON OR WITHIN 200' OF THIS SITE.

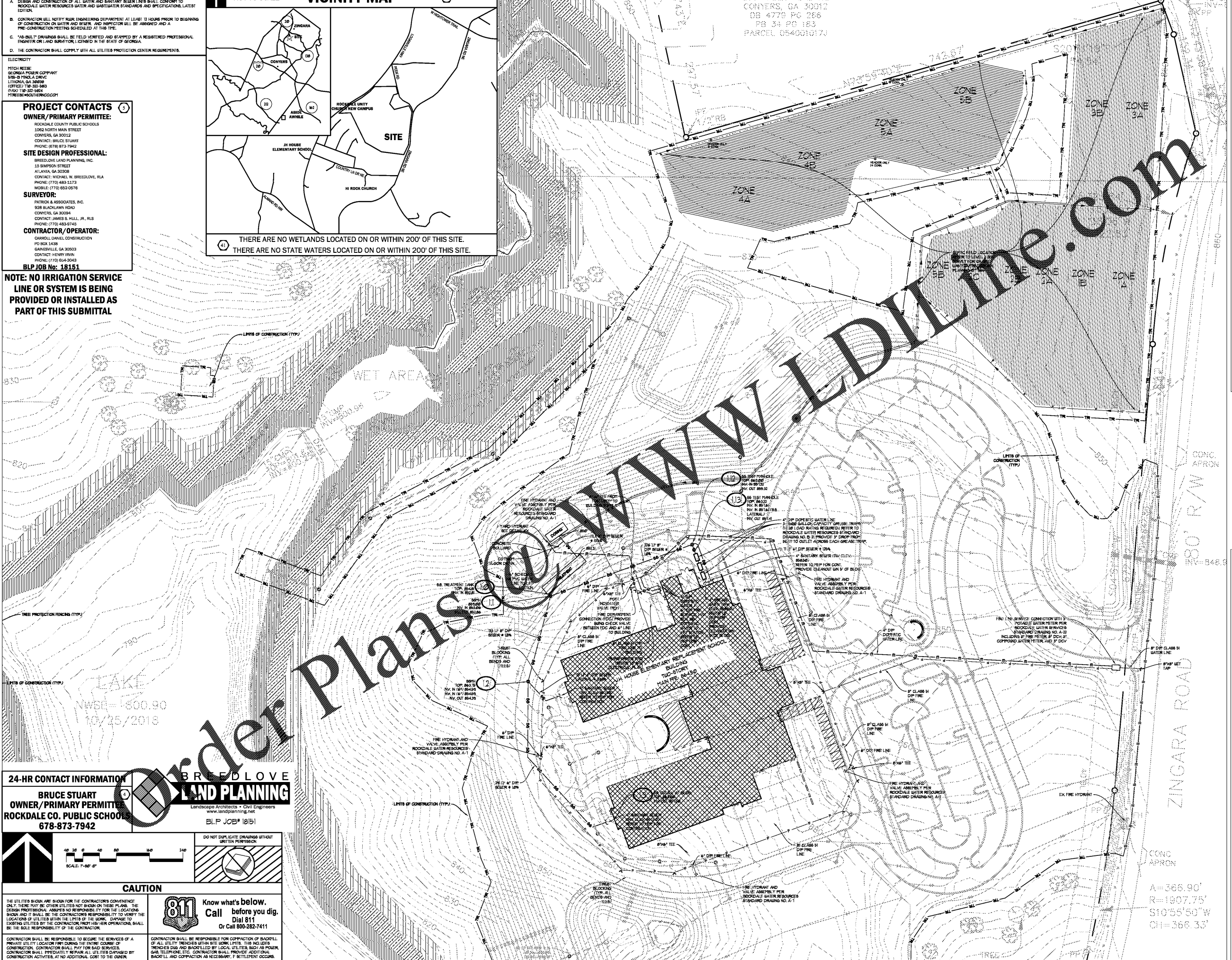

24-HR CONTACT INFORMATION

BRUCE STUART
 OWNER/PRIMARY PERMITTEE
 ROCKDALE CO. PUBLIC SCHOOLS
 678-873-7942

BREEDLOVE LAND PLANNING

Landscapes Architects • Civil Engineers
 www.landplanning.net
 BLP JOB# 18151

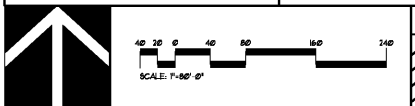

CAUTION

THE UTILITIES SHOWN ARE SHOWN FOR THE CONTRACTOR'S CONVENIENCE ONLY. THERE MAY BE OTHER UTILITIES NOT SHOWN ON THESE PLANS. THE DESIGN PROFESSIONAL ASSUMES NO RESPONSIBILITY FOR THE LOCATION, DEPTH AND TYPE OF UTILITIES. IT SHALL BE THE CONTRACTOR'S RESPONSIBILITY TO VERIFY THE LOCATION OF UTILITIES WITHIN THE LIMITS OF THE WORK. DAMAGE TO EXISTING UTILITIES BY THE CONTRACTOR FROM HIS/HER OPERATIONS, SHALL BE THE SOLE RESPONSIBILITY OF THE CONTRACTOR.

CONTRACTOR SHALL BE RESPONSIBLE TO SECURE THE SERVICES OF A PRIVATE UTILITY LOCATOR (PUL) DURING THE ENTIRE COURSE OF CONSTRUCTION. CONTRACTOR SHALL PAY FOR SAID SERVICES. CONTRACTOR SHALL PREPARE TO REPAIR ALL UTILITIES DAMAGED BY CONTRACTOR ACTIVITIES, AT NO ADDITIONAL COST TO THE OWNER.

CONTRACTOR SHALL BE RESPONSIBLE FOR CORRECTION OF BACKFILL OF ALL UTILITY TRENCHES WITHIN SITE WORK LIMITS. TRENCHES SHALL BE BACKFILLED BY LOCAL UTILITIES SUCH AS POWER, GAS, TELEPHONE, ETC. CONTRACTOR SHALL PROVIDE ADDITIONAL BACKFILL AND CORRECTION AS NECESSARY, IF SETTLEMENT OCCURS.

811 Know what's below. Call before you dig. Dial 811. Or Call 800-282-7411

SPARTAN LUMBER SA TIMBERLANDS
 3144 PEEK ROAD NE
 CONYERS, GA 30012
 DB 4779 PG 266
 PB 34 PG 183
 PARCEL 054001017J

REVISIONS / PRINTED

REV. NO.	DATE	REMARKS
1	04/05/19	ISSUE PRELIMINARY
2	08/08/19	BITS PACKAGE
3	08/16/19	ISSUE CHECK SET

INSTRUCTIONAL UNITS

UNITS	71,150 SF	37,270 SF	10,637 SF	5,186 SF	7,260 SF
REGULAR CLASSROOMS					
REGULAR CLASSROOMS					
MUSIC CENTER					
PHYSICAL EDUCATION CENTER					
ART					
TOTAL					

PROJECT SUMMARY

PROJECT SUMMARY	CHANGES	TO BE ASSIGNED	TO BE ASSIGNED
PROJECT SUMMARY	71,150 SF	37,270 SF	10,637 SF
CHANGES			
TO BE ASSIGNED			
TO BE ASSIGNED			



CONTRACTOR SHALL BE RESPONSIBLE FOR CORRECTION OF BACKFILL OF ALL UTILITY TRENCHES WITHIN SITE WORK LIMITS. TRENCHES SHALL BE BACKFILLED BY LOCAL UTILITIES SUCH AS POWER, GAS, TELEPHONE, ETC. CONTRACTOR SHALL PROVIDE ADDITIONAL BACKFILL AND CORRECTION AS NECESSARY, IF SETTLEMENT OCCURS.

Smallwood, Reynolds, Stewart & Associates, Inc. Architects

SITE UTILITY PLAN

J.H. HOUSE ELEMENTARY SCHOOL
 3100 Zingara Road NE, Conyers, GA 30012

DATE: _____

JOB NO. **218036.00**

SHEET NO. **C500**

ISSUED FOR CONSTRUCTION