

6 SECTION - STAIR #3 (STAIR #4 SIM.)
1/4" = 1'-0"

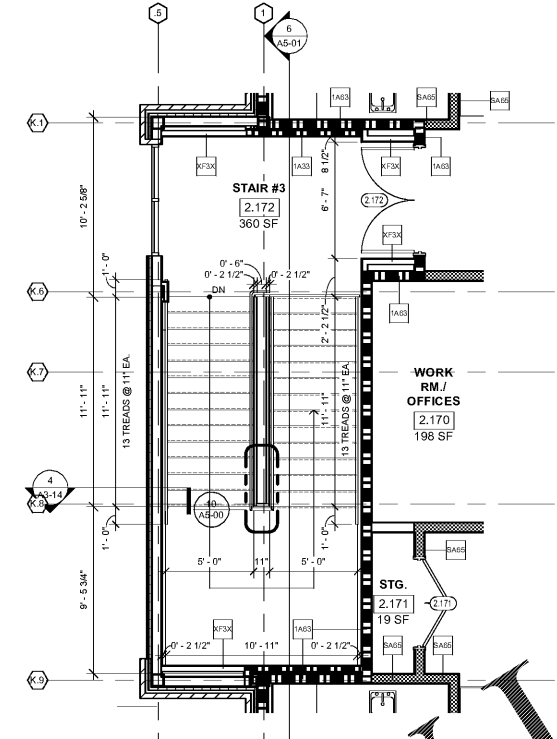

4 ENLARGED STAIR #3 PLAN - LEVEL 02
(STAIR #4 SIM.)
1/4" = 1'-0"

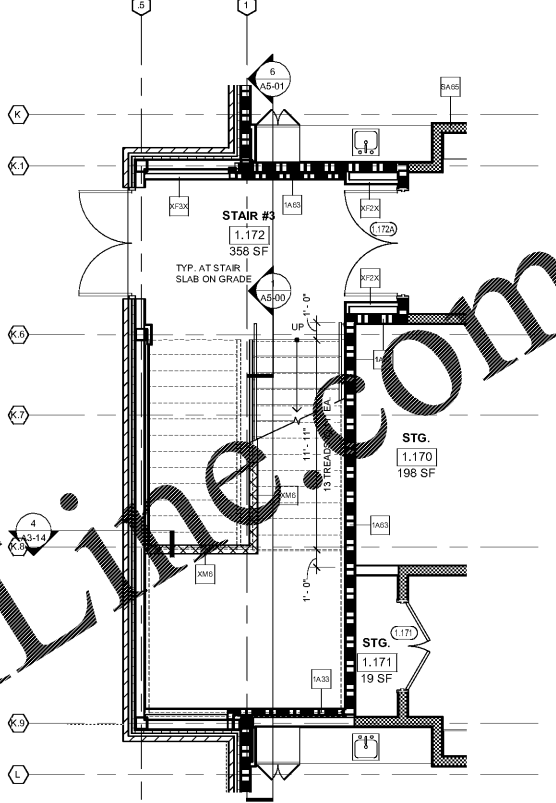

3 ENLARGED STAIR #3 PLAN - LEVEL 01
(STAIR #4 SIM.)
1/4" = 1'-0"

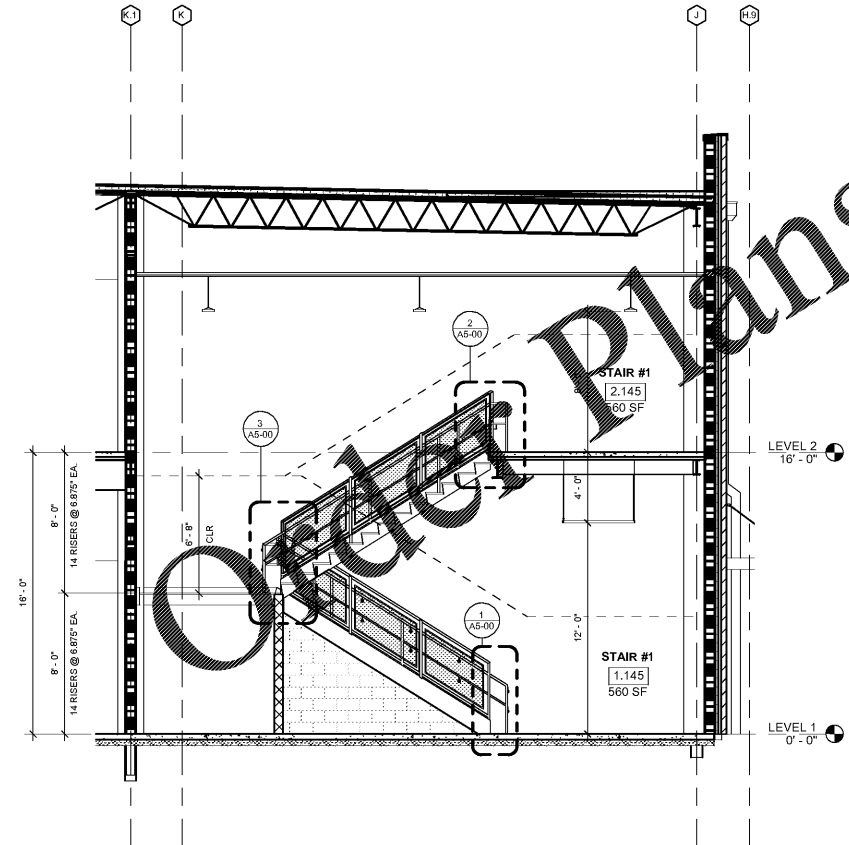

5 SECTION - STAIR #1 (STAIR #2 SIM.)
1/4" = 1'-0"

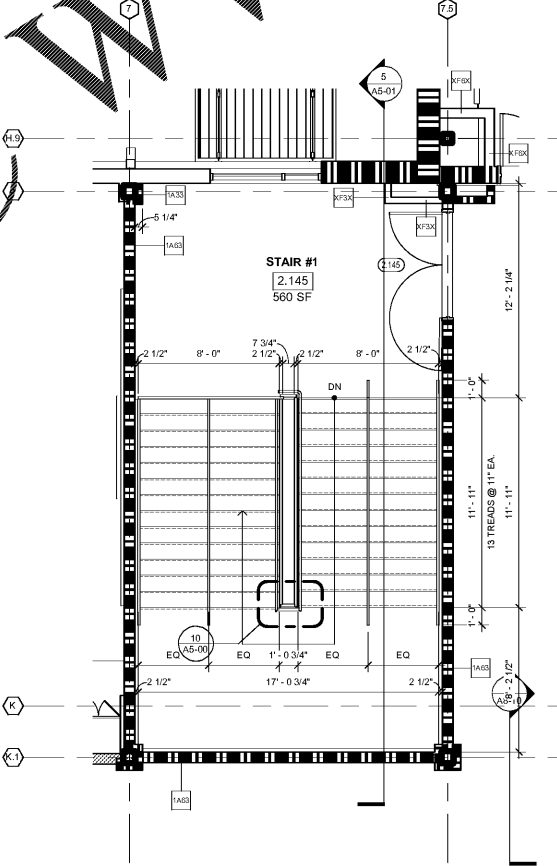

2 ENLARGED STAIR #1 PLAN - LEVEL 02
(STAIR #2 SIM.)
1/4" = 1'-0"

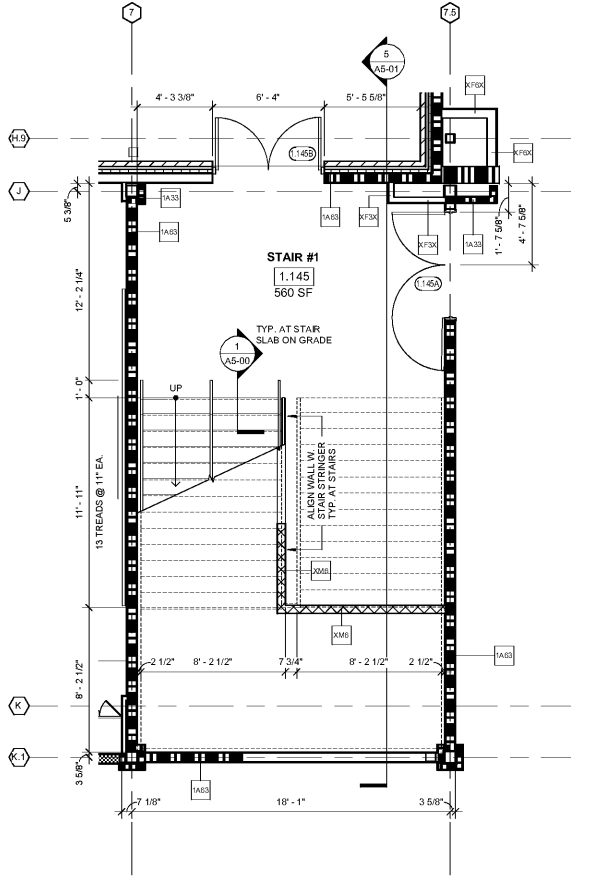

1 ENLARGED STAIR #1 PLAN - LEVEL 01
(STAIR #2 SIM.)
1/4" = 1'-0"

REV. NO.	DATE	REMARKS
1	10/01/19	ISSUED FOR BID/PERMIT/QUOTE
2	10/01/19	ISSUED FOR BID/PERMIT/QUOTE
3	10/01/19	ISSUED FOR BID/PERMIT/QUOTE
4	10/01/19	ISSUED FOR BID/PERMIT/QUOTE
5	10/01/19	ISSUED FOR BID/PERMIT/QUOTE
6	10/01/19	ISSUED FOR BID/PERMIT/QUOTE
7	10/01/19	ISSUED FOR BID/PERMIT/QUOTE
8	10/01/19	ISSUED FOR BID/PERMIT/QUOTE
9	10/01/19	ISSUED FOR BID/PERMIT/QUOTE
10	10/01/19	ISSUED FOR BID/PERMIT/QUOTE

REVISIONS / PRINTED	REV. NO.	DATE	REMARKS
45	10/01/19	10/01/19	PROGRESS PRINT
46	10/01/19	10/01/19	ISSUED FOR BID/PERMIT/QUOTE
47	10/01/19	10/01/19	ISSUED FOR BID/PERMIT/QUOTE
48	10/01/19	10/01/19	ISSUED FOR BID/PERMIT/QUOTE
49	10/01/19	10/01/19	ISSUED FOR BID/PERMIT/QUOTE
50	10/01/19	10/01/19	ISSUED FOR BID/PERMIT/QUOTE
51	10/01/19	10/01/19	ISSUED FOR BID/PERMIT/QUOTE

INSTRUCTIONAL UNITS	REGULAR CLASSROOMS	REGULAR PLEX AREAS	MUSIC	PHYSICAL EDUCATION	ART CENTER	ART	TOTAL
71,145 SF	32,239 SF	108,631 SF					
COVERED AREAS (IE CANOPIES)							
COVERED AREAS (TYP)							
COVERED AREAS (BY 2)							
TOTAL							2,265 SF

PROJECT SUMMARY	REGULAR CLASSROOMS	REGULAR PLEX AREAS	MUSIC	PHYSICAL EDUCATION	ART CENTER	ART	TOTAL
71,145 SF	32,239 SF	108,631 SF					
COVERED AREAS (IE CANOPIES)							
COVERED AREAS (TYP)							
COVERED AREAS (BY 2)							
TOTAL							2,265 SF

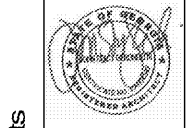

STATE OF GEORGIA
 DEPARTMENT OF EDUCATION
 DIVISION OF OPERATIONS
 3100 ZINGARIA ROAD NE, CONYERS, GA 30012

STAIR PLANS & SECTIONS
 J.H. HOUSE ELEMENTARY SCHOOL
 3100 Zingaria Road NE, Conyers, GA 30012

DATE: 10-01-2019
 JOB NO.: 218036.00
 SHEET NO.: A5-01

www.LDILine.com
 Order Plans @