

4 SECTION AT DISH RETURN
A3-18 3/4" = 1'-0"

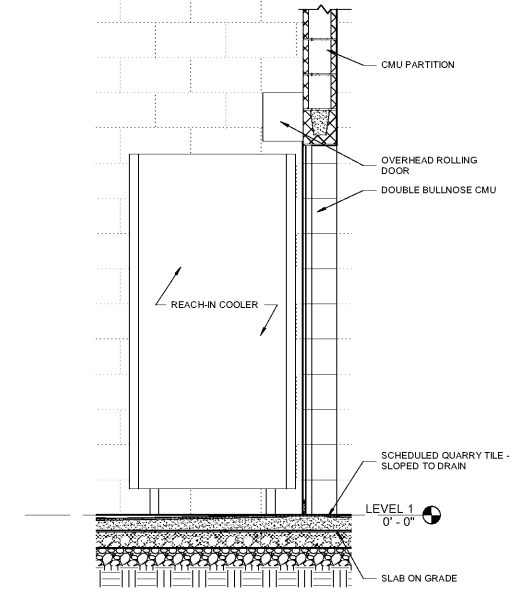

3 SECTION AT REACH-IN COOLER
A3-18 3/4" = 1'-0"

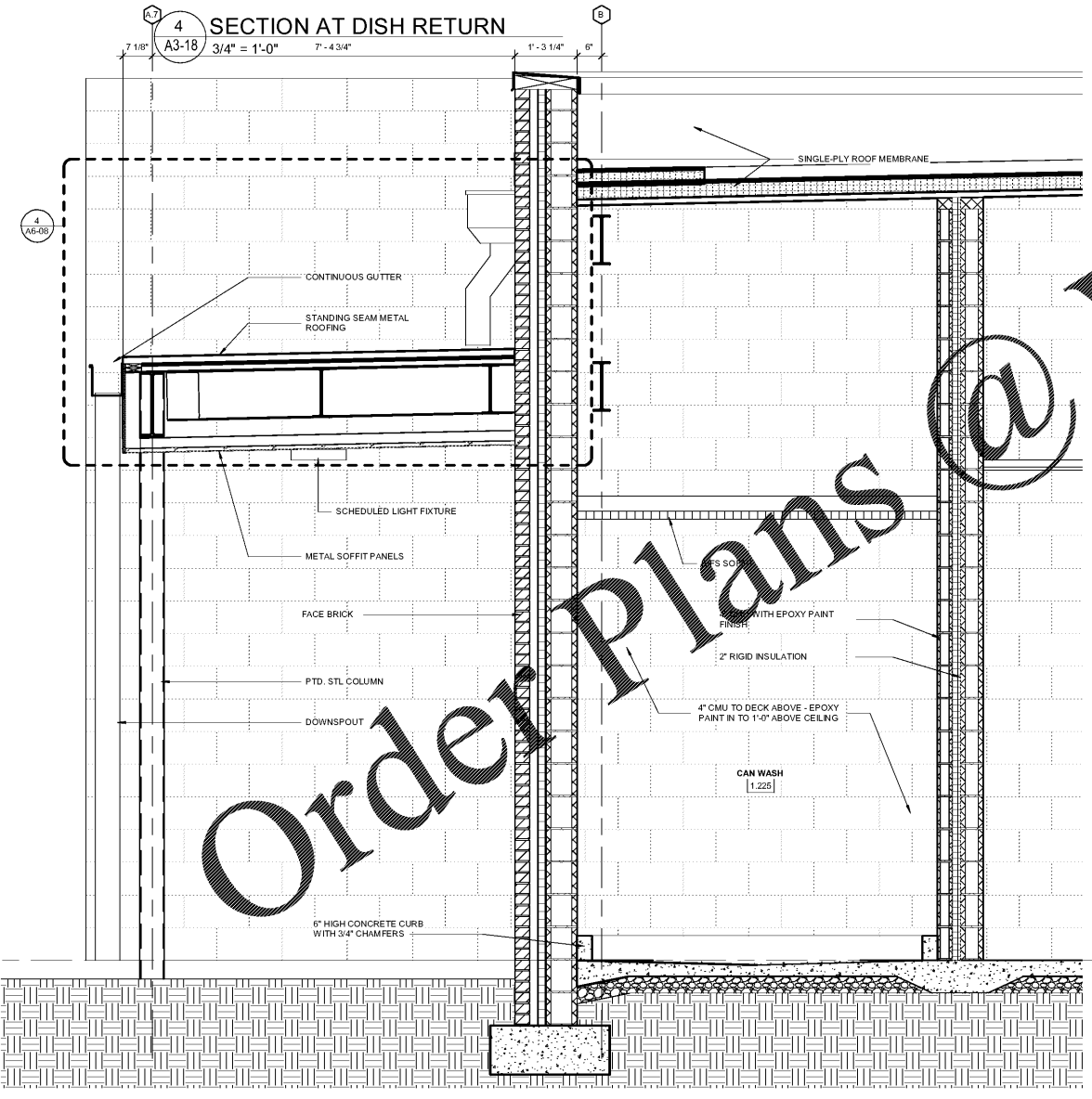

2 SECTION AT CAN WASH
A3-18 3/4" = 1'-0"

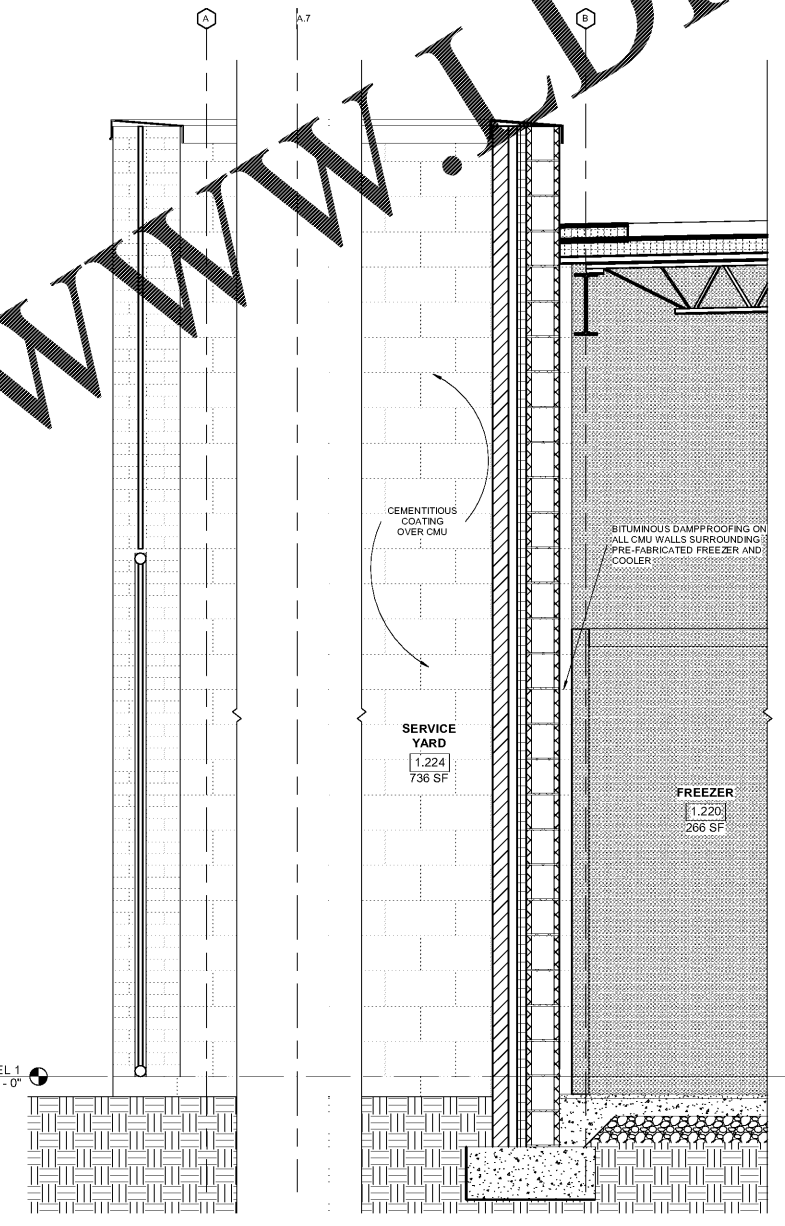

1 SECTION AT FREEZER/COOLER
A3-18 3/4" = 1'-0"

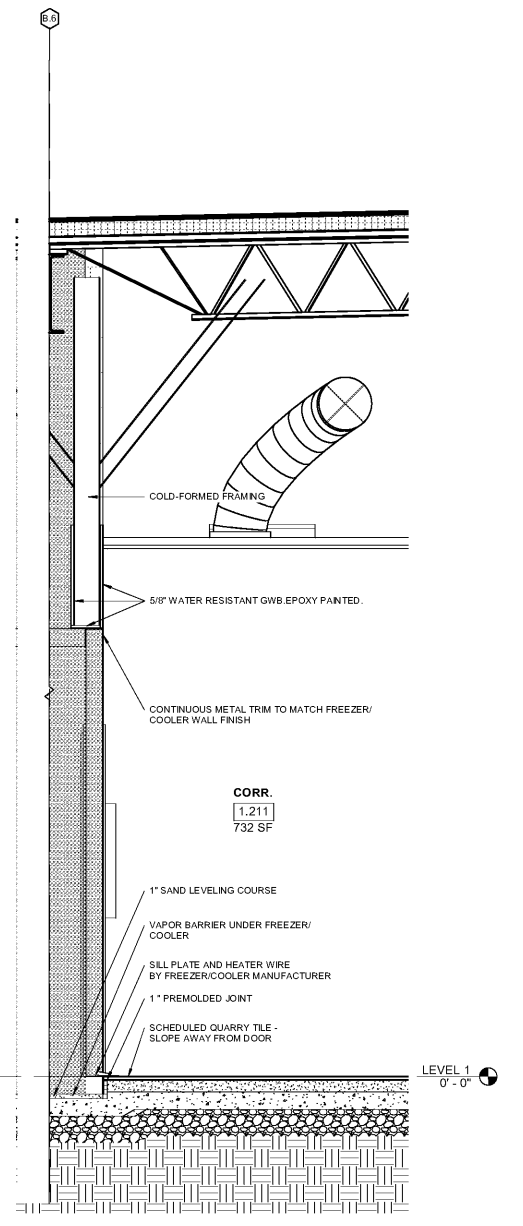

Order Plans @

WWW.LDILine.com

Smallwood, Reynolds, Stewart & Associates, Inc. Architects

One Piedmont Center, Suite 303 3565 Piedmont Road Atlanta, Georgia 30305

KITCHEN SECTIONS

J.H. HOUSE ELEMENTARY SCHOOL
3100 Zingira Road NE, Conyers, GA 30012

DATE: 10-01-2019
JOB NO: 218036.00
SHEET NO: A3-18

ISSUED FOR CONSTRUCTION

REV. NO.	DATE	REMARKS
00019	09/01/19	PROGRESS PRINT
00019	05/06/19	ISSUED FOR BID / PERMIT / GDC

REVISIONS / PRINTED	REV. NO.	DATE	REMARKS
46	4	1	1
45	4	1	1
44	4	1	1
43	4	1	1
42	4	1	1
41	4	1	1
40	4	1	1
39	4	1	1
38	4	1	1
37	4	1	1
36	4	1	1
35	4	1	1
34	4	1	1
33	4	1	1
32	4	1	1
31	4	1	1
30	4	1	1
29	4	1	1
28	4	1	1
27	4	1	1
26	4	1	1
25	4	1	1
24	4	1	1
23	4	1	1
22	4	1	1
21	4	1	1
20	4	1	1
19	4	1	1
18	4	1	1
17	4	1	1
16	4	1	1
15	4	1	1
14	4	1	1
13	4	1	1
12	4	1	1
11	4	1	1
10	4	1	1
9	4	1	1
8	4	1	1
7	4	1	1
6	4	1	1
5	4	1	1
4	4	1	1
3	4	1	1
2	4	1	1
1	4	1	1

PROJECT SUMMARY	REVISIONS / PRINTED
REGULAR CLASSROOMS	46
REGULAR FLEX AREAS	4
MUSIC	1
PHYSICAL EDUCATION	1
ART CENTER	1
AET	1
TOTAL	56

INSTRUCTIONAL UNITS	REVISIONS / PRINTED
REGULAR CLASSROOMS	46
REGULAR FLEX AREAS	4
MUSIC	1
PHYSICAL EDUCATION	1
ART CENTER	1
AET	1
TOTAL	56

FINISHING AREA	REVISIONS / PRINTED
LEVEL 01	71.153 SF
LEVEL 02	32.238 SF
TOTAL	103.391 SF

COVERED AREAS (IE CANOPIES)	REVISIONS / PRINTED
COVERED AREAS (IE CANOPIES)	5.188 SF
COVERED AREAS (BY 2)	3.258 SF
TOTAL	8.446 SF

RCPS

STATE OF GEORGIA

DEPARTMENT OF REVENUE

REGISTERED PROFESSIONAL ARCHITECT

STEWART & ASSOCIATES, INC.

REGISTERED PROFESSIONAL ARCHITECT

MEMBER - AIA