

1 LEVEL 02 - LIFE SAFETY PLAN  
 1/16" = 1'-0"

**RATED WALLS LEGEND**

	ONE HOUR RATED FIRE BARRIER
	TWO HOUR RATED FIRE BARRIER
	THREE HOUR RATED FIRE BARRIER
	SMOKE PARTITION

**LIFE SAFETY LEGEND NFPA 101**

Occupancy Type	Use	Occupancy Load Factor (SF)
A-C	Concentrated Use, Without Fixed Seating	7 SF
A-UC	Less Concentrated Use, Without Fixed Seating	15 SF
B	Business Use	100 SF
E-C	Classrooms	20 SF
E-V	Shops, Laboratories, Vocational Rooms	50 SF
EX-X	Exercise Rooms without Equipment	15 SF
KIT	Kitchens	100 SF
L-R	Library Reading Rooms	50 SF
STG	Stages	15 SF
STR	Storage / Mechanical	300 SF

**GENERAL NOTES**

- SEE SHEET T-06 FOR CODE SUMMARY.
- ALL CORRIDORS TO BE SMOKE RATED.

**LIFE SAFETY ANNOTATIONS LEGEND**

**AREA TAGS**

ROOM NAME  
 AREA TYPE  
 300 SF  
 30

**DOOR TAGS**

30  
 CLEAR WIDTH (MIN.)  
 # OF PERSONS EGRESSING THROUGH EXIT  
 CAPACITY

**TRAVEL DISTANCE**

1'-0" RAD.  
 OCCUPANT LOAD  
 DIRECTION OF TRAVEL

**OCCUPANT LOAD SUMMARY**

LEVEL 01	1,347
LEVEL 02	2,138
TOTAL	3,485

**REVISIONS / PRINTED**

REV. NO.	DATE	REMARKS
00/01/19		PROGRESS PRINT
00/01/19		ISSUE CHECK SET
00/01/19		ISSUED FOR BID / PERMIT / ISSUE

**INSTRUCTIONAL UNITS**

REGULAR CLASSROOMS	71,153 SF
REGULAR FLEX-AREAS	32,238 SF
MUSIC	106,321 SF
PHYSICAL EDUCATION	5,188 SF
ART CENTER	1,258 SF
TOTAL	216,158 SF

**PROJECT SUMMARY**

REGULAR AREA	71,153 SF
LEVEL 01	32,238 SF
LEVEL 02	106,321 SF
TOTAL	216,158 SF

**COVERED AREAS (I.E. CANOPIES)**

COVERED AREAS	5,188 SF
COVERED BY 2	1,258 SF
TOTAL	6,446 SF



DESIGNED BY: SMALLWOOD, REYNOLDS, STEWART & ASSOCIATES, INC.  
 PREPARED BY: THE UNIVERSITY OF GEORGIA ARCHITECTURE  
 WITHOUT THE ARCHITECT'S PERMISSION

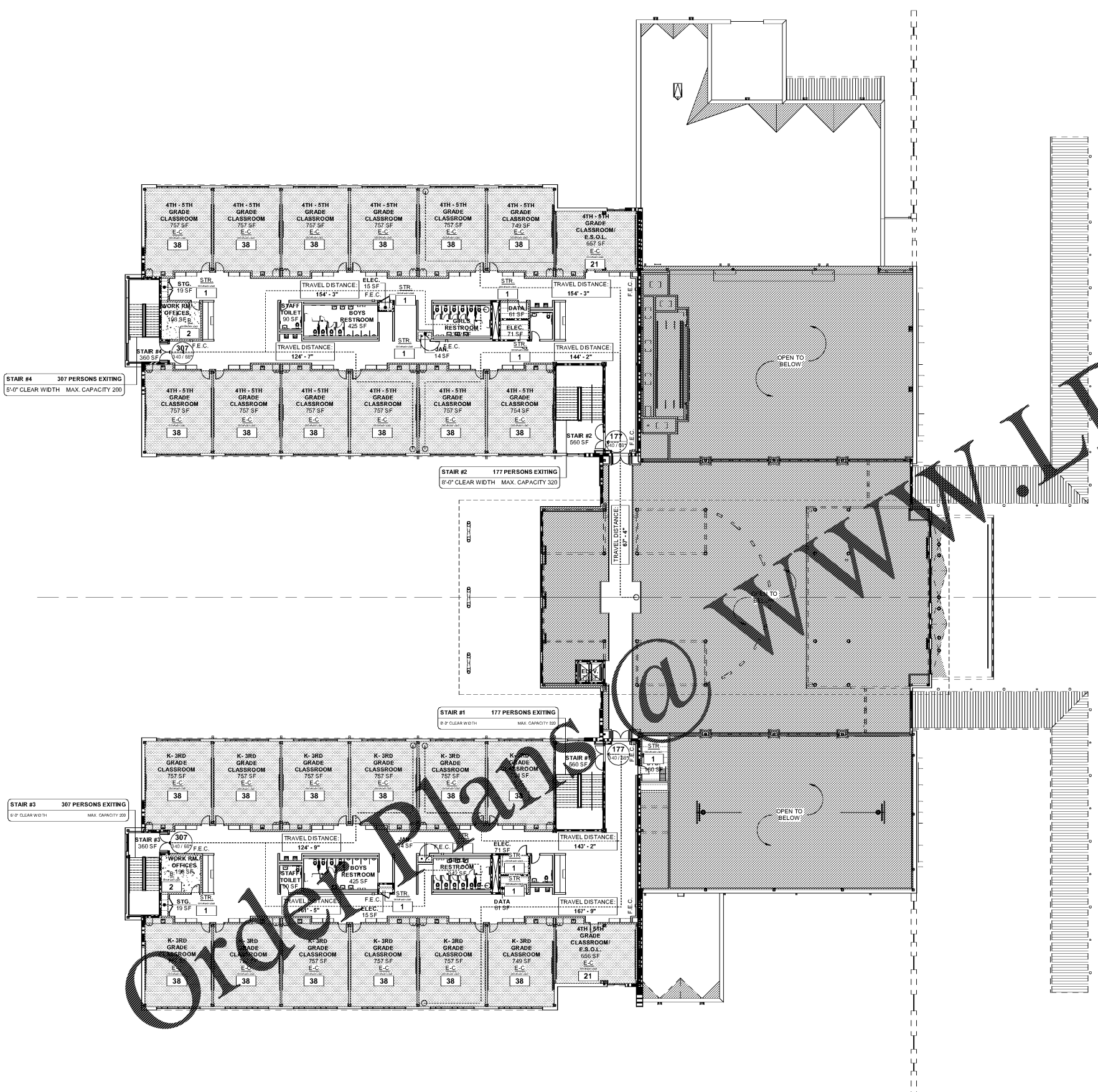

Order Plans @ [www.LDILine.com](http://www.LDILine.com)