



PHILLIPS

CONSULTANT

SEAL

ISSUE & REVISION RECORD

This document is the property of Phillips Partnership, P.C. and is considered an instrument of service and is loaned for use with respect to the project as indicated below. All rights reserved. This document may not be reproduced without the prior written consent of Phillips Partnership, P.C.

PROJECT

Hilton Garden Inn  
CURRENT VERSION

MALL OF GEORGIA

NEW CONSTRUCTION  
4 STORIES-116 GUESTROOMS

CURRENT CODE

CONSTRUCTION TYPE 1

CONSTRUCTION TYPE 2

Hilton Garden Inn Ariston,  
Mall of Georgia, Buford,  
GA

CLIENT



PHILLIPS JOB NUMBER 1963613

ISSUE DATE 08-07-19

DRAWN BY/CHECKED BY Author / Checker

DRAWING TITLE

FLOOR PLAN LEVEL 3

SHEET NUMBER

A-1.3

5901 PEACHTREE DUNWOODY RD.  
BUILDING A, SUITE 450  
ATLANTA, GEORGIA 30328

PHILLIPSPART.COM 776-394-1616

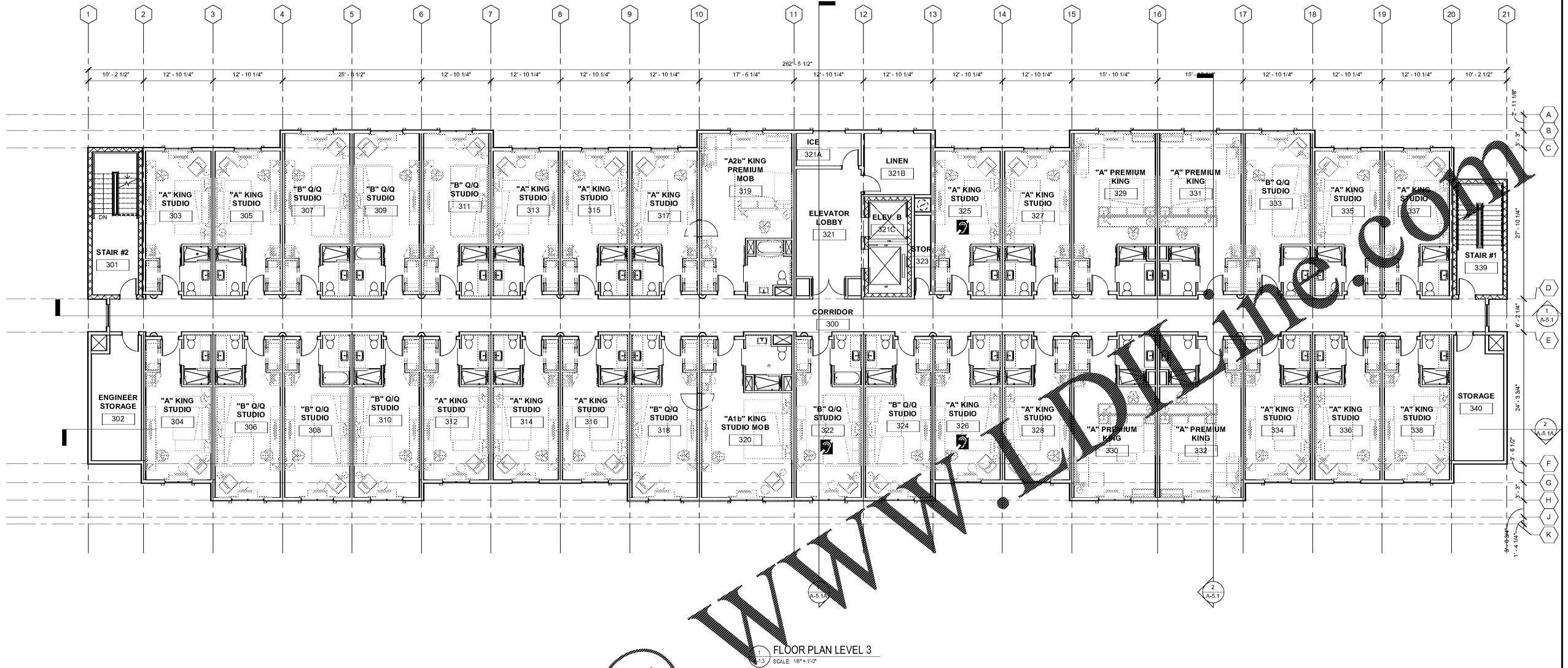

FLOOR PLAN LEVEL 3  
SCALE: 1/8" = 1'-0"

**SYMBOLS LEGEND:**

	INTERNATIONAL SYMBOL OF ACCESS FOR HEARING IMPAIRED - DENOTES GUESTROOMS WITH COMMUNICATION FEATURES (C.F.)		WALL TYPE - SHEET A-0.7 FOR WALL ASSEMBLY.
	INTERNATIONAL SYMBOL OF ACCESS WITH WHEELCHAIR - DENOTES GUESTROOMS WITH MOBILITY FEATURES TO BE EQUIPPED WITH COMMUNICATION FEATURES (C.F.) (M.F.)		DOOR NUMBER
	SMOKE DETECTOR HOLDING DEVICE TO BE RELEASED IN FIRE ALARM ACTIVATION		WINDOW TYPE
	OPERABLE CARD READER AND INTERCOM LOCATIONS. CARD READER STOREFRONT DOORS SHALL BE LOCATED ON EACH STAIR. TOP OF HIGHEST OPERABLE PART SHALL BE 48" AFF AND 81" X 48" CLR. SPACE PROVIDED FOR ADA ACCESS. ALL CARD READERS ARE BATTERY POWERED EXCEPT FOR THE FRONT ENTRY DOOR. THIS DOOR WILL BE HARD WIRE. REF. ELEC. DWG. ONLY PUBLIC ACCESS CARD READERS ARE SHOWN ON FLOOR PLANS.		EYE WASH STATION - REF. PLUMBING DRAWINGS AND BRAND STANDARDS FOR CRITERIA AND LOCATIONS
	FULLY-RECESSED FIRE EXTINGUISHER CABINET (FEC) F.R. CABINET AND WALL PENETRATION ASSEMBLY REQ. AT RATED WALLS. REF. ALL POINTS OF BUILDING SHALL BE WITHIN 70' OF EXTINGUISHER. VERIFY LOCATIONS W/ AHJ.		FULLY-RECESSED FIRE EXTINGUISHER CABINET (FEC) F.R. CABINET AND WALL PENETRATION ASSEMBLY REQ. AT RATED WALLS. REF. ALL POINTS OF BUILDING SHALL BE WITHIN 70' OF EXTINGUISHER. VERIFY LOCATIONS W/ AHJ.

**GUEST UNIT MATRIX - HILTON GARDEN INN ARISTON (GWINNETT), BUFORD, GA**

FLOOR AREA (SF)	KING UNITS						Q/Q UNITS (QUEEN/QUEEN)				TOTAL	
	'A' KING STUDIO	'A1a' KING STUDIO MOB	'A1b' KING STUDIO MOB	'A2' KING PREMIUM	'A2a' KING PREMIUM MOB	'A2b' KING PREMIUM MOB	'B' Q/Q	'B' Q/Q XL	'B1a' Q/Q MOB	'B1b' Q/Q MOB		
LEVEL 1	18,135 SF	4	0	0	0	0	1	1	1	0	7	
LEVEL 2	16,541 SF	18	1	0	4	0	1	10	0	0	34	
LEVEL 3	16,541 SF	18	0	1	4	0	1	10	0	0	34	
LEVEL 4	16,541 SF	18	0	1	4	0	1	10	0	0	34	
SUBTOTAL		58	1	2	12	0	3	31	1	1	109	
TOTAL	67,758 SF	77						33				109
PERCENTAGES		70%						30%				100%

**GUEST UNIT ACCESSIBILITY MATRIX - LOCATION**

TOTAL NUMBER OF GUEST UNITS: 109		
GUEST UNITS WITH:	# OF UNITS REQUIRED	# OF UNITS PROVIDED
MOBILITY FEATURES (M.F.) w/ BATHTUB UNITS #: 'A1b' = 320, 426 'A2b' = 219, 319, 419 'B1b' = N/A	5	5
MOBILITY FEATURES (M.F.) w/ ROLL-IN SHOWER (R-I-S) UNITS #: 'A1a' = 220 'B1a' = 131 • (C.F.)	2	2
<b>TOTAL</b>	<b>7</b>	<b>7</b>
COMMUNICATION FEATURES (C.F.) UNITS #: 'A' = 136, 225, 226, 229, 325, 425, 426 'B' = 120, 131, 222, 322	12	12
CONNECTING ROOMS		
A1a-B: 220-218 A1b-A: 219-217 A1b-B: 320-318	A2b-A: 319-317 A1b-B: 420-418 A2a-A: 419-417	5.5 PAIRS (11) 6 PAIRS (12)

Order Plans @ WWW.IDRIVE.COM