

PHILLIPS

CONSULTANT

SEAL

ISSUE & REVISION RECORD

This document is the property of Phillips Partnership, P.C. and is considered an instrument of service and is solely for use with regard to the project as indicated below. All rights reserved. This document may not be reproduced without the prior written consent of Phillips Partnership, P.C.

PROJECT

Hilton Garden Inn
CURRENT VERSION

MALL OF GEORGIA

NEW CONSTRUCTION
4 STORIES-116 GUESTROOMS

CURRENT CODE

CONSTRUCTION TYPE 1

CONSTRUCTION TYPE 2

Hilton Garden Inn Ariston,
Mall of Georgia, Buford,
GA

CLIENT



PHILLIPS JOB NUMBER 1963613

ISSUE DATE 08-07-19

DRAWN BY/CHECKED BY Author / Checker

DRAWING TITLE FLOOR PLAN LEVEL 1

SHEET NUMBER

A-1.1

5901 PEACHTREE DUNWOODY RD.
BUILDING A, SUITE 450
ATLANTA, GEORGIA 30328

PHILLIPSPART.COM 776-394-1616

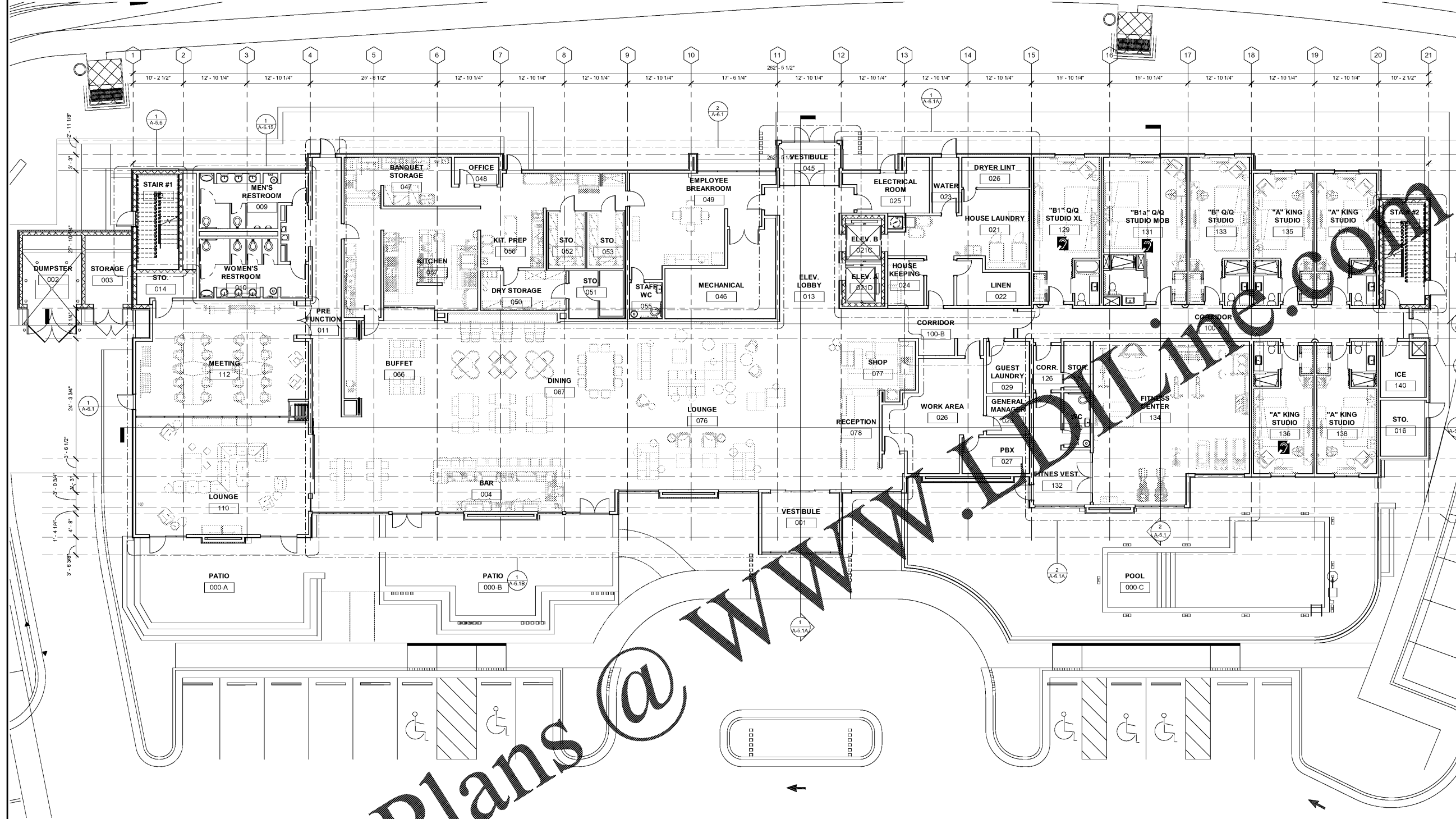

1 FLOOR PLAN LEVEL 1
SCALE: 1/8" = 1'-0"

SYMBOLS LEGEND:

	INTERNATIONAL SYMBOL OF ACCESS FOR HEARING IMPAIRED - NOTES: RESTROOM COMMUNICATION FEATURES (C.F.)		W# - WALL TYPE - SHEET A-0.7 FOR WALL ASSEMBLY.
	INTERNATIONAL SYMBOL OF ACCESSIBILITY DENOTES GUEST ROOMS WITH ACCESSIBILITY FEATURES TO BE EQUIPPED WITH COMMUNICATION FEATURES ALSO (M.F.)		### - DOOR NUMBER
	MAGNETIC DOOR HOLD OPEN DEVICE TO BE RELEASED IN FIRE ALARM ACTIVATION.		W - WINDOW TYPE
	GUEST OPERABLE CARD READER AND INTERCOM LOCATIONS. CARD READERS AT STOREFRONT DOORS SHALL BE LOCATED ON DOOR STYLE. TOP OF HIGHEST OPERABLE PART SHALL BE 48" MAX. AFF AND 30"Y. 48" CLR. SPACE PROVIDED FOR ADA ACCESS ALL CARD READERS ARE BATTERY POWERED EXCEPT FOR THE FRONT ENTRY DOOR. THIS DOOR WILL BE HARD WIRED. REF. ELEC. DWG. ONLY PUBLIC ACCESS CARD READERS ARE SHOWN ON FLOOR PLANS.		EYE WASH STATION - REF. PLUMBING DRAWINGS AND LOCATIONS
			F.E.C. FULLY RECESSED FIRE EXTINGUISHER CABINET (F.E.C.) F.R. CABINET AND WALL PENETRATION ASSEMBLY REQ. AT RATED WALLS. REF. ALL POINTS OF BUILDING SHALL BE WITHIN 75' OF EXTINGUISHER. VERIFY LOCATIONS W/ AHJ.

GUEST UNIT MATRIX - HILTON GARDEN INN ARISTON (GWINNETT), BUFORD, GA

FLOOR AREA (SF)	KING UNITS						Q/Q UNITS (QUEEN/QUEEN)				TOTAL
	'A' KING STUDIO	'A1a' KING STUDIO MOB	'A1b' KING STUDIO MOB	'A2' KING PREMIUM	'A2a' KING PREMIUM MOB	'A2b' KING PREMIUM MOB	'B' Q/Q	'B' Q/Q XL	'B1a' Q/Q MOB	'B1b' Q/Q MOB	
LEVEL 1 18,135 SF	4	0	0	0	0	0	1	1	1	1	7
LEVEL 2 16,541 SF	18	1	0	4	0	1	10	0	0	0	34
LEVEL 3 16,541 SF	18	0	1	4	0	1	10	0	0	0	34
LEVEL 4 16,541 SF	18	0	1	4	0	1	10	0	0	0	34
SUBTOTAL	58	1	2	12	0	3	31	1	1	0	109
TOTAL	77						33				110
PERCENTAGES	70%						30%				100%

GUEST UNIT ACCESSIBILITY MATRIX - LOCATION

GUEST UNITS WITH:	# OF UNITS REQUIRED	# OF UNITS PROVIDED
MOBILITY FEATURES (M.F.) w/ BATHTUB UNITS #: 'A1b' = 320, 420 'A2b' = 219, 319, 419 'B1b' = N/A	5	5
MOBILITY FEATURES (M.F.) w/ ROLL-IN SHOWER (R-I-S) UNITS #: 'A1a' = 220 'B1a' = 131 + (C.F.)	2	2
TOTAL	7	7
COMMUNICATION FEATURES (C.F.) UNITS #: 'A1a' = 136, 225, 226, 229, 325, 326, 425, 426 'B' = 129, 131, 222, 322	12	12
CONNECTING ROOMS A1a-B: 220-218 A1b-A: 219-217 A1b-B: 320-318	A2b-A: 319-317 A1b-B: 420-418 A2a-A: 419-417	5.5 PARS (11) 6 PARS (12)