

PHILLIPS

CONSULTANT \_\_\_\_\_

SEAL \_\_\_\_\_

ISSUE & REVISION RECORD \_\_\_\_\_

This document is © Phillips Partnership, P.C. and is considered an instrument of service and is solely for use with regard to the project as indicated below. All rights reserved. This document may not be reproduced without the prior written consent of Phillips Partnership, P.C.

PROJECT \_\_\_\_\_

**Hilton Garden Inn**  
CURRENT VERSION

**MALL OF GEORGIA**

NEW CONSTRUCTION  
4 STORIES-116 GUESTROOMS

CURRENT CODE

CONSTRUCTION TYPE 1  
CONSTRUCTION TYPE 2

**Hilton Garden Inn Ariston,  
Mall of Georgia, Buford,  
GA**

CLIENT \_\_\_\_\_



PHILLIPS JOB NUMBER 1963613

ISSUE DATE 08-07-19

DRAWN BY/CHECKED BY Author / Checker

DRAWING TITLE SITE PLAN & DETAILS

SHEET NUMBER \_\_\_\_\_

**SP-1**

5901 PEACHTREE DUNWOODY RD.  
BUILDING A, SUITE 450  
ATLANTA, GEORGIA 30328

PHILLIPSPART.COM 770-394-1616

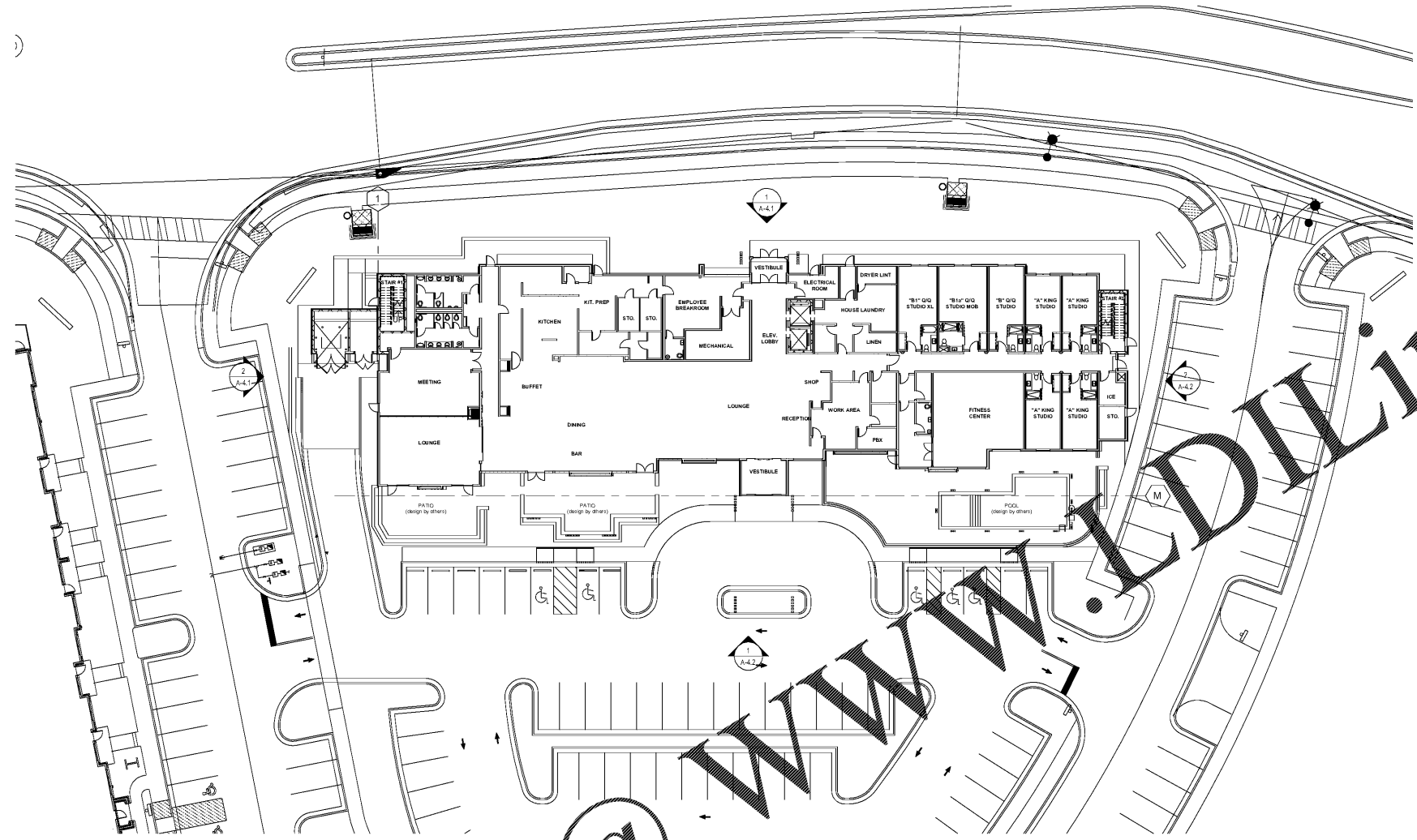

Order Plans @ [www.WWJDDI.com](http://www.WWJDDI.com)

**CRITERIA NOTES**  
CRITERIA NOTES ARE SHOWN CATEGORIZED BY DISCIPLINE AND COULD BE INTERPRETED TO APPLY TO MORE THAN ONE DISCIPLINE. FOR EFFICIENCY, NOTES ARE ONLY SHOWN UNDER ONE PREDOMINANT DISCIPLINE. CONTRACTOR SHALL COORDINATE WITH ALL ASSOCIATED TRADES.

**ARCHITECTURE:**

- A1 MONUMENT SIGN
- A2 DUMPSTER ENCLOSURE. DO NOT BLOCK OVERHEAD FUNCTIONING OF TRUCK.
- A3 EDGE OF SOFFIT ABOVE. SEE RCP FOR EXTERIOR LIGHTING
- A4 SIDE ENTRY CANOPY ABOVE. SEE RCP FOR EXTERIOR LIGHTING
- A5 LOW WALL W/ PRECAST BENCH & SUPPORT COLUMNS FOR SIDE ENTRY CANOPY.
- A6 EDGE OF PORTE COCHERE CANOPY ABOVE. SEE GROUND FLOOR RCP FOR EXTERIOR LIGHTING.
- A7 WALL W/ PRECAST BENCH. EXTEND CONCRETE FOOTING TO SUPPORT COLUMNS & PROTECT AGAINST VEHICLE IMPACT. SEE PORTE COCHERE DRAWINGS FOR ADDITIONAL INFORMATION.
- A8 STRUCTURAL WALL W/ CULTURED STONE VENEER & WELCOME SIGN. EXTEND CONCRETE FOOTING TO PROTECT AGAINST VEHICLE IMPACT.
- A9 DEPRESSED SIDEWALK AND FLOOR SLAB AT VESTIBULE FOR WALK-OFF MAT.
- A10 POOL PATIO FENCE. SEE SHEET SP-4 FOR DETAILS.

**ENGINEERING:**

- E1 FLOOD LIGHTS. ADJUST & AIM LIGHTS TO GRAZE TEXTURED WALL SURFACE.
- E2 SITE LIGHTING POLES TO BE CENTERED ON PARKING STRIPES TO PROTECT FROM CAR OVER-HANG DAMAGE. REF. SITE LIGHTING PLAN.
- E3 LIGHT BOLLARDS @ 10'-0" ON CENTER. LOCATE IN GROUND 18" FROM EDGE OF SIDEWALK (CENTER TO EDGE). PROVIDE CONCRETE FOUNDATION W/ J-BOX PER MANUF. REQUIREMENTS. REF. SITE LIGHTING PLAN.
- E4 NOT USED
- E5 ELECTRIC CAR (PPV) CHARGING STATIONS BY OWNER. SEE ELECTRICAL DRAWING. REF CIVIL DRAWINGS FOR LOCATIONS.

**KEYNOTES:**

- 1 NON-SLIP VEHICULAR GRADE. STAMPED CONCRETE. MAX 2% SLOPE IN ALL DIRECTIONS. REF CIVIL DRAWINGS. VERIFY FINISH WITH OWNER.
- 2 ACCESSIBLE PASSENGER DROP OFF AREA W/ADJACENT CLEAR ACCESS AISLE - DROP OFF & ACCESS AISLE SHALL BE AT THE SAME LEVEL AND SHALL HAVE A SLOPE NOT TO EXCEED 1:50 IN ALL DIRECTIONS. DRIVE AISLES SHALL RAMP UP TO LEVEL OF WALK AT DROP-OFF AREA.

SYMBOLS LEGEND	
	TRANSFORMER ON CONC. PAD
	SITE LIGHT POLE

**GENERAL NOTES:**

- ALL SIGNAGE TO CONFORM TO ALL LOCAL CODES AND ORDINANCES & FRANCHISE STANDARDS. ELECTRICAL FOR BUILDING SIGNAGE AND MONUMENT SIGNAGE SHALL BE PROVIDED AND CONNECTED BY THE CONTRACTOR.
- LIGHT POLE FIXTURES SHALL BE LOCATED AWAY FROM GUESTROOM WINDOWS, SEE ELECTRICAL DRAWINGS.

NOTE: ARCHITECTURAL SITE PLAN FOR REFERENCE ONLY. REF. CIVIL AND LANDSCAPE DRAWINGS PREPARED BY PENINSULA ENGINEERS & SURVEYING FOR CONSTRUCTION AND ADDITIONAL INFORMATION. REF. ELEC. DRAWINGS FOR SITE LIGHTING.