

STORM PROFILE B3-A1

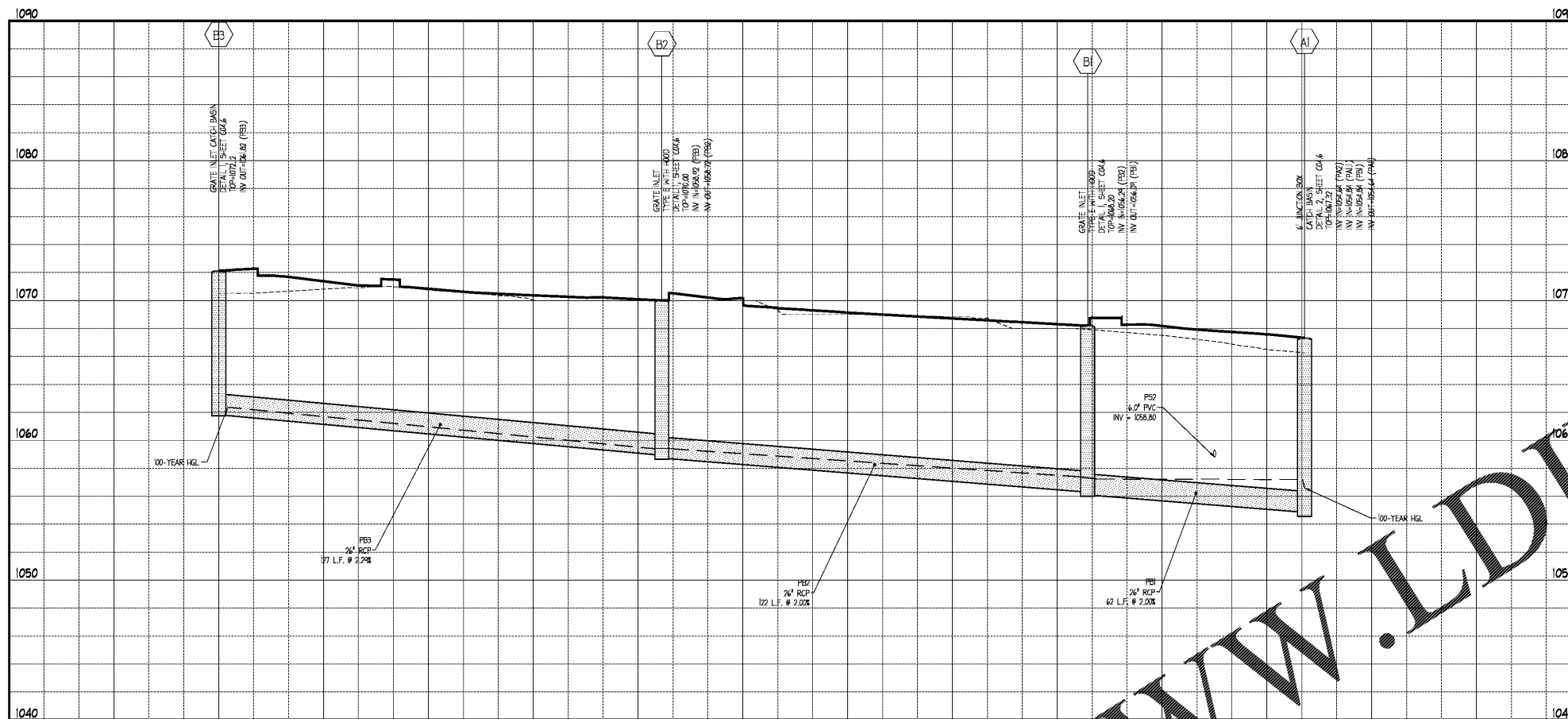

HORIZONTAL SCALE: 1"=20'  
VERTICAL SCALE: 1"=5'

STRUCTURE NAME	STRUCTURE TYPE	RIM ELEVATION	INVERT IN	INVERT OUT
A0	CONTRACTOR SHALL REPLACE EXISTING HERE TOP WITH RAINSOLE	1067.10	1054.29 (PA1)	1054.09 (PEX1)
A1	6" JUNCTION BOX CATCH BASIN DETAIL 2, SHEET C04.6	1067.32	1054.64 (PA2) 1054.84 (PA1.1) 1054.84 (PB1)	1054.44 (PA1)
A1.1	GRATE INLET TYPE E WITH HOOD DETAIL 1, SHEET C04.6	1064.50	1056.76 (PA1.2)	1055.56 (PA1.1)
A1.2	TRENCH DRAIN DETAIL 3, SHEET C04.6	1064.90	1056.88 (PA1.3)	1056.68 (PA1.2)
A1.3	JUNCTION BOX CATCH BASIN DETAIL 2, SHEET C04.6	1067.00	1058.82 (PA1.4)	1058.62
A1.4	JUNCTION BOX CATCH BASIN DETAIL 2, SHEET C04.6	1063.80	1059.73 (PA1.5) 1059.73 (PA1.4)	1059.53 (PA1.4)
A1.5	GRATE INLET CATCH BASIN DETAIL 1, SHEET C04.6	1064.90	1056.99 (PA2)	1056.79 (PA2)
A2	SINGLE RING CATCH BASIN DETAIL 4, SHEET C04.6	1070.00	1055.94 (PA3)	1055.39 (PA2)
A3	GRATE INLET CATCH BASIN DETAIL 1, SHEET C04.6	1070.00	1057.10 (PA3)	1057.10 (PA3)
B1	GRATE INLET TYPE E WITH HOOD DETAIL 1, SHEET C04.6	1066.30	1056.29 (PB2)	1056.09 (PB1)
B2	GRATE INLET TYPE E WITH HOOD DETAIL 1, SHEET C04.6	1070.00	1058.92 (PB3)	1058.72 (PB2)
B3	GRATE INLET CATCH BASIN DETAIL 1, SHEET C04.6	1072.12	1061.82 (PB3)	1061.82 (PB3)

NAME	SIZE	LENGTH	SLOPE	MATERIAL
PA1	18"	10'	2.00%	RCP
PA1.1	18"	30'	2.00%	RCP
PA1.2	18"	46'	2.00%	RCP
PA1.3	18"	79'	2.00%	RCP
PA1.4	18"	44'	2.2%	RCP
PA1.5	18"	40'	2.00%	RCP
PA2	18"	37'	2.00%	RCP
PA2.1	18"	37'	2.00%	RCP
PB1	18"	10'	2.00%	RCP
PB2	18"	107'	2.00%	RCP
PB3	18"	9'	1.50%	RCP

WWW.LDLINE.COM

Order Plans @

Station	Len	Dmg Area	Rnoff	Area x C	Tc	Rain	Total	Cap	Vel	Pipe	Invert Elev	Man Elev	Grate Elev	Rim Elev	Line ID							
Line	To Line	Incr	Total	Incr	Total	Inlet	Syst	(in/hr)	(cfs)	(ft/s)	(ft)	(ft)	(ft)	(ft)	(ft)							
1	End	91.428	0.01	1.10	0.01	0.00	0.85	5.0	8.9	8.3	10.93	13.93	6.18	18	1.50	1052.72	1054.19	1055.38	1055.22	0.00	1067.10	PEX1
2	1	17.741	0.01	1.09	0.01	0.00	0.85	5.0	6.9	8.3	10.83	16.21	6.19	18	2.00	1054.29	1054.29	1056.43	1056.59	1057.10	1067.32	PA1
3	2	35.983	0.11	0.41	0.89	0.10	0.31	5.0	6.5	8.5	2.66	16.09	1.50	18	2.00	1054.85	1055.21	1057.19	1057.21	1057.32	1066.50	PA1.1
4	3	45.539	0.18	0.30	0.69	0.16	0.21	5.0	6.2	8.7	1.86	16.27	1.50	18	1.50	1055.77	1056.68	1057.22	1057.19	1056.50	1054.90	PA1.2
5	4	78.586	0.01	0.12	0.01	0.00	0.05	5.0	5.5	9.0	0.48	16.75	2.11	18	2.00	1056.88	1058.45	1057.19	1058.71	1064.90	1067.00	PA1.3
6	5	43.883	0.01	0.11	0.01	0.00	0.05	5.0	5.3	9.2	0.48	16.83	2.29	18	2.00	1058.82	1059.78	1058.99	1060.04	1067.00	1063.80	PA1.4
7	6	39.870	0.10	0.10	0.61	0.05	0.05	5.0	5.0	9.3	0.48	16.12	1.48	18	2.01	1059.73	1060.53	1060.04	1060.79	1063.80	1064.90	PA1.5
8	2	82.126	0.18	0.38	0.78	0.14	0.28	5.0	6.1	8.7	0.48	16.22	1.65	18	2.00	1054.85	1058.09	1057.19	1057.23	1057.32	1068.20	PB1
9	8	121.838	0.12	0.20	0.91	0.11	0.17	5.0	5.5	9.0	0.48	16.10	3.13	18	2.00	1058.29	1058.73	1057.38	1059.39	1068.20	1070.00	PB2
10	9	126.830	0.08	0.08	0.42	0.03	0.03	5.0	5.0	9.0	0.48	17.17	4.03	18	2.28	1058.89	1061.82	1059.39	1062.36	1070.00	1069.80	PB3
11	2	37.453	0.24	0.29	0.69	0.21	0.26	5.5	5.5	9.1	0.48	15.99	2.49	18	1.98	1054.65	1055.39	1057.19	1057.24	1067.32	1068.00	PA2
12	11	72.058	0.05	0.05	0.92	0.05	0.05	5.0	5.0	9.3	0.48	16.47	2.59	18	2.10	1055.59	1057.10	1057.37	1057.69	1068.00	1070.00	PA3

Line No	Inlet ID	Q = CIA	Q carry	Q capt	Q Byp	Junc Type	Curb Inlet	Grate Inlet	Gutter	Inlet	Byp Line											
		(cfs)	(cfs)	(cfs)	(cfs)		Ht (ft)	L (ft)	Area (sqft)	L (ft)	W (ft)	So (ft/ft)	W (ft)	Sw (ft/ft)	Sx (ft/ft)	n	Depth (ft)	Spread (ft)	Depth (ft)	Spread (ft)	Depth (ft)	Byp (ft)
1	A0	0.01*	0.00	0.00	0.01	MH	0.0	0.00	0.00	0.00	Sag	0.00	0.00	0.000	0.000	0.000	0.00	0.00	0.00	0.00	0.0	Off
2	A1	0.01*	0.00	0.00	0.01	MH	0.0	0.00	0.00	0.00	Sag	0.00	0.00	0.000	0.000	0.000	0.00	0.00	0.00	0.00	0.0	Off
3	A1.1	1.13	0.00	1.13	0.00	Comb	5.5	2.40	0.71	2.40	1.75	Sag	1.50	0.050	0.010	0.000	0.20	13.78	0.20	13.78	0.0	Off
4	A1.2	1.86	0.00	1.83	0.03	DrGr	0.0	0.00	0.00	39.59	0.67	0.050	0.67	0.010	0.012	0.012	0.08	16.87	0.08	16.87	0.0	Off
5	A1.3	0.01*	0.00	0.00	0.01	MH	0.0	0.00	0.00	0.00	Sag	0.00	0.00	0.000	0.000	0.000	0.00	0.00	0.00	0.00	0.0	Off
6	A1.4	0.01*	0.00	0.00	0.01	MH	0.0	0.00	0.00	0.00	Sag	0.00	0.00	0.000	0.000	0.000	0.00	0.00	0.00	0.00	0.0	Off
7	A1.5	0.59	0.00	0.59	0.00	DrGr	0.0	0.00	0.71	2.40	1.75	Sag	1.50	0.010	0.010	0.000	0.08	18.25	0.08	18.25	0.0	Off
8	B1	1.63	0.00	1.63	0.00	Comb	5.5	2.40	0.71	2.40	1.75	Sag	1.50	0.050	0.010	0.000	0.24	18.13	0.24	18.13	0.0	Off
9	B2	1.27	0.00	1.27	0.00	Comb	5.5	2.40	0.71	2.40	1.75	Sag	1.50	0.050	0.010	0.000	0.21	14.99	0.21	14.99	0.0	Off
10	B3	0.39	0.00	0.39	0.00	DrGr	0.0	0.00	0.71	2.40	1.75	Sag	1.50	0.010	0.010	0.000	0.08	14.24	0.08	14.24	0.0	Off
11	A2	2.48	0.00	2.48	0.00	Curb	5.5	12.17	0.00	0.00	Sag	1.50	0.050	0.010	0.000	0.23	17.36	0.23	17.36	0.0	Off	
12	A3	0.53	0.00	0.53	0.00	DrGr	0.0	0.00	0.71	2.40	1.75	Sag	1.50	0.010	0.010	0.000	0.08	17.15	0.08	17.15	0.0	Off

PROFILE NOTES

- CONTROLLED BACK FILL TO BE PLACED IN 6" LOOSE LIFT AND COMPACTED TO 100% ASTM D698 PRIOR TO STORM AND SANITARY SEWER CONSTRUCTION. BACK FILL SHALL BE PLACED TO A MINIMUM OF 12" ABOVE THE CROWN ELEVATION OF THE PIPES.
- STORM DRAIN AND SANITARY SEWER LENGTHS ARE MEASURED FROM CENTER LINE OF STRUCTURE TO CENTERLINE OF STRUCTURE OR FACE OF HEADWALL.
- ALL PIPE LENGTHS SHOWN ARE ROUNDED TO THE NEAREST FOOT.
- ALL STORM DRAIN PIPING SHALL BE TRENCHED, BEDDED AND BACK FILLED ACCORDING WITH DETAIL 3 ON SHEET C04.6 UNLESS SPECIFICALLY NOTED OTHERWISE.
- ALL SANITARY SEWER PIPING SHALL BE TRENCHED, BEDDED AND BACK FILLED ACCORDING WITH DETAIL 3 ON SHEET C04.6 UNLESS SPECIFICALLY NOTED OTHERWISE.
- UNFORESEEN SUBSURFACE CONDITIONS SHALL BE BROUGHT TO THE OWNER'S AND ENGINEER'S ATTENTION IMMEDIATELY. IMPLEMENTATION OF CORRECTIVE BEDDING MEASURES WITHOUT THE OWNER'S APPROVAL SHALL BE AT THE CONTRACTOR'S OWN RISK AND AT NO ADDITIONAL COMPENSATION.
- EXISTING GRADES SHOWN ARE APPROXIMATE AND DO NOT REFLECT TOP SOIL REMOVAL, CLEARING, AND GRUBBING OPERATIONS. THE CONTRACTOR SHALL ASCERTAIN FOR HIMSELF THE EXTENT OF DISTURBANCE FOR THESE ACTIVITIES.
- THE CONTRACTOR SHALL REFERENCE THE GEOTECHNICAL REPORT PREPARED FOR THE OWNER FOR SUBSURFACE CONDITIONS. THE GEOTECHNICAL REPORT IS NOT A PART OF THE CONTRACT DOCUMENTS.
- EXCAVATIONS FOR STRUCTURES SHALL BE TAKEN AS A TRENCHING EXCAVATION WITHOUT FURTHER COMPENSATION.
- SEE SHEET C01 FOR GENERAL NOTES.

WINNETT COUNTY NOTES

- THE CONTRACTOR SHALL CALL DEVELOPMENT INSPECTIONS TO SCHEDULE A PRECONSTRUCTION MEETING PRIOR TO THE START OF ANY CONSTRUCTION (678) 518-6000.
- NOTIFY WINNETT COUNTY INSPECTOR 24 HOURS BEFORE BEGINNING OF EVERY PHASE OF CONSTRUCTION (678) 518-6000.
- NO CERTIFICATE OF OCCUPANCY WILL BE ISSUED UNTIL ALL SITE IMPROVEMENTS HAVE BEEN COMPLETED.
- NO DRIVE UP WINDOWS ARE TO BE INSTALLED.
- NO OUTSIDE STORAGE PROPOSED. THIS INCLUDES SUPPLIES, EQUIPMENT, VEHICLES, PRODUCTS, ETC.
- SIGNS, LOCATION, NUMBER, AND SIZE ARE NOT APPROVED UNDER THIS BUILDING PERMIT. A SEPARATE PERMIT IS REQUIRED FOR EACH SIGN.
- ALL CONSTRUCTION TO COMPLY WITH WINNETT COUNTY STANDARDS.
- NO OVERSIZED SIGNS PERMITTED.
- NATURAL VEGETATION SHALL REMAIN ON THE PROPERTY UNTIL ISSUANCE OF A DEVELOPMENT PERMIT. NO INTERIY LAND DISTURBANCE PERMITS SHALL BE ISSUED.
- IF NO CURB & GUTTER EXISTS ON EXISTING ROADWAY THE SIDEWALK MUST BE FURTHER SETBACK FROM THE EDGE OF PAVEMENT. LOCATION TO BE APPROVED BY THE DEPARTMENT OF TRANSPORTATION.
- MAXIMUM BUILDING HEIGHT: 46 FEET
- THERE IS NO FLOOD PLAN ON THIS PROPERTY FROM A WATER COURSE WITH DRAINAGE AREA EXCEEDING 100 ACRES OR FLOOD PLAIN PER FIRST PANEL 135F0507 DATED SEPTEMBER 24, 2006.
- THERE ARE NO WETLANDS BEING DISTURBED ON THIS SITE.
- THERE ARE NO ROOF OVERHANGS.



ingenium  
PLANNING & ENGINEERING  
1448 N DALE HARRY HWY  
SUITE 250  
TAYLOR, FL 32408  
853.307.0094  
WWW.INGENIUMTEAM.COM



HILTON GARDEN INN  
BUFORD, GEORGIA  
MALL OF GEORGIA BLVD &  
WOODWARD CROSSING BLVD

Hilton  
Garden Inn

CLIENT:  
PHG BUFORD, LLC  
3500 LENOX ROAD, SUITE 625  
ATLANTA, GEORGIA 30326  
PHONE: (404) 497-4111

No	Description
1	Issue for Permit

PROJ #	180060
DWG NAME	180060 COLDING
ISSUE DATE	10/30/2019
PROJ MGR	EF
SHEET NUMBER	
C04.8	

SHEET FOR PERMIT