



Copyright © 2019
 Ellis Architects, Inc.
 Ellis Architects, Inc. maintains all intellectual rights and ownership of all information contained on these documents. Ellis Architects, Inc. and its consultants shall be deemed the authors and owners of their respective instruments of service and shall retain all common law, statutory and other reserved rights, including copyrights. This document shall not be reproduced without the written authorization of Ellis Architects.
 Do Not Scale From Drawings.
 Contractor must verify all dimensions prior to construction.

JOB No.	18004
DOCUMENT	DATE
FINAL CDS	09/06/2019
DRAWN BY: JAM/JR	
AUXILIARY PLAN	
E4.1	

- KEYED NOTES:**
1. PROVIDE COPPER TELEPHONE LINES FOR FIRE ALARM SYSTEM AS REQUIRED.
 2. FOR TIME CLOCK, DATA DEVICE TO BE LOCATED IN RECESSED BOX. VERIFY MOUNTING HEIGHT WITH OWNER.
 3. PANIC BUTTON SYSTEM PANEL.
 4. 2 x 2 FLOOR MOUNTED DATA RACK AS REQUIRED.
 5. DATA DROPS FOR COMPUTERS/SERVERS, 4 DROPS PER LOCATION. VERIFY LOCATIONS WITH OWNERS IT PERSONNEL.
 6. TBB (TELEPHONE BACKBOARD) 8" TALL X 3/4" THICK WHERE SHOWN.
 7. DATA DEVICE MOUNTED AT 44" A.F.F. TO THE TOP OF BOX. VERIFY MOUNTING HEIGHT WITH ARCHITECT AND CASEWORK.
 8. DATA DEVICE MOUNTED AT 24" A.F.F. TO THE TOP OF BOX. VERIFY MOUNTING HEIGHT WITH ARCHITECT AND CASEWORK.
 9. PROVIDE 3/4" EMT FROM ROOM 113, THROUGH CORRIDOR TO SECURITY DEVICE LATCH AS SHOWN. CONDUIT SHALL BE RECESSED WITHIN WALL CAVITY. ROUTED TO THE LAY, INCLUDING.

- GENERAL AUXILIARY NOTES:**
1. STRUCTURED CABLING SYSTEM BY CONTRACTOR.
 2. CONTRACTOR SHALL FURNISH AND INSTALL ALL WIRING IN CONDUIT FOR FIRE ALARM SYSTEM EVEN THOUGH NOT SPECIFICALLY SHOWN ON DRAWING. FIRE ALARM DEVICES AND EQUIPMENT ARE SHOWN AND MUST BE PROPERLY CONNECTED TO PROVIDE A COMPLETE WORKING SYSTEM. WIRING AND ZONING SHALL BE AS RECOMMENDED BY MANUFACTURER.
 3. FIRE ALARM SYSTEM SHALL BE TESTED AND CERTIFIED.
 4. VERIFY EXACT LOCATION OF ALL DEVICES IN WITH ARCHITECT PRIOR TO INSTALLATION. COORDINATE WITH ARCHITECT'S INTERIOR ELEVATIONS AND SECTIONS TO LOCATE DEVICES. WHERE BEDROOMS ARE SIMILAR IN LAYOUT DEVICE LOCATIONS MUST BE CONSISTENT IN EACH ROOM.
 5. ALL CEILING MOUNTED DEVICES SHALL BE MOUNTED IN THE CENTER OF CEILING TILES. SEE ARCHITECTURAL REFLECTED CEILING PLANS.
 6. SEE ARCHITECTURAL ELEVATIONS AND REFLECTED CEILING PLAN FOR EXACT LOCATIONS OF ALL DEVICES.
 7. ALL TV OUTLETS ARE TO BE CENTERED ON WALLS. SEE MOUNTING DETAILS.
 8. VERIFY EXACT LOCATION OF ALL CCTV EQUIPMENT WITH SECURITY CONTRACTOR.

- AUXILIARY RACEWAY NOTES:**
- PROVIDE J-HOOKS IN ALL CORRIDORS WHERE CABLE TRAY IS NOT SHOWN AS FOLLOWS:**
1. J-HOOKS SHALL BE 4" EQUAL TO 8-LINE #8CH64 WITH CABLE RETAINERS.
 2. J-HOOK MULTI-TIER SUPPORTS SHALL BE FACTORY ASSEMBLED UNITS EQUAL TO 8-LINE BCH SERIES HANGERS.
 3. ALL J-HOOKS SHALL BE EQUIPPED WITH CABLE RETAINERS EQUAL TO 8-LINE #8CHIR QUICK-LATCH CABLE RETAINERS OF THE PROPER SIZE.
 4. HANGERS SHALL BE CONFIGURED AS REQUIRED TO ATTACH TO THE STRUCTURE. WALL MOUNTED, CEILING MOUNTED, SUSPENDED FROM ALL THREAD ROD, OR SUPPORTED ON STRUT ATTACHED TO THE STRUCTURE. ANCHORS ATTACHED TO SHEETROCK SHALL NOT BE ACCEPTABLE.
 5. HANGERS SHALL BE SINGLE OR MULTIPLE TIERED AS REQUIRED FOR THE NUMBER OF CABLES BEING SUPPORTED.
 6. AT CORRIDOR CROSSINGS OR OTHER LOCATIONS WHERE WALL MOUNTING IS IMPRACTICAL, HANGERS SHALL BE DOUBLE SIDED. SINGLE TIER J-HOOKS SUSPENDED ON ALL THREAD RODS SUPPORTED FROM THE BUILDING STRUCTURE OR BEAM CLAMPS.
 7. J-HOOKS SHALL BE SPACED AT A MAXIMUM OF 36" ON CENTERS.

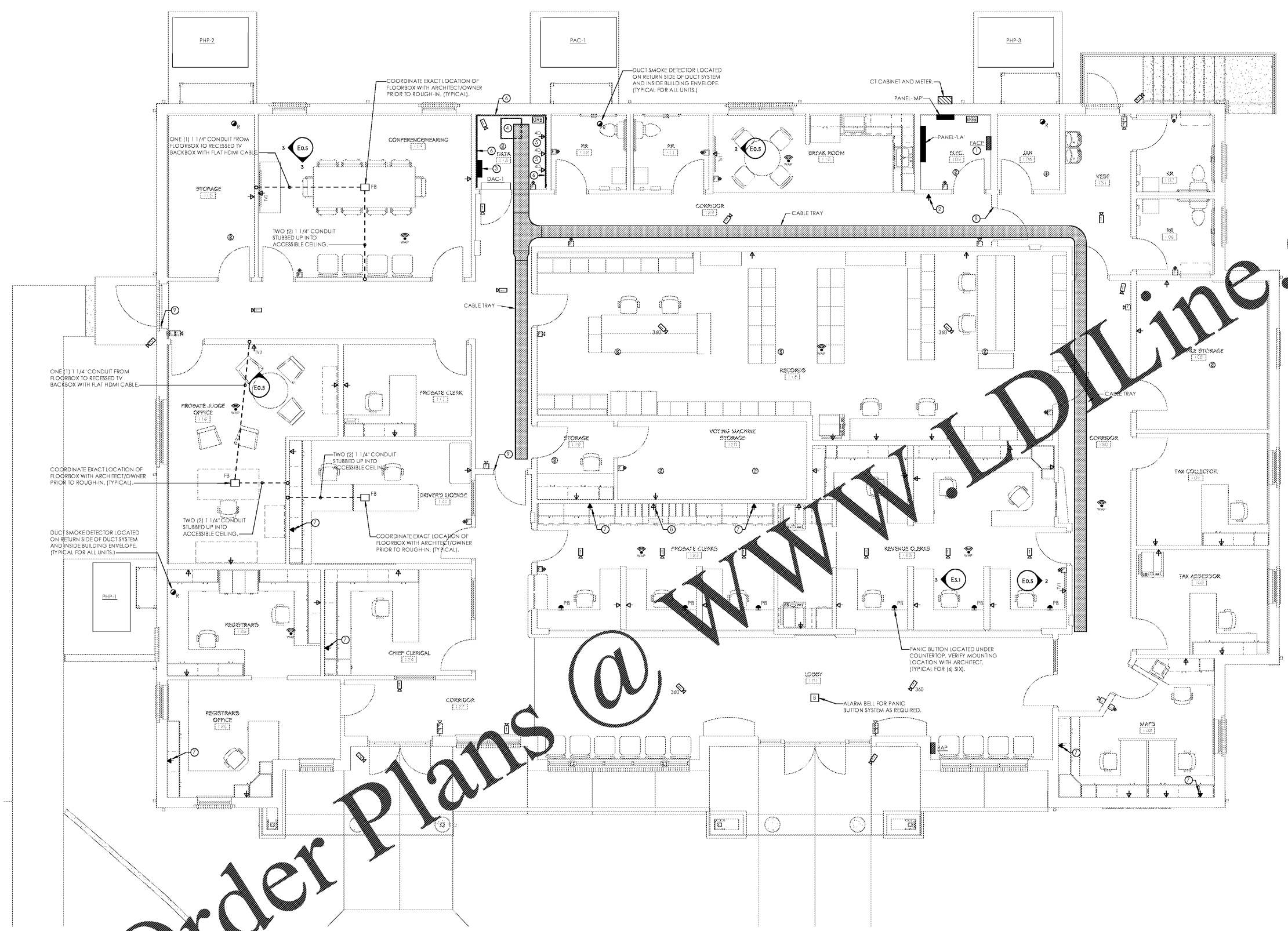

Order Plans @ WWW.DIline.com

AUXILIARY PLAN